

ROMANELLI, PATRICIA J
A.P.N. 1420-19-101-016

WEST RIDGE HOMES, INC
APN 1420-19-101-012
PARCEL 2, P.M. 147129
±44,286 SQ.FT.

WEST RIDGE HOMES, INC
APN 1420-19-101-013
PARCEL 1, P.M. 147129
& DOC. NO. 175914
± 64581 SQ.FT.

WESTRIDGE HOMES, INC
APN 1420-19-101-014
PARCEL 3, P.M. 147129
±49,257 SQ.FT.

LODESTONE GROUP LLC, et al
A.P.N. 1420-19-101-015

- LEGEND**
- SET REBAR & CAP OR NAIL & WASHER PLS 9102
 - ⊙ FOUND 5/8" REBAR
 - ⊙ FOUND 1" IRON PIPE

- REFERENCES**
1. PARCEL MAP NO. 147129, OFFICIAL RECORDS OF DOUGLAS COUNTY.
 2. FINAL CONDEMNATION ORDER DOCUMENT NO. 175914 OF DOUGLAS COUNTY.
 3. GRANT OF EASEMENT DOCUMENT NO. 2018-920552 OF DOUGLAS COUNTY.

BASIS OF BEARINGS
THE BASIS OF BEARINGS FOR THIS SURVEY ARE THE SAME AS THOSE AS SHOWN ON P.M. NO. 147129, RECORDED DECEMBER 19, 1986, OFFICIAL RECORDS OF DOUGLAS COUNTY, NEVADA.

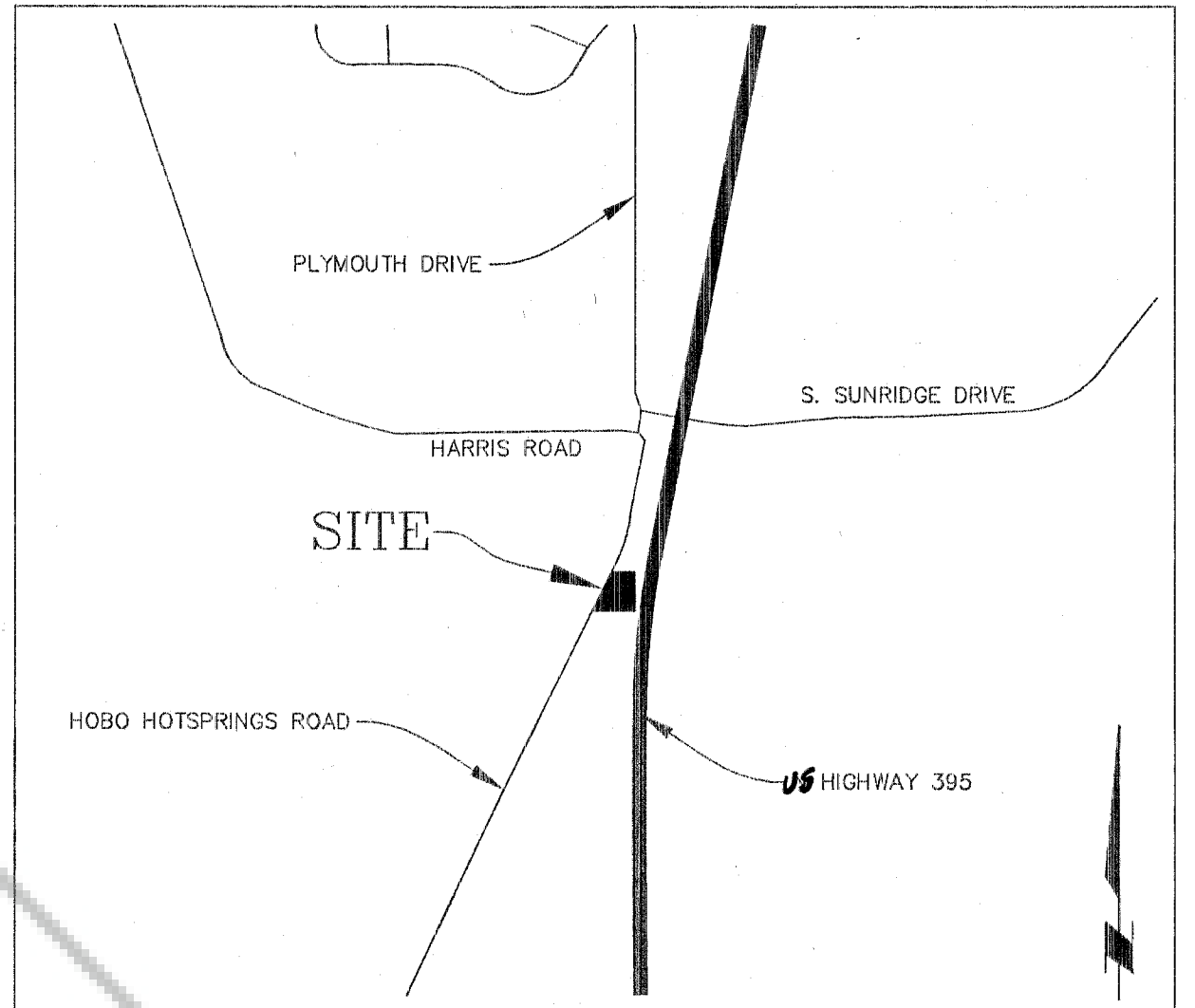
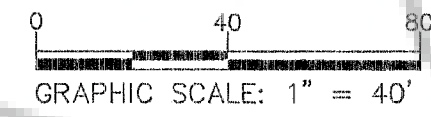

VICINITY MAP
N.T.S.

SURVEYOR'S CERTIFICATE

I, GREGORY A. BIGBY, A PROFESSIONAL LAND SURVEYOR LICENSED IN THE STATE OF NEVADA, CERTIFY THAT:

THIS PLAT REPRESENTS THE RESULTS OF A SURVEY CONDUCTED UNDER MY DIRECT SUPERVISION AT THE INSTANCE OF: PETER BEEKHOF

1. THE LANDS SURVEYED LIE WITHIN THE NE 1/4 OF THE NW 1/4 OF SECTION 19, TOWNSHIP 14 NORTH, RANGE 20 EAST, MOUNT DIABLO MERIDIAN, AND THE SURVEY WAS COMPLETED ON OCTOBER 29, 2018.
2. THIS PLAT COMPLIES WITH THE APPLICABLE STATE STATUTES AND ANY LOCAL ORDINANCES IN EFFECT ON THE DATE THAT THE SURVEY WAS COMPLETED, AND THE SURVEY WAS CONDUCTED IN ACCORDANCE WITH CHAPTER 625 OF THE NEVADA ADMINISTRATIVE CODE.
3. THE MONUMENTS DEPICTED ON THIS PLAT ARE OF THE CHARACTER SHOWN AND OCCUPY THE POSITION AND ARE OF SUFFICIENT NUMBER AND DURABILITY FOR THE SURVEY TO BE RETRACED.
4. THIS MAP IS NOT IN CONFLICT WITH THE PROVISIONS OF N.R.S. 278.010 AND 278.830 INCLUSIVE, AND NO NEW PARCELS HAVE BEEN CREATED.

Gregory A. Bigby
GREGORY A. BIGBY, P.L.S. 9102

12/30/18

RECORDER'S STATEMENT

FILE NO. 2018-921592 FEE \$27.00
FILED FOR RECORD AT THE REQUEST OF BIGBY AND ASSOCIATES
ON THIS 30 DAY OF October, 2018, AT 58 MINUTES PAST 1 O'CLOCK
P.M. OFFICIAL RECORDS OF DOUGLAS COUNTY, NEVADA

Karen Ellison COUNTY RECORDER BY: [Signature] DEPUTY

TOTAL AREA: 3.63 ACRES ±
RECORD OF SURVEY
FOR
WEST RIDGE HOMES
BEING A PORTION OF THE NE 1/4 OF THE NW 1/4 OF SECTION 19, TOWNSHIP 14 NORTH, RANGE 20 EAST, MOUNT DIABLO BASELINE AND MERIDIAN
DOUGLAS COUNTY NEVADA

BIGBY AND ASSOCIATES, INC.
1280 TERMINAL WAY #32
RENO, NEVADA 89502 (775) 851-0432