

VICINITY MAP
NO SCALE

NOTES

THIS MAP REFERENCES PARCEL MAP #4 FOR COLDWELL BANKER ITILDO, INC., FILED FOR RECORD OCTOBER 20, 1992 AS DOCUMENT NO. 291152 AND PARCEL MAP #3 FOR COLDWELL BANKER ITILDO, INC., FILED FOR RECORD OCTOBER 2, 1992 AS DOCUMENT NO. 289989.

THESE PARCELS LIE WITHIN THE UNSHADED "X" AND SHADED "X" ZONES PER FEMA PANEL MAP 32005C0240G DATED JANUARY 20, 2010.

ADJUSTED PARCEL 1-D HAS NO WELL AND NO SEPTIC

ADJUSTED PARCEL 2-D HAS ONE WELL AND ONE SEPTIC

THIS RECORD OF SURVEY IS TO SUPPORT THOSE CERTAIN DEEDS RECORDED IN OFFICIAL RECORDS OF DOUGLAS COUNTY, NEVADA AS DOCUMENT NO. 2018-921631, AND DOCUMENT NO. N/A, AND DOCUMENT NO. N/A.

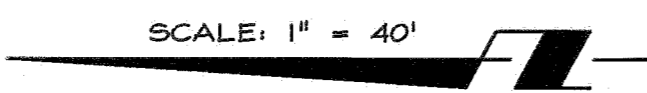

SURVEYOR'S CERTIFICATE

I, MATTHEW P. BERNARD, A PROFESSIONAL LAND SURVEYOR LICENSED IN THE STATE OF NEVADA, CERTIFY THAT:

- 1) A FIELD SURVEY OF THE BOUNDARIES OF THE AFFECTED PARCELS HAS BEEN PERFORMED BY ME OR UNDER MY SUPERVISION AT THE INSTANCE OF JENNIFER ANN YTURBIDE AND TOD F. CARLINI.
- 2) THIS PLAT IS A TRUE AND ACCURATE REPRESENTATION OF THE LANDS SURVEYED.
- 3) ALL CORNERS AND ANGLE POINTS OF THE ADJUSTED BOUNDARY LINE HAVE BEEN SET AND THE MONUMENTS ARE OF THE CHARACTER SHOWN AND OCCUPY THE POSITIONS INDICATED AND ARE OF SUFFICIENT NUMBER AND DURABILITY TO ENABLE THIS SURVEY TO BE RETRACED.
- 4) THE LANDS SURVEYED LIE WITHIN A PORTION OF SECTION 3, T.12N., R.19E., M.D.M. AND THE SURVEY WAS COMPLETED ON 10-23-18.
- 5) THIS PLAT IS NOT IN CONFLICT WITH THE PROVISIONS OF NRS 278.010 THROUGH NRS 278.630 INCLUSIVE AND COMPLIES WITH ALL APPLICABLE STATE STATUTES AND ANY LOCAL ORDINANCES.

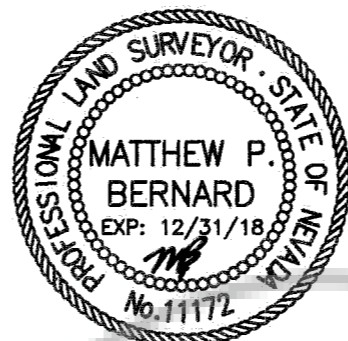

Matthew P. Bernard
MATTHEW P. BERNARD, P.L.S. 11172

OWNER'S CERTIFICATE

WE, THE UNDERSIGNED OWNERS OF THE AFFECTED PARCELS AS SHOWN ON THIS MAP, DO HEREBY STATE THAT:

- 1) WE HAVE EXAMINED THIS PLAT AND APPROVE AND AUTHORIZE ITS RECORDING;
- 2) WE AGREE TO EXECUTE THE REQUIRED DOCUMENTS CREATING ANY EASEMENT WHICH IS SHOWN HEREON;
- 3) WE AGREE TO EXECUTE THE REQUIRED DOCUMENTS ABANDONING ANY EXISTING EASEMENT PURSUANT TO THE PROVISIONS OF NRS 278.010 TO 278.630 INCLUSIVE;
- 4) ALL PROPERTY TAXES ON THE LAND FOR THE FISCAL YEAR HAVE BEEN PAID;
- 5) ANY LENDER WITH AN IMPOUND ACCOUNT FOR THE PAYMENT OF TAXES HAS BEEN NOTIFIED OF THE ADJUSTMENT OF THE BOUNDARY LINE OR THE TRANSFER OF THE LAND.

Jennifer Ann Yturbide
JENNIFER ANN YTURBIDE, OWNER (A.P.N. 1219-03-001-044)

Jennifer Ann Yturbide
JENNIFER ANN YTURBIDE, TRUSTEE OF CARLINI/YTURBIDE TRUST (A.P.N. 1219-03-001-045)

Tod F. Carlini
TOD F. CARLINI, TRUSTEE OF CARLINI/YTURBIDE TRUST (A.P.N. 1219-03-001-045)

STATE OF NEVADA SS.
COUNTY OF DOUGLAS

ON THIS 23 DAY OF October, IN THE YEAR 2018 BEFORE ME, A NOTARY PUBLIC, PERSONALLY APPEARED JENNIFER ANN YTURBIDE & TOD F. CARLINI, PERSONALLY KNOWN BY ME TO BE THE PERSONS WHOSE NAMES ARE SUBSCRIBED TO THE ABOVE INSTRUMENT WHO ACKNOWLEDGED THAT THEY EXECUTED THE SAME IN THEIR AUTHORIZED CAPACITY AND THAT BY THEIR SIGNATURES ON THE INSTRUMENT, THE PERSONS, OR THE ENTITY ON BEHALF OF WHICH THE PERSONS ACTED, EXECUTED THE INSTRUMENT.

WITNESS MY HAND AND OFFICIAL SEAL:

Jane Gray
NOTARY'S SIGNATURE

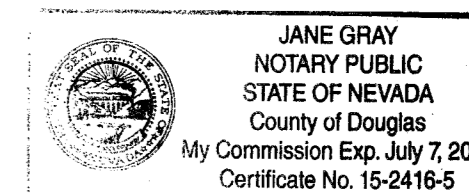

CLERK TREASURER'S CERTIFICATE

ALL PROPERTY TAXES FOR THE PARCELS SHOWN ON THIS MAP HAVE BEEN PAID IN FULL FOR THE FISCAL TAX YEAR. (A.P.N. 1219-03-001-044 & A.P.N. 1219-03-001-045)

Kathy Lewis Senior Deputy Treasurer
KATHY LEWIS
TREASURER 10/29/18

COMMUNITY DEVELOPMENT DEPARTMENT CERTIFICATE

IT IS HEREBY CERTIFIED THAT THIS BOUNDARY LINE ADJUSTMENT WAS PRESENTED TO THE DOUGLAS COUNTY COMMUNITY DEVELOPMENT DEPARTMENT AND WAS DULY APPROVED.

Lucille Rao 10/24/18
COMMUNITY DEVELOPMENT DEPARTMENT DATE
Lucille Rao

RECORDER'S CERTIFICATE

FILED FOR RECORD THIS 31st DAY OF October, 2018, AT 53 MINUTES PAST 10 O'CLOCK A.M., DOCUMENT NO. 2018-921631 RECORDED AT THE REQUEST OF JENNIFER ANN YTURBIDE & TOD F. CARLINI.

John O. Small Deputy
DOUGLAS COUNTY RECORDER

SCALE: 1" = 40' SHEET 1 OF 1

RECORD OF SURVEY
TO SUPPORT A BOUNDARY LINE ADJUSTMENT
FOR
JENNIFER ANN YTURBIDE
AND
CARLINI/YTURBIDE TRUST

LOCATED WITHIN A PORTION OF SECTION 3,
TOWNSHIP 12 NORTH, RANGE 19 EAST, M.D.M.
DOUGLAS COUNTY, NEVADA

0271-015
0271-015BLA

09/11/18

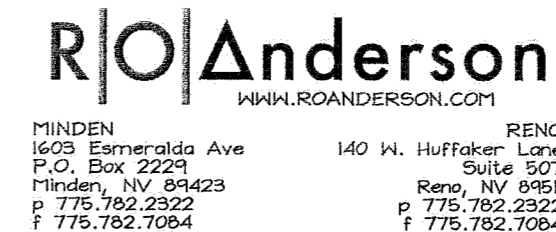

YTURBIDE, JENNIFER ANN
CARLINI-YTURBIDE TRUST

2018-921631

SEC 3 T12N R19E

LINE TABLE		
LINE	BEARING	LENGTH
LI	S89°42'19"W	70.86'

LEGEND

- FOUND MONUMENT AS INDICATED
- △ SET 5/8" REBAR WITH PLASTIC CAP PLS 11172 OR AS INDICATED
- ⊕ WATER WELLHEAD

BASIS OF BEARING

S00°07'52"E - BEING THE EAST LINE OF PARCEL 2-D AS SHOWN ON PARCEL MAP #3 FOR COLDWELL BANKER ITILDO, INC., FILED FOR RECORD OCTOBER 2, 1992 IN THE OFFICE OF RECORDER, DOUGLAS COUNTY, NEVADA AS DOCUMENT NO. 289989, ALSO BEING THE EAST LINE OF PARCEL 1-D AS SHOWN ON PARCEL MAP #4 FOR COLDWELL BANKER ITILDO, INC., FILED FOR RECORD OCTOBER 20, 1992 IN THE OFFICE OF RECORDER, DOUGLAS COUNTY, NEVADA AS DOCUMENT NO. 291152.

C:\Client\Files\2018\2018-921631-015BLA.dwg 10/22/2018 3:15:14 PM D:\Dwg_Schurman.dwg