

LYONS AVENUE

BASIS OF BEARINGS  
N89°46'36"W (R1,M)  
34.04' (M)  
34.00' (R1)

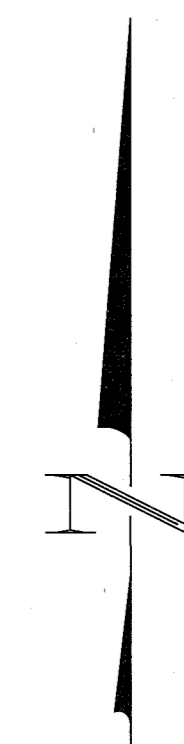

1" = 5'

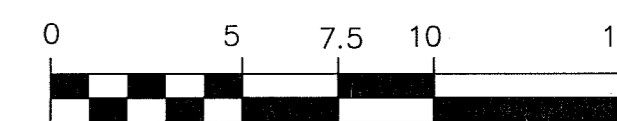

LOT 2  
BLOCK 1  
TAHOE DOUGLAS DISTRICT  
DOC. NO. 676693

N07°32'4"E  
60.00' (R1,R2)  
N07°00'33"W  
59.57' (M)

LOT 3, BLOCK 1  
CURRY  
DOC. NO. 2018-911436  
AREA=2026 SQ. FT.

N04°31'1"E  
59.93' (M)  
N07°04'1"E  
60.00' (R1)

LOT 4  
BLOCK 1  
PECK/LOOMIS  
DOC. NO. 892243

**SURVEYOR'S CERTIFICATE**

- STEPHEN BREJC, A PROFESSIONAL LAND SURVEYOR LICENSED IN THE STATE OF NEVADA, CERTIFY THAT:
- THIS PLAT REPRESENTS THE RESULTS OF A SURVEY CONDUCTED UNDER MY DIRECT SUPERVISION AT THE INSTANCE OF: RYAN E. CURRY
- THE LANDS SURVEYED LIE WITHIN A PORTION OF THE NW 1/4 OF SECTION 34, TOWNSHIP 14 NORTH, RANGE 18 EAST, MOUNT DIABLO MERIDIAN, AND THE SURVEY WAS COMPLETED ON NOVEMBER 27, 2018.
- THIS PLAT COMPLIES WITH APPLICABLE STATE STATUTES AND ANY LOCAL ORDINANCES IN EFFECT ON THE DATE THAT THE SURVEY WAS COMPLETED, AND THE SURVEY WAS CONDUCTED IN ACCORDANCE WITH CHAPTER 626 OF THE NEVADA ADMINISTRATIVE CODE.
- THE MONUMENTS DEPICTED ON THIS PLAT ARE OF THE CHARACTER SHOWN AND OCCUPY THE POSITION AND ARE OF SUFFICIENT NUMBER AND DURABILITY FOR THE SURVEY TO BE RETRACED.
- NO NEW PARCELS HAVE BEEN CREATED BY THIS MAP.

*Stephen Brejc*  
STEPHEN BREJC PLS 16626

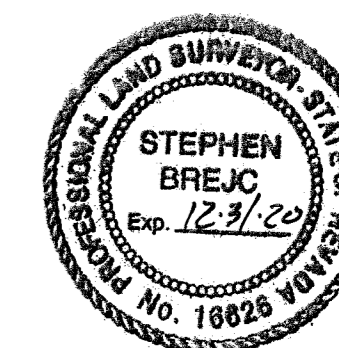

**RECORDER'S STATEMENT**

FILE NO. 2018-923435 FEE 27<sup>00</sup>  
FILED FOR RECORD AT THE REQUEST  
OF InSite Land Surveys, Inc.  
ON THIS 10 DAY OF Dec. 2018 AT 36  
MINUTES PAST 3 O'CLOCK P.M.  
OFFICIAL RECORDS OF DOUGLAS COUNTY, NEVADA.

DOUGLAS COUNTY RECORDER

BY: *Shawayne Laven*  
DEPUTY

**RECORD OF SURVEY  
FOR  
RYAN E. CURRY**

**OF THAT CERTAIN PARCEL DESCRIBED IN  
DOCUMENT NO. 2018-911436**

**BEING LOT 3, BLOCK 1, CAVE ROCK VILLAGE SUBDIVISION  
SITUATE IN THE NW 1/4 OF SECTION 34,  
TOWNSHIP 14 NORTH, RANGE 18 EAST, M.D.M.  
DOUGLAS COUNTY, NEVADA**

InSite Land Surveys  
P.O. Box 551085  
South Lake Tahoe, California 96155  
530-577-4815

SHEET 1 OF 1

FND RR SPIKE  
IN POSITION OF NDOT  
R/W MON. #3  
PER (R2)

N89°46'36"W (R3)  
N89°43'41"W (M)  
111.46' (R3,M)

FND 5/8" REBAR W/CAP  
PLS 21260  
(R3)

N89°43'41"W  
56.93' (M)

N89°43'41"W  
168.39' (M)

N89°46'36"W (R1,R2,R3)  
168.63' (R2)  
178.84' (R1)

N89°43'41"W  
33.95' (M)  
N89°46'36"W  
34.00' (R1)

FND SQUARE HEAD BOLT  
SET WIRE & TAG  
PLS 16626

N89°46'36"W (R3)  
N89°43'41"W (M)  
626.94' (R3,M)  
627.00' (R1)

FND 3/4" IRON PIPE  
W/PLUG PLS 3519  
(R3)

CAVE ROCK JUNCTION, LLC  
DOC. NO. 2017-894682

N89°46'36"W (R1,R2,R3)  
N89°43'41"W (M)  
829.28' (M,R3)  
839.84' (R1)

**LEGEND**

- FOUND 1/2" IRON PIPE OR AS NOTED
- SET 5/8" REBAR W/PLASTIC CAP PLS 16626 OR AS NOTED
- (M) MEASURED
- (R) RECORD

**REFERENCES**

- (R1) CAVE ROCK VILLAGE SUBDIVISION DOC. NO. 9223
- (R2) RECORD OF SURVEY DOC. NO. 240750
- (R3) MERGER AND RESUBDIVISION OF LAND DOC. NO. 2014-851411

**BASIS OF BEARINGS**

THE MERIDIAN OF THIS SURVEY IS IDENTICAL TO CAVE ROCK VILLAGE SUBDIVISION DOCUMENT NO. 9223 FILED IN THE OFFICE OF THE RECORDER OF DOUGLAS COUNTY, NEVADA, BEING N89°46'36"E AS SHOWN.