

DOUGLAS COUNTY, NV **2019-927119**
RPTT:\$0.00 Rec:\$35.00
\$35.00 Pgs=2 **03/27/2019 02:37 PM**
TICOR TITLE - GARDNERVILLE
KAREN ELLISON, RECORDER E03

WHEN RECORDED MAIL TO:

Jeremy Lyle Duby
Kim Meridyth Duby
2797 Davis Court

Minden, NV 89423

MAIL TAX STATEMENTS TO:

Jeremy Lyle Duby
2797 Davis Court

Minden, NV 89423

Escrow No. 1901141-RLT

The undersigned hereby affirms that this document submitted for recording does not contain the social security number of any person or persons.
(Pursuant to NRS 239b.030)

APN No.: 1420-35-101-008
R.P.T.T. \$ 0.00

SPACE ABOVE FOR RECORDER'S USE ONLY

GRANT, BARGAIN, SALE DEED

THIS INDENTURE WITNESSETH: That Jeremy L. Duby and Kim M. Duby, husband and wife as community with rights of survivorship

FOR A VALUABLE CONSIDERATION, receipt of which is hereby acknowledged, do/does hereby Grant, Bargain, Sell and Convey to Jeremy Lyle Duby and Kim Meridyth Duby husband and wife as community with rights of survivorship

all that real property situated in the County of Douglas, State of Nevada, described as follows:

SEE EXHIBIT "A" ATTACHED HERETO AND BY REFERENCE MADE A PART HEREOF

Together with all and singular the tenements, hereditaments and appurtenances thereunto belonging or in anywise appertaining.

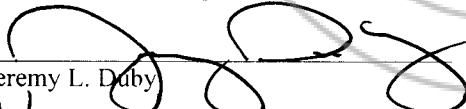

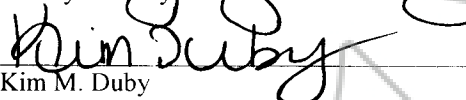
Jeremy L. Duby

Kim M. Duby

STATE OF NEVADA
COUNTY OF DOUGLAS

This instrument was acknowledged before me on ,
by Jeremy L. Duby and Kim M. Duby

} ss:
3/22/19

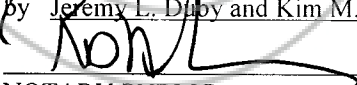

NOTARY PUBLIC

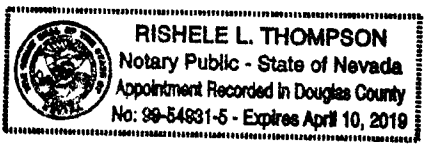

Escrow No. 1901141-RLT

**EXHIBIT A
LEGAL DESCRIPTION**

All that certain real property situate in the County of Douglas, State of Nevada, described as follows:

All that certain lot, piece or parcel of land situate in the Northwest 1/4 of the Northwest 1/4 of Section 35, Township 14 North, Range 20 East, M.D.B.&M., more particularly described as follows:

Parcel 2 of that certain parcel map for JAMES W. and RAMONA J. BARKER, recorded August 1, 1979 in Book 879 of Official Records at Page 002, Douglas County, Nevada, as Document No. 35054.

APN: 1420-35-101-008

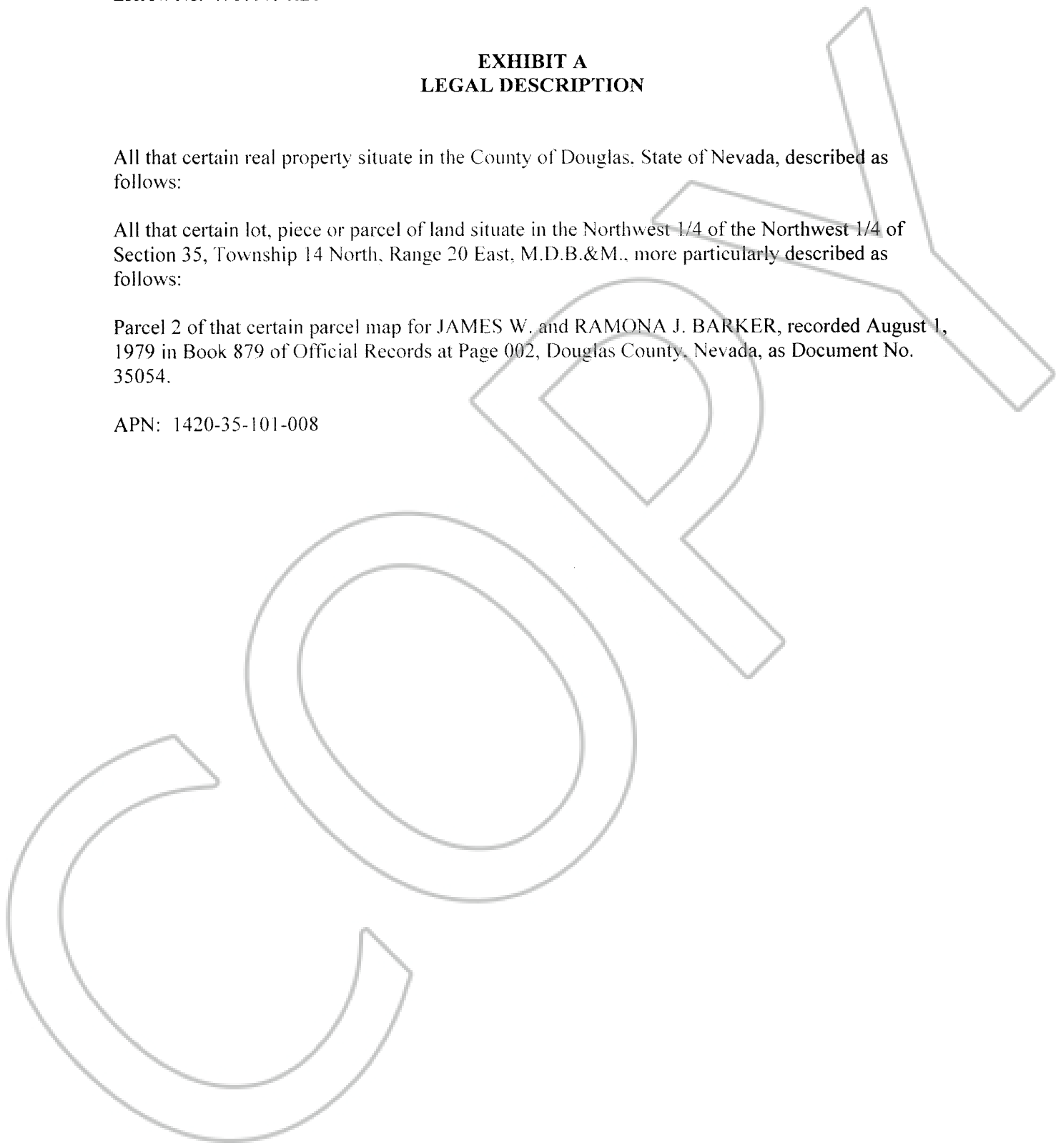

STATE OF NEVADA-DECLARATION OF VALUE FORM

1. Assessor Parcel Number(s)

- a) 1420-35-101-008
b)
c)
d)

2. Type of Property:

- a) [] Vacant Land b) [x] Single Fam. Res.
c) [] Condo/Twnhse d) [] 2-4 Plex
e) [] Apt. Bldg f) [] Comm'l/Ind'l
g) [] Agricultural h) [] Mobile Home
i) [] Other

FOR RECORDERS OPTIONAL USE ONLY
Book Page
Date of Recording:
Notes:

3. Total Value/Sales Price of Property:

Deed in Lieu of Foreclosure Only (value of property) \$ 0
Transfer Tax Value \$
Real Property Transfer Tax Due: \$ 0.00

4. If Exemption Claimed

- a. Transfer Tax Exemption, per NRS 375.090, Section 3
b. Explain Reason for Exemption: correcting vesting WITHOUT CONSIDERATION

5. Partial Interest: Percentage being transferred: %

The undersigned declares and acknowledges, under penalty of perjury, pursuant to NRS 375.060 and NRS 375.110, that the information provided is correct to the best of their information and belief, and can be supported by documentation if called upon to substantiate the information provided herein. Furthermore, the parties agree that disallowance of any claimed exemption, or other determination of additional tax due, may result in a penalty of 10% of the tax due plus interest at 1% per month. Pursuant to NRS 375.030, the Buyer and Seller shall be jointly and severally liable for any additional amount owed.

Signature Capacity
Signature Capacity

SELLER (GRANTOR) INFORMATION (REQUIRED)

BUYER (GRANTEE) INFORMATION (REQUIRED)

Print Name: Jeremy L. Duby and Kim M. Duby
Address: 2797 David Court
Minden, NV 89423
City, State, Zip

COMPANY/PERSON REQUESTING RECORDING (Required if not the Seller or Buyer)

Print Name: Ticor Title of Nevada, Inc. Escrow #: 1901141-RLT
Address: 1483 Highway 395 N, Suite B
City, State, Zip: Gardnerville, NV 89410