

DECLARATION OF HOMESTEAD

Assessor's Parcel Number (APN): 1321-29-002-014 or
Assessor's Manufactured Home ID Number: _____



KAREN ELLISON, RECORDER

Recording Requested by and Mail to:
Name: Bonita Paxson
Address: 1650 Carlson Drive
City/State/Zip: Gardnerville, NV 89410

Check One:

- Married (filing jointly) Married (filing individually)
- Widowed Single Person Multiple Single Persons Head of Family
- By Wife (filing for joint benefit of both) By Husband (filing for joint benefit of both)
- Other (describe): _____

Check One:

- Regular Home Dwelling/Manufactured Home Condominium Unit Other

Name on Title of Property:

Bonita Paxson

do individually or severally certify and declare as follows:

Bonita Paxson
is/are now residing on the land, premises (or manufactured home) located in the city/town of
Gardnerville, County of Douglas, State of Nevada, and
more particularly described as follows: (set forth legal description and commonly known street address
or manufactured home description)

See Exhibit A

I/We claim the land and premises hereinabove described, together with the dwelling house thereon, and
its appurtenances, or the described manufactured home as a Homestead.

In witness, Whereof, I/we have hereunto set my hand/our hands this 23 day of April, 2019.

Bonita Paxson _____
Signature Signature
Bonita Paxson _____
Print or type name here Print or type name here

STATE OF NEVADA, COUNTY OF Douglas This instrument was acknowledged
before me on 4-23-19

By Bonita Joy Paxson (date)
Person(s) appearing before notary

By _____
Person(s) appearing before notary
Jodi O. Stovall
Signature of notarial officer

Notary Seal

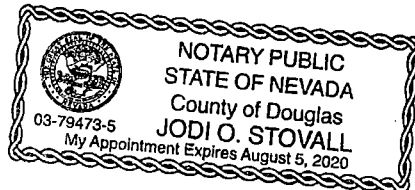

CONSULT AN ATTORNEY IF YOU DOUBT THIS FORM FITS YOUR PURPOSE.

NOTE: Do not write in 1-inch margin. Rev. Feb 2010

EXHIBIT A

Legal Description

The real property situate in the County of Douglas, State of Nevada, described as follows:

Being a point of the Northwest Quarter (NW1/4) of the Southeast Quarter (SE1/4) of Section 29, Township 13, North, Range 21 East, M.D.B. and M., further described as follows:

Parcel 4, as set forth on the Parcel Map for Robert E. and Pauline Fay Carlson, filed for record February 25, 1980, in Book 280, Page 1335, Document No. 41829, Official Records of Douglas County, State of Nevada.

APN: 1321-29-002-014

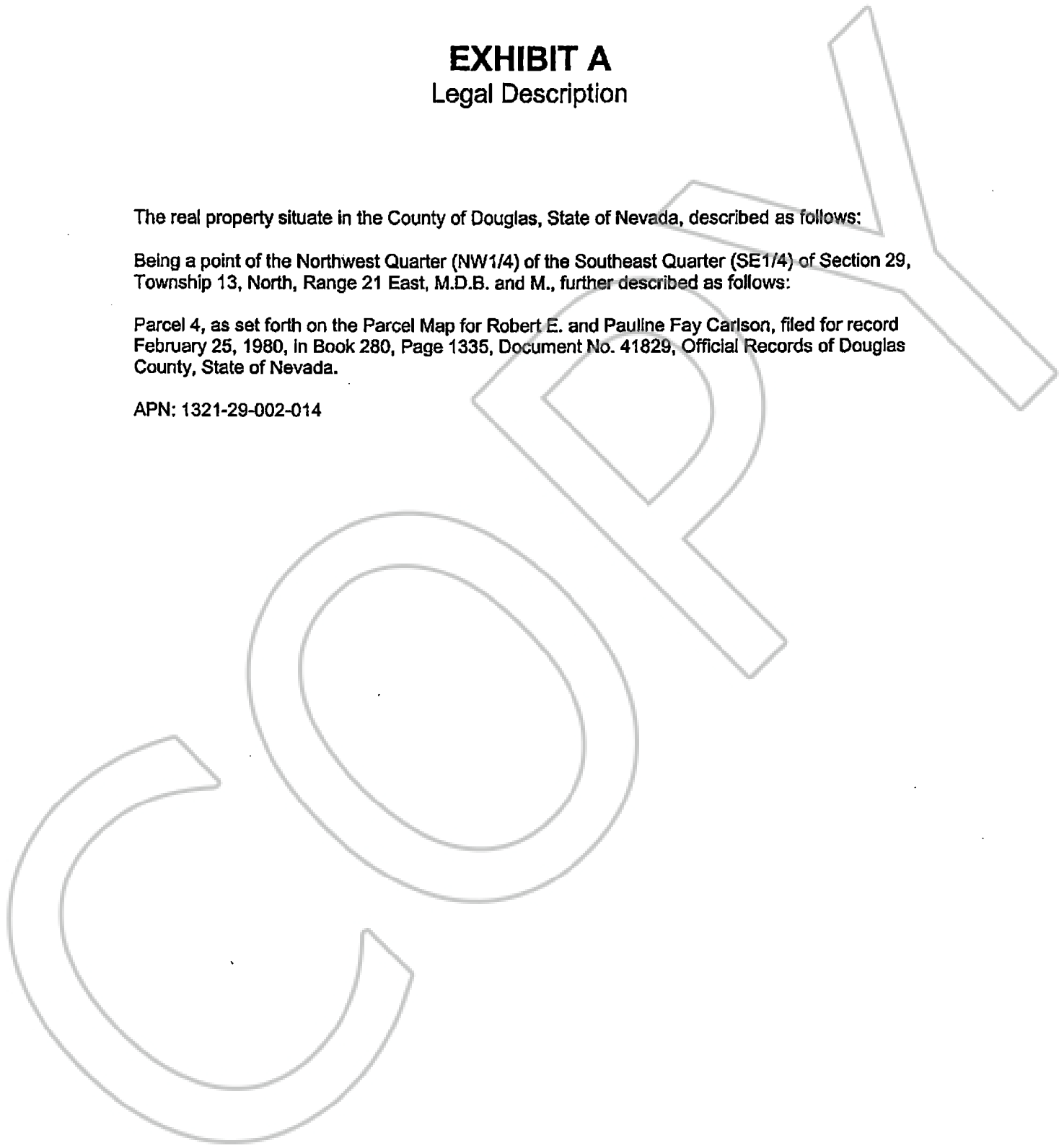

BK-408
PG-5893