

COMMUNITY DEVELOPMENT DEPARTMENT CERTIFICATE

IT IS HEREBY CERTIFIED THAT THIS BOUNDARY LINE ADJUSTMENT WAS PRESENTED TO THE DOUGLAS COUNTY COMMUNITY DEVELOPMENT DEPARTMENT AND WAS DULY APPROVED.

Steve Mason 4/25/19
 COMMUNITY DEVELOPMENT DEPARTMENT
 Steve Mason DATE

CLERK TREASURER'S CERTIFICATE

ALL PROPERTY TAXES FOR THE PARCELS SHOWN ON THIS MAP HAVE BEEN PAID IN FULL FOR THE FISCAL TAX YEAR. (A.P.N. 1321-33-001-014, 1321-33-002-001 & 002)

Heathley Lewis 4/29/19
 HEATHLEY LEWIS
 CLERK TREASURER DATE

OWNER'S CERTIFICATE

WE, THE UNDERSIGNED OWNERS OF THE AFFECTED PARCELS AS SHOWN ON THIS MAP, DO HEREBY STATE THAT:

- 1) WE HAVE EXAMINED THIS PLAT AND APPROVE AND AUTHORIZE ITS RECORDING;
- 2) WE AGREE TO EXECUTE THE REQUIRED DOCUMENTS CREATING ANY EASEMENT WHICH IS SHOWN HEREON;
- 3) WE AGREE TO EXECUTE THE REQUIRED DOCUMENTS ABANDONING ANY EXISTING EASEMENT PURSUANT TO THE PROVISIONS OF NRS 278.010 TO 278.630 INCLUSIVE;
- 4) ALL PROPERTY TAXES ON THE LAND FOR THE FISCAL YEAR HAVE BEEN PAID;
- 5) ANY LENDER WITH AN IMPOUND ACCOUNT FOR THE PAYMENT OF TAXES HAS BEEN NOTIFIED OF THE ADJUSTMENT OF THE BOUNDARY LINE OR THE TRANSFER OF THE LAND.

Michael Gilbert
 BY: MICHAEL GILBERT
 ITS: OWNER
 (A.P.N. 1321-33-002-001 & 1321-33-002-002)

STATE OF NEVADA
 COUNTY OF DOUGLAS

ON THIS 12 DAY OF April, IN THE YEAR 2019 BEFORE ME, A NOTARY PUBLIC, PERSONALLY APPEARED MICHAEL GILBERT, PERSONALLY KNOWN BY ME TO BE THE PERSON WHOSE NAME IS SUBSCRIBED TO THE ABOVE INSTRUMENT WHO ACKNOWLEDGED THAT HE EXECUTED THE SAME IN HIS AUTHORIZED CAPACITY AND THAT BY HIS SIGNATURE ON THE INSTRUMENT, THE PERSON, OR THE ENTITY ON BEHALF OF WHICH THE PERSONS ACTED, EXECUTED THE INSTRUMENT.

WITNESS MY HAND AND OFFICIAL SEAL:

Paul Gray
 NOTARY'S SIGNATURE

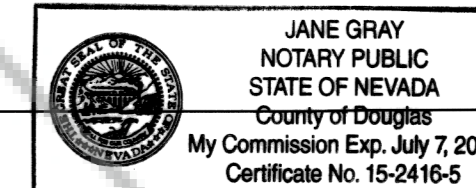

Russell Orrin
 BY: RUSSELL ORRIN
 TRUSTEE OF THE ORRIN-MOFFATT FAMILY TRUST
 (A.P.N. 1321-33-001-014)

Catherine E. Moffatt
 CATHERINE E. MOFFATT
 TRUSTEE OF THE ORRIN-MOFFATT FAMILY TRUST
 (A.P.N. 1321-33-001-014)

STATE OF NEVADA
 COUNTY OF DOUGLAS

ON THIS 12 DAY OF April, IN THE YEAR 2019 BEFORE ME, A NOTARY PUBLIC, PERSONALLY APPEARED RUSSELL L ORRIN & CATHERINE E. MOFFATT, PERSONALLY KNOWN BY ME TO BE THE PERSON WHOSE NAME IS SUBSCRIBED TO THE ABOVE INSTRUMENT WHO ACKNOWLEDGED THAT THEY EXECUTED THE SAME IN THEIR AUTHORIZED CAPACITY AND THAT BY THEIR SIGNATURES ON THE INSTRUMENT, THE PERSON, OR THE ENTITY ON BEHALF OF WHICH THE PERSONS ACTED, EXECUTED THE INSTRUMENT.

WITNESS MY HAND AND OFFICIAL SEAL:

Paul Gray
 NOTARY'S SIGNATURE

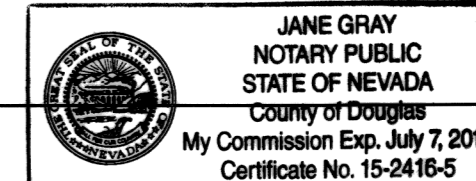

SURVEYOR'S CERTIFICATE

I, TODD A. ENKE, A PROFESSIONAL LAND SURVEYOR LICENSED IN THE STATE OF NEVADA, CERTIFY THAT:

- 1) A FIELD SURVEY OF THE BOUNDARIES OF THE AFFECTED PARCELS HAS BEEN PERFORMED BY ME OR UNDER MY SUPERVISION AT THE INSTANCE OF MICHAEL GILBERT & THE ORRIN-MOFFATT FAMILY TRUST.
- 2) THIS PLAT IS A TRUE AND ACCURATE REPRESENTATION OF THE LANDS SURVEYED.
- 3) ALL CORNERS AND ANGLE POINTS OF THE ADJUSTED BOUNDARY LINE HAVE BEEN SET AND THE MONUMENTS ARE OF THE CHARACTER SHOWN AND OCCUPY THE POSITIONS INDICATED AND ARE OF SUFFICIENT NUMBER AND DURABILITY TO ENABLE THIS SURVEY TO BE RETRACED.
- 4) THE LANDS SURVEYED LIE WITHIN A PORTION OF THE SW1/4 OF SECTION 33, TOWNSHIP 13 NORTH, RANGE 21 EAST, M.D.M., DOUGLAS COUNTY, NEVADA, AND THE SURVEY WAS COMPLETED ON FEBRUARY 7, 2019.
- 5) THIS PLAT IS NOT IN CONFLICT WITH THE PROVISIONS OF NRS 278.010 THROUGH NRS 278.630 INCLUSIVE AND COMPLIES WITH ALL APPLICABLE STATE STATUTES AND ANY LOCAL ORDINANCES.

TODD A. ENKE, P.L.S. 19734

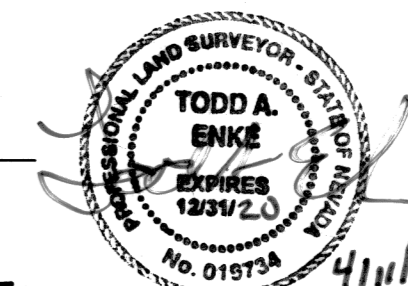

RECORDER'S CERTIFICATE

FILED FOR RECORD THIS 30th DAY OF April, 2019,
 AT 31 MINUTES PAST 11 O'CLOCK A.M., DOCUMENT NO. 2019-928463.
 RECORDED AT THE REQUEST OF MICHAEL GILBERT & THE ORRIN-MOFFATT FAMILY TRUST.

Karen Ellison
 KAREN ELLISON
 DOUGLAS COUNTY RECORDER

SCALE: 1" = 100'

SHEET 1 OF 1

**RECORD OF SURVEY
 TO
 SUPPORT A BOUNDARY LINE ADJUSTMENT**
 FOR
**MICHAEL GILBERT &
 THE ORRIN-MOFFATT FAMILY TRUST**

LOCATED WITHIN A PORTION OF THE SW1/4 OF SECTION
 33 TOWNSHIP 13 NORTH, RANGE 21 EAST, M.D.M.
 DOUGLAS COUNTY, NEVADA

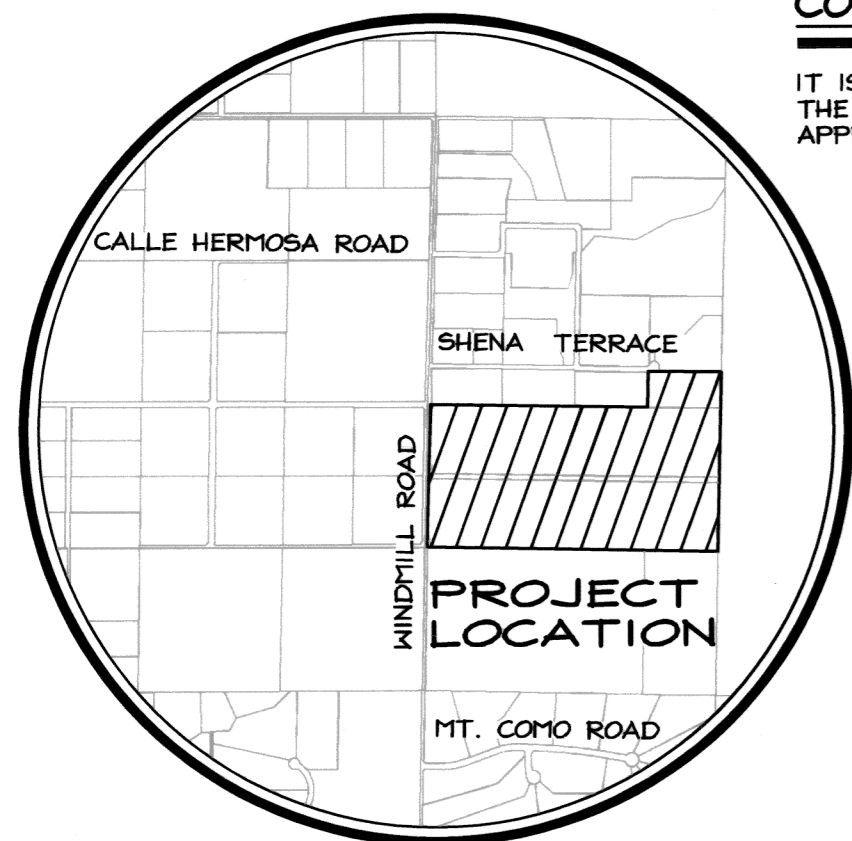

VICINITY MAP
 NO SCALE

ADJUSTED PARCEL A
 (A.P.N. 1321-33-002-001)
 29.95 AC.

ADJUSTED PARCEL B
 (A.P.N. 1321-33-002-002)
 29.97 AC.

ADJUSTED PARCEL C
 (A.P.N. 1321-33-001-014)
 25.05 AC.

BASIS OF BEARINGS

N01°14'36"E - THE SOUTH ONE-HALF (S1/2) OF THE NORTH-SOUTH CENTER SECTION LINE OF SECTION 33, T13N., R21E., M.D.M. AS SHOWN ON THE MAP OF DIVISION INTO LARGE PARCELS FOR RUTH H. JERDON (FINGAR), FILED FOR RECORD APRIL 5, 1983 IN THE OFFICE OF RECORDER, DOUGLAS COUNTY, NEVADA AS DOCUMENT NO. 78498 AS MEASURED ON THE NEVADA STATE PLANE COORDINATE SYSTEM, WEST ZONE NAD83(2011), SCALED TO GROUND BY THE COMBINED FACTOR OF 1.000194266.

LEGEND

- FOUND 5/8" REBAR & TAG, LS 1350
 - FOUND 5/8" REBAR, NO TAG, OR AS NOTED
 - FOUND 5/8" REBAR & CAP, PLS 3090
 - FOUND 1/2" IRON PIPE, RE 446
 - ⊗ FOUND BLM1 BRASS CAP, 1/4 CORNER
 - ▲ SET 5/8" REBAR & CAP, PLS 19734
 - ⊠ SET REBAR & CAP, PLS 19734 AT CALCULATED 1/4 CORNER
 - (C) CALCULATED POSITION
- (R1) PARCEL MAP FOR GEORGE E. MULLER, FILED FOR RECORD NOVEMBER 30, 1974 AS DOCUMENT NO. 39239.
 - (R2) MAP OF DIVISION INTO LARGE PARCELS FOR RUTH H. JERDON (FINGAR) FILED FOR RECORD APRIL 5, 1983 AS DOCUMENT NO. 78498.
 - (R3) RECORD OF SURVEY FOR STEVE JEZERCAC FILED FOR RECORD JULY 30, 1990 AS DOCUMENT NO. 445744.
 - (R4) RECORD OF SURVEY FOR PHIL & RHONDA FINGAR FILED FOR RECORD DECEMBER 13, 1997 AS DOCUMENT NO. 482444.
 - (R5) PARCEL MAP FOR SONJA M. SCOTT FILED FOR RECORD FEBRUARY 11, 1981 AS DOCUMENT NO. 53478.
 - (R6) RECORD OF SURVEY FOR WILLIAM & DIANE DUKE FILED FOR RECORD FEBRUARY 27, 1989 AS DOCUMENT NO. 19713.

NOTES

- THIS MAP REFERENCES THE MAP OF DIVISION INTO LARGE PARCELS FOR RUTH H. JERDON (FINGAR) FILED FOR RECORD APRIL 5, 1983 IN THE OFFICE OF THE DOUGLAS COUNTY RECORDER, NEVADA AS DOCUMENT NO. 78498.
- THESE PARCELS LIE WITHIN THE UNSHADED "X", "AE" FLOOD ZONES & "AE" FLOOD WAY PER FEMA PANEL MAP 32005C0254H, DATED JUNE 15, 2016. THE LOCATIONS OF FLOOD ZONES SHOWN HEREON ARE APPROXIMATE.
- ALL DISTANCES ARE MEASURED UNLESS OTHERWISE NOTED.
- THE 30' EASEMENT SHOWN ON RECORD OF SURVEY DOCUMENT NO. 19713 IS NOT SHOWN AS NO DOCUMENT CREATING EASEMENT WAS PROVIDED.
- THIS RECORD OF SURVEY IS TO SUPPORT THOSE CERTAIN DEEDS RECORDED IN OFFICIAL RECORDS OF DOUGLAS COUNTY, NEVADA AS
- DOCUMENT NO. 2019-928463; & DOCUMENT NO. N/A.
- & DOCUMENT NO. N/A.