

DOUGLAS COUNTY, NV

2019-931996

RPTT:\$772.20 Rec:\$35.00

\$807.20 Pgs=4

07/16/2019 11:45 AM

ETRCO

KAREN ELLISON, RECORDER

APN#: 1023-00-001-022
RPTT: \$772.20

Recording Requested By:
Western Title Company

Escrow No.: 103793-MLM

When Recorded Mail To:

Brad Aviles and
Katherine A. Aviles

15 Fairway Drive
Yerington, NV 89447

Mail Tax Statements to: (deeds only)
Same as Above

I the undersigned hereby affirm that the attached document, including any exhibits, hereby submitted for recording does not contain the social security number of any person or persons.

(Per NRS 239B.030)

Signature



Lynn Moore

Escrow Officer

Grant, Bargain, and Sale Deed

This page added to provide additional information required by NRS 111.312
(additional recording fee applies)

GRANT, BARGAIN AND SALE DEED

THIS INDENTURE WITNESSETH: That

FOR A VALUABLE CONSIDERATION, receipt of which is hereby acknowledged,

Gary G. Gregory and Rosemary A. Gregory, husband and wife

do(es) hereby GRANT(s) BARGAIN SELL and CONVEY to

Brad Aviles and Katherine A. Aviles, husband and wife as community property, with right of survivorship

and to the heirs and assigns of such Grantee forever, all the following real property situated in the City of Gardnerville, County of Douglas State of Nevada bounded and described as follows:

See attached Exhibit A

TOGETHER with all tenements, hereditaments and appurtenances, if any, thereto belonging or appertaining, and any reversions, remainders, rents, issues or profits thereof.

Dated: 06/18/2019

Gary G. Gregory
Gary G. Gregory

Rosemary A. Gregory
Rosemary A. Gregory

STATE OF OREGON

COUNTY OF CROOK } ss

This instrument was acknowledged before me on

6-27-2019

By Gary G. Gregory and Rosemary A. Gregory.

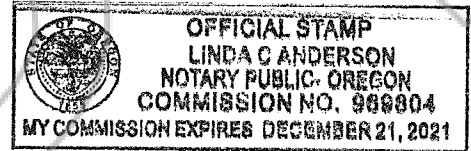

Linda C. Anderson
Notary Public

EXHIBIT "A"

All that certain real property situate in the County of Douglas, State of Nevada, described as follows:

A parcel of land located within a portion of the West one-half of Section 16, Township 10 North, Range 23 East MDM, Douglas County, Nevada, being more particularly described as follows:

Parcel 5 as shown on Land Division Map recorded in the office of the Douglas County Recorder, State of Nevada, on June 18, 2004 in Book 0604, Page 9079, as File No. 616422, Official Records, Douglas County, Nevada.

**Assessor's Parcel Number(s):
1023-00-001-022**

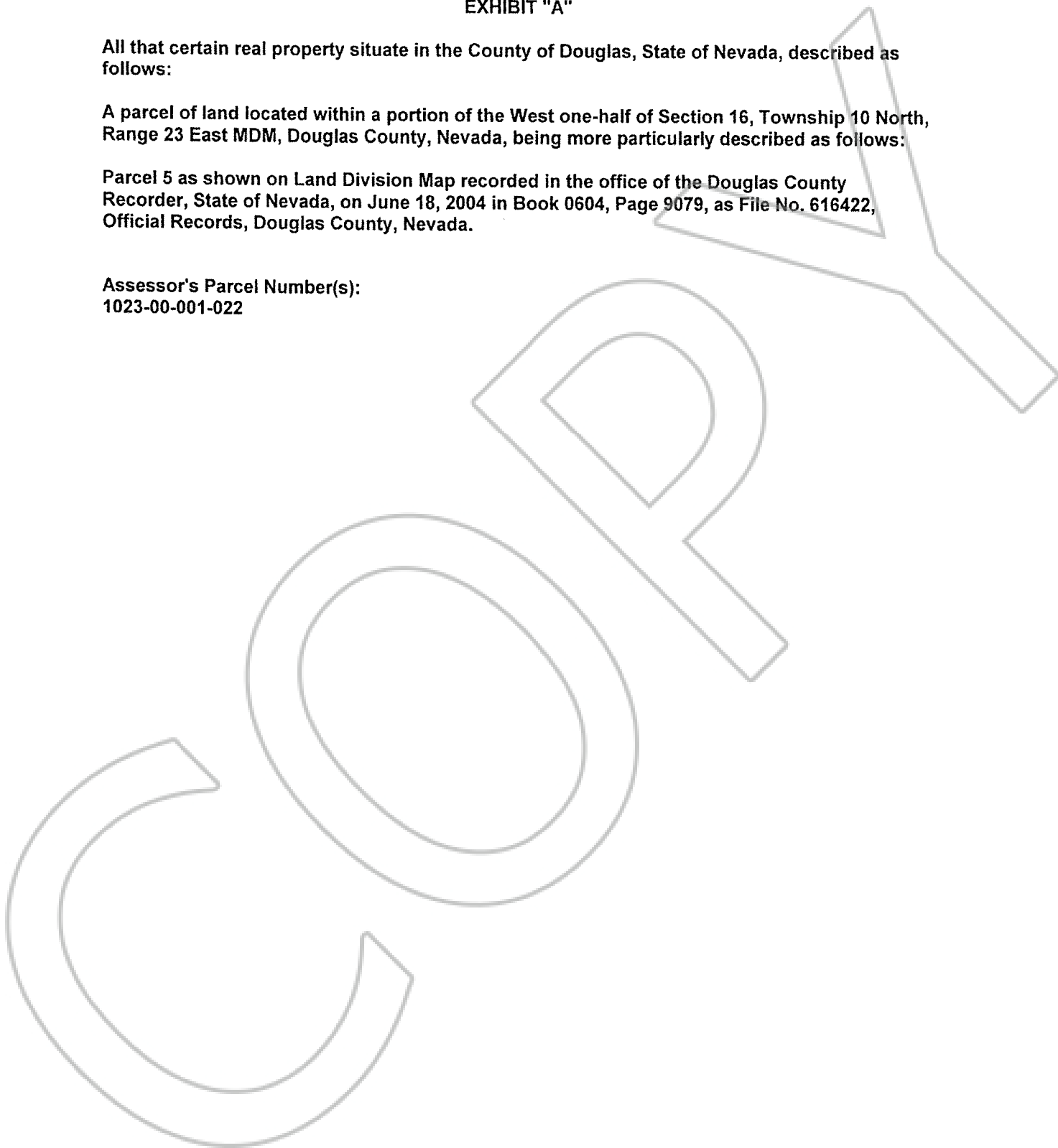

**STATE OF NEVADA
DECLARATION OF VALUE**

1. Assessors Parcel Number(s)
a) 1023-00-001-022

2. Type of Property:
 a) Vacant Land b) Single Fam. Res.
 c) Condo/Twnhse d) 2-4 Plex
 e) Apt. Bldg f) Comm'l/Ind'l
 g) Agricultural h) Mobile Home
 i) Other _____

FOR RECORDERS OPTIONAL USE ONLY
 NOTES: _____

3. Total Value/Sales Price of Property: \$198,000.00
 Deed in Lieu of Foreclosure Only (value of property) (
 Transfer Tax Value: \$198,000.00
 Real Property Transfer Tax Due: \$772.20

4. If Exemption Claimed:
 a. Transfer Tax Exemption per NRS 375.090, Section
 b. Explain Reason for Exemption:

5. Partial Interest: Percentage being transferred: 100 %

The undersigned declares and acknowledges, under penalty of perjury, pursuant to NRS 375.060 and NRS 375.110, that the information provided is correct to the best of their information and belief, and can be supported by documentation if called upon to substantiate the information provided herein. Furthermore, the parties agree that disallowance of any claimed exemption, or other determination of additional tax due, may result in a penalty of 10% of the tax due plus interest at 1% per month.

Pursuant to NRS 375.030, the Buyer and Seller shall be jointly and severally liable for any additional amount owed.

Signature [Signature] Capacity Escrow Agent
 Signature [Signature] Capacity Escrow Agent

**SELLER (GRANTOR) INFORMATION
(REQUIRED)**
 Print Name: Gary G. Gregory and Rosemary A. Gregory
 Address: 3761 Cherokee Road
 City: Prineville
 State: OR Zip: 97754

**BUYER (GRANTEE) INFORMATION
(REQUIRED)**
 Print Name: Brad Aviles and Katherine A. Aviles
 Address: 15 Fairway Drive
 City: Yerington
 State: NV Zip: 89447

COMPANY/PERSON REQUESTING RECORDING
 (required if not the seller or buyer)

Print Name: eTRCo, LLC. On behalf of Western Title Company
 Address: Kietzke Office
 5390 Kietzke Ln Suite 101
 City/State/Zip: Reno, NV 89511

Esc. #: 103793-MLM

(AS A PUBLIC RECORD THIS FORM MAY BE RECORDED/MICROFILMED)