

1320-30-802-030 (a portion of)

DOUGLAS COUNTY, NV **2019-932351**
Rec:\$90.00
\$90.00 Pgs=5 **07/22/2019 08:46 AM**
CORPORATION SERVICE COMPANY (UCC)
KAREN ELLISON, RECORDER

UCC FINANCING STATEMENT

FOLLOW INSTRUCTIONS

A. NAME & PHONE OF CONTACT AT FILER (optional) CSC 1-800-858-5294
B. E-MAIL CONTACT AT FILER (optional) SPRFiling@cscglobal.com
C. SEND ACKNOWLEDGMENT TO: (Name and Address) 1671 78765 - 7/19/2019 CSC 801 Adlai Stevenson Drive Springfield, IL 62703

Filed In: Nevada
(Douglas)

THE ABOVE SPACE IS FOR FILING OFFICE USE ONLY

1. DEBTOR'S NAME: Provide only one Debtor name (1a or 1b) (use exact, full name; do not omit, modify, or abbreviate any part of the Debtor's name); if any part of the Individual Debtor's name will not fit in line 1b, leave all of item 1 blank, check here and provide the Individual Debtor information in item 10 of the Financing Statement Addendum (Form UCC1Ad)

1a. ORGANIZATION'S NAME NV Bean L.L.C.				
OR	1b. INDIVIDUAL'S SURNAME	FIRST PERSONAL NAME	ADDITIONAL NAME(S)/INITIAL(S)	SUFFIX
1c. MAILING ADDRESS	3550 Barron Way Ste 5A	CITY Reno	STATE NV	POSTAL CODE 89511
				COUNTRY USA

2. DEBTOR'S NAME: Provide only one Debtor name (2a or 2b) (use exact, full name; do not omit, modify, or abbreviate any part of the Debtor's name); if any part of the Individual Debtor's name will not fit in line 2b, leave all of item 2 blank, check here and provide the Individual Debtor information in item 10 of the Financing Statement Addendum (Form UCC1Ad)

2a. ORGANIZATION'S NAME				
OR	2b. INDIVIDUAL'S SURNAME	FIRST PERSONAL NAME	ADDITIONAL NAME(S)/INITIAL(S)	SUFFIX
2c. MAILING ADDRESS		CITY	STATE	POSTAL CODE
				COUNTRY

3. SECURED PARTY'S NAME (or NAME of ASSIGNEE of ASSIGNOR SECURED PARTY): Provide only one Secured Party name (3a or 3b)

3a. ORGANIZATION'S NAME Meadows Bank				
OR	3b. INDIVIDUAL'S SURNAME	FIRST PERSONAL NAME	ADDITIONAL NAME(S)/INITIAL(S)	SUFFIX
3c. MAILING ADDRESS	6518 South McCarran Blvd.	CITY Reno	STATE NV	POSTAL CODE 89509-6112
				COUNTRY USA

4. COLLATERAL: This financing statement covers the following collateral:
All fixtures; all attachments, accessions, accessories, fittings, increases, tools, parts, repairs, supplies, and commingled goods relating to the foregoing property, and all additions, replacements of and substitutions for all or any part of the foregoing property; all insurance refunds relating to the foregoing property; all records and data and embedded software relating to the foregoing property, and all equipment, inventory and software to utilize, create, maintain and process any such records and data on electronic media; whether now owned or hereafter acquired or whether now or hereafter subject to any rights in the foregoing property; and all products and proceeds (including but not limited to all insurance payments) of or relating to the foregoing property. Collateral is affixed to the real property commonly known as 1652 North Highway 395, Minden, NV 89423 (a portion of APN #1320-30-802-030). Collateral is more described and real property is legally described in Exhibit "A" attached hereto and made a part hereof by this reference. The record owner of the real property is 1652 Hwy 395 Minden RE-1, LLC.

5. Check only if applicable and check only one box: Collateral is held in a Trust (see UCC1Ad, item 17 and Instructions) being administered by a Decedent's Personal Representative

6a. Check only if applicable and check only one box:
 Public-Finance Transaction Manufactured-Home Transaction A Debtor is a Transmitting Utility

6b. Check only if applicable and check only one box:
 Agricultural Lien Non-UCC Filing

7. ALTERNATIVE DESIGNATION (if applicable): Lessee/Lessor Consignee/Consignor Seller/Buyer Bailee/Bailor Licensee/Licensor

8. OPTIONAL FILER REFERENCE DATA: :jh-12937 (2)

1671 78765

UCC FINANCING STATEMENT ADDENDUM

FOLLOW INSTRUCTIONS

9. NAME OF FIRST DEBTOR: Same as line 1a or 1b on Financing Statement; if line 1b was left blank because Individual Debtor name did not fit, check here

9a. ORGANIZATION'S NAME

NV Bean L.L.C.

OR
9b. INDIVIDUAL'S SURNAME

FIRST PERSONAL NAME

ADDITIONAL NAME(S)/INITIAL(S)

SUFFIX

THE ABOVE SPACE IS FOR FILING OFFICE USE ONLY

10. DEBTOR'S NAME: Provide (10a or 10b) only one additional Debtor name or Debtor name that did not fit in line 1b or 2b of the Financing Statement (Form UCC1) (use exact, full name; do not omit, modify, or abbreviate any part of the Debtor's name) and enter the mailing address in line 10c

10a. ORGANIZATION'S NAME

OR
10b. INDIVIDUAL'S SURNAME

INDIVIDUAL'S FIRST PERSONAL NAME

INDIVIDUAL'S ADDITIONAL NAME(S)/INITIAL(S)

SUFFIX

10c. MAILING ADDRESS

CITY

STATE

POSTAL CODE

COUNTRY

11. ADDITIONAL SECURED PARTY'S NAME or ASSIGNOR SECURED PARTY'S NAME: Provide only one name (11a or 11b)

11a. ORGANIZATION'S NAME

OR
11b. INDIVIDUAL'S SURNAME

FIRST PERSONAL NAME

ADDITIONAL NAME(S)/INITIAL(S)

SUFFIX

11c. MAILING ADDRESS

CITY

STATE

POSTAL CODE

COUNTRY

12. ADDITIONAL SPACE FOR ITEM 4 (Collateral):

13. This FINANCING STATEMENT is to be filed [for record] (or recorded) in the REAL ESTATE RECORDS (if applicable)

14. This FINANCING STATEMENT:

covers timber to be cut covers as-extracted collateral is filed as a fixture filing

15. Name and address of a RECORD OWNER of real estate described in item 16 (if Debtor does not have a record interest):

1652 Hwy 395 Minden RE-1, LLC
1033 University Terrace
Reno NV 89503

16. Description of real estate:

17. MISCELLANEOUS:

Exhibit "A"

All that certain real property situated in the County of **Douglas**, State of **Nevada**, described as follows:

All that real property situate in the Southeast quarter of Section 30, Township 13 North, Range 20 East, M.D.B. & M., Douglas County, Nevada, described as follows:

Parcel 3, as set forth on Parcel Map for Bank Building, Inc., filed for record in the Office of the County Recorder of Douglas County, State of Nevada on November 25, 1991, in Book 1191, Page 4010, as Document No. 265804.

Reference is made to Record of Survey recorded March 20, 2003, in Book 303, Page 8642, as Document No. 570468.

Excepting therefrom that portion conveyed to Douglas County, Nevada by certain Grant, Bargain and Sale Deed recorded August 15, 2007 under recording number 707524 in the Office of the County Recorder of Douglas County, Nevada, more particularly described as follows:

That portion of the Southeast quarter of Section 30, Township 13 North, Range 20 East, M.D.B. & M., in the County of Douglas, State of Nevada, being more particularly described as follows:

The Northwesterly 30.00 feet of Parcel 3 as said parcel is shown on the parcel map for Bank Building, Inc., recorded in Book 1191 at Page 4010, as Document No. 265804 in the Official Records of said Douglas County.

Further Excepting therefrom that portion conveyed to Douglas County, Nevada by certain Grant, Bargain and Sale Deed recorded October 16, 2015 under recording number 2015-871347 in the Office of the County Recorder of Douglas County, Nevada, more particularly described as follows:

A parcel of land for public road right-of-way purposes located within a portion of Section 30, Township 13 North, Range 20 East, Mount Diablo Meridian, more particularly described as follows:

Commencing at the northerly corner of the NVBP Three, Ltd. Parcel as shown on the Record of Survey for MTEB, LLC and NVBP Three, Ltd. Filed for record March 20, 2003 in the office of Recorder, Douglas County, Nevada as Document No. 570468, said point also falling on the westerly line of U.S. Highway 395;

Thence along said westerly line of U.S. Highway 395, South 63°25'00" East, 30.00 feet, the Point of Beginning;

Thence continuing along said Westerly line of U.S. Highway 395, South 63°25'00" East, 45.00 feet;

Thence along the arc of a curve to the left, non-tangent to the preceding course, having a radius of 45.00 feet, central angle of 89°59'59", arc length of 70.69 feet, chord bearing of South 71°35'00" West, chord distance of 63.64 feet;

Thence North 26°35'00" East, 45.00 feet to the Point of Beginning.

NOTE: Said legal description was previously recorded in Grant, Bargain and Sale Deed recorded February 13, 2015, as Document No. 2015-856850 and Grant, Bargain, Sale Deed recorded October 16, 2015, as Document No. 2015-871347, Official Records, Douglas County, Nevada.

APN: 1320-30-802-030 (a portion of)- Human Bean located on 1652 North Highway 395 Minden, NV 89423

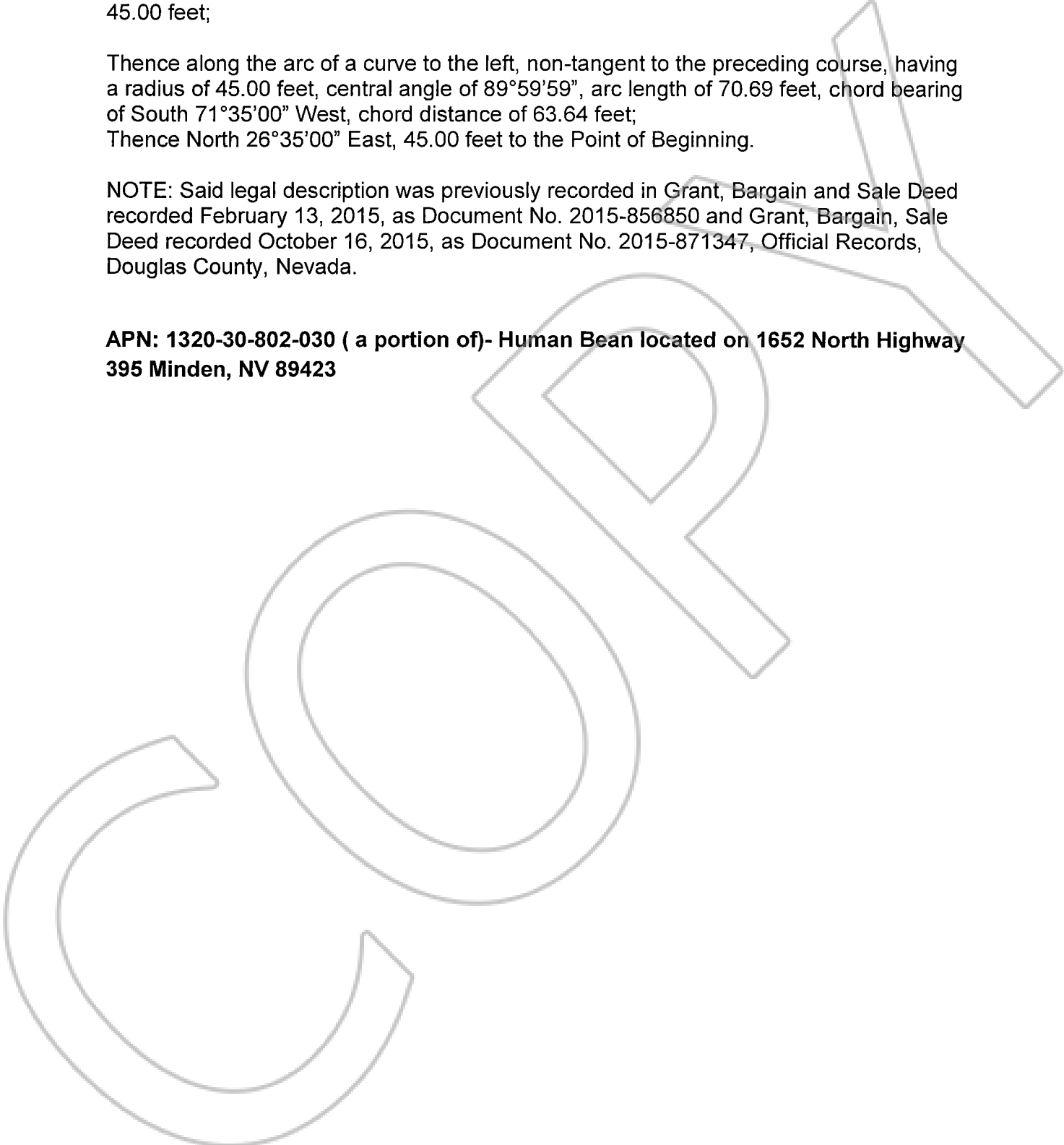

Human Bean Style

13 x 36 PRE-FAB BUILDING

SHELL CONSTRUCTION

- Structural Steel Foundation Frame
- Floor Framing and Sheathing
- Headers, Blocking, Backing & Nailers
- Storefront Window System w/3 Serving Windows
- Insulation
- All Rough Plumbing
- All Rough Electrical
- Durolast Membrane Roofing
- All Low Voltage Rough Wiring
- Stainless Exterior Serving Trays
- Heavy Duty Steel Exterior Door
- Roof Parapet Framing
- Commercial Grade Triple Sink
- Hand Wash Sink (1)
- Mop Sink
- Floor Sinks
- High Efficiency LED Light Fixtures

MISCELLANEOUS

- Building Drawings
- Foundation Drawings
- Building Set Package (Foundation Excluded)
- Shipping Prep
- Flat Metal Awnings -3
- Towers

FINISH CONSTRUCTION

- Gypsum Wallboard, Fire taped
- FRP Installed on all Walls T-Bar
- Altro Commercial Grade Flooring Covered 6"
- P Lam Cabinetry
- Joint Sealing & Caulking
- Wood Core Restroom Door
- Electrical and Plumbing Trim Out
- Stainless Steel Counters
- Stucco

EXCLUDED ITEMS

- All Site Work, Foundation Work & Permits
- Cameras & POS Systems
- Shipping & Crane Service
- Stone
- Signs

EQUIPMENT

- Daiken Split System HVAC 3 ton (Std is 1.5 ton)
- 30 Gallon Water Heater
- 5' x 8' Walk -In Cooler
- Pre-Wire for Speakers/Cameras

FIXTURES

- ADA Toilet
 - ADA Lav Sink
 - ADA Grab Bars
 - Restroom Mirrors
 - Restroom Accessories
-