

VICINITY MAP
NO SCALE

SURVEYOR'S CERTIFICATE

I, TODD A. ENKE, A PROFESSIONAL LAND SURVEYOR, LICENSED IN THE STATE OF NEVADA, AS AN AGENT FOR RESOURCE CONCEPTS, INC, DO HEREBY CERTIFY THAT:

1. THIS PLAT REPRESENTS THE RESULTS OF A SURVEY CONDUCTED UNDER MY DIRECT SUPERVISION AT THE INSTANCE OF BRENDAN RILEY & MAGGIE TRACEY.
2. THE LANDS SURVEYED LIE WITHIN A PORTION OF SECTION 9, T.13N., R.18E., M.D.M, DOUGLAS COUNTY NEVADA AND THE SURVEY WAS COMPLETED ON JUNE 18, 2019.
3. THIS PLAT COMPLIES WITH THE APPLICABLE STATE STATUTES AND ANY LOCAL ORDINANCES IN EFFECT ON THE DATE THAT THE SURVEY WAS COMPLETED.
4. THE MONUMENTS DEPICTED ON THE PLAT ARE OF THE CHARACTER SHOWN, OCCUPY THE POSITIONS INDICATED, AND ARE OF SUFFICIENT DURABILITY.
5. THIS SURVEY WAS CONDUCTED IN ACCORDANCE WITH CHAPTER 625 OF THE NEVADA ADMINISTRATIVE CODE AND MEETS THE POSITIONAL CERTAINTY FOR A HIGH URBAN LAND BOUNDARY SURVEY.
6. THIS RECORD OF SURVEY IS NOT IN CONFLICT WITH N.R.S. 625.340 AND NO NEW LOTS ARE BEING CREATED

TODD A. ENKE, PLS 19734

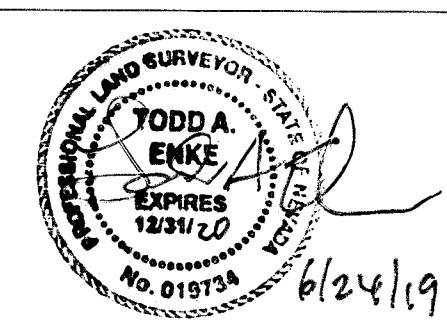

COUNTY RECORDER'S CERTIFICATE

FILED THIS 29th DAY OF July, 2019 AT 46 MINUTES PAST 3 O'CLOCK P.M.,
AS DOCUMENT NUMBER 2019-932720. RECORDED AT THE REQUEST OF Resource Concepts Inc.

M. Brantner, Deputy
DOUGLAS COUNTY RECORDER

REFERENCE DOCUMENTS:

(R1) AMENDED MAP OF SUBDIVISION NO. 2 OF ZEPHYR COVE PROPERTIES INC. FILED FOR RECORD AUGUST 5, 1929 IN THE OFFICE OF DOUGLAS COUNTY RECORDER AS DOCUMENT NO. 000267.

NOTES:

1. NO TITLE REPORT WAS PROVIDED BY CLIENT FOR SURVEY. INFORMATION SHOWN IS PER RECORD INFORMATION.
2. TOTAL AREA SURVEYED IS 4,000 sq.ft.

LEGEND

- FOUND 3/4" IRON PIPE & CAP RLS 3519
- ⦿ FOUND POINT AS NOTED
- SET MAG NAIL & TAG PLS 19734

BASIS OF BEARINGS

NORTH 00°36'00" WEST - THE EASTERLY RIGHT-OF-WAY OF FREIL DRIVE AS SHOWN ON THE AMENDED MAP OF SUBDIVISION NO. 2 OF ZEPHYR COVE PROPERTIES, INC. FILED FOR RECORD AUGUST 5, 1929 IN THE OFFICE OF DOUGLAS COUNTY RECORDER AS DOCUMENT NO. 000267.

Carson City
340 N. Minnesota St.
Carson City, NV 89709-4152
775-583-1600

Zephyr Cove
212 Ems Point Rd., Ste. 443
Zephyr Cove, NV 89404-6020
775-589-7500

**Engineering • Surveying • Water Rights
Resources & Environmental Services**

www.rci-nv.com

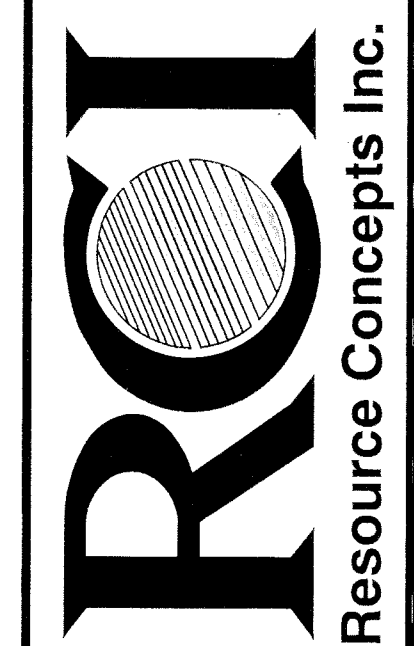

JOB NO.	19-218.2
DATE	06-24-19
DRAWN	TAE
CHECKED	TAE

SHEET 1 OF 1

RECORD OF SURVEY
FOR
BRENDAN RILEY & MARGARET TRACEY

APN 1318-09-812-006

LOCATED WITHIN A PORTION OF
SECTION 9, T.13N., R.18E., M.D.M.
DOUGLAS COUNTY, NEVADA