

**SURVEYOR'S CERTIFICATE**

I, TODD A. ENKE, A PROFESSIONAL LAND SURVEYOR, LICENSED IN THE STATE OF NEVADA, AS AN AGENT FOR RESOURCE CONCEPTS, INC. DO HEREBY CERTIFY THAT:

1. THIS PLAT REPRESENTS THE RESULTS OF A SURVEY CONDUCTED UNDER MY DIRECT SUPERVISION AT THE INSTANCE OF JAMES CZAJKOWSKI & DAVID SYLVIAN-CZAJKOWSKI.
2. THE LANDS SURVEYED LIE WITHIN A PORTION OF SECTION 27, T.14N., R.18E., M.D.M. DOUGLAS COUNTY NEVADA AND THE SURVEY WAS COMPLETED ON SEPTEMBER 18, 2019.
3. THIS PLAT COMPLIES WITH THE APPLICABLE STATE STATUTES AND ANY LOCAL ORDINANCES IN EFFECT ON THE DATE THAT THE SURVEY WAS COMPLETED.
4. THE MONUMENTS DEPICTED ON THE PLAT ARE OF THE CHARACTER SHOWN, OCCUPY THE POSITIONS INDICATED, AND ARE OF SUFFICIENT DURABILITY.
5. THIS SURVEY WAS CONDUCTED IN ACCORDANCE WITH CHAPTER 625 OF THE NEVADA ADMINISTRATIVE CODE AND MEETS THE POSITIONAL CERTAINTY FOR A HIGH URBAN LAND BOUNDARY SURVEY.
6. THIS RECORD OF SURVEY IS NOT IN CONFLICT WITH N.R.S. 625.340 AND NO NEW LOTS ARE BEING CREATED

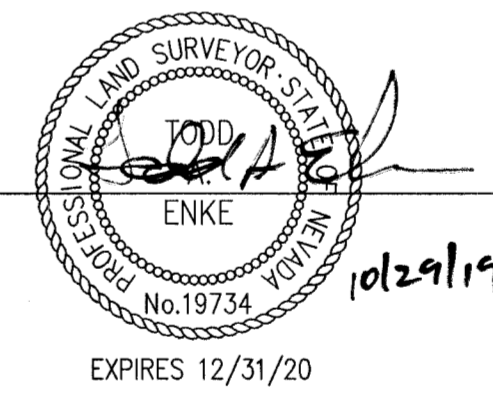

TODD A. ENKE, PLS 19734

**COUNTY RECORDER'S CERTIFICATE**

FILED THIS 29<sup>th</sup> DAY OF October, 2019 AT 58 MINUTES PAST 10 O'CLOCK A.M., AS DOCUMENT NUMBER 2019-937270. RECORDED AT THE REQUEST OF RCI.

*Karen Ellison*  
DOUGLAS COUNTY RECORDER - *Karen Ellison*

**LEGEND**

- FOUND MONUMENT AS NOTED
- ▲ FOUND 5/8" REBAR WITH YPC, PLS 6497
- FOUND CONCRETE NAIL WITH TAG, PLS 3519
- FOUND PREVIOUSLY PER NOTE 1, NOT FOUND AND/OR NOT SEARCHED FOR THIS SURVEY
- SET WITNESS CORNER, 5/8" REBAR WITH TAG, PLS 19734, OFFSET TO HIGH WATER LINE
- DIMENSION POINT, NOTHING FOUND OR SET
- LOT LINES AND NUMBERS PER DOC. NO. 3331, SEE REFERENCE #3
- - - APPROXIMATE LOW WATER LINE, PER THIS SURVEY
- LOT LINES PER DOC. NO. 3331, SEE REFERENCE #3

**BASIS OF BEARINGS**

FOUND MONUMENTS AS NOTATED HEREON ALONG THE SOUTHEASTERLY BOUNDARY LINE OF PITTMAN TERRACE, AS SHOWN ON RECORD OF SURVEY MAP FOR TOM YTURBIDE, RECORDED AUGUST 28, 1989 AS DOCUMENT NO. 209569, OFFICIAL RECORDS OF DOUGLAS COUNTY, NEVADA. (S 59°59'00" W)

**REFERENCE DOCUMENTS:**

- (1) RECORD OF SURVEY MAP FOR TOM YTURBIDE, RECORDED AUGUST 28, 1989 AS DOCUMENT NO. 209569, OFFICIAL RECORDS OF DOUGLAS COUNTY, NEVADA.
- (2) CERTIFICATE OF AMENDMENT, DOCUMENT NO. 354072, OFFICIAL RECORDS.
- (3) MAP OF SUBDIVISION NO. 1, CAVEROCK COVE, LTD. TRACT, DOCUMENT NO. 3331, OFFICIAL RECORDS
- (4) DEED DOCUMENT NO. 1987-157156, OFFICIAL RECORDS.

**NOTES:**

1. BOUNDARY PER UNRECORDED BOUNDARY SURVEY IN 2004 BY RESOURCE CONCEPTS, INC., REFERENCING THE RECORD OF SURVEY MAP FOR TOM YTURBIDE, RECORDED AUGUST 28, 1989 AS DOCUMENT NO. 209569, WITH CERTIFICATE OF AMENDMENT, DOCUMENT NO. 354072, OFFICIAL RECORDS OF DOUGLAS COUNTY, NEVADA.
- 1A. THE MAP OF SUBDIVISION NO. 1, CAVEROCK COVE, LTD. TRACT, DOCUMENT NO. 3331, OFFICIAL RECORDS, DOES NOT MATHEMATICALLY CLOSE. BEARINGS AND DISTANCES FOR MANY OF SAID PROPERTIES WERE PRORATED TO REFLECT THE EXISTING MONUMENTS AND SITE CONDITIONS.
2. THE LEGAL LIMIT OF PRIVATE OWNERSHIP ON LAKE TAHOE FRONTAGE EXTENDS TO ELEVATION 6223 FEET ABOVE MEAN SEA LEVEL WHICH IS LOW WATER MARK PER N.R.S. 321.595.
3. TOTAL AREA SURVEYED IS 19,229 sq.ft.

**Carson City**  
340 N. Minnesota St.  
Carson City, NV 89703-4152  
775-883-1600

**Lake Tahoe**  
276 Kingsbury Grade, Ste. 206  
Stateline, NV 89449  
775-588-7500

**Engineering • Surveying • Water Rights  
Resources • Environmental Services**

www.rci-nv.com



JOB NO.	19-281.2
DATE	10/07/2019
DRAWN	CNJ
CHECKED	TAE

SHEET 1 OF 1

**RECORD OF SURVEY**  
FOR  
**JAMES CZAJKOWSKI & DAVID SYLVIAN-CZAJKOWSKI**  
APN: 1418-27-210-014  
LOCATED WITHIN A PORTION OF SECTION 27, T.14N., R.18E., M.D.M. DOUGLAS COUNTY, NEVADA