

DOUGLAS COUNTY, NV **2019-940147**  
RPTT:\$1521.00 Rec:\$35.00  
\$1,556.00 Pgs=4 12/24/2019 12:10 PM  
TICOR TITLE - GARDNERVILLE  
KAREN ELLISON, RECORDER

**WHEN RECORDED MAIL TO:**

Gary Lee Frankforter  
Jill D. Frankforter  
842 Mahogany Drive

Minden, NV 89423

**MAIL TAX STATEMENTS TO:**

Gary Lee Frankforter  
842 Mahogany Drive

Minden, NV 89423

Escrow No. 1906933-RLT

The undersigned hereby affirms that this document submitted for recording does not contain the social security number of any person or persons.  
(Pursuant to NRS 239b.030)

APN No.: 1320-30-211-022  
R.P.T.T. \$1,521.00

SPACE ABOVE FOR RECORDER'S USE ONLY

**GRANT, BARGAIN, SALE DEED**

**THIS INDENTURE WITNESSETH:** That Joan Marie Schiavo, Successor Trustee of the Butler Family Trust Agreement dated July 29, 1992. and Christine Conkling Successor Trustee of the Adelheid A. Butler Trust dated May 27, 2011.

**FOR A VALUABLE CONSIDERATION,** receipt of which is hereby acknowledged, do/does hereby Grant, Bargain, Sell and Convey to Gary Lee Frankforter and Jill D. Frankforter, Husband and Wife, as joint tenants

all that real property situated in the County of Douglas, State of Nevada, described as follows:  
**SEE EXHIBIT "A" ATTACHED HERETO AND BY REFERENCE MADE A PART HEREOF**

Together with all and singular the tenements, hereditaments and appurtenances thereunto belonging or in anywise appertaining.

**SIGNED IN COUNTERPART**

Joan Marie Schiavo, Successor Trustee of  
the Butler Family Trust Agreement dated  
July 29, 1992.

Christine Conkling Successor Trustee of the  
Adelheid A. Butler Trust dated May 27, 2011.

\_\_\_\_\_  
Joan Marie Schiavo, Successor Trustee.

*Christine Conkling*  
\_\_\_\_\_  
Christine Conkling Successor Trustee

STATE OF *Michigan*  
COUNTY OF *Oakland*

} ss:

This instrument was acknowledged before me on , *12-21-2019*  
by *Joan Marie Schiavo, Successor Trustee of the Butler Family Trust Agreement dated July 29, 1992 and*  
*Christine Conkling Successor Trustee of the Adelheid A. Butler Trust dated May 27, 2011.*

*Elaine J. Jinkins*  
\_\_\_\_\_  
NOTARY PUBLIC

ELAINE JINKINS  
Notary Public - State of Michigan  
County of Wayne  
My Commission Expires May 19, 2024  
Acting in the County of *Oakland*

Joan Marie Schiavo, Successor Trustee of  
the Butler Family Trust Agreement dated  
July 29, 1992.

Christine Conkling Successor Trustee of the  
Adelheid A. Butler Trust dated May 27, 2011.

Joan Marie Schiavo  
Joan Marie Schiavo, Successor Trustee.

\_\_\_\_\_  
Christine Conkling Successor Trustee

STATE OF Colorado  
COUNTY OF Larimer

} ss:

This instrument was acknowledged before me on , December 23, 2019  
by Joan Marie Schiavo, Successor Trustee of the Butler Family Trust Agreement dated July 29, 1992. and  
~~Christine Conkling Successor Trustee of the Adelheid A. Butler Trust dated May 27, 2011.~~ SP 12/23/19

Shirley Preuit  
NOTARY PUBLIC

SHIRLEY PREUIT  
NOTARY PUBLIC - STATE OF COLORADO  
NOTARY ID 20034027751  
MY COMMISSION EXPIRES AUG 19, 2023

Escrow No. 1906933-RLT

**EXHIBIT A  
LEGAL DESCRIPTION**

All that certain real property situate in the County of Douglas, State of Nevada, described as follows:

Lot 17, Block E, as shown on the Official Map of Westwood Village Unit No. 1, according to the map thereof, filed in the office of the County Recorder of Douglas County, State of Nevada, on October 5, 1979, in Book 1079, Page 440, Document No. 37417, Official Records, and amended by Certificate of Amendment recorded July 14, 1980, in Book 780, Page 783, Document No. 46166, and recorded January 31, 1991, in Book 191, Page 3820, Document No. 243938, and recorded January 3, 1994, in Book 194, Page 130, as document No. 326601, Official Records.

APN: 1320-30-211-022

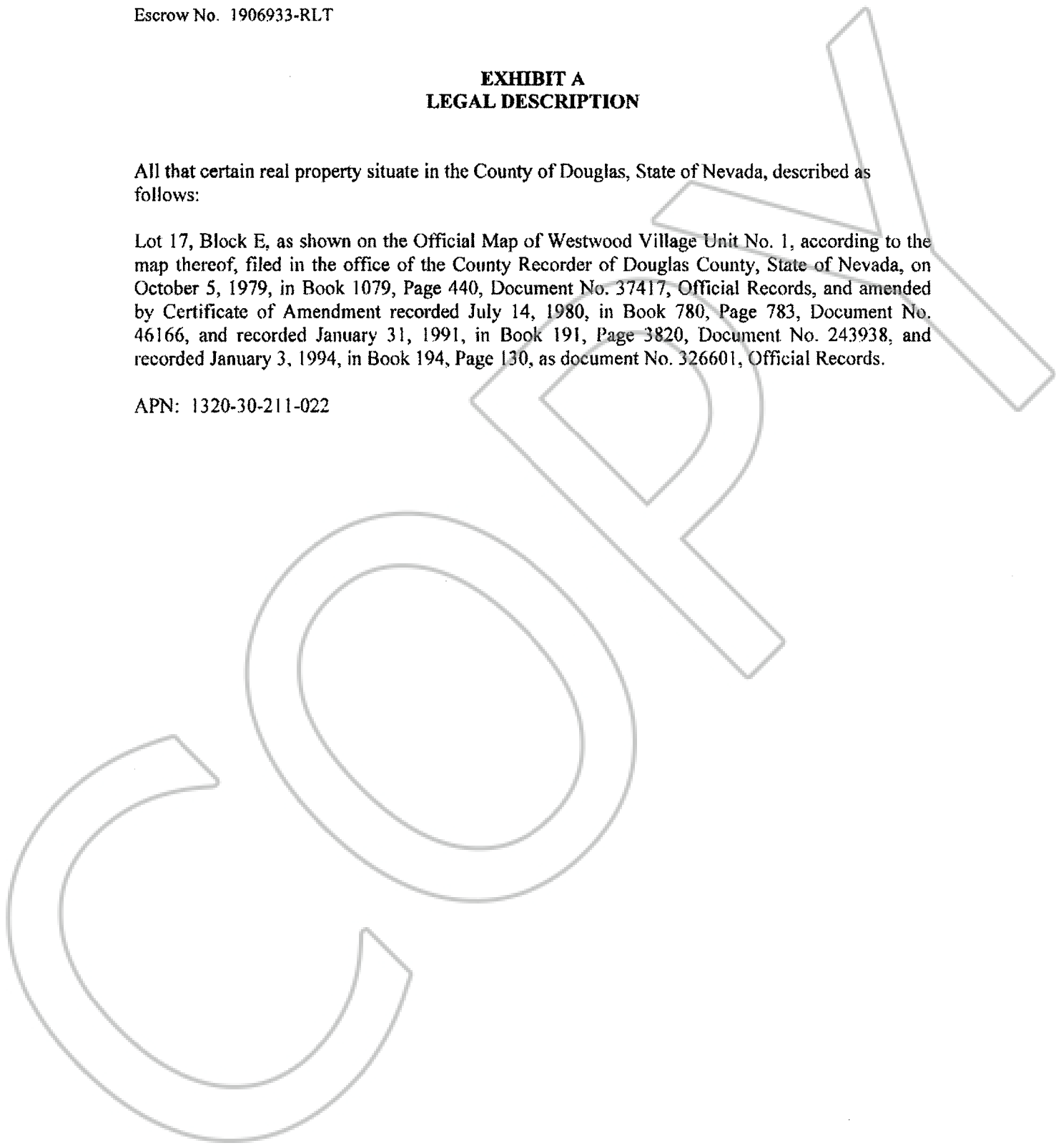

STATE OF NEVADA  
DECLARATION OF VALUE FORM

1. Assessor Parcel Number(s)  
a. 1320-30-211-022  
b. \_\_\_\_\_  
c. \_\_\_\_\_  
d. \_\_\_\_\_

2. Type of Property:  
a.  Vacant Land      b.  Single Fam. Res.  
c.  Condo/Twnhse      d.  2-4 Plex  
e.  Apt. Bldg      f.  Comm'l/Ind'l  
g.  Agricultural      h.  Mobile Home  
i. Other \_\_\_\_\_

FOR RECORDERS OPTIONAL USE ONLY  
Book \_\_\_\_\_ Page \_\_\_\_\_  
Date of Recording: \_\_\_\_\_  
Notes: \_\_\_\_\_

3. a. Total Value/Sales Price of Property: \$ 390,000.00  
b. Deed in Lieu of Foreclosure Only (value of property) \$  
c. Transfer Tax Value \$ 390,000.00  
d. Real Property Transfer Tax Due: \$ 1,521.00

4. **If Exemption Claimed**  
a. Transfer Tax Exemption, per NRS 375.090, Section \_\_\_\_\_  
b. Explain Reason for Exemption: \_\_\_\_\_

5. Partial Interest: Percentage being transferred: 00 %

The undersigned declares and acknowledges, under penalty of perjury, pursuant to NRS 375.060 and NRS 375.110, that the information provided is correct to the best of their information and belief, and can be supported by documentation if called upon to substantiate the information provided herein. Furthermore, the parties agree that disallowance of any claimed exemption, or other determination of additional tax due, may result in a penalty of 10% of the tax due plus interest at 1% per month. Pursuant to NRS 375.030, the Buyer and Seller shall be jointly and severally liable for any additional amount owed.

Signature Christine Conkling Capacity Successor Trustee  
Signature \_\_\_\_\_ Capacity [Signature]

**SELLER (GRANTOR) INFORMATION**  
(REQUIRED)

**BUYER (GRANTEE) INFORMATION**  
(REQUIRED)

Print Name: Joan Marie Schiavo, Successor  
Trustee of the Butler Family Trust Agreement dated  
July 29, 1992; Christine Conkling, Successor Trustee  
Address: 1742 Edinborough Dr of the Adelheid  
City: Rochester Hills A. Butler Trust  
State: MI Zip: 48306 dated May 27, 2011  
cc

Print Name: Gary Lee Frankforter + Jill D. Frankforter  
Address: 842 Mahogany Drive  
City: Clancy Minden  
State: NV Zip: 59634

**COMPANY/PERSON REQUESTING RECORDING (Required if not Seller or Buyer)**  
Print Name: Ticor Title of Nevada, Inc. Escrow No.: 01906933-020-RLT  
Address: 1483 US Highway 395 N, Suite B  
City, State, Zip: Gardnerville, NV 89410

AS A PUBLIC RECORD THIS FORM MAY BE RECORDED/MICROFILMED