

DOUGLAS COUNTY, NV **2020-941415**  
RPTT:\$3042.00 Rec:\$40.00  
\$3,082.00 Pgs=3 01/27/2020 02:17 PM  
TICOR TITLE - GARDNERVILLE  
KAREN ELLISON, RECORDER

**WHEN RECORDED MAIL TO:**

James W. Lamb and Judith A. Lamb, Trustees of the  
Lamb 1993 Trust dated 10/19/1993  
PO BOX 1421  
Genoa, NV 89411

**MAIL TAX STATEMENTS TO:**

James W. Lamb and Judith A. Lamb, Trustees of the  
Lamb 1993 Trust dated 10/19/1993  
PO BOX 1421  
Genoa, NV 89411

Escrow No. 1907134-RLT

The undersigned hereby affirms that this document  
submitted for recording does not contain the social  
security number of any person or persons.

(Pursuant to NRS 239b.030)

APN No.: 1220-24-601-027  
R.P.T.T. \$3,042.00

SPACE ABOVE FOR RECORDER'S USE ONLY

**GRANT, BARGAIN, SALE DEED**

**THIS INDENTURE WITNESSETH:** That Mark T. Brewer and Laura L. Brewer, Trustees of the  
Mark and Laura Brewer Revocable Trust dated March 3, 2006

**FOR A VALUABLE CONSIDERATION,** receipt of which is hereby acknowledged, do/does hereby  
Grant, Bargain, Sell and Convey to James W. Lamb and Judith A. Lamb, Trustees of the Lamb 1993  
Trust dated 10/19/1993

**all that real property situated in the County of Douglas, State of Nevada, described as follows:**

**SEE EXHIBIT "A" ATTACHED HERETO AND BY REFERENCE MADE A PART HEREOF**

**Together with all and singular the tenements, hereditaments and appurtenances thereunto belonging  
or in anywise appertaining.**

**Signature and notary acknowledgement on page two.**

Mark T. Brewer and Laura L. Brewer,  
Trustees of the Mark and Laura Brewer  
Revocable Trust dated March 3, 2006

Mark T. Brewer  
Mark T. Brewer, Trustee

Laura L. Brewer, Trustee  
Laura L. Brewer, Trustee

STATE OF NEVADA  
COUNTY OF DOUGLAS

} ss:

This instrument was acknowledged before me on , January 21, 2020  
by Mark T. Brewer and Laura L. Brewer, Trustees of the Mark and Laura Brewer Revocable Trust dated  
March 3, 2006

Elizabeth Del Real  
NOTARY PUBLIC



Escrow No. 1907134-RLT

**EXHIBIT A  
LEGAL DESCRIPTION**

All that certain real property situate in the County of Douglas, State of Nevada, described as follows:

Parcel 4D-1, as shown on that certain Parcel Map #3 for Robert and Yoshiko Oswald recorded May 31, 1994, in Book 594, at Page 5295, as Document No. 338606, Official Records of Douglas County, State of Nevada.

APN: 1220-24-601-027

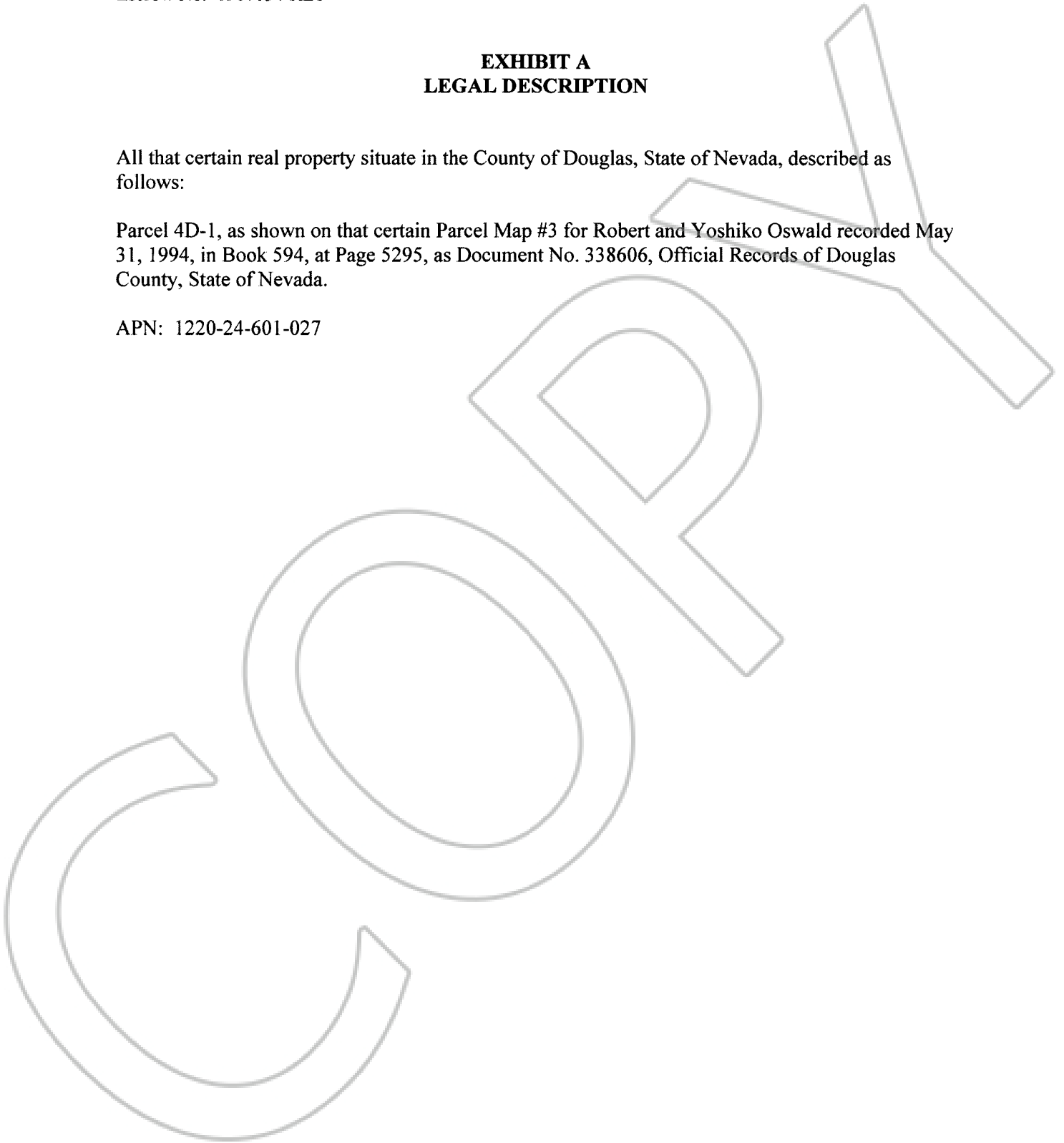

**STATE OF NEVADA  
DECLARATION OF VALUE FORM**

1. Assessor Parcel Number(s)  
 a. 1220-24-601-027  
 b. \_\_\_\_\_  
 c. \_\_\_\_\_  
 d. \_\_\_\_\_

2. Type of Property:  
 a.  Vacant Land                      b.  Single Fam. Res.  
 c.  Condo/Twnhse                    d.  2-4 Plex  
 e.  Apt. Bldg                            f.  Comm'l/Ind'l  
 g.  Agricultural                      h.  Mobile Home  
 i. Other \_\_\_\_\_

FOR RECORDERS OPTIONAL USE ONLY	
Book _____	Page _____
Date of Recording: _____	
Notes: _____	

3. a. Total Value/Sales Price of Property:                      \$ 780,000.00  
 b. Deed in Lieu of Foreclosure Only (value of property)    \$ \_\_\_\_\_  
 c. Transfer Tax Value    \$ 780,000.00  
 d. Real Property Transfer Tax Due:                                \$ 3,042.00

4. **If Exemption Claimed**  
 a. Transfer Tax Exemption, per NRS 375.090, Section \_\_\_\_\_  
 b. Explain Reason for Exemption: \_\_\_\_\_

5. Partial Interest: Percentage being transferred: 100 %

The undersigned declares and acknowledges, under penalty of perjury, pursuant to NRS 375.060 and NRS 375.110, that the information provided is correct to the best of their information and belief, and can be supported by documentation if called upon to substantiate the information provided herein. Furthermore, the parties agree that disallowance of any claimed exemption, or other determination of additional tax due, may result in a penalty of 10% of the tax due plus interest at 1% per month. Pursuant to NRS 375.030, the Buyer and Seller shall be jointly and severally liable for any additional amount owed.

Signature Mark T. Brewer    Capacity Grantor & Trustee  
 Signature Laura L. Brewer    Capacity Grantor & Trustee

**SELLER (GRANTOR) INFORMATION**  
**(REQUIRED)**  
 Print Name: Mark T. Brewer and Laura L. Brewer,  
 Trustees of the Mark and Laura Brewer Revocable  
 Trust dated March 3, 2006  
 Address: 3402 Danbury Circle  
 City: Cocinth  
 State: Zip: TX 76208

**BUYER (GRANTEE) INFORMATION**  
**(REQUIRED)**  
 Print Name: James W. Lamb + Judith A. Lamb,  
trustees et al  
 Address: PO BOX 1421  
 City: Genoa  
 State: NV Zip: 89411

**COMPANY/PERSON REQUESTING RECORDING (Required if not Seller or Buyer)**  
 Print Name: Titor Title of Nevada, Inc.                                      Escrow No.: 01907134-020-RLT  
 Address: 1483 US Highway 395 N, Suite B  
 City, State, Zip: Gardnerville, NV 89410

AS A PUBLIC RECORD THIS FORM MAY BE RECORDED/MICROFILMED