

VICINITY MAP
NO SCALE

BASIS OF BEARINGS

THE BASIS OF BEARINGS FOR THIS SURVEY IS NAD-83 NEVADA STATE PLANE, WEST ZONE SCALED AROUND 0.00N, 0.00E BY THE COMBINED FACTOR OF 1.0002753280 AS DERIVED FROM AN NGS OPUS SOLUTION FOR USGLO BRASS DISK AP 4, TR.38, T.9N., R.23E.

NAD-83 NEVADA WEST CONTROL TIES (GROUND)

POINT	NORTH	EAST	DESCRIPTION
A	14,534,872.17	2,380,114.86	FOUND USGLO BRASS CAP AP 4
B	14,537,261.65	2,377,527.02	FOUND 5/8" REBAR & TAG, PLS 6497
C	14,534,918.65	2,380,116.12	SET 5/8" REBAR & CAP, PLS 19734

NOTES

- TOTAL AREA SURVEYED IS 39.99 AC.
- EASEMENTS OF RECORD ARE NOT SHOWN HEREON.
- NO TITLE REPORT WAS PROVIDED BY CLIENT.

REFERENCE DOCUMENTS

- MAP OF DIVISION INTO LARGE PARCELS FOR THE ESTATE OF JOSEPH T. BANNER AN UNDIVIDED 76.63% AND FRANK C. BOSLER AND UNDIVIDED 23.33% FILED FOR RECORD JANUARY 18, 1984, AS DOCUMENT NO. 94344 IN THE OFFICE OF THE DOUGLAS COUNTY RECORDER.
- UNITED STATES DEPARTMENT OF INTERIOR BUREAU OF LAND MANAGEMENT COMPLETION OF SUBDIVISION WITH TRACT SEGREGATIONS FOR T.9N., R.23E., M.D.M. NEVADA APPROVED FEBRUARY 4, 1948.

SURVEYOR'S CERTIFICATE

I, TODD A. ENKE, A PROFESSIONAL LAND SURVEYOR, LICENSED IN THE STATE OF NEVADA, AS AN AGENT FOR RESOURCE CONCEPTS, INC, DO HEREBY CERTIFY THAT:

- THIS PLAT REPRESENTS THE RESULTS OF A SURVEY CONDUCTED UNDER MY DIRECT SUPERVISION AT THE INSTANCE OF KARL & MARLA COUGHTRY.
- THE LANDS SURVEYED BEING TRACT 30 OF DIVISION MAP INTO LARGE PARCELS FOR JOSEPH T. BANNER & FRANK C. BOSLER LYING WITHIN A PORTION OF SECTION 30, T.9N., R.23E., M.D.M. DOUGLAS COUNTY NEVADA. THIS SURVEY WAS COMPLETED ON NOVEMBER 25, 2019.
- THIS PLAT COMPLIES WITH THE APPLICABLE STATE STATUTES AND ANY LOCAL ORDINANCES IN EFFECT ON THE DATE THAT THE SURVEY WAS COMPLETED.
- THE MONUMENTS DEPICTED ON THE PLAT ARE OF THE CHARACTER SHOWN, OCCUPY THE POSITIONS INDICATED, AND ARE OF SUFFICIENT DURABILITY.
- THIS SURVEY WAS CONDUCTED IN ACCORDANCE WITH CHAPTER 625 OF THE NEVADA ADMINISTRATIVE CODE AND MEETS THE POSITIONAL CERTAINTY FOR A HIGH URBAN LAND BOUNDARY SURVEY.
- THIS RECORD OF SURVEY IS NOT IN CONFLICT WITH N.R.S. 625.340 AND NO NEW LOTS ARE BEING CREATED.

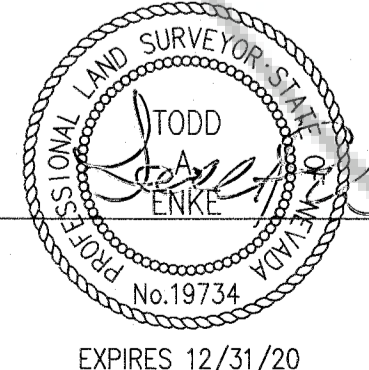

TODD A. ENKE, PLS 19734

1/27/20

EXPIRES 12/31/20

COUNTY RECORDER'S CERTIFICATE

FILED THIS 25th DAY OF January, 2020 AT 20 MINUTES PAST 8 O'CLOCK A.M.,
AS DOCUMENT NUMBER 2020-941433 RECORDED AT THE REQUEST OF Todd Enke.

Karen Ellison
DOUGLAS COUNTY RECORDER - *Deputy*

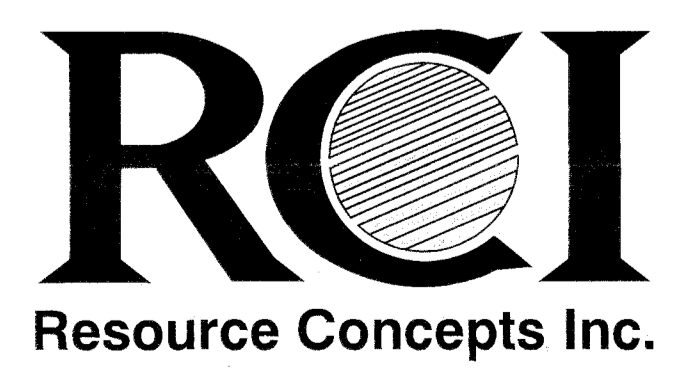

Carson City
340 N. Minnesota St. Carson
City, NV 89703-4152
775-883-1600
Lake Tahoe
276 Kingsbury Grade, Ste. 206
Stateline, NV 89449
775-588-7500

JANUARY 27, 2020

JOB NO. 19-307

SHEET 1 OF 1

RECORD OF SURVEY

FOR

KARL & MARLA COUGHTRY

TRACT 30 OF MAP INTO DIVISION INTO LARGE PARCELS FOR THE ESTATE OF

JOSEPH T. BANNER & FRANK C. BOSLER

LOCATED WITHIN A PORTION OF SECTION 30, T.9N., R.23E., M.D.M.

DOUGLAS COUNTY

NEVADA