

APN# _____

Recording Requested by/Mail to:

Name: Douglas County Community Dev.

Address: _____

City/State/Zip: _____

Mail Tax Statements to:

Name: _____

Address: _____

City/State/Zip: _____



KAREN ELLISON, RECORDER

Certificate of Amendment

Title of Document (required)

----- (Only use if applicable) -----

The undersigned hereby affirms that the document submitted for recording
DOES contain personal information as required by law: (check applicable)

- Affidavit of Death – NRS 440.380(1)(A) & NRS 40.525(5)
- Judgment – NRS 17.150(4)
- Military Discharge – NRS 419.020(2)

Signature

Printed Name

This document is being (re-)recorded to correct document # _____, and is correcting

When recorded mail to:

Gregory A Bigby, P.L.S.
Bigby and Associates, Inc.
1280 Terminal Way, #32
Reno, NV 89502

CERTIFICATE OF AMENDMENT

January 22, 2020

Greg Phillips, P.L.S.
Douglas County Surveyor
308 N. Curry Street, Suite 200
Carson City, NV 89703

DOCUMENT:

Record of Survey of Boundary Line Adjustment
for West Ridge Homes - Lessard
File No. 2019-936837
Recorded October 28, 2019
Official Records of Douglas County, Nevada

LEGAL DESCRIPTION:

Situate within the NE ¼ of Section 24
T. 12 N., R. 20 E., M.D.M.
Douglas County, Nevada

Dear Mr. Phillips:

In accordance with NRS 278.473, I am respectfully requesting that the following omission and correction to be noted on the above referenced plat:

- As shown on Sheet 1 of 1 the Westerly line of Parcel A-1 contains an error on the called out length of 461.00'. The correct length is **449.00'**.
- As shown on Sheet 1 of 1 the Westerly line of Parcel A-1 contains an error on the called out length of 176.00'. The correct length is **188.00'**.
- As shown on Sheet 1 of 1 the original area of Parcel A-1 is incorrectly labeled +/- 3.89 acres. The correct area is **+/- 3.82 acres**.
- As shown on Sheet 1 of 1 the adjusted area of Parcel A-1 is incorrectly labeled +/- 4.15 acres. The correct area is **+/-4.08 acres**.

This correction of error does not change or purport to change the physical location of any monument of the adjusted property line or boundary line.

Respectfully Submitted,

Gregory A. Bigby, PLS
Bigby and Associates, Inc.
Nevada Certificate No. 9102

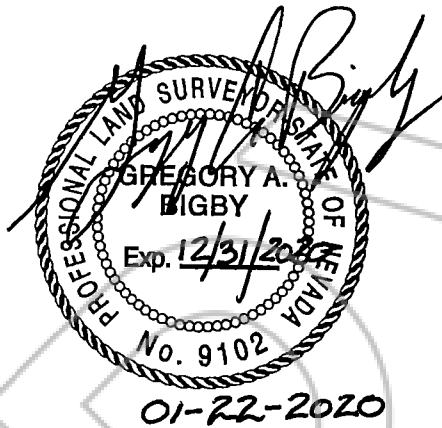

GOVERNING AGENCIES STATEMENTS:

I hereby certify that I have examined the certificate of amendment and that the changes to the original document specified therein are provided for in applicable sections of NRS 278.010 and 278.630, inclusive, 623.340 to 625.380, inclusive, and local ordinances adopted pursuant thereto, and I am satisfied that this certificate of amendment so amends or corrects the document to make it technically correct.

Greg Phillips, P.L.S.
Nevada Certificate No. 17616
Douglas County Surveyor

