

DOUGLAS COUNTY, NV

2020-943252

RPTT:\$0.00 Rec:\$40.00

03/09/2020 02:07 PM

\$40.00 Pgs=4

TICOR TITLE - GARDNERVILLE

KAREN ELLISON, RECORDER

E03

APN # 1420-32-001-017

The undersigned hereby affirms that this document submitted for recording does not contain the social security number of any person or persons.
(Pursuant to NRS 239b.030)

Recording Requested by and Return to:

TICORTITLE OF NEVADA, INC.
1483 US Highway 395 N, Suite B

Gardnerville, NV 89410

Grant Bargain and Sale Deed

(Title on Document)

This page added to provide additional information required by NRS 111.312 Sections 1-2 (Additional recording fee applies).

This document is being re-recorded to correct Grantees mailing address

DOUGLAS COUNTY, NV 2020-943178
RPTT:\$1673.10 Rec:\$40.00
\$1,713.10 Pgs=2 03/06/2020 10:49 AM
TICOR TITLE - GARDNERVILLE
KAREN ELLISON, RECORDER

WHEN RECORDED MAIL TO:
Series 5 of GRCSMC LLC, a Nevada Limited Liability Company

PO Box 217
Gardner, NV 89413
Glenbrook

MAIL TAX STATEMENTS TO:
Series 5 of GRCSMC LLC, a Nevada Limited Liability Company

PO Box 217
Gardner, NV 89413
Glenbrook
Escrow No. 1903039-RLT

The undersigned hereby affirms that this document submitted for recording does not contain the social security number of any person or persons.
(Pursuant to NRS 239b.030)

APN No.: 1420-32-001-017
R.P.T.T. \$ 1,673.10

SPACE ABOVE FOR RECORDER'S USE ONLY

GRANT, BARGAIN, SALE DEED

THIS INDENTURE WITNESSETH: That Black Horse Ranch LLC, a Nevada limited liability company

FOR A VALUABLE CONSIDERATION, receipt of which is hereby acknowledged, do/does hereby Grant, Bargain, Sell and Convey to Series 5 of GRCSMC LLC, a Nevada Limited Liability Company

all that real property situated in the County of Douglas, State of Nevada, described as follows:
SEE EXHIBIT "A" ATTACHED HERETO AND BY REFERENCE MADE A PART HEREOF

Together with all and singular the tenements, hereditaments and appurtenances thereunto belonging or in anywise appertaining.

Together with any and all appurtenant water rights, whether from surface or underground sources.

Black Horse Ranch LLC, a Nevada limited liability company

By: Peter H. Grimm

STATE OF NEVADA
COUNTY OF DOUGLAS

} ss:

This instrument was acknowledged before me on, March 2, 2020
by Black Horse Ranch LLC, a Nevada limited liability company, Peter H. Grimm

NOTARY PUBLIC

 CATHERINE P. COLLIER
Notary Public - State of Nevada
Appointment Recorded in Lyon County
No: 10-2072-12 - Expires April 14, 2022

WHEN RECORDED MAIL TO:
Series 5 of GRCSMC LLC, a Nevada Limited Liability
Company

PO Box 217
~~4444~~, NV 89413

Glenbrook
MAIL TAX STATEMENTS TO:
Series 5 of GRCSMC LLC, a Nevada Limited Liability
Company

PO Box 217
~~Glenbrook~~, NV 89413
Glenbrook
Escrow No. 1903039-RLT

E-RECORDED simplifile®

ID: 2020-943178

County: DOUGLAS

Date: 3/6/2020 Time: 10:49am

The undersigned hereby affirms that this document
submitted for recording does not contain the social
security number of any person or persons.
(Pursuant to NRS 239b.030)

APN No.: 1420-32-001-017
R.P.T.T. \$ 1,673.10

SPACE ABOVE FOR RECORDER'S USE ONLY

GRANT, BARGAIN, SALE DEED

THIS INDENTURE WITNESSETH: That Black Horse Ranch LLC, a Nevada limited liability
company

FOR A VALUABLE CONSIDERATION, receipt of which is hereby acknowledged, do/does hereby
Grant, Bargain, Sell and Convey to Series 5 of GRCSMC LLC, a Nevada Limited Liability Company

all that real property situated in the County of Douglas, State of Nevada, described as follows:
SEE EXHIBIT "A" ATTACHED HERETO AND BY REFERENCE MADE A PART HEREOF

Together with all and singular the tenements, hereditaments and appurtenances thereunto belonging
or in anywise appertaining.

Together with any and all appurtenant water rights, whether from surface or
underground sources.

Black Horse Ranch LLC, a Nevada limited
liability company

Peter H. Grimm
By: Peter H. Grimm

STATE OF NEVADA
COUNTY OF DOUGLAS

} ss:

This instrument was acknowledged before me on, March 2, 2020
by Black Horse Ranch LLC, a Nevada limited liability company, Peter H. Grimm

NOTARY PUBLIC

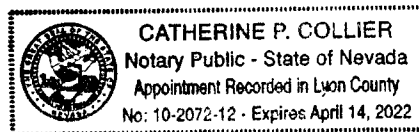

Order No.: 01903039-RLT

EXHIBIT A

All that certain real property situate in the County of Douglas, State of Nevada, described as follows:

All that certain lot, piece or parcel of land situate in the West 1/2 of Section 32, Township 14 North, Range 20 East, M. D. B. & M., County of Douglas, State of Nevada, described as follows:

Parcels 1-A as shown on Parcel Map No. 1 for Martin W. and Susan D. Johnson filed for record August 7, 1985, in Book 885, Page 788, Document No. 121204, of Official Records of Douglas County, Nevada.

APN: 1420-32-001-017

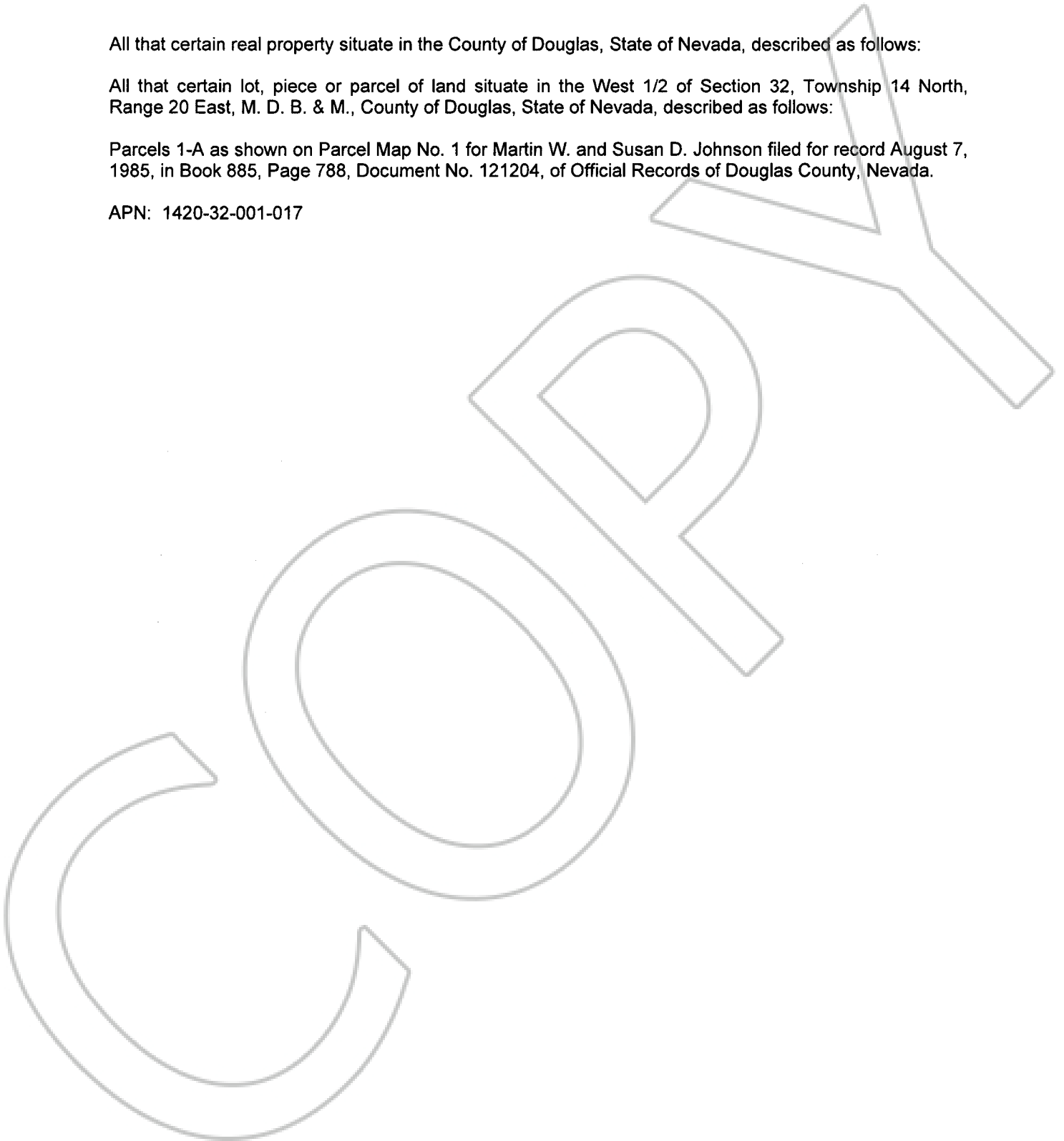

**STATE OF NEVADA
DECLARATION OF VALUE FORM**

1. Assessor Parcel Number(s)
 a. 1420-32-001-017
 b. _____
 c. _____
 d. _____

2. Type of Property:
 a. Vacant Land
 b. Single Fam. Res.
 c. Condo/Twnhse
 d. 2-4 Plex
 e. Apt. Bldg
 f. Comm'l/Ind'l
 g. Agricultural
 h. Mobile Home
 i. Other _____

| | |
|---------------------------------|------------|
| FOR RECORDERS OPTIONAL USE ONLY | |
| Book _____ | Page _____ |
| Date of Recording: _____ | |
| Notes: _____ | |

3. a. Total Value/Sales Price of Property: \$ 0
 b. Deed in Lieu of Foreclosure Only (value of property) \$ _____
 c. Transfer Tax Value \$ 0
 d. Real Property Transfer Tax Due: \$ 0

4. **If Exemption Claimed**
 a. Transfer Tax Exemption, per NRS 375.090, Section 3
 b. Explain Reason for Exemption: Re-Recording to correct Grantees mailing address,
DOCUMENT NO. 2020-943178

5. Partial Interest: Percentage being transferred: _____ %

The undersigned declares and acknowledges, under penalty of perjury, pursuant to NRS 375.060 and NRS 375.110, that the information provided is correct to the best of their information and belief, and can be supported by documentation if called upon to substantiate the information provided herein. Furthermore, the parties agree that disallowance of any claimed exemption, or other determination of additional tax due, may result in a penalty of 10% of the tax due plus interest at 1% per month. Pursuant to NRS 375.030, the Buyer and Seller shall be jointly and severally liable for any additional amount owed.

Signature _____ Capacity Agent
 Signature _____ Capacity _____

**SELLER (GRANTOR) INFORMATION
(REQUIRED)**
 Print Name: Black Horse Ranch LLC, a Nevada limited liability company
 Address: 1024 Nobles Ct
 City: Minden
 State: NV Zip: 89423

**BUYER (GRANTEE) INFORMATION
(REQUIRED)**
 Print Name: Series 5 of GRCSMC LLC, a Nevada Limited Liability Company
 Address: PO BOX 217
 City: Glenbrook
 State: NV Zip: 89413

COMPANY/PERSON REQUESTING RECORDING (Required if not Seller or Buyer)
 Print Name: Ticor Title of Nevada, Inc. Escrow No.: 01903039-020-RLT
 Address: 1483 US Highway 395 N, Suite B
 City, State, Zip: Gardnerville, NV 89410

AS A PUBLIC RECORD THIS FORM MAY BE RECORDED/MICROFILMED