

SCALE: 1" = 100'

A.P.N. 1022-05-000-002
SEATON REVOCABLE TRUST

A.P.N. 1022-04-000-001
B.L.M.

A.P.N. 1022-05-000-011
(LOT 4, BLOCK "R" OF TOPAZ RANCH
ESTATES, UNIT NO. 4)
11.30 ACRES

A.P.N. 1022-05-000-010
TOPAZ RANCH ESTATES
G.I.D.

A.P.N. 1022-05-000-017
B.L.M.

A.P.N. 1022-05-000-009
JULIAN RIGUAS, JR. &
ANN RIGUAS

A.P.N. 1022-05-000-013
MILLIAM G. SETHUVEGA

A.P.N. 1022-05-000-012
GENE DIORIO

SURVEYOR'S CERTIFICATE

- I, CORY J. KLEINE, A PROFESSIONAL LAND SURVEYOR LICENSED IN THE STATE OF NEVADA CERTIFY THAT:
- 1) THIS PLAT REPRESENTS THE RESULTS OF A SURVEY CONDUCTED UNDER MY DIRECT SUPERVISION AT THE INSTANCE OF ROBERT McVICKER.
 - 2) THE LANDS SURVEYED LIE WITHIN A PORTION OF SECTION 5, T.10N., R.22E., M.D.M. AND THE SURVEY WAS COMPLETED ON APRIL 23, 2020.
 - 3) THIS PLAT COMPLIES WITH THE APPLICABLE STATE STATUTES AND ANY LOCAL ORDINANCE IN EFFECT ON THE DATE THAT THE SURVEY WAS COMPLETED.
 - 4) THE MONUMENTS DEPICTED ON THE PLAT ARE OF THE CHARACTER SHOWN, OCCUPY THE POSITIONS INDICATED AND ARE OF SUFFICIENT NUMBER AND DURABILITY.

Cory J. Kleine
CORY J. KLEINE, P.L.S. 21988

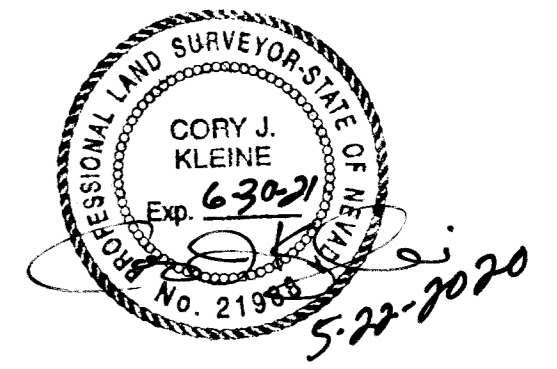

NOTES

AREA: 11.30 ACRES
THIS RECORD OF SURVEY HAS BEEN PREPARED TO DELINEATE THE BOUNDARY OF LOT 4, BLOCK "R" PER THE OFFICIAL PLAT OF TOPAZ RANCH ESTATES, UNIT NO. 4, FILED FOR RECORD NOVEMBER 16, 1970 IN THE OFFICE OF RECORDER, DOUGLAS COUNTY, NEVADA AS DOCUMENT NO. 50212.
NO ATTEMPT HAS BEEN MADE TO SHOW EASEMENTS OF RECORD WHICH MAY EXIST.
THIS MAP IS NOT IN CONFLICT WITH N.R.S. 278.010 TO 278.630 INCLUSIVE.

RECORDER'S CERTIFICATE

FILED FOR RECORD THIS 22nd DAY OF May, 2020, AT 41 MINUTES PAST 1 O'CLOCK P.M., IN BOOK --- OF OFFICIAL RECORDS AT PAGE ---, DOCUMENT NO. 2020-946508 RECORDED AT THE REQUEST OF CORY J. KLEINE.

Karen Ellison, Deputy
KAREN ELLISON
DOUGLAS COUNTY RECORDER

CURVE TABLE					
CURVE	DELTA	RADIUS	LENGTH	CHORD BEARING	CHORD LENGTH
C1(C)	34°26'17"	50.00'	30.05'	S86°13'25"W	29.60'
C1(R)	34°38'08"	50.00'	30.23'		
C2(M)	101°20'07"	50.00'	88.43'	S18°20'14"W	77.35'
C2(R)	101°19'16"	50.00'	88.42'		

LEGEND

- FOUND SECTION CORNER WITH USGLO BRASS CAP, 1940
- FOUND 1/4 SECTION CORNER WITH USGLO BRASS CAP, 1940
- FOUND 1/2" REBAR PER DOC. NO. 50212, UNLESS OTHERWISE NOTED
- SET 5/8" REBAR WITH CAP, PLS 21988
- (R) RECORD POSITION PER TOPAZ RANCH ESTATES, UNIT NO. 4, DOC NO. 50212
- (M) MEASURED POSITION
- (C) CALCULATED POSITION

BASIS OF BEARING

S0217°50'E - THE EASTERLY LINE OF SECTION 5 AS SHOWN ON THE OFFICIAL PLAT FOR TOPAZ RANCH ESTATES, UNIT NO. 4, FILED FOR RECORD NOVEMBER 16, 1970 IN THE OFFICE OF RECORDER, DOUGLAS COUNTY, NEVADA AS DOCUMENT NO. 50212.



RO Anderson
www.roanderson.com
MINDEN 1603 Esmeralda Ave P.O. Box 22291 Minden, NV 89423
RENO 4060 Double Diamond Pkwy, Unit 1B Reno, NV 89521
P 775.782.2322 F 775.782.7084

SCALE: 1" = 100' SHEET 1 OF 1
RECORD OF SURVEY
FOR
ROBERT & COLLEEN McVICKER

LOCATED WITHIN A PORTION OF SECTION 5, T.10N., R.22E., M.D.M. DOUGLAS COUNTY, NEVADA