

DOUGLAS COUNTY, NV 2020-946518

Rec:\$40.00

Total:\$40.00

05/22/2020 02:52 PM

LANGFORDS BEAR ENG

Pgs=3

RECORDING REQUESTED BY:

John Langford
2575 State Route 338
Wellington, NV 89444



00111596202009465180030033

KAREN ELLISON, RECORDER

CORNER RECORD

SURVEYOR'S CERTIFICATE

I, John R. Langford, a Professional Land Surveyor registered in the State of Nevada, certify that:

1. This corner record represents the establishment or restoration of a corner or accessory to a corner conducted under my direct supervision.
2. The monument or accessories perpetuated lie within Section 23, T 13 N, R 20 E, MDM, County of Douglas, and the establishment or restoration was completed on April 30, 2020.
3. This Corner Record has been filed pursuant to NRS 329.140 or 329.150 and complies with the provisions of NAC 329.010 and any local ordinances in effect on the date that the establishment or restoration was completed.
4. The monument or witness monument and accessories found are of the character shown, occupy the positions indicated, and are of sufficient durability.

JOHN R LANGFORD
PLS 4957

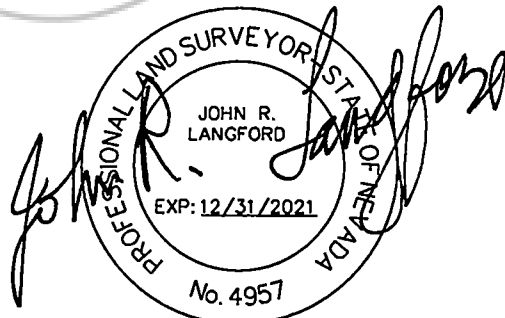

MAY 18 2020

MONUMENTATION NOTES

The monuments in the centerlines of Grandview Parkway, Painted Desert Drive, Grandpeak Court and Grandvista Court in the GRANDVIEW ESTATES PHASE I subdivision were removed during reconstruction of the aforementioned streets.

The found monuments as noted on the attached subdivision map are described as follows:

M11: A 1-1/2" aluminum cap inscribed PLS on a 3/4"Ø rebar
14115
down 0.2' from finish pavement grade in an 8"Ø cast iron monument well with a 2.5' concrete collar.

M12: A 1-1/2" aluminum cap inscribed PLS on a 3/4"Ø rebar
14115
down 0.2' from finish pavement grade in an 8"Ø cast iron monument well with a 2.5' concrete collar.

M13: A 1-1/2" aluminum cap inscribed PLS on a 3/4"Ø rebar
14115
down 0.3' from finish pavement grade in an 8"Ø cast iron monument well with a 2.5' concrete collar.

M14: A 1-1/2" aluminum cap inscribed PLS on a 3/4"Ø rebar
14115
down 0.4' from finish pavement grade in an 8"Ø cast iron monument well with a 2.5' concrete collar.

M17: A 1-1/2" aluminum cap inscribed PLS on a 3/4"Ø rebar
14115
down 0.2' from finish pavement grade in an 8"Ø cast iron monument well with a 2.5' concrete collar.

M18: A 1-1/2" aluminum cap inscribed PLS lying alongside of a
14115
3/4"Ø rebar down 0.4' from finish pavement grade in an 8"Ø cast iron monument well with a 2.5' concrete collar.

All monuments were measured prior to reconstruction. After reconstruction a 1-1/2"Ø aluminum cap inscribed PLS4957 on a 5/8"Øx24" rebar was set down 0.4' below the new pavement grade at the measured location of each monument. Each monument was placed in an 8"Ø cast iron monument well set in a 2.5' concrete collar.

RECORD REFERENCE

FINAL MAP NO. PD 99-12-01, GRANDVIEW ESTATES PHASE I filed on January 6, 2003, File No. 562908

