

APN#: 1320-33-811-033

RPTT: S-0-

Recording Requested By:

Western Title Company, Inc.

Escrow No. 115084-SLA

When Recorded Mail To:

Kristine Hughes

1311 Penn lane

Gardnerville, NV 89410

Mail Tax Statements to: (deeds only)

Same as Above

(space above for Recorder's use only)

I the undersigned hereby affirm that the attached document, including any exhibits, hereby submitted for recording does not contain the social security number of any person or persons.

(Per NRS 239B.030)

Signature

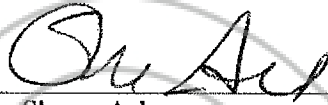

Sherry Ackermann

Escrow Officer

**Grant, Bargain, and Sale Deed**

This page added to provide additional information required by NRS 111.312 (additional recording fee applies)

## GRANT, BARGAIN AND SALE DEED

THIS INDENTURE WITNESSETH: That Patrick Hughes, a married man, in consideration of \$10.00, the receipt of which is hereby acknowledged, does hereby Grant, Bargain, Sell and Convey to Kristine Hughes, a married woman as her sole and separate property all that real property situated in the City of Gardnerville, County of Douglas, State of Nevada described as follows:

All that real property situate in the County of Douglas, State of Nevada, described as follows:

Lot 45, on Block D of FINAL SUBDIVISION MAP #1006-4 for CHICHESTER ESTATES, PHASE 4, according to the map thereof, filed in the office of the County Recorder of Douglas County, State of Nevada, on December 11, 1997, in Book 1297, Page 2264, as Document No. 428220.

TOGETHER with all and singular the tenements, hereditaments and appurtenances, if any, thereto belonging or appertaining, and any reversions, remainders, rents, issues or profits thereof.

Grantor and Grantee are husband and wife. It is the intention of Grantor that Grantee shall henceforth have and hold said real property as her sole and separate property. By this conveyance, Grantor releases any community interest that he might now have or be presumed to hereafter acquire in the above described property.

Dated: 06/02/2020

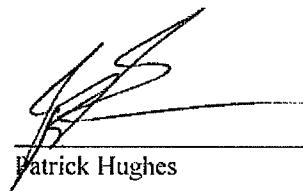
  
Patrick Hughes

STATE OF Nevada

COUNTY OF Douglas

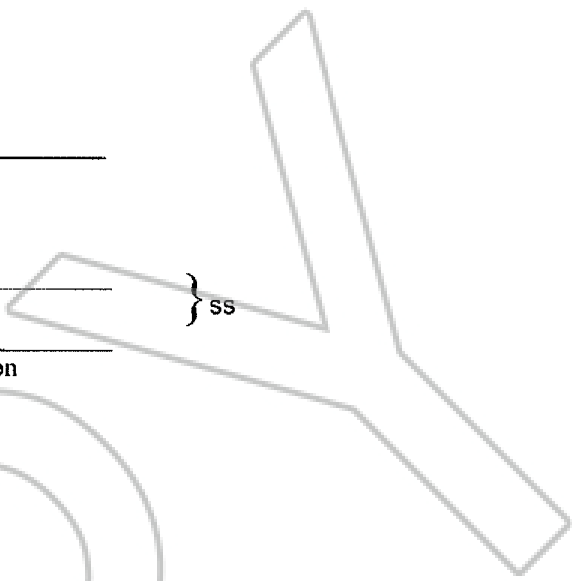

} SS

This instrument was acknowledged before me on

June 2, 2020

by Patrick Hughes.

  
Notary Public

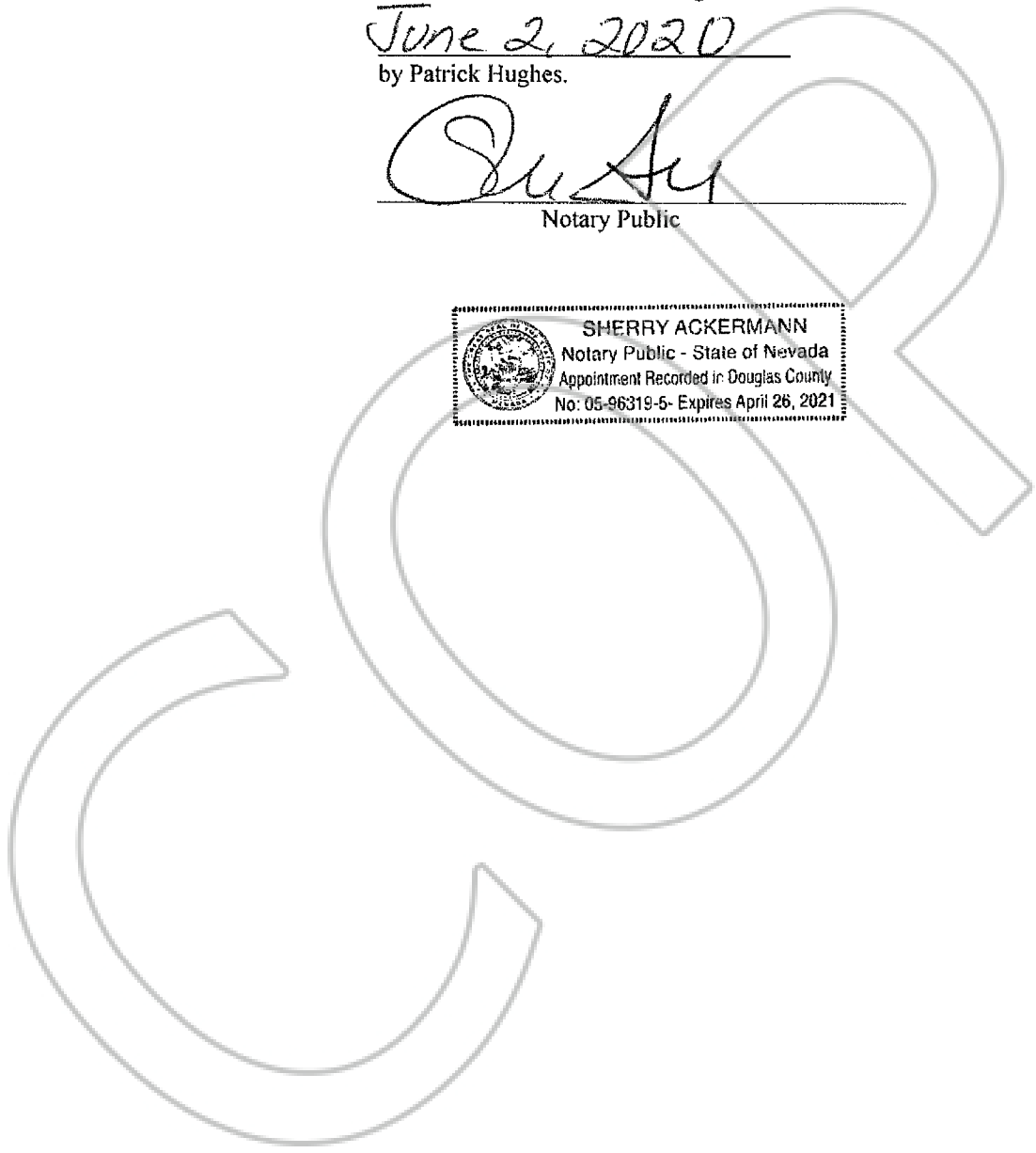
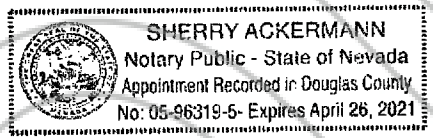
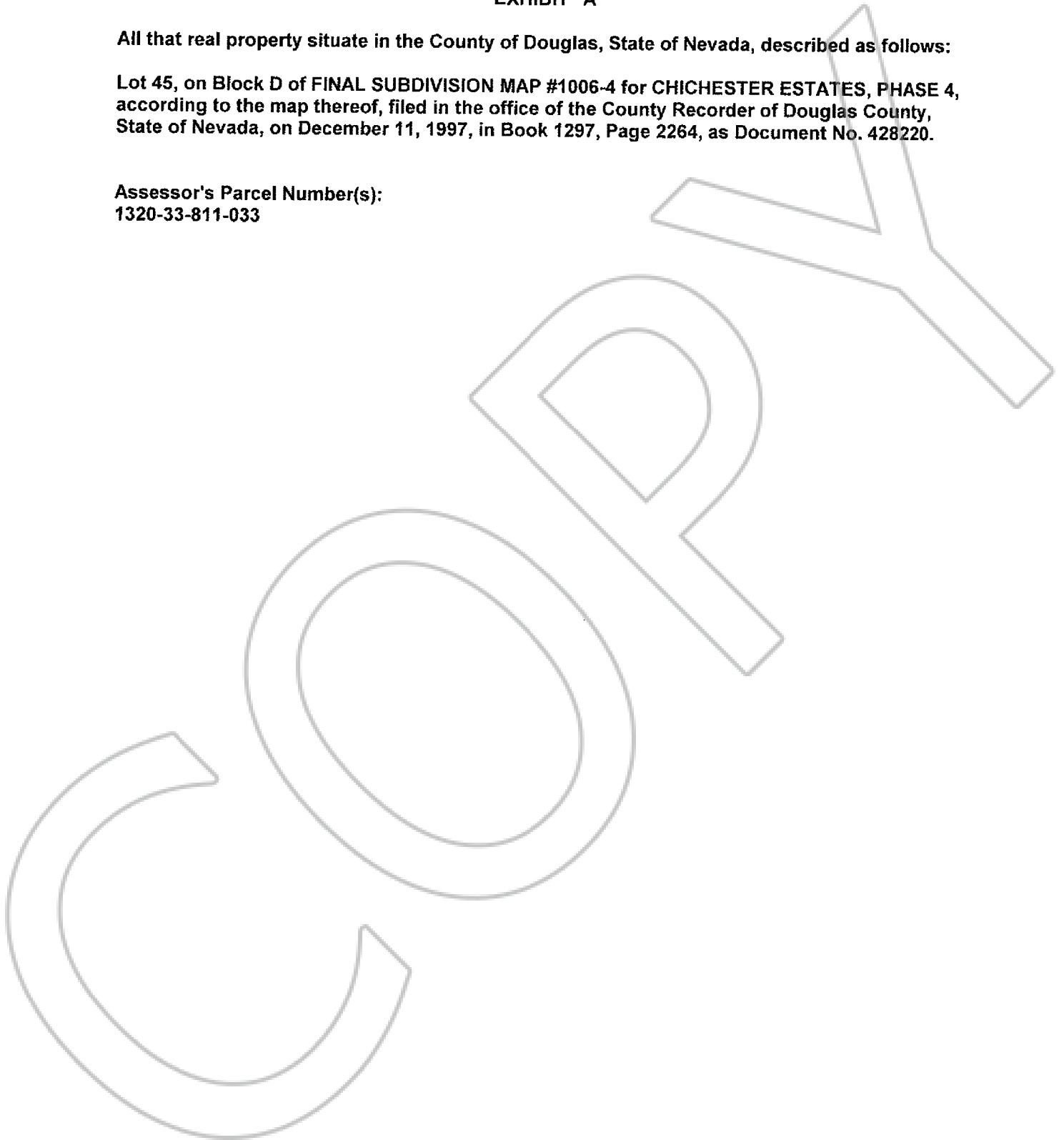

**EXHIBIT "A"**

**All that real property situate in the County of Douglas, State of Nevada, described as follows:**

**Lot 45, on Block D of FINAL SUBDIVISION MAP #1006-4 for CHICHESTER ESTATES, PHASE 4, according to the map thereof, filed in the office of the County Recorder of Douglas County, State of Nevada, on December 11, 1997, in Book 1297, Page 2264, as Document No. 428220.**

**Assessor's Parcel Number(s):  
1320-33-811-033**



**STATE OF NEVADA  
DECLARATION OF VALUE**

1. Assessors Parcel Number(s)  
a) 1320-33-811-033

2. Type of Property:  
 a)  Vacant Land                      b)  Single Fam. Res.  
 c)  Condo/Twnhse                      d)  2-4 Plex  
 e)  Apt. Bldg                              f)  Comm'l/Ind'l  
 g)  Agricultural                        h)  Mobile Home  
 i)  Other \_\_\_\_\_

**FOR RECORDERS OPTIONAL USE ONLY**  
 NOTES: \_\_\_\_\_  
 \_\_\_\_\_  
 \_\_\_\_\_

3. Total Value/Sales Price of Property: \$ \_\_\_\_\_  
 Deed in Lieu of Foreclosure Only (value of property) ( \_\_\_\_\_  
 Transfer Tax Value: \$ \_\_\_\_\_  
 Real Property Transfer Tax Due: \$ \_\_\_\_\_

4. If Exemption Claimed:  
 a. Transfer Tax Exemption per NRS 375.090, Section #5  
 b. Explain Reason for Exemption: Husband deeding to wife no consideration

5. Partial Interest: Percentage being transferred: 100 %

The undersigned declares and acknowledges, under penalty of perjury, pursuant to NRS 375.060 and NRS 375.110, that the information provided is correct to the best of their information and belief, and can be supported by documentation if called upon to substantiate the information provided herein. Furthermore, the parties agree that disallowance of any claimed exemption, or other determination of additional tax due, may result in a penalty of 10% of the tax due plus interest at 1% per month.

Pursuant to NRS 375.030, the Buyer and Seller shall be jointly and severally liable for any additional amount owed.

Signature \_\_\_\_\_ Capacity Grantor  
 Signature \_\_\_\_\_ Capacity \_\_\_\_\_

**SELLER (GRANTOR) INFORMATION  
(REQUIRED)**

**BUYER (GRANTEE) INFORMATION  
(REQUIRED)**

Print Name: Patrick Hughes  
 Address: PO Box 6669  
 City: Minden  
 State: NV Zip: 89423

Print Name: Kristine Hughes  
 Address: 1311 Penn Lane  
 City: Gardnerville  
 State: NV Zip: 89410

**COMPANY/PERSON REQUESTING RECORDING**  
 (required if not the seller or buyer)

Print Name: eTRCo, LLC. On behalf of Western Title Company  
 Address: Douglas Office  
1362 Highway 395, Ste. 109  
 City/State/Zip: Gardnerville, NV 89410

Esc. #: 115084-SLA