

DOUGLAS COUNTY, NV

2020-950946

Rec:\$40.00

\$40.00

Pgs=4

08/17/2020 03:12 PM

TICOR TITLE - GARDNERVILLE

KAREN ELLISON, RECORDER

WHEN RECORDED MAIL TO:

**Linda B. Radus
PO BOX 518
Genoa, NV 89411**

MAIL TAX STATEMENTS TO:

**Linda B. Radus
PO BOX 518
Genoa, NV 89411**

The undersigned hereby affirms that this document submitted for recording includes a death certificate which may contain a social security number as required by NRS 440.380(1)(a).

SPACE ABOVE FOR RECORDER'S USE ONLY

Escrow No. 2005032-RLT
APN No.: 1319-09-501-004

AFFIDAVIT TERMINATING JOINT TENANCY

STATE OF NEVADA
COUNTY OF DOUGLAS

} SS:

Linda B. Radus, of legal age and competent, to be a witness as to the matters stated herein, being duly sworn, deposes and says

That Clifford Leigh Radus the decedent mentioned in the attached copy of the Certificate of Death, is the same person as Clifford L. Radaus named as one of the Grantees in that certain Deed from Nancy A. Fransen, an unmarried woman to Clifford L. Radus and Linda B. Radus, husband and wife as joint tenants as Instrument No. 2017-902199, on 08/01/2017 of Official Records of Douglas County, Nevada, covering the following described property.

SEE EXHIBIT "A" ATTACHED HERETO AND BY REFERENCE MADE A PART HEREOF

Dated: 8-12-2020

Linda B. Radus
Linda B. Radus, Surviving Joint Tenant

STATE OF NEVADA
COUNTY OF DOUGLAS

} SS:

This instrument was acknowledged before me on 8/12/2020,
by Linda B. Radus

[Signature]
NOTARY PUBLIC

 **RISHELE L. THOMPSON**
Notary Public - State of Nevada
Appointment Recorded in Douglas County
No: 99-54931-5 - Expires April 10, 2023

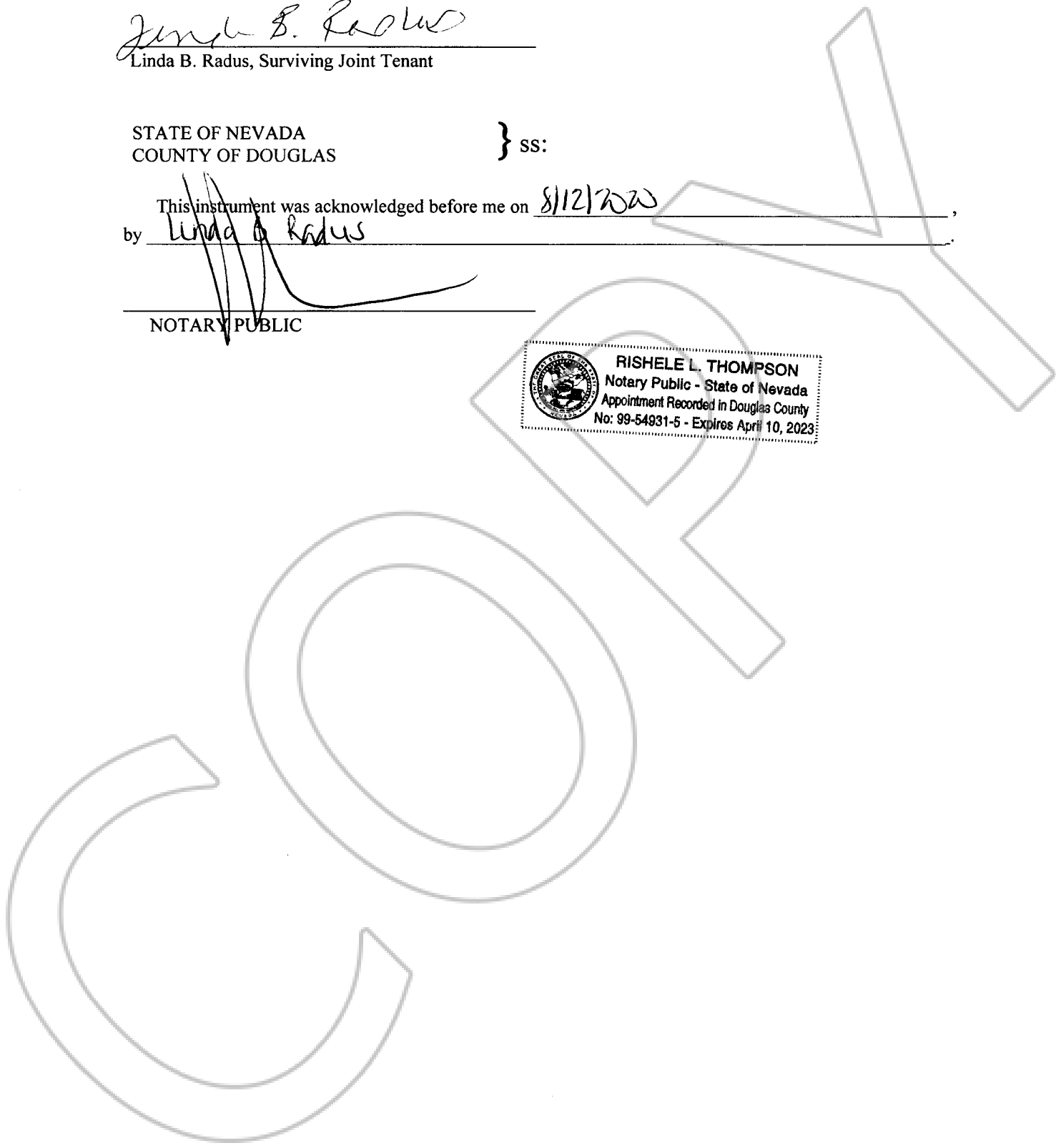

Escrow No.02005032 RLT

**EXHIBIT A
LEGAL DESCRIPTION**

All that certain real property situate in the County of Douglas, State of Nevada, described as follows:

A Parcel of land situated in and being a portion of the Northeast 1/4 of the Northeast 1/4 of Section 9, and the Northwest 1/4 of the Northwest 1/4 of Section 10, all in Township 13 North, Range 19 East M.D.B.&M., described as follows:

Parcel 1 as set forth on that certain Parcel Map for Dan Hickey filed for record in the Office of the County Recorder of Douglas County, State of Nevada, on August 29, 1989, in Book 889, Page 4299, as Document No. 209745.

APN: 1319-09-501-004

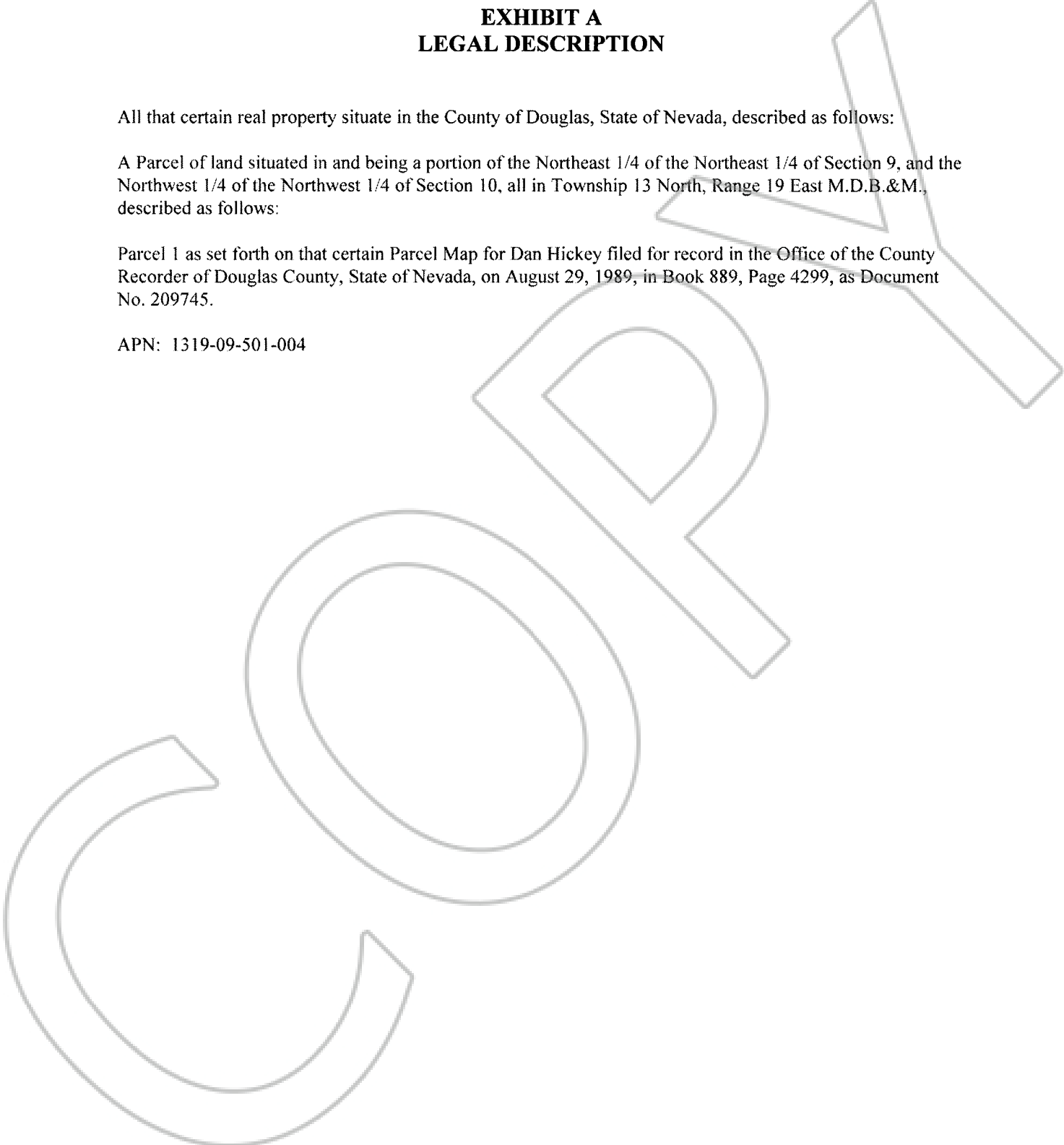

STATE OF NEVADA

CERTIFICATION OF VITAL RECORD

DEPARTMENT OF HEALTH AND HUMAN SERVICES DIVISION OF PUBLIC AND BEHAVIORAL HEALTH VITAL STATISTICS

CASE FILE NO. 4137899

CERTIFICATE OF DEATH

202006579

STATE FILE NUMBER

TYPE OR PRINT IN PERMANENT INK DECEASED IF DEATH OCCURRED IN INSTITUTION SEE HANDBOOK REGARDING COMPLETION OF RESIDENCE ITEMS PARENTS POSITION TRADE CALL CERTIFIER REGISTRAR CAUSE OF DEATH CONDITIONS IF ANY WHICH AVE RISE TO IMMEDIATE CAUSE STATING THE UNDERLYING CAUSE LAST	<table border="1" style="width: 100%; border-collapse: collapse;"> <tr> <td colspan="2">1a. DECEASED-NAME (FIRST,MIDDLE, LAST,SUFFIX) Clifford Leigh RADUS</td> <td colspan="2">2. DATE OF DEATH (Mo/Day/Year) March 31, 2020</td> <td colspan="2">3a. COUNTY OF DEATH Douglas</td> </tr> <tr> <td colspan="2">3b. CITY, TOWN, OR LOCATION OF DEATH Genoa</td> <td colspan="2">3c. HOSPITAL OR OTHER INSTITUTION -Name (If not either, give street number) 186 Centinneal Drive</td> <td colspan="2">3e. If Hosp. or Inst. Indicate DOA,OP/Emer. Rm. Inpatient(Specify) Home</td> </tr> <tr> <td colspan="2">5. RACE (Specify) White</td> <td colspan="2">6. Hispanic Origin? Specify No - Non-Hispanic</td> <td colspan="2">7a. AGE-Last birthday (Years) 69</td> </tr> <tr> <td colspan="2">7b. UNDER 1 YEAR MOS: _____ DAYS: _____ HOURS: _____ MINS: _____</td> <td colspan="2">7c. UNDER 1 DAY</td> <td colspan="2">8. DATE OF BIRTH (Mo/Day/Yr) December 30, 1950</td> </tr> <tr> <td colspan="2">9a. STATE OF BIRTH (If not US/CA, name country) New Jersey</td> <td colspan="2">9b. CITIZEN OF WHAT COUNTRY United States</td> <td colspan="2">10. EDUCATION 16</td> </tr> <tr> <td colspan="2">11. MARITAL STATUS (Specify) Married</td> <td colspan="4">12. SURVIVING SPOUSE'S NAME (Last name prior to first marriage) Linda Ann BRIDGES</td> </tr> <tr> <td colspan="2">13. SOCIAL SECURITY NUMBER ██████████-4899</td> <td colspan="2">14a. USUAL OCCUPATION (Give Kind of Work Done During Most of) Engineer</td> <td colspan="2">14b. KIND OF BUSINESS OR INDUSTRY Engineering</td> </tr> <tr> <td colspan="2">15a. RESIDENCE - STATE Nevada</td> <td colspan="2">15b. COUNTY Douglas</td> <td colspan="2">15c. CITY, TOWN OR LOCATION Genoa</td> </tr> <tr> <td colspan="2">15d. STREET AND NUMBER 186 Centinneal Drive</td> <td colspan="4">15e. INSIDE CITY LIMITS (Specify Yes or No) Yes</td> </tr> <tr> <td colspan="3">16. FATHER/PARENT - NAME (First Middle Last Suffix) Clifford Raymond RADUS</td> <td colspan="3">17. MOTHER/PARENT - NAME (First Middle Last Suffix) Martha LEIGH</td> </tr> <tr> <td colspan="3">18a. INFORMANT- NAME (Type or Print) Linda Ann RADUS</td> <td colspan="3">18b. MAILING ADDRESS (Street or R.F.D. No, City or Town, State, Zip) 186 Centinneal Drive Genoa, Nevada 89411</td> </tr> <tr> <td colspan="2">19a. BURIAL, CREMATION, REMOVAL, OTHER (Specify) Cremation</td> <td colspan="2">19b. CEMETERY OR CREMATORY - NAME Autumn Cremation Services</td> <td colspan="2">19c. LOCATION City or Town State Carson City Nevada 89701</td> </tr> <tr> <td colspan="2">20a. FUNERAL DIRECTOR - SIGNATURE (Or Person Acting as Such) JOHN LAWRENCE SIGNATURE AUTHENTICATED</td> <td colspan="2">20b. FUNERAL DIRECTOR LICENSE NUMBER FD304</td> <td colspan="2">20c. NAME AND ADDRESS OF FACILITY Autumn Funerals & Cremations 1575 N Lompa Ln Carson City NV 89701</td> </tr> <tr> <td colspan="6">TRADE CALL - NAME AND ADDRESS</td> </tr> <tr> <td colspan="3">21a. To the best of my knowledge, death occurred at the time, date and place and due to the cause(s) stated. (Signature & Title) NITA SCHWARTZ MD SIGNATURE AUTHENTICATED</td> <td colspan="3">22a. On the basis of examination and/or investigation, in my opinion death occurred at the time, date and place and due to the cause(s) stated. (Signature & Title)</td> </tr> <tr> <td colspan="2">21b. DATE SIGNED (Mo/Day/Yr) April 02, 2020</td> <td colspan="2">21c. HOUR OF DEATH 11:55</td> <td colspan="2">22b. DATE SIGNED (Mo/Day/Yr)</td> </tr> <tr> <td colspan="2">21d. NAME OF ATTENDING PHYSICIAN IF OTHER THAN CERTIFIER (Type or Print)</td> <td colspan="2">22d. PRONOUNCED DEAD (Mo/Day/Yr)</td> <td colspan="2">22e. PRONOUNCED DEAD AT (Hour)</td> </tr> <tr> <td colspan="4">23a. NAME AND ADDRESS OF CERTIFIER (PHYSICIAN, ATTENDING PHYSICIAN, MEDICAL EXAMINER, OR CORONER) (Type or Print) Nita Schwartz MD 710 W. Washington St. Carson City, NV 89703</td> <td colspan="2">23b. LICENSE NUMBER 9114</td> </tr> <tr> <td colspan="2">24a. REGISTRAR (Signature) BLAISE SATARIANO SIGNATURE AUTHENTICATED</td> <td colspan="2">24b. DATE RECEIVED BY REGISTRAR (Mo/Day/Yr) April 03, 2020</td> <td colspan="2">24c. DEATH DUE TO COMMUNICABLE DISEASE YES <input type="checkbox"/> NO <input checked="" type="checkbox"/></td> </tr> <tr> <td colspan="6">25. IMMEDIATE CAUSE (ENTER ONLY ONE CAUSE PER LINE FOR (a), (b), AND (c).)</td> </tr> <tr> <td colspan="6">PART I</td> </tr> <tr> <td colspan="6">(a) Malignant Neoplasm Of The Esophagus With Metastasis</td> </tr> <tr> <td colspan="6">DUE TO, OR AS A CONSEQUENCE OF:</td> </tr> <tr> <td colspan="6">(b) DUE TO, OR AS A CONSEQUENCE OF:</td> </tr> <tr> <td colspan="6">(c) DUE TO, OR AS A CONSEQUENCE OF:</td> </tr> <tr> <td colspan="6">(d) DUE TO, OR AS A CONSEQUENCE OF:</td> </tr> <tr> <td colspan="4">PART II OTHER SIGNIFICANT CONDITIONS-Conditions contributing to death but not resulting in the underlying cause given in Part I.</td> <td colspan="2">26. AUTOPSY (Specify Yes or No) No</td> </tr> <tr> <td colspan="2">27. WAS CASE REFERRED TO CORONER (Specify Yes or No) No</td> <td colspan="4"></td> </tr> <tr> <td colspan="2">28a. ACC, SUICIDE, HOM., UNDET. OR PENDING INVEST. (Specify)</td> <td colspan="2">28b. DATE OF INJURY (Mo/Day/Yr)</td> <td colspan="2">28c. HOUR OF INJURY</td> </tr> <tr> <td colspan="6">28d. DESCRIBE HOW INJURY OCCURRED</td> </tr> <tr> <td colspan="2">28e. INJURY AT WORK (Specify Yes or No)</td> <td colspan="2">28f. PLACE OF INJURY - At home, farm, street, factory, office building, etc. (Specify)</td> <td colspan="2">28g. LOCATION STREET OR R.F.D. No. CITY OR TOWN STATE</td> </tr> </table>	1a. DECEASED-NAME (FIRST,MIDDLE, LAST,SUFFIX) Clifford Leigh RADUS		2. DATE OF DEATH (Mo/Day/Year) March 31, 2020		3a. COUNTY OF DEATH Douglas		3b. CITY, TOWN, OR LOCATION OF DEATH Genoa		3c. HOSPITAL OR OTHER INSTITUTION -Name (If not either, give street number) 186 Centinneal Drive		3e. If Hosp. or Inst. Indicate DOA,OP/Emer. Rm. Inpatient(Specify) Home		5. RACE (Specify) White		6. Hispanic Origin? Specify No - Non-Hispanic		7a. AGE-Last birthday (Years) 69		7b. UNDER 1 YEAR MOS: _____ DAYS: _____ HOURS: _____ MINS: _____		7c. UNDER 1 DAY		8. DATE OF BIRTH (Mo/Day/Yr) December 30, 1950		9a. STATE OF BIRTH (If not US/CA, name country) New Jersey		9b. CITIZEN OF WHAT COUNTRY United States		10. EDUCATION 16		11. MARITAL STATUS (Specify) Married		12. SURVIVING SPOUSE'S NAME (Last name prior to first marriage) Linda Ann BRIDGES				13. SOCIAL SECURITY NUMBER ██████████-4899		14a. USUAL OCCUPATION (Give Kind of Work Done During Most of) Engineer		14b. KIND OF BUSINESS OR INDUSTRY Engineering		15a. RESIDENCE - STATE Nevada		15b. COUNTY Douglas		15c. CITY, TOWN OR LOCATION Genoa		15d. STREET AND NUMBER 186 Centinneal Drive		15e. INSIDE CITY LIMITS (Specify Yes or No) Yes				16. FATHER/PARENT - NAME (First Middle Last Suffix) Clifford Raymond RADUS			17. MOTHER/PARENT - NAME (First Middle Last Suffix) Martha LEIGH			18a. INFORMANT- NAME (Type or Print) Linda Ann RADUS			18b. MAILING ADDRESS (Street or R.F.D. No, City or Town, State, Zip) 186 Centinneal Drive Genoa, Nevada 89411			19a. BURIAL, CREMATION, REMOVAL, OTHER (Specify) Cremation		19b. CEMETERY OR CREMATORY - NAME Autumn Cremation Services		19c. LOCATION City or Town State Carson City Nevada 89701		20a. FUNERAL DIRECTOR - SIGNATURE (Or Person Acting as Such) JOHN LAWRENCE SIGNATURE AUTHENTICATED		20b. FUNERAL DIRECTOR LICENSE NUMBER FD304		20c. NAME AND ADDRESS OF FACILITY Autumn Funerals & Cremations 1575 N Lompa Ln Carson City NV 89701		TRADE CALL - NAME AND ADDRESS						21a. To the best of my knowledge, death occurred at the time, date and place and due to the cause(s) stated. (Signature & Title) NITA SCHWARTZ MD SIGNATURE AUTHENTICATED			22a. On the basis of examination and/or investigation, in my opinion death occurred at the time, date and place and due to the cause(s) stated. (Signature & Title)			21b. DATE SIGNED (Mo/Day/Yr) April 02, 2020		21c. HOUR OF DEATH 11:55		22b. DATE SIGNED (Mo/Day/Yr)		21d. NAME OF ATTENDING PHYSICIAN IF OTHER THAN CERTIFIER (Type or Print)		22d. PRONOUNCED DEAD (Mo/Day/Yr)		22e. PRONOUNCED DEAD AT (Hour)		23a. NAME AND ADDRESS OF CERTIFIER (PHYSICIAN, ATTENDING PHYSICIAN, MEDICAL EXAMINER, OR CORONER) (Type or Print) Nita Schwartz MD 710 W. Washington St. Carson City, NV 89703				23b. LICENSE NUMBER 9114		24a. REGISTRAR (Signature) BLAISE SATARIANO SIGNATURE AUTHENTICATED		24b. DATE RECEIVED BY REGISTRAR (Mo/Day/Yr) April 03, 2020		24c. DEATH DUE TO COMMUNICABLE DISEASE YES <input type="checkbox"/> NO <input checked="" type="checkbox"/>		25. IMMEDIATE CAUSE (ENTER ONLY ONE CAUSE PER LINE FOR (a), (b), AND (c).)						PART I						(a) Malignant Neoplasm Of The Esophagus With Metastasis						DUE TO, OR AS A CONSEQUENCE OF:						(b) DUE TO, OR AS A CONSEQUENCE OF:						(c) DUE TO, OR AS A CONSEQUENCE OF:						(d) DUE TO, OR AS A CONSEQUENCE OF:						PART II OTHER SIGNIFICANT CONDITIONS-Conditions contributing to death but not resulting in the underlying cause given in Part I.				26. AUTOPSY (Specify Yes or No) No		27. WAS CASE REFERRED TO CORONER (Specify Yes or No) No						28a. ACC, SUICIDE, HOM., UNDET. OR PENDING INVEST. (Specify)		28b. DATE OF INJURY (Mo/Day/Yr)		28c. HOUR OF INJURY		28d. DESCRIBE HOW INJURY OCCURRED						28e. INJURY AT WORK (Specify Yes or No)		28f. PLACE OF INJURY - At home, farm, street, factory, office building, etc. (Specify)		28g. LOCATION STREET OR R.F.D. No. CITY OR TOWN STATE	
1a. DECEASED-NAME (FIRST,MIDDLE, LAST,SUFFIX) Clifford Leigh RADUS		2. DATE OF DEATH (Mo/Day/Year) March 31, 2020		3a. COUNTY OF DEATH Douglas																																																																																																																																																																																							
3b. CITY, TOWN, OR LOCATION OF DEATH Genoa		3c. HOSPITAL OR OTHER INSTITUTION -Name (If not either, give street number) 186 Centinneal Drive		3e. If Hosp. or Inst. Indicate DOA,OP/Emer. Rm. Inpatient(Specify) Home																																																																																																																																																																																							
5. RACE (Specify) White		6. Hispanic Origin? Specify No - Non-Hispanic		7a. AGE-Last birthday (Years) 69																																																																																																																																																																																							
7b. UNDER 1 YEAR MOS: _____ DAYS: _____ HOURS: _____ MINS: _____		7c. UNDER 1 DAY		8. DATE OF BIRTH (Mo/Day/Yr) December 30, 1950																																																																																																																																																																																							
9a. STATE OF BIRTH (If not US/CA, name country) New Jersey		9b. CITIZEN OF WHAT COUNTRY United States		10. EDUCATION 16																																																																																																																																																																																							
11. MARITAL STATUS (Specify) Married		12. SURVIVING SPOUSE'S NAME (Last name prior to first marriage) Linda Ann BRIDGES																																																																																																																																																																																									
13. SOCIAL SECURITY NUMBER ██████████-4899		14a. USUAL OCCUPATION (Give Kind of Work Done During Most of) Engineer		14b. KIND OF BUSINESS OR INDUSTRY Engineering																																																																																																																																																																																							
15a. RESIDENCE - STATE Nevada		15b. COUNTY Douglas		15c. CITY, TOWN OR LOCATION Genoa																																																																																																																																																																																							
15d. STREET AND NUMBER 186 Centinneal Drive		15e. INSIDE CITY LIMITS (Specify Yes or No) Yes																																																																																																																																																																																									
16. FATHER/PARENT - NAME (First Middle Last Suffix) Clifford Raymond RADUS			17. MOTHER/PARENT - NAME (First Middle Last Suffix) Martha LEIGH																																																																																																																																																																																								
18a. INFORMANT- NAME (Type or Print) Linda Ann RADUS			18b. MAILING ADDRESS (Street or R.F.D. No, City or Town, State, Zip) 186 Centinneal Drive Genoa, Nevada 89411																																																																																																																																																																																								
19a. BURIAL, CREMATION, REMOVAL, OTHER (Specify) Cremation		19b. CEMETERY OR CREMATORY - NAME Autumn Cremation Services		19c. LOCATION City or Town State Carson City Nevada 89701																																																																																																																																																																																							
20a. FUNERAL DIRECTOR - SIGNATURE (Or Person Acting as Such) JOHN LAWRENCE SIGNATURE AUTHENTICATED		20b. FUNERAL DIRECTOR LICENSE NUMBER FD304		20c. NAME AND ADDRESS OF FACILITY Autumn Funerals & Cremations 1575 N Lompa Ln Carson City NV 89701																																																																																																																																																																																							
TRADE CALL - NAME AND ADDRESS																																																																																																																																																																																											
21a. To the best of my knowledge, death occurred at the time, date and place and due to the cause(s) stated. (Signature & Title) NITA SCHWARTZ MD SIGNATURE AUTHENTICATED			22a. On the basis of examination and/or investigation, in my opinion death occurred at the time, date and place and due to the cause(s) stated. (Signature & Title)																																																																																																																																																																																								
21b. DATE SIGNED (Mo/Day/Yr) April 02, 2020		21c. HOUR OF DEATH 11:55		22b. DATE SIGNED (Mo/Day/Yr)																																																																																																																																																																																							
21d. NAME OF ATTENDING PHYSICIAN IF OTHER THAN CERTIFIER (Type or Print)		22d. PRONOUNCED DEAD (Mo/Day/Yr)		22e. PRONOUNCED DEAD AT (Hour)																																																																																																																																																																																							
23a. NAME AND ADDRESS OF CERTIFIER (PHYSICIAN, ATTENDING PHYSICIAN, MEDICAL EXAMINER, OR CORONER) (Type or Print) Nita Schwartz MD 710 W. Washington St. Carson City, NV 89703				23b. LICENSE NUMBER 9114																																																																																																																																																																																							
24a. REGISTRAR (Signature) BLAISE SATARIANO SIGNATURE AUTHENTICATED		24b. DATE RECEIVED BY REGISTRAR (Mo/Day/Yr) April 03, 2020		24c. DEATH DUE TO COMMUNICABLE DISEASE YES <input type="checkbox"/> NO <input checked="" type="checkbox"/>																																																																																																																																																																																							
25. IMMEDIATE CAUSE (ENTER ONLY ONE CAUSE PER LINE FOR (a), (b), AND (c).)																																																																																																																																																																																											
PART I																																																																																																																																																																																											
(a) Malignant Neoplasm Of The Esophagus With Metastasis																																																																																																																																																																																											
DUE TO, OR AS A CONSEQUENCE OF:																																																																																																																																																																																											
(b) DUE TO, OR AS A CONSEQUENCE OF:																																																																																																																																																																																											
(c) DUE TO, OR AS A CONSEQUENCE OF:																																																																																																																																																																																											
(d) DUE TO, OR AS A CONSEQUENCE OF:																																																																																																																																																																																											
PART II OTHER SIGNIFICANT CONDITIONS-Conditions contributing to death but not resulting in the underlying cause given in Part I.				26. AUTOPSY (Specify Yes or No) No																																																																																																																																																																																							
27. WAS CASE REFERRED TO CORONER (Specify Yes or No) No																																																																																																																																																																																											
28a. ACC, SUICIDE, HOM., UNDET. OR PENDING INVEST. (Specify)		28b. DATE OF INJURY (Mo/Day/Yr)		28c. HOUR OF INJURY																																																																																																																																																																																							
28d. DESCRIBE HOW INJURY OCCURRED																																																																																																																																																																																											
28e. INJURY AT WORK (Specify Yes or No)		28f. PLACE OF INJURY - At home, farm, street, factory, office building, etc. (Specify)		28g. LOCATION STREET OR R.F.D. No. CITY OR TOWN STATE																																																																																																																																																																																							

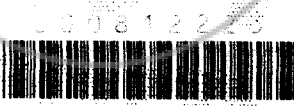

CERTIFIED COPY OF VITAL RECORDS

This is a true and exact reproduction of the document officially registered and placed on file in the office of the State Registrar and Vital Records.

DATE ISSUED:

4/13/2020

This copy is not valid unless prepared on engraved border displaying date, seal and signature of Registrar.

Blaise Satariano
STATE REGISTRAR

