

DOUGLAS COUNTY, NV **2020-955484**
RPTT:\$2047.50 Rec:\$40.00
\$2,087.50 Pgs=3 10/29/2020 02:37 PM
TICOR TITLE - GARDNERVILLE
KAREN ELLISON, RECORDER

WHEN RECORDED MAIL TO:
Patricia T. Pumphrey, Trustee of the Pumphrey Family
Trust

1105 Wisteria Drive

Minden, NV 89423

MAIL TAX STATEMENTS TO:
Same as above

Escrow No. 2006198-RLT

The undersigned hereby affirms that this document
submitted for recording does not contain the social
security number of any person or persons.
(Pursuant to NRS 239b.030)

APN No.: 1320-29-116-031
R.P.T.T. \$2,047.50

SPACE ABOVE FOR RECORDER'S USE ONLY

GRANT, BARGAIN, SALE DEED

THIS INDENTURE WITNESSETH: That Catherine Hopkins, Successor Trustee of The George S. and Catherine Hopkins Revocable Trust, dated February 14, 1994

FOR A VALUABLE CONSIDERATION, receipt of which is hereby acknowledged, do/does hereby Grant, Bargain, Sell and Convey to Patricia T. Pumphrey, Trustee of the Pumphrey Family Trust Agreement dated November 18, 1989

all that real property situated in the County of Douglas, State of Nevada, described as follows:
SEE EXHIBIT "A" ATTACHED HERETO AND BY REFERENCE MADE A PART HEREOF

Together with all and singular the tenements, hereditaments and appurtenances thereunto belonging or in anywise appertaining.

Signature and notary acknowledgement on page two.

Catherine Hopkins, Successor Trustee of
The George S. and Catherine Hopkins
Revocable Trust, dated February 14,
1994

Catherine Hopkins
Catherine Hopkins, Successor Trustee

CA 3-A
STATE OF ~~NEVADA~~ 3-A } ss:
COUNTY OF DOUGLAS Los Angeles

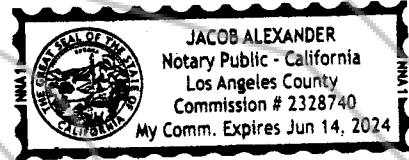

This instrument was acknowledged before me on, 10-20-2020
by Catherine Hopkins, Successor Trustee of The George S. and Catherine Hopkins Revocable Trust, dated February 14, 1994

[Signature]
NOTARY PUBLIC

This Notary Acknowledgement is attached to that certain Grant, Bargain, Sale Deed under escrow
No. 02006198.

Escrow No. 2006198-RLT

**EXHIBIT A
LEGAL DESCRIPTION**

All that certain real property situate in the County of Douglas, State of Nevada, described as follows:

Lot 241 as shown on the official plat of WINHAVEN, UNIT NO. 6, filed for record in the office of the County Recorder of Douglas County, Nevada on August 4, 1994, in Book 894 of Official Records at page 692, as Document No. 343273.

APN: 1320-29-116-031

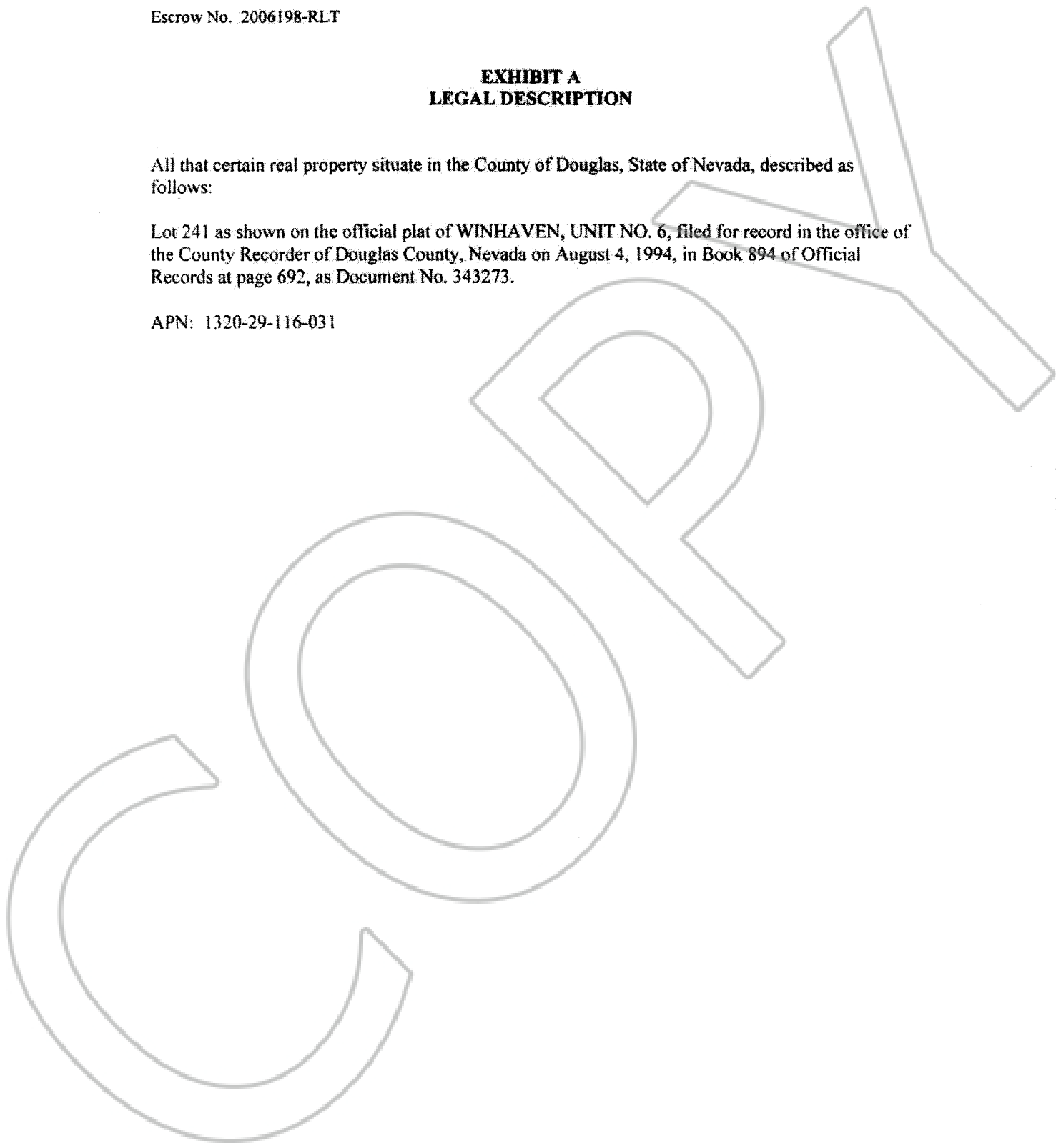

**STATE OF NEVADA
DECLARATION OF VALUE FORM**

1. Assessor Parcel Number(s)
 a. 1320-29-116-031
 b. _____
 c. _____
 d. _____

2. Type of Property:
 a. Vacant Land b. Single Fam. Res.
 c. Condo/Twnhse d. 2-4 Plex
 e. Apt. Bldg f. Comm'l/Ind'l
 g. Agricultural h. Mobile Home
 i. Other _____

FOR RECORDERS OPTIONAL USE ONLY	
Book _____	Page _____
Date of Recording: _____	
Notes: _____	

3. a. Total Value/Sales Price of Property: \$ 525,000.00
 b. Deed in Lieu of Foreclosure Only (value of property) \$ _____
 c. Transfer Tax Value \$ 525,000.00
 d. Real Property Transfer Tax Due: \$ 2,047.50

4. **If Exemption Claimed**
 a. Transfer Tax Exemption, per NRS 375.090, Section _____
 b. Explain Reason for Exemption: _____

5. Partial Interest: Percentage being transferred: _____ %

The undersigned declares and acknowledges, under penalty of perjury, pursuant to NRS 375.060 and NRS 375.110, that the information provided is correct to the best of their information and belief, and can be supported by documentation if called upon to substantiate the information provided herein. Furthermore, the parties agree that disallowance of any claimed exemption, or other determination of additional tax due, may result in a penalty of 10% of the tax due plus interest at 1% per month. Pursuant to NRS 375.030, the Buyer and Seller shall be jointly and severally liable for any additional amount owed.

Signature Catherine Hopkins Capacity Grantor
 Signature _____ Capacity _____

**SELLER (GRANTOR) INFORMATION
(REQUIRED)**
 Print Name: Catherine Hopkins, Successor Trustee
 of The George S. and Catherine Hopkins
 Revocable Trust, dated February 14, 1994
 Address: 18821 Gregory Ave
 City: Huntington Beach
 State: Zip: CA 92646

**BUYER (GRANTEE) INFORMATION
(REQUIRED)**
 Print Name: Patricia T. Pumphrey, Trustee of the
 Pumphrey Family Trust
 Address: 1105 Western Dr
 City: Minden
 State: Zip: NV 89423

COMPANY/PERSON REQUESTING RECORDING (Required if not Seller or Buyer)
 Print Name: Ticor Title of Nevada, Inc. Escrow No.: 02006198-020-RLT
 Address: 1483 US Highway 395 N, Suite B
 City, State, Zip: Gardnerville, NV 89410

AS A PUBLIC RECORD THIS FORM MAY BE RECORDED/MICROFILMED