

BASIS OF BEARINGS

THE BASIS OF BEARINGS FOR THIS SURVEY IS IDENTICAL TO PARCEL C OF PARCEL MAP FOR GLENBROOK COMPANY, FILED FOR RECORD FEBRUARY 19, 1980 AS DOCUMENT NO. 41653 IN THE OFFICE OF THE DOUGLAS COUNTY RECORDER.

REFERENCE DOCUMENTS

(1) PARCEL MAP FOR GLENBROOK COMPANY, FILED FOR RECORD FEBRUARY 19, 1980 AS DOCUMENT NO. 41653 IN THE OFFICE OF THE DOUGLAS COUNTY RECORDER.

- LEGEND**
- FOUND 5/8" REBAR WITH TAG, RLS 1255 OR AS NOTED
 - FOUND 5/8" REBAR & CAP, RLS 1586 WITH CONCRETE COLLAR
 - FOUND 1" CAPPED IRON PIPE, RLS 1586
 - FOUND 3/4" CAPPED IRON PIPE, PLS 3519
 - SET MAG NAIL & TAG, PLS 19734
 - SET 5/8" REBAR WITH CAP, PLS 19734
 - DIMENSION POINT, NOTHING FOUND OR SET

- NOTES:**
- NO EASEMENTS OF RECORD ARE SHOWN.
 - TOTAL AREA SURVEYED IS 2.35 ACRES (102,510 SQ. FT.)

SURVEYOR'S CERTIFICATE

I, TODD A. ENKE, A PROFESSIONAL LAND SURVEYOR, LICENSED IN THE STATE OF NEVADA, AS AN AGENT FOR RESOURCE CONCEPTS, INC, DO HEREBY CERTIFY THAT:

THIS PLAT REPRESENTS THE RESULTS OF A SURVEY CONDUCTED UNDER MY DIRECT SUPERVISION AT THE INSTANCE OF WILLIAM R. SCHUTTE AND MEGAN WALTON.

- THE LANDS SURVEYED LIE WITHIN A PORTION OF SECTION 10, T.14N., R.18E., M.D.M, DOUGLAS COUNTY NEVADA AND THE SURVEY WAS COMPLETED ON OCTOBER 7, 2020.
- THIS PLAT COMPLIES WITH THE APPLICABLE STATE STATUTES AND ANY LOCAL ORDINANCES IN EFFECT ON THE DATE THAT THE SURVEY WAS COMPLETED.
- THE MONUMENTS DEPICTED ON THE PLAT ARE OF THE CHARACTER SHOWN, OCCUPY THE POSITIONS INDICATED, AND ARE OF SUFFICIENT DURABILITY.
- THIS SURVEY WAS CONDUCTED IN ACCORDANCE WITH CHAPTER 625 OF THE NEVADA ADMINISTRATIVE CODE AND MEETS THE POSITIONAL CERTAINTY FOR A HIGH URBAN LAND BOUNDARY SURVEY.
- THIS RECORD OF SURVEY IS NOT IN CONFLICT WITH N.R.S. 625.340 AND NO NEW LOTS ARE BEING CREATED

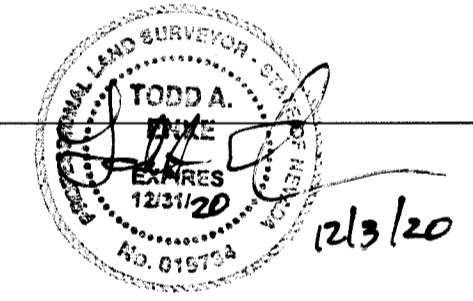

TODD A. ENKE, PLS 19734

COUNTY RECORDER'S CERTIFICATE

FILED THIS 4th DAY OF December 2020 AT 40 MINUTES PAST 3 O'CLOCK P.M., AS DOCUMENT NUMBER 2020-957647. RECORDED AT THE REQUEST OF WILLIAM R. SCHUTTE AND MEGAN WALTON.

Karen Ellison, Deputy
KAREN ELLISON
DOUGLAS COUNTY RECORDER

RCI
Resource Concepts Inc.
Carson City
340 N. Minnesota St. Carson
City, NV 89703-4152
775-883-1600
Lake Tahoe
276 Kingsbury Grade, Ste. 206
Stateline, NV 89449
775-588-7500

RECORD OF SURVEY
FOR
WILLIAM R. SCHUTTE & MEGAN WALTON
2059 PRAY MEADOW ROAD
LOCATED WITHIN A PORTION OF SECTION 10, T.14N., R.18E., M.D.M.
GLENBROOK DOUGLAS COUNTY NEVADA