

DOUGLAS COUNTY, NV

2021-962337

RPTT:\$0.00 Rec:\$40.00

\$40.00 Pgs=5

02/22/2021 03:43 PM

ETRCO

KAREN ELLISON, RECORDER

E05

APN# : 1022-13-001-026

RPTT: \$-0-

Recording Requested By:

Western Title Company

Escrow No. 124516-WLD

When Recorded Mail To:

Jess C. Merrithew

2572 Mt. Siegel Lane

Gardnerville, NV 89410

Mail Tax Statements to: (deeds only)

Same as Above

(space above for Recorder's use only)

I the undersigned hereby affirm that the attached document, including any exhibits, hereby submitted for recording does not contain the social security number of any person or persons.

(Per NRS 239B.030)

Signature

Wendy Dunbar

Escrow Officer

Grant, Bargain, and Sale Deed

This page added to provide additional information required by NRS 111.312 (additional recording fee applies)

GRANT, BARGAIN AND SALE DEED

THIS INDENTURE WITNESSETH: That Karena Merrithew, spouse of the grantee herein, in consideration of \$10.00, the receipt of which is hereby acknowledged, does hereby Grant, Bargain, Sell and Convey to Jess C. Merrithew, a married man as his sole and separate property all that real property situated in the City of Wellington, County of Douglas, State of Nevada described as follows:

See attached Exhibit A

TOGETHER with all and singular the tenements, hereditaments and appurtenances, if any, thereto belonging or appertaining, and any reversions, remainders, rents, issues or profits thereof.

Grantor and Grantee are wife and husband. It is the intention of Grantor that Grantee shall henceforth have and hold said real property as his sole and separate property. By this conveyance, Grantor releases any community interest that she might now have or be presumed to hereafter acquire in the above described property.

Dated: 02/15/2021

Karena Merrithew
Karena Merrithew

STATE OF Nevada } ss
COUNTY OF Douglas
This instrument was acknowledged before me on February
22, 2021 by Karena Merrithew.

[Signature]
Notary Public

 **WENDY DUNBAR**
Notary Public - State of Nevada
Appointment Recorded in Douglas County
No: 02-79065-5 - Expires Dec. 16, 2022

EXHIBIT "A"

All that certain real property situate in the County of Douglas, State of Nevada, described as follows:

PARCEL 1:

A parcel of land located within a portion of Section 13, Township 10 North, Range 22 East, MDM, Douglas County, Nevada, being more particularly described as follows:

Parcel 1 as shown on Parcel Map (LDA 18-0054) for Jess C. Merrithew and James C. Merrithew, filed for record in the office of the Douglas County Recorder, State of Nevada, on December 26, 2018 as Document No. 2018-923943, Official Records.

PARCEL 2:

All that certain lot, piece or parcel or land situate in the County of Douglas, State of Nevada, being all that portion of Section 13 and the East 1/2 of Section 14, Township 10 North, Range 22 East, M.D.B. & M., described as follows:

Non-exclusive easements for roadway and utility purposes and to provide access to State Route No. 3, for the benefit of and appurtenant to the property conveyed hereinabove and shall inure to the benefit of and be used by all persons who may become owners of said land or any parts or portions thereof said easements being 60 feet in width the centerline of which is described as follows:

Commencing at North 1/4 corner of said Section 14; thence South 89°51' East along the North line of said Section 14, a distance of 792.53 feet to a point; thence South 13°00' East 104.32 feet to a point on the Southerly right-of-way line of State Route No. 3, the true point of beginning; thence along said line South 13°00' East 360.80 feet; thence on a curve to the left the tangent of which bears the last described course having a radius of 500 feet through a central angle of 22°30'00" for an arc distance of 196.35 feet; thence South 35°30' East 2287.85 feet; thence on a curve to the left the tangent of which bears the last described course having a radius of 500 feet through a central angle of 29°15' for an arc distance of 255.25 feet; thence South 64°45' East 1559.09 feet; thence on a curve to the left the tangent of which bears the last described course having a radius of 500 feet through a central angle of 49°29'15" for an arc distance of 431.86 feet; thence North 65°45'45" East 1075.22 feet; thence on a curve to the left the tangent of which bears the last described course having a radius of 500 feet through a central angle of 16°40'22" for an arc distance of 145.50 feet; thence North 49°05'23" East a distance of 1161.73 feet to the true point of ending.

ALSO

Commencing at North 1/4 corner of said Section 14; thence South 89°51' East along the North line of said Section 14 a distance of 792.53 feet to a point; thence South 13°00' East 104.32 feet to a point on the Southerly right-of-way line of State Route No. 3; thence South 13°00' East 360.80 feet; thence on a curve to the left the tangent of which bears the last described course having a radius of 500 feet through a central angle of 07°04'13" for an arc distance of 61.70 feet to the true point of beginning; thence North 76°34' East 1706.97 feet; thence on a curve to the right the tangent of which bears the last described course having a radius of 500 feet through a central angle of 28°59'00" for an arc distance of 129.23 feet; thence South 74°27' East a distance of 3465.80 feet to the true point of ending.

Reference is made to Record of Survey filed in the office of the County Recorder of Douglas County, Nevada on October 10, 1969 under File No. 45991 and the above described easements shown as Bosler Way and Kyle Drive.

Assessor's Parcel Number(s):
1022-13-001-026

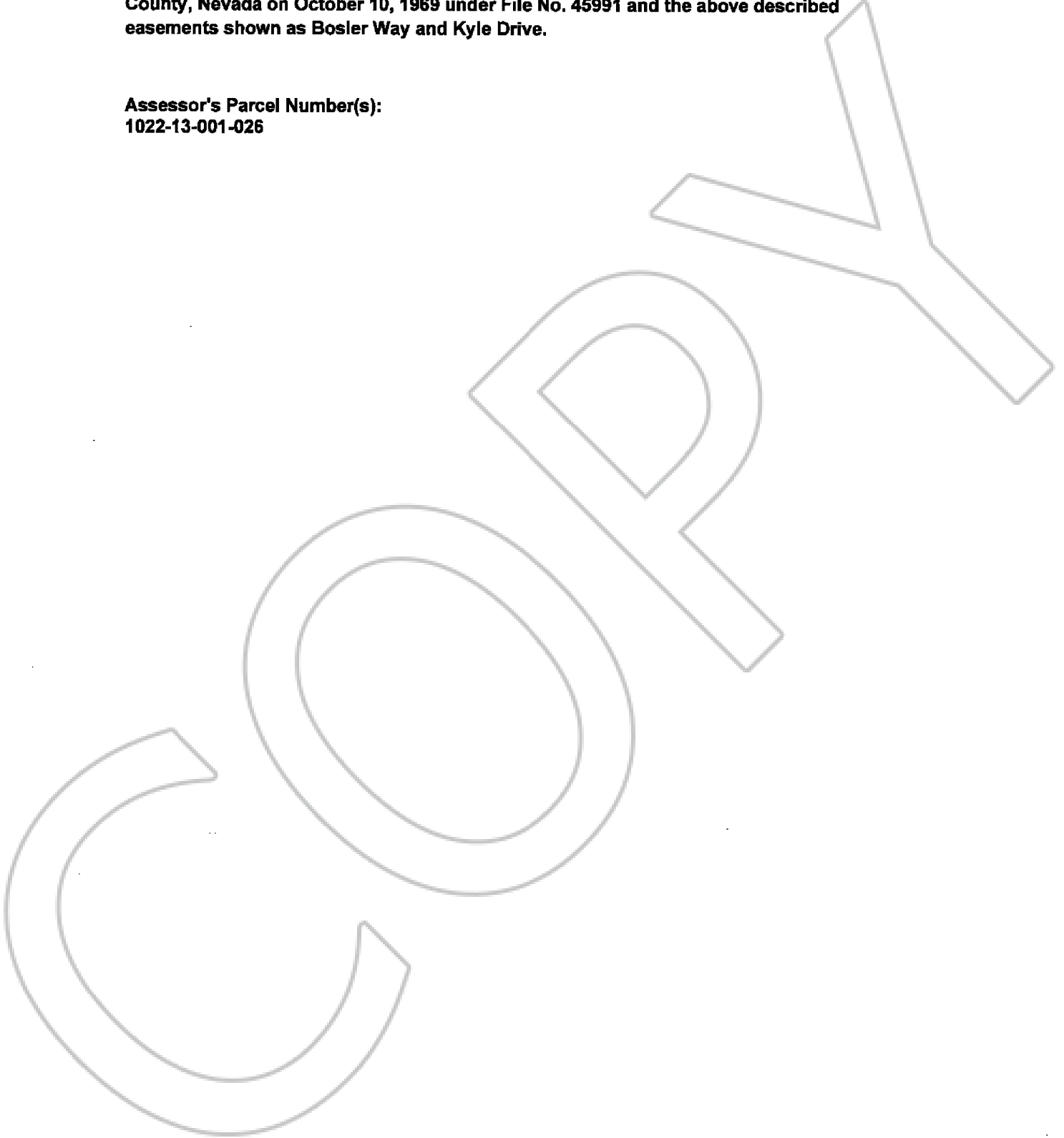

**STATE OF NEVADA
DECLARATION OF VALUE**

1. Assessors Parcel Number(s)

a) 1022-13-001-026

2. Type of Property:

- | | |
|--|--|
| a) <input checked="" type="checkbox"/> Vacant Land | b) <input type="checkbox"/> Single Fam. Res. |
| c) <input type="checkbox"/> Condo/Twnhse | d) <input type="checkbox"/> 2-4 Plex |
| e) <input type="checkbox"/> Apt. Bldg | f) <input type="checkbox"/> Comm'!/Ind'l |
| g) <input type="checkbox"/> Agricultural | h) <input type="checkbox"/> Mobile Home |
| i) <input type="checkbox"/> Other _____ | |

FOR RECORDERS OPTIONAL USE ONLY
NOTES: _____

3. Total Value/Sales Price of Property:

Deed in Lieu of Foreclosure Only (value of property)	\$ 0
Transfer Tax Value:	\$ 0
Real Property Transfer Tax Due:	\$ 0

4. If Exemption Claimed:

- a. Transfer Tax Exemption, per NRS 375.090, Section: #5
- b. Explain Reason for Exemption: wife deeding off to husband, no consideration

5. Partial Interest: Percentage being transferred: 100%

The undersigned declares and acknowledges, under penalty of perjury, pursuant to NRS 375.060 and NRS 375.110, that the information provided is correct to the best of their information and belief, and can be supported by documentation if called upon to substantiate the information provided herein. Furthermore, the disallowance of any claimed exception, or other determination of additional tax due, may result in a penalty of 10% of the tax due plus interest at 1% per month.

Pursuant to NRS 375.030, the Buyer and Seller shall be jointly and severally liable for any additional amount owed.

Signature: _____ Capacity: Escrow Agent

Signature: _____ Capacity: _____

SELLER (GRANTOR) INFORMATION

(REQUIRED)

Print Name: Karena Merrithew
 Address: 2572 Mt. Siegel Lane
 City: Gardnerville
 State: NV Zip: 89410

BUYER (GRANTEE) INFORMATION

(REQUIRED)

Print Name: Jess C. Merrithew
 Address: 2572 Mt. Siegel Lane
 City: Gardnerville
 State: NV Zip: 89410

COMPANY/PERSON REQUESTING RECORDING

(REQUIRED IF NOT THE SELLER OR BUYER)

Print Name: Western Title Company, LLC Esc. #: 124516-WLD
 Address: Douglas Office
1362 Highway 395, Ste. 109
 City/State/Zip: Gardnerville, NV 89410