

APN: 1320-36-002-048

RECORDING REQUESTED BY:

Craig Hodges & Maria Hodges
1830 Bitterbrush Ct.
Gardnerville, NV 89410



KAREN ELLISON, RECORDER

E07

AFTER RECORDATION, RETURN BY MAIL TO:

Craig J. Hodges & Maria E. Hodges, Trustees
1830 Bitterbrush Ct.
Gardnerville, NV 89410

SPACE ABOVE THIS LINE FOR RECORDER'S USE

GRANT, BARGAIN, SALE DEED

THIS INDENTURE WITNESSETH: On this 3RD day of JUNE, 2021, CRAIG HODGES and MARIA HODGES, husband and wife as community property with right of survivorship, do hereby Grant, Bargain, Sell and Convey to CRAIG J. HODGES and MARIA E. HODGES, Trustees of The Hodges 2001 Revocable Trust dated March 14, 2001, as amended, and to the heirs and assigns of such Grantee forever, his interest in all that real property situated in the County of Douglas, State of Nevada, bounded and described as follows:

SEE EXHIBIT "A" ATTACHED HERETO AND MADE A PART HEREOF.

Subject to Restrictions, Conditions, Covenants, Rights, Rights of Way, and Easements now of record, if any. TOGETHER with all and singular the tenements, hereditaments and appurtenances now of record, if any.

IN WITNESS WHEREOF, the said first party has signed and sealed these presents the day and year first above written.

Craig Hodges

Maria Hodges

STATE OF NEVADA)
) ss.
COUNTY OF DOUGLAS)

This instrument was acknowledged before me on the 3 day of June, 2021, by Craig Hodges and Maria Hodges.

Notary Public



EXHIBIT "A"

All that certain real property situate in the County of Douglas, State of Nevada, described as follows:

Lot 9, in Block I, as shown on the Map of WILDFLOWER RIDGE, UNIT 7A, filed for record in the office of the County Recorder on February 5, 1991, in Book 291, Page 313, Document No. 244241, Official Records of Douglas County, Nevada

Per NRS 111.312, this legal description was previously recorded at Document NO. 2018-911948, on 03/23/2018

APN: 1320-36-002-048

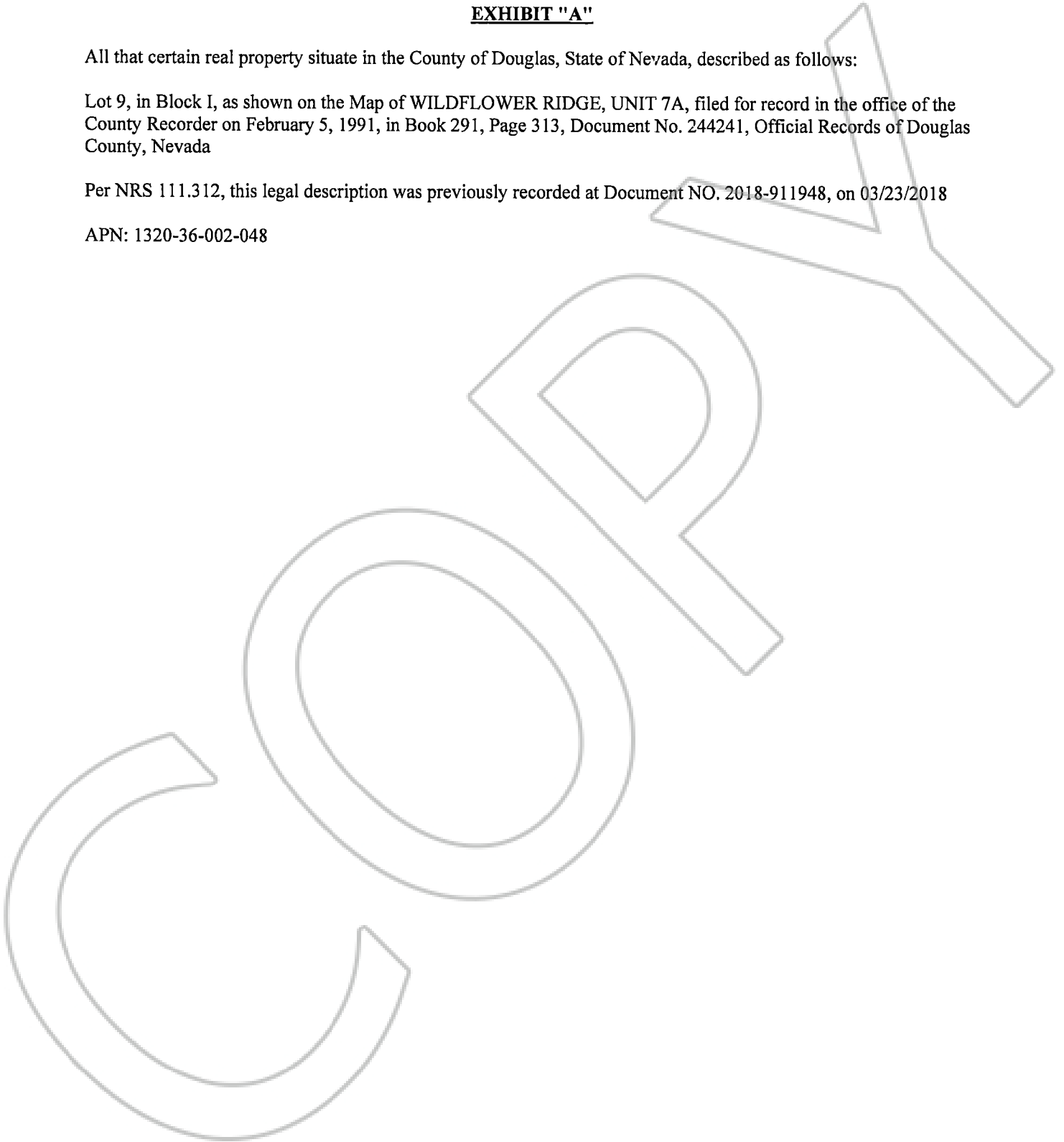

STATE OF NEVADA
DECLARATION OF VALUE

1. Assessor Parcel Number(s)
 a) 1320-36-002-048
 b) _____
 c) _____
 d) _____

2. Type of Property:
 a) Vacant Land b) Single Fam. Res.
 c) Condo/Twnhse d) 2-4 Plex
 e) Apt. Bldg f) Comm'l/Ind'l
 g) Agricultural h) Mobile Home
 i) Other _____

FOR RECORDERS OPTIONAL USE ONLY	
BOOK _____	PAGE _____
DATE OF RECORDING: _____	
NOTES: <u>Trust Cert of - KE</u>	

3. Total Value/Sales Price of Property: \$ _____
 Deed in Lieu of Foreclosure Only (value of property) (_____
 Transfer Tax Value: \$ _____
 Real Property Transfer Tax Due: \$ _____

4. If Exemption Claimed:
 a. Transfer Tax Exemption per NRS 375.090, Section # 7
 b. Explain Reason for Exemption: Transfer to trust without consideration

5. Partial Interest: Percentage being transferred: _____ %

The undersigned declares and acknowledges, under penalty of perjury, pursuant to NRS 375.060 and NRS 375.110, that the information provided is correct to the best of their information and belief, and can be supported by documentation if called upon to substantiate the information provided herein. Furthermore, the parties agree that disallowance of any claimed exemption, or other determination of additional tax due, may result in a penalty of 10% of the tax due plus interest at 1% per month.

Pursuant to NRS 375.030, the Buyer and Seller shall be jointly and severally liable for any additional amount owed.

Signature [Signature] Capacity Grantor

Signature [Signature] Capacity Grantor

SELLER (GRANTOR) INFORMATION
(REQUIRED)

BUYER (GRANTEE) INFORMATION
(REQUIRED)

Print Name: Graog Hodges & Maria Hodges
 Address: 1830 Bitterbrush Ct.
 City: Gardnerville
 State: NV Zip: 89410

Print Name: Graig J. Hodges & Maria E. Hodges, Trustees
 Address: 1830 Bitterbrush Ct.
 City: Gardnerville
 State: NV Zip: 89410

COMPANY/PERSON REQUESTING RECORDING

(required if not the seller or buyer)

Print Name: _____ Escrow # _____
 Address: _____
 City: _____ State: _____ Zip: _____

(AS A PUBLIC RECORD THIS FORM MAY BE RECORDED/MICROFILMED)