



KAREN ELLISON, RECORDER

When recorded, send to:
Douglas County – Community Development
1594 Esmeralda Avenue
Minden, Nevada 89423

CERTIFICATE OF AMENDMENT

To: Jeremy J. Hutchings, PE
Douglas County Engineer
Douglas County – Community Development #34
1594 Esmeralda Avenue
Minden, NV 89423

This is to amend the FINAL SUBDIVISION MAP LDA #04-064 for Holbrook Estates recorded in Book 1106 at Page 839 as Document No. 687834, Official Records of Douglas County, Nevada.

The Amendment is as follows:

- 1. On SHEET 1 of said map, Note #8 handwritten in states: “The Road Right-of-Way’s shown on this map are private roadways and shall not be subject to maintenance by Douglas County.” This note should not have been placed on the map and is hereby removed.

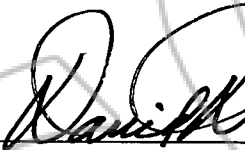
David D. Winchell, PLS 3209
Date: 7/14/21

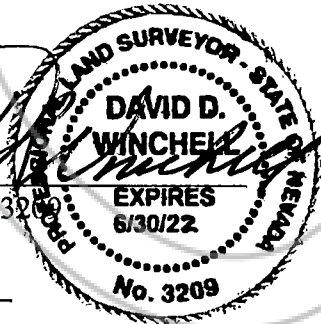

I hereby certify that I have examined the certificate of amendment and that the changes to the original document specified therein are provided for the applicable sections of NRS 278.010 to 278.630, inclusive, NRS 625.340 to 625.380, inclusive, and local ordinances adopted thereto, and I am satisfied this certificate so amends the document as to make it technically correct.

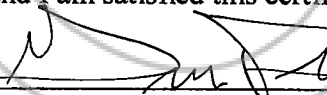
Gregory Phillips, P.L.S.
Douglas County Surveyor
Date: 07/22/21

