

DOUGLAS COUNTY, NV

2021-972193

RPTT:\$0.00 Rec:\$40.00

\$40.00 Pgs=3

08/09/2021 08:29 AM

AMROCK, LLC

KAREN ELLISON, RECORDER

E07

APN: 1320-30-312-007

R.P.T.T.: \$0.00

Exempt: (7)

Recording Requested By:

Jerry Van Sickle
1721 Westwood Drive
Minden, NV 89423

After Recording Mail To:

Jerry Van Sickle
1721 Westwood Drive
Minden, NV 89423

Send Subsequent Tax Bills To:

Jerry Van Sickle
1721 Westwood Drive
Minden, NV 89423

70291206-7198934

QUITCLAIM DEED

THIS INDENTURE WITNESSETH THAT, Jerry Van Sickle, Trustee of The Van Sickle Revocable Trust dated November 15, 2017, and any amendments thereto, FOR GOOD AND VALUABLE CONSIDERATION, the receipt of which is hereby acknowledged, do(es) hereby REMISE, RELEASE AND FOREVER QUITCLAIM to Jerry Van Sickle, an unmarried man, whose address is 1721 Westwood Drive, Minden, NV 89423,

ALL that real property situated in the County of Douglas, State of Nevada, bounded and described as follows:

SEE EXHIBIT "A" ATTACHED HERETO AND BY THIS REFERENCE MADE A PART HEREOF.

MORE commonly known as: 1721 Westwood Drive, Minden, NV 89423

Subject To: Restrictions, Conditions, Covenants, Rights, Rights of Way, and Easements now of record, if any.

TOGETHER with all and singular the tenements, hereditaments and appurtenances thereunto belonging or in anywise appertaining.

PRO

70291206QDXXV010103



(Attached to and becoming a part of Quitclaim Deed dated 5/21
between Jerry Van Sickle, Trustee of The Van Sickle Revocable Trust dated November 15, 2017,
and any amendments thereto, as Seller(s) and Jerry Van Sickle, an unmarried man, as
Purchaser(s).)

WITNESS my/our hands, this 3rd day of May, 2021.

Jerry Van Sickle
Jerry Van Sickle, Trustee

STATE OF Nevada)

COUNTY OF Douglas)
SS

This instrument was acknowledged before me, this 3 day of
May, 2021, by Jerry Van Sickle, Trustee.

NOTARY STAMP/SEAL

Sherril Macaluso
Notary Public

Notary Public
Title and Rank
My Commission Expires: 07/30/2023

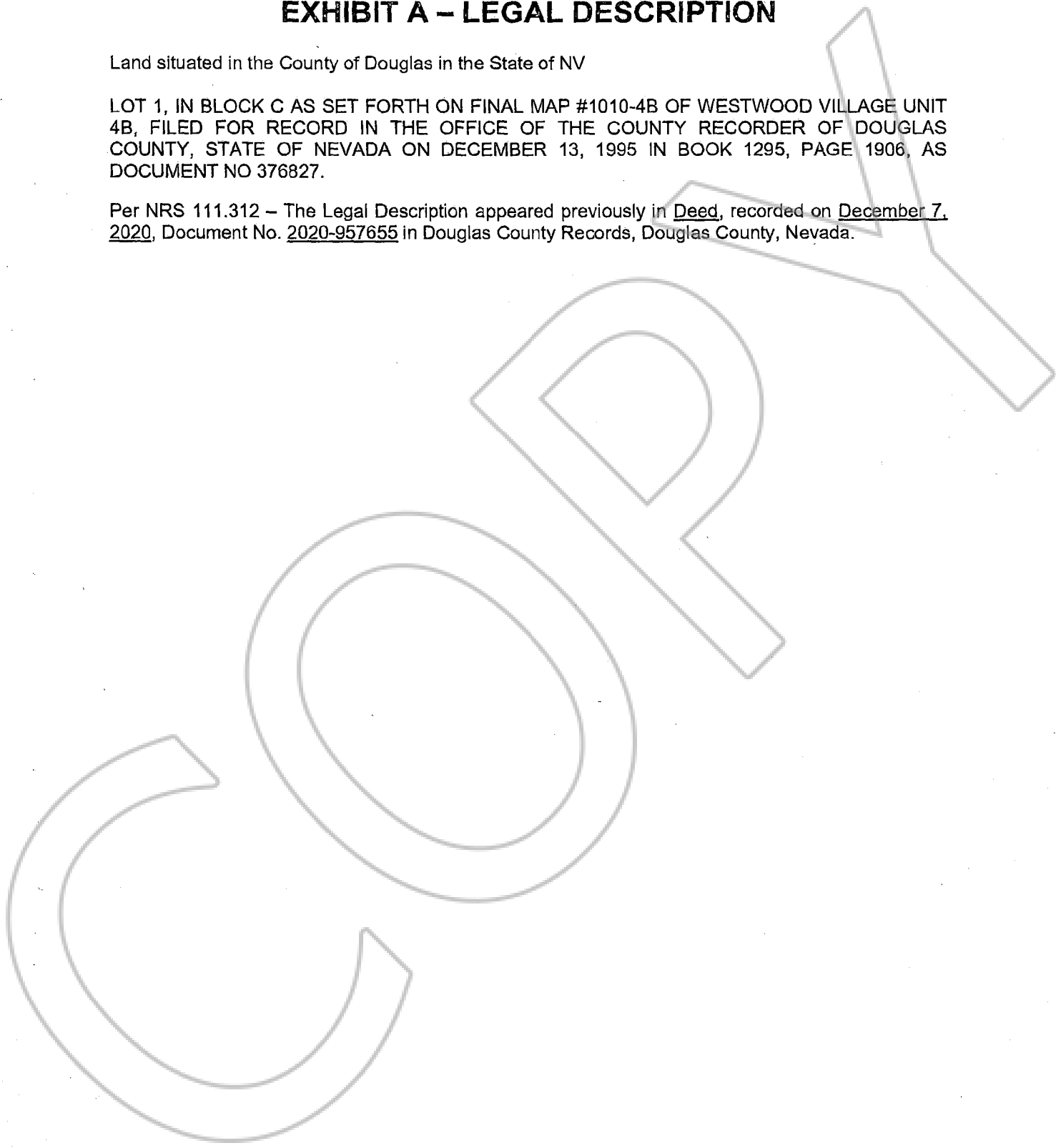

EXHIBIT A – LEGAL DESCRIPTION

Land situated in the County of Douglas in the State of NV

LOT 1, IN BLOCK C AS SET FORTH ON FINAL MAP #1010-4B OF WESTWOOD VILLAGE UNIT 4B, FILED FOR RECORD IN THE OFFICE OF THE COUNTY RECORDER OF DOUGLAS COUNTY, STATE OF NEVADA ON DECEMBER 13, 1995 IN BOOK 1295, PAGE 1906, AS DOCUMENT NO 376827.

Per NRS 111.312 – The Legal Description appeared previously in Deed, recorded on December 7, 2020, Document No. 2020-957655 in Douglas County Records, Douglas County, Nevada.



**STATE OF NEVADA
DECLARATION OF VALUE**

1. Assessor Parcel Number(s)
 a. 1320-30-312-007
 b. _____
 c. _____
 d. _____

2. Type of Property:
 a. Vacant Land b. Single Fam. Res.
 c. Condo/Twnhse d. 2-4 Plex
 e. Apt. Bldg f. Comm'l/Ind'l
 g. Agricultural h. Mobile Home
 Other

| | |
|---------------------------------|-------------|
| FOR RECORDERS OPTIONAL USE ONLY | |
| Book _____ | Page: _____ |
| Date of Recording: _____ | |
| Notes: 8/9/21 Trust Ok~A.B. | |

3. a. Total Value/Sales Price of Property \$ 0.00
 b. Deed in Lieu of Foreclosure Only (value of property (N/a))
 c. Transfer Tax Value: \$ 0.00
 d. Real Property Transfer Tax Due \$ 0.00

4. If Exemption Claimed:

- a. Transfer Tax Exemption per NRS 375.090, Section 7
 b. Explain Reason for Exemption: Transfers without consideration from a trust

5. Partial Interest: Percentage being transferred: 100 %

The undersigned declares and acknowledges, under penalty of perjury, pursuant to NRS 375.060 and NRS 375.110, that the information provided is correct to the best of their information and belief, and can be supported by documentation if called upon to substantiate the information provided herein. Furthermore, the parties agree that disallowance of any claimed exemption, or other determination of additional tax due, may result in a penalty of 10% of the tax due plus interest at 1% per month. Pursuant to NRS 375.030, the Buyer and Seller shall be jointly and severally liable for any additional amount owed.

Signature Jerry Van Sickle Capacity: GRANTOR
 Signature Jerry Van Sickle Capacity: GRANTEE

SELLER (GRANTOR) INFORMATION
(REQUIRED)
 Print Name: The Van Sickle Revocable Trust
 Address: 1721 Westwood Drive
 City: Minden
 State: NV Zip: 89423

BUYER (GRANTEE) INFORMATION
(REQUIRED)
 Print Name: Jerry Van Sickle
 Address: 1721 Westwood Drive
 City: Minden
 State: NV Zip: 89423

COMPANY/PERSON REQUESTING RECORDING (Required if not seller or buyer)
 Print Name: Amrock - Recording Department Escrow # 70291206
 Address: 662 Woodward Avenue
 City: Detroit State: MI Zip: 48226