

DOUGLAS COUNTY, NV **2021-975903**  
RPTT:\$2281.50 Rec:\$40.00  
\$2,321.50 Pgs=3 10/22/2021 02:32 PM  
STEWART TITLE COMPANY - NV  
KAREN ELLISON, RECORDER

<b>A.P.N. No.:</b>	1220-16-210-138
<b>R.P.T.T.</b>	\$2,281.50
<b>File No.:</b>	1400595 MDD
<b>Recording Requested By:</b>	
<b>Stewart Title Company</b>	
<b>Mail Tax Statements To:</b>	<i>Same as below</i>
<b>When Recorded Mail To:</b>	
Kyrene M. Hagerman and Nathan R. Goldstein	
1233 Monarch Lane	
Gardnerville, NV 89460	

## GRANT, BARGAIN, SALE DEED

THIS INDENTURE WITNESSETH: That

**Sierra Solitude, LLC, a Nevada limited liability company**

for valuable consideration, the receipt of which is hereby acknowledged, does hereby Grant, Bargain, Sell and Convey to

**Kyrene M. Hagerman, a single woman and Nathan R. Goldstein, a single man, as joint tenants**

all that real property situated in the County of Douglas, State of Nevada, bounded and described as follows:

See Exhibit "A" attached hereto and made a part hereof.

\*SUBJECT TO:

1. Taxes for the fiscal year;
2. Reservations, restrictions, conditions, rights, rights of way and easements, if any of record on said premises.

Together with all and singular the tenements, hereditaments and appurtenances thereunto belonging or in anywise appertaining, and any reversions, remainders, rents, issues or profits thereof.

Dated: September 28<sup>th</sup>, 2021

SIGNATURES AND NOTARY ON PAGE 2  
THIS GRANT BARGAIN SALE DEED MAY BE SIGNED IN COUNTERPART.

Sierra Solitude, LLC

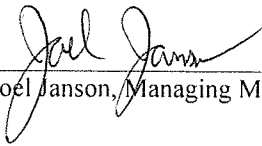
  
By Joel Janson, Managing Member

STATE OF Nevada } ss  
COUNTY OF Washoe

This instrument was acknowledged before me on

Sep. 29, 2021

By Joel Janson.

  
Notary Public



**EXHIBIT "A"**  
**LEGAL DESCRIPTION**

All that certain real property situate in the County of Douglas, State of Nevada, described as follows:

Lot 2, in Block I, as said lot and block are shown on the amended map of RANCHOS ESTATES, filed in the office of the County Recorder of Douglas County, State of Nevada, on October 30, 1972, as Document No. 62493.

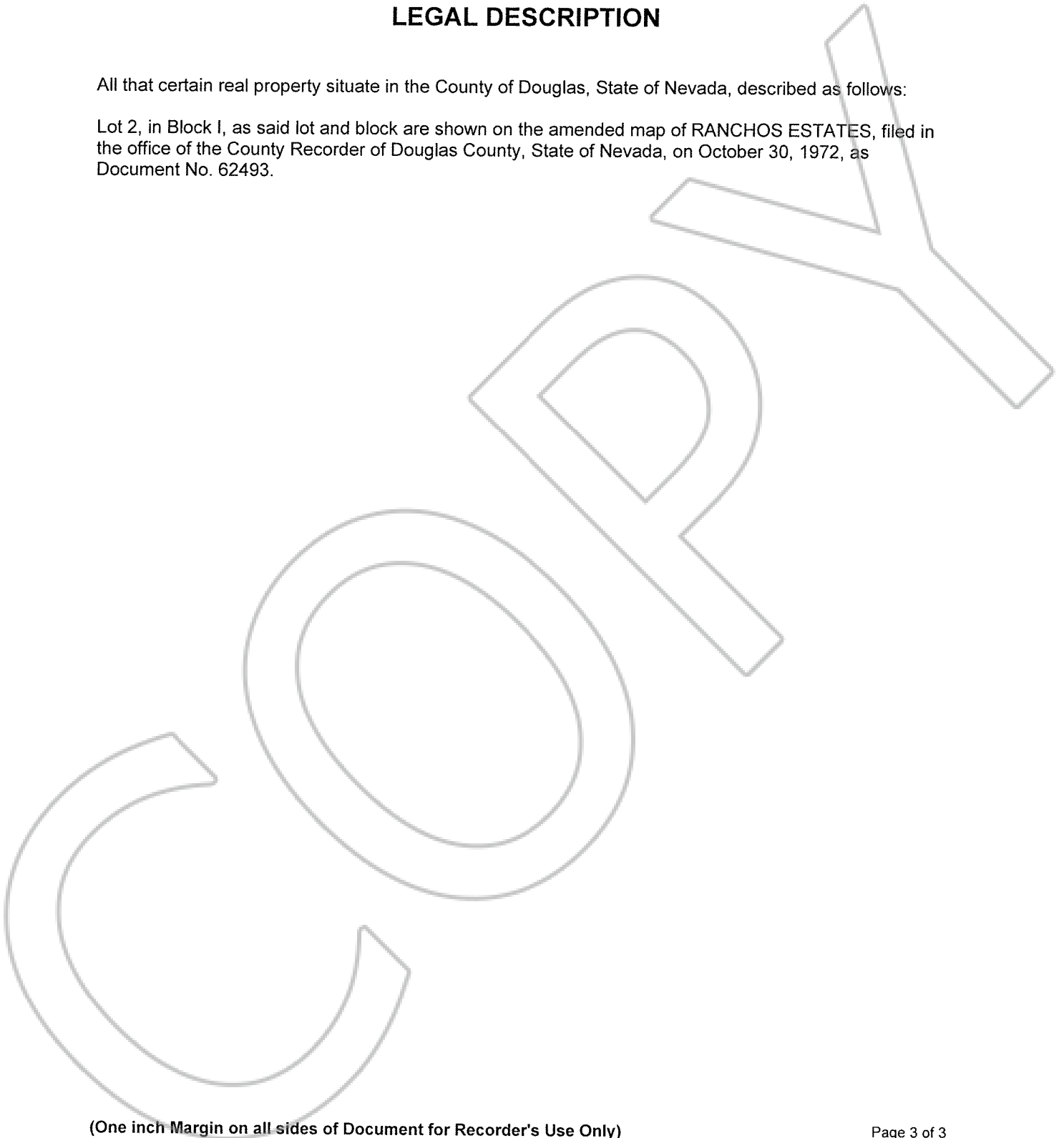

**STATE OF NEVADA  
DECLARATION OF VALUE FORM**

1. Assessor Parcel Number(s)  
 a) 1220-16-210-138  
 b) \_\_\_\_\_  
 c) \_\_\_\_\_  
 d) \_\_\_\_\_

2. Type of Property:  
 a.  Vacant Land                      b.  Single Fam. Res.  
 c.  Condo/Twnhse                    d.  2-4 Plex  
 e.  Apt. Bldg.                            f.  Comm'l/Ind'l  
 g.  Agricultural                        h.  Mobile Home  
 Other \_\_\_\_\_

**FOR RECORDERS OPTIONAL USE ONLY**  
 Book \_\_\_\_\_ Page: \_\_\_\_\_  
 Date of Recording: \_\_\_\_\_  
 Notes: \_\_\_\_\_

3. a. Total Value/Sales Price of Property                      \$ 585,000.00  
 b. Deed in Lieu of Foreclosure Only (value of property)    (                      )  
 c. Transfer Tax Value:    \$ 585,000.00  
 d. Real Property Transfer Tax Due                              \$ 2,281.50

4. **If Exemption Claimed:**  
 a. Transfer Tax Exemption per NRS 375.090, Section \_\_\_\_\_  
 b. Explain Reason for Exemption: \_\_\_\_\_

5. Partial Interest: Percentage being transferred: 100%  
 The undersigned declares and acknowledges, under penalty of perjury, pursuant to NRS 375.060 and NRS 375.110, that the information provided is correct to the best of their information and belief, and can be supported by documentation if called upon to substantiate the information provided herein. Furthermore, the parties agree that disallowance of any claimed exemption, or other determination of additional tax due, may result in a penalty of 10% of the tax due plus interest at 1% per month. Pursuant to NRS 375.030, the Buyer and Seller shall be jointly and severally liable for any additional amount owed.

Signature Kyrene MS Hagerman                      Capacity                      Grantor  
 Signature Nathan R. Goldstein                      Capacity                      Grantee

**SELLER (GRANTOR) INFORMATION**  
**(REQUIRED)**  
 Print Name: Sierra Solitude, LLC  
 Address: 9450 SW Gemini Drive, PMB 19391  
 City: Beaverton  
 State: OR                      Zip: 97008

**BUYER (GRANTEE) INFORMATION**  
**(REQUIRED)**  
 Print Name: Nathan Ray Goldstein and Kyrene Michelle Hagerman  
 Address: 1233 Monarch Lane  
 City: Gardnerville  
 State: NV                      Zip: 89460

**COMPANY/PERSON REQUESTING RECORDING (required if not seller or buyer)**  
 Print Name: Stewart Title Company                      Escrow # 1400595 MDD  
 Address: 5390 Kietzke Ln., Suite 101  
 City: Reno                      State: NV                      Zip: 89511

AS A PUBLIC RECORD THIS FORM MAY BE RECORDED/MICROFILMED