

DOUGLAS COUNTY, NV **2022-982012**
RPTT:\$2671.50 Rec:\$40.00
\$2,711.50 Pgs=3 03/03/2022 10:28 AM
TICOR TITLE - GARDNERVILLE
KAREN ELLISON, RECORDER

WHEN RECORDED MAIL TO:
Sheryl Christian
P.O. Box 424
Minden, 89423

MAIL TAX STATEMENTS TO:
Same as above

Escrow No. 2200590-RLT

The undersigned hereby affirms that this document submitted for recording does not contain the social security number of any person or persons.
(Pursuant to NRS 239b.030)

APN No.: 1220-24-601-017
R.P.T.T. \$2,671.50

SPACE ABOVE FOR RECORDER'S USE ONLY

GRANT, BARGAIN, SALE DEED

THIS INDENTURE WITNESSETH: That Michael J. Ciriello and Jeannette G. Ciriello, Trustees of The Michael and Jeannette Ciriello Revocable Trust, dated April 17,2004

FOR A VALUABLE CONSIDERATION, receipt of which is hereby acknowledged, do/does hereby Grant, Bargain, Sell and Convey to Sheryl Christian, Unmarried Woman

all that real property situated in the County of Douglas, State of Nevada, described as follows:
SEE EXHIBIT "A" ATTACHED HERETO AND BY REFERENCE MADE A PART HEREOF

Together with all and singular the tenements, hereditaments and appurtenances thereunto belonging or in anywise appertaining.

Signature and notary acknowledgement on page two.

Michael J. Ciriello and Jeannette G. Ciriello, Trustees of The Michael and Jeannette Ciriello Revocable Trust, dated April 17, 2004

Michael J. Ciriello and Jeannette G. Ciriello, Trustees of The Michael and Jeannette Ciriello Revocable Trust, dated April 17, 2004

Michael J. Ciriello
Michael J. Ciriello, Trustee

Jeannette G. Ciriello
Jeannette G. Ciriello, Trustee

STATE OF ~~NEVADA~~ CALIF ^{CR 2/28/2020} } ss:
COUNTY OF ~~DOUGLAS~~ SHASTA

This instrument was acknowledged before me on, FEB 28, 2022
by Michael J. Ciriello and Jeannette G. Ciriello, Trustees

Clinton J. Davis
NOTARY PUBLIC

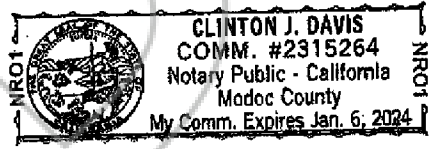

This Notary Acknowledgement is attached to that certain Grant, Bargain, Sale Deed under escrow No. 02200590.

Order No.: 02200590-RLT

EXHIBIT A

All that certain real property situate in the County of Douglas, State of Nevada, described as follows:

All that certain lot, piece or parcel of land situate in Section 24, Township 12 North, Range 20 East, M.D.B. & M., in the County of Douglas, State of Nevada described as follows:

Parcel 1, as set forth on that certain Parcel Map for EARL R. and PAULA J. McKIE, according to the map thereof, filed for record in the office of the County Recorder of Douglas County, State of Nevada, on December 12, 1991, in Book 1291, Page 1872, as Document No.266952.

APN: 1220-24-601-017

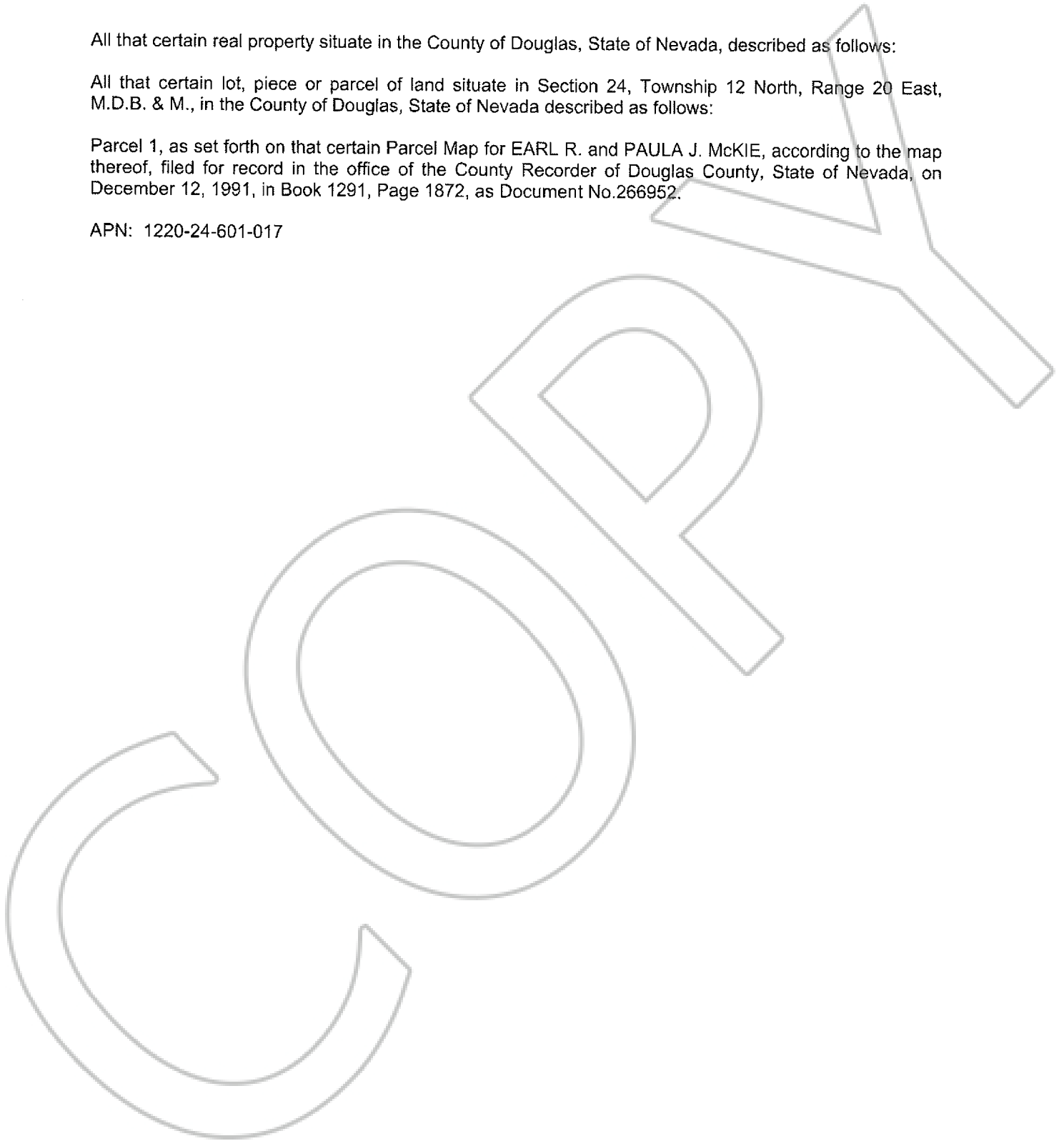

**STATE OF NEVADA
DECLARATION OF VALUE FORM**

1. Assessor Parcel Number(s)
 a. 1220-24-601-017
 b. _____
 c. _____
 d. _____

2. Type of Property:
 a. Vacant Land b. Single Fam. Res.
 c. Condo/Twnhse d. 2-4 Plex
 e. Apt. Bldg f. Comm'l/Ind'l
 g. Agricultural h. Mobile Home
 i. Other _____

FOR RECORDERS OPTIONAL USE ONLY	
Book _____	Page _____
Date of Recording: _____	
Notes: _____	

3. a. Total Value/Sales Price of Property: \$ 685,000.00
 b. Deed in Lieu of Foreclosure Only (value of property) \$ _____
 c. Transfer Tax Value \$ 685,000.00
 d. Real Property Transfer Tax Due: \$ 2,671.50

4. **If Exemption Claimed**
 a. Transfer Tax Exemption, per NRS 375.090, Section _____
 b. Explain Reason for Exemption: _____

5. Partial Interest: Percentage being transferred: 10%

The undersigned declares and acknowledges, under penalty of perjury, pursuant to NRS 375.060 and NRS 375.110, that the information provided is correct to the best of their information and belief, and can be supported by documentation if called upon to substantiate the information provided herein. Furthermore, the parties agree that disallowance of any claimed exemption, or other determination of additional tax due, may result in a penalty of 10% of the tax due plus interest at 1% per month. Pursuant to NRS 375.030, the Buyer and Seller shall be jointly and severally liable for any additional amount owed.

Signature [Signature] Capacity Agent
 Signature _____ Capacity _____

**SELLER (GRANTOR) INFORMATION
(REQUIRED)**
 Print Name: Michael J. Ciriello and Jeannette G. Ciriello, Trustees
 Address: PO Box 218
 City: Fall River Mills
 State: CA Zip: 96028

**BUYER (GRANTEE) INFORMATION
(REQUIRED)**
 Print Name: Sheryl Christian
 Address: P.O. Box 424
 City: Minden
 State: Zip: 89423

COMPANY/PERSON REQUESTING RECORDING (Required if not Seller or Buyer)
 Print Name: Ticor Title of Nevada, Inc. Escrow No.: 02200590-020-RLT
 Address: 1483 US Highway 395 N, Suite B
 City, State, Zip: Gardnerville, NV 89410

AS A PUBLIC RECORD THIS FORM MAY BE RECORDED/MICROFILMED