

SURVEYOR'S CERTIFICATE

1. JEFFERY W. TURNER, A PROFESSIONAL LAND SURVEYOR LICENSED IN THE STATE OF NEVADA, CERTIFY THAT:
 1. THIS IS A TRUE AND ACCURATE REPRESENTATION OF THE LANDS SURVEYED UNDER MY SUPERVISION AT THE INSTANCE OF SWEN TEMMEL.
 2. THE LANDS SURVEYED LIE WITHIN A PORTION OF SECTION 34, TOWNSHIP 14 NORTH, RANGE 18 EAST, M.D.M., AND THE SURVEY WAS COMPLETED ON AUGUST 19, 2020.
 3. THIS PLAT COMPLIES WITH THE APPLICABLE STATE STATUTES AND ANY LOCAL ORDINANCE AND IS NOT IN CONFLICT WITH THE PROVISIONS FOR N.R.S. 278.010 TO 278.630, INCLUSIVE.
 4. THE MONUMENTS ARE OF THE CHARACTER SHOWN AND OCCUPY THE POSITIONS INDICATED.

JEFFERY W. TURNER
 P.L.S. 21260

22 APRIL 22
 DATE

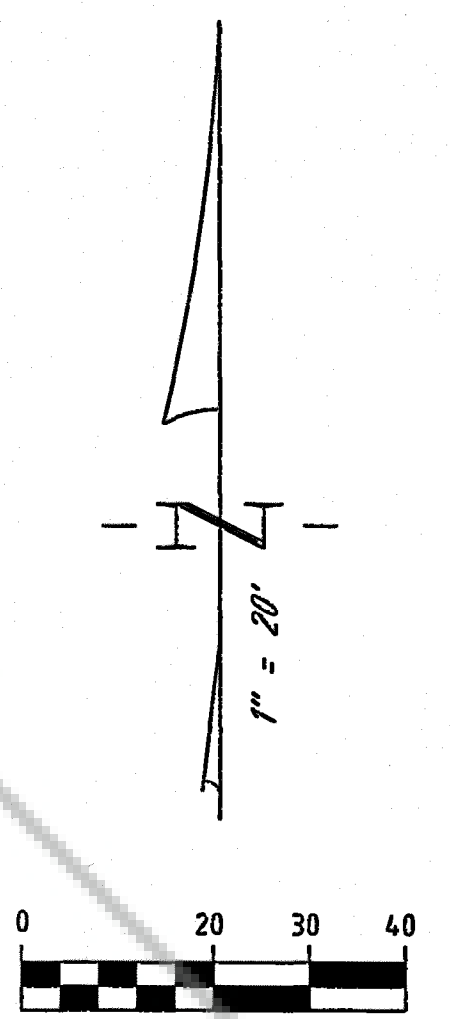
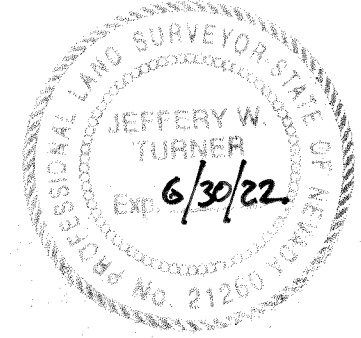

NRS 321.595

BOUNDARY BETWEEN BED OF LAKE TAHOE AND ADJACENT LANDS. THE BOUNDARY BETWEEN THE BED OF LAKE TAHOE, OWNED BY THE STATE OF NEVADA IN ITS SOVEREIGN CAPACITY, AND ADJACENT LANDS OWNED BY OTHERS OR BY THE STATE IN ANY OTHER CAPACITY, IS ESTABLISHED AS A LINE WHOSE ELEVATION IS 6,223 FEET, LAKE TAHOE DATUM.

LAKE TAHOE

APPROX. LOW-WATER LINE
 ILAKE ELEV. 6223' DATUM

PARCEL 1
 PER DOC. NO. 2019-931547
 TEMMEL, SWEN TTEE
 14,010 SQ. FT.
 APN 1418-34-210-011
 176 PINE POINT DR

LOT 11
 APN 1418-34-210-017
 NATHAN MASON BRILL

LOT 12
 APN 1418-34-210-016
 1260 TAMARACK LLC

LOT 9
 APN 1418-34-210-010
 ROBERT RODRIGUEZ & SUSAN BOYER

PINE POINT DR.

L=33.10'(R1)
 R=45.00'(R1)
 Δ=42°08'30"(R1)
 CH=N 42°37'34" E(C)
 CH=32.36'(C)

BASIS OF BEARINGS

THE MERIDIAN OF THIS SURVEY IS IDENTICAL WITH THAT OF LAKERIDGE ESTATES NO. 1 (REVISED PLAT), FILED FOR RECORD ON FEBRUARY 23, 1959 AS DOCUMENT NUMBER 14083.

REFERENCES

- (R1) LAKERIDGE ESTATES NO. 1 (REVISED PLAT), FILED FOR RECORD ON FEBRUARY 23, 1959 AS DOCUMENT NUMBER 14083.
- (R2) GRANT, BARGAIN AND SALE DEED, FILED FOR RECORD ON JULY 10, 2019 AS DOCUMENT NUMBER 2019-931547.

NOTE

THIS MAP IS BEING FILED TO DELINEATE PROPERTY LINES AS DESCRIBED IN DEEDS RECORDED IN THE OFFICIAL RECORDS OF DOUGLAS COUNTY, NEVADA.

COUNTY RECORDER'S CERTIFICATE

FILED FOR RECORD THIS 20th DAY OF April, 2022
 AT 7 MINUTES PAST 10 O'CLOCK A.M., AS DOCUMENT
 NUMBER 2022-984171

RECORDED AT THE REQUEST OF SWEN TEMMEL.

 DOUGLAS COUNTY RECORDER

SCALE: 1"=20' SHEET 1 OF 1

TURNER & ASSOCIATES, INC.
 LAND SURVEYING
 (775) 588-5658
 FAX (775) 588-9296
 308 DORLA COURT, SUITE 203 - ROUND HILL, NEVADA 89448
 P.O. BOX 5067 - STATELINE, NEVADA 89449
 JN:20168

RECORD OF SURVEY
 FOR
DANCING WATER TRUST
 PARCEL 1 PER DOCUMENT NUMBER 2019-931547,
 BEING LOT 10, LAKERIDGE ESTATES NO. 1 REVISED
 TO THE LOW-WATER LINE OF LAKE TAHOE
 PORTION OF SECTION 34, T.14N., R.18E., M.D.M.
 DOUGLAS COUNTY, NEVADA
 FILE NO. 20168 ROS.DWG APRIL 2022