



KAREN ELLISON, RECORDER

After recordation return to:
MAPCA Surveys, Inc.
Attn. James Bedard, PLS
580 Mt. Rose Street
Reno, Nevada 89509

CERTIFICATE OF AMENDMENT

May 19, 2022

Phil Reimer, PLS
Douglas County Surveyor
5510 Longley Lane
Reno, Nevada, 89511

RE: Final Subdivision Map PD 03-004 as modified under DP19-0477 for Clear Creek Tahoe Unit 4, recorded July 30, 2021 as Document No. 2021-971781, Official Records of Douglas County, Nevada, situate in the South 1/2 of Section 3, Township 14 North, range 19 East, Mount Diablo Base and Meridian

Dear Mr. Reimer,
In accordance with N.R.S. 278.371(2) and N.R.S. 278.473, I am notifying you that a 1-1/2" aluminum cap in a well were set at all centerline monument locations shown as being set on the above referenced map bearing the stamp "PLS 17044". A 5/8" rebar with cap stamped "PLS 17044" was set at all front lot corners along Headwaters Way and Twain Court that are noted as set on the above referenced map. The monuments were set under my supervision. I hereby accept the responsibility for setting of these monuments.

The correction does not change or purport to change any property line or boundary line.

Respectfully Submitted,

James R. Bedard, P.L.S.
Nevada Certificate No. 17044

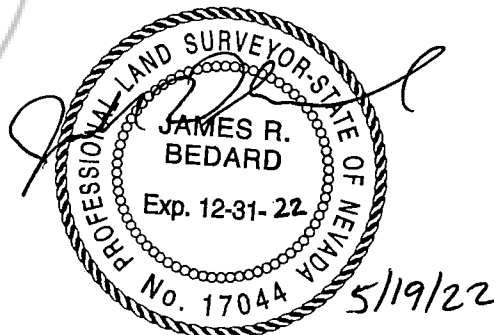

COUNTY SURVEYOR'S STATEMENT:

I hereby certify that I have examined the certificate of amendment and that the changes to the original document specified therein are provided for the in applicable sections of N.R.S. 278.010 to 278.630 inclusive, 625.340 to 625.380, inclusive, and for local ordinances adopted pursuant thereto, and I am satisfied that this certificate of amendment so amends or corrects the document as to make it technically correct.

Phil Reimer, P.L.S.
Nevada Certificate No. 013869

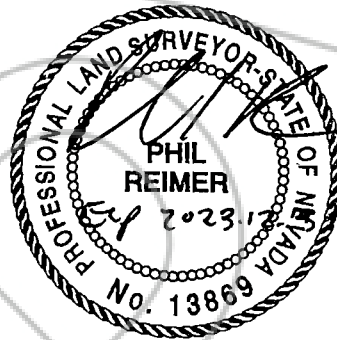

2022.05.19