



00155333202209856910020026

KAREN ELLISON, RECORDER

DECLARATION OF HOMESTEAD

Assessor's Parcel Number (APN):

1320-02-002-018 or

Assessor's Manufactured Home ID Number:

Recording Requested by and Mail to:

Name: ROGER V. & ELIZABETH K. WATTS

Address: 1691 DEVON COURT

City/State/Zip: MINDEN, NV 89423

Check One:

- Married (filing jointly)       Married (filing individually)
- Widowed       Single Person       Multiple Single Persons       Head of Family
- By Wife (filing jointly for benefit of both)       By Husband (filing jointly for benefit of both)
- Other (describe): \_\_\_\_\_

Check One:

- Regular Home Dwelling/Manufactured Home       Condominium Unit       Other

Name on Title of Property:

ROGER V. WATTS JR. & ELIZABETH K. WATTS

do individually or severally certify and declare as follows:

is/are now residing on the land, premises (or manufactured home) located in the city/town of MINDEN, county of DOUGLAS, State of Nevada, and more particularly described as follows: (set forth legal description and commonly known street address or manufactured home description)

Two story, 4 bedroom, 2.5 bath, stucco at 1691 Devon Court  
Exhibit "A"

I/We claim the land and premises hereinabove described, together with the dwelling house thereon, and its appurtenances, or the described manufactured home as a Homestead.

In witness, Whereof, I/we have hereunto set my/our hands this 27 day of May, 2022

[Signature]  
Signature  
[Signature]  
Signature

ROGER WATTS  
Print or type name here  
Elizabeth Watts.  
Print or type name here

STATE OF NEVADA, COUNTY OF Douglas  
me on 5-27-2022  
(date)

This instrument was acknowledged before

Notary Seal

By Roger V. Watts Jr.  
Person(s) appearing before notary  
By Elizabeth K. Watts  
Person(s) appearing before notary  
[Signature]  
Signature of notarial officer

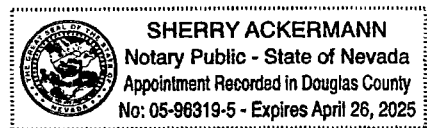

CONSULT AN ATTORNEY IF YOU DOUBT THIS FORM FITS YOUR PURPOSE.

NOTE: Do not write in 1-inch margin. Revised Sept. 2019

**EXHIBIT "A"**

**The land referred to herein is situated in Douglas County, State of Nevada, and is described as follows:**

Situate in the Southeast 1/4 of the Northeast 1/4 of the Southwest 1/4 of Section 2, Township 13 North, Range 20 East, M.D.B. & M., described as follows:

Parcel No. 4, as set forth on Parcel Map #1020 for DANIEL AND KATHY BARNES, recorded September 16, 1996, in Book 996, Page 1906, Document No. 396356 of Official Records.

Assessor's Parcel No. 1320-02-002-018

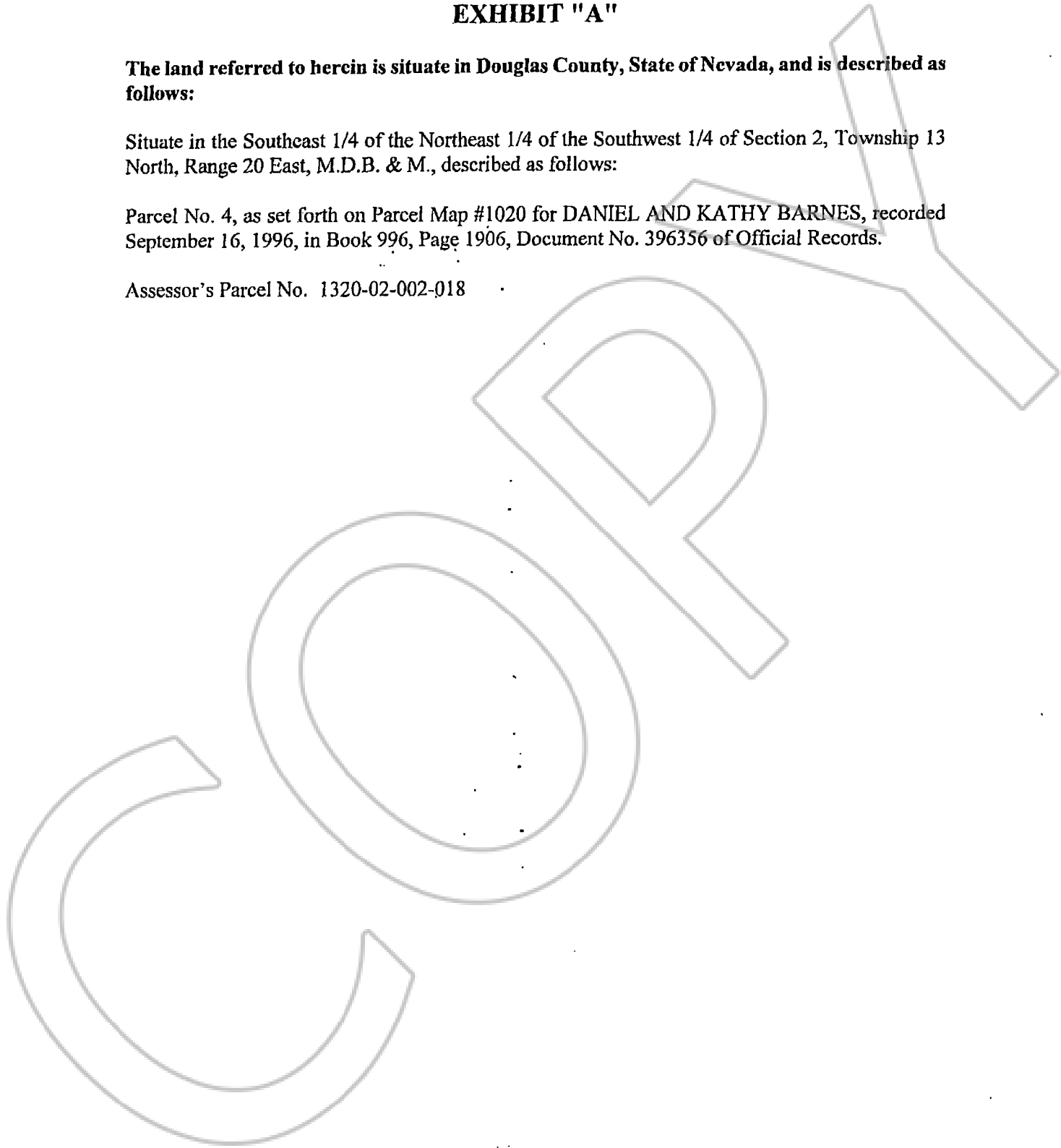

0605923  
BK0204 PG12898