



KAREN ELLISON, RECORDER

A.P.N. 1220-09-302-006

After Recording Return To:  
DRESSLER FLATS LLC  
P.O. Box 489  
Minden, NV 89423

**DEED RESTRICTION**

I, the undersigned, Leo A. Hanly, Manager of Santa Ynez Valley Construction Company, am the owner of that certain real property situate in the County of Douglas, State of Nevada, described as follows:

**SEE ATTACHED EXHIBIT "A" MADE A PART HEREOF**

Owner, by its execution hereof, does hereby acknowledge and agree that the following deed restriction shall apply to the herein above-described property:

"Douglas County has declared it a policy to protect and encourage agricultural operations. If your property is located near an agricultural operation, you may at some time be subject to inconvenience or discomfort arising from agricultural operations. If conducted in a manner consistent with proper and accepted standards, these inconveniences and discomforts do not constitute a nuisance for purpose of the Douglas County Code."

Dated: 4/18/22

[Signature]  
By: Leo A. Hanly  
Its: Manager

STATE OF NEVADA )  
: SS  
COUNTY OF DOUGLAS)

This instrument was acknowledged before me on April 18, 2022, by Leo A. Hanly.

STATE OF NEVADA )  
: SS  
COUNTY OF DOUGLAS)

JANE GRAY  
NOTARY PUBLIC  
STATE OF NEVADA  
County of Douglas  
My Commission Expires: August 21, 2023  
Certificate No: 15-2416-5

[Signature]  
NOTARY PUBLIC

EXHIBIT "A"

2255-013  
04/08/22

**DESCRIPTION**  
**(A.P.N.1220-09-302-006)**

All that real property situate in the County of Douglas, State of Nevada, described as follows:

A parcel of land located within a portion of Section 9, Township 12 North, Range 20 East, Douglas County, Nevada, described as follows:

Adjusted Parcel 2 as shown on the Record of Survey to Support a Boundary Line Adjustment for Bently Family Limited Partnership filed for record March 23, 2001, in the office of Recorder, Douglas County, Nevada as Document No. 510913.

Prepared By: R.O. ANDERSON ENGINEERING, INC.  
Andrew R. Lindsay, P.L.S. 151441  
P.O. Box 2229  
Minden, Nevada 89423

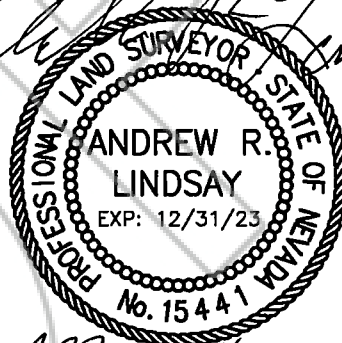

*APRIL 14, 2022*