

DOUGLAS COUNTY, NV **2022-991271**
Rec:\$40.00
\$40.00 Pgs=9 10/31/2022 03:33 PM
STEWART TITLE COMPANY - NV
KAREN ELLISON, RECORDER

A.P.N. No.:	1320-30-801-008
File No.:	1841433 AMG
Recording Requested By:	
Stewart Title Company	
When Recorded Mail To:	
George and Judy Keele	
1512 Wildrose Drive	
Gardnerville, NV 89410	

(for recorders use only)

**Affidavit Terminating Joint Tenancy
(Title of Document)**

Please complete Affirmation Statement below:

I the undersigned hereby affirm that the attached document, including any exhibits, hereby submitted for recording does not contain the social security number of any person or persons. (Per NRS 239B.030)

-OR-

I the undersigned hereby affirm that the attached document, including any exhibits, hereby submitted for recording does contain the social security number of a person or persons as required by law: NRS 440.380
(State specific law)

Signature

Amy Gutierrez
Print Signature

Escrow Officer
Title

**Rerecording Affidavit Terminating Joint Tenancy Recorded
on 1/6/1995 as Document No. 353918 Official Records
Douglas County Nevada to correct legal description**

This page added to provide additional information required by NRS 111.312 Sections 1 - 2 and NRS 239B.030 Section 4.

This cover page must be typed or printed in black ink.

(Additional recording fee applies)

A.P.N. 1320-30-801-008

LEGAL DESCRIPTION
(LOT 3-B-2, as shown on Document No. 223820)

Being that portion of the South $\frac{1}{2}$ of the Southeast $\frac{1}{4}$ of Section 30, Township 13 North, Range 20 East, M.D.B. & M. in the County of Douglas, State of Nevada, more particularly described as follows:

That portion of PARCEL 3-B as said parcel is shown on the PARCEL MAP FOR CENTER 88 which was recorded in Book 1085 at Page 3024 as Document No. 126041 in the Official Record of said Douglas County, described as follows:

Beginning at the Northeasterly corner of said PARCEL 3-B, said corner being on the Southerly right-of-way line of County Road; thence Southerly along the Easterly line of said PARCEL 3-B S.03°16'25" E., 163.52 feet to the Southeasterly corner of said PARCEL 3-B; thence Westerly along the Southerly line of said PARCEL 3-B S.74°50'00" W., 62.63 feet; thence N.15°10'00" W., 44.50 feet; thence N.74°50'00" E., 22.00 feet; thence N.15°10'00" W., 17.00 feet; thence N.33°43'20" W., 59.56 feet; thence N.26°04'18" W., 42.82 feet to a point on the Northerly line of said PARCEL 3-B, said line also being the Southerly right-of-way line of County Road; thence Easterly along said right-of-way line N.74°50'00" E., 101.38 feet to the Point of Beginning.

Said Lot contains 11,678 Sq.Ft. (0.27 Ac.), more or less.

Note: The parcel described above is shown as LOT 3-B-2 on the RECORD OF SURVEY FOR CAMBRIDGE COURT which was recorded in Book 490 at Page 1653 as Document No. 223820 in the Official Records of said Douglas County

Together with a private access easement, variable in width, over that portion of said PARCEL 3-B described as follows:

Beginning at the Northwesterly corner of said PARCEL 3-B, said corner being on the Southerly right-of-way line of County Road; thence Easterly along said right-of-way line N.74°50'00" E., 22.00 feet; thence leaving said right-of-way line S.15°10'00" E., 115.51 feet; thence N.74°50'00" E., 53.05 feet to a corner on the Westerly line of LOT 3-B-2 as said lot is shown on EXHIBIT A, attached hereto; thence Southerly along said Westerly line S.15°10'00" E., 25.00 feet; thence S.74°50'00" W., 75.05 feet to a point on the Westerly line of said PARCEL 3-B; thence Northerly along said Westerly line N.15°10'00" W., 140.51 feet to the Point of Beginning.

And reserving from the above described parcel, for the benefit of LOT 3-B-1 as said lot is shown on EXHIBIT A, attached hereto, a Private Access Easement over the following described portion thereof:

Beginning at the Northeasterly corner of said PARCEL 3-B; thence Southerly along the Easterly line of said PARCEL 3-B S.03°16'25" E., 118.04 feet to the True Point of Beginning; thence continuing Southerly along said Easterly line S.03°16'25" E., 25.55 feet; thence leaving said Easterly line S.74°50'00" W., 66.73 feet to a point on the Westerly line of LOT 3-B-2 as said lot is shown on said EXHIBIT A; thence Northerly along said Westerly line N.15°10'00" W., 25.00 feet to a corner on said Westerly line; thence N.74°50'00" E., 72.00 feet to the True Point of Beginning..

Per NRS 111.312, this legal description was prepared by Western Surveying Services, whose mailing address in P.O. Box 6202, Gardnerville, Nevada 89460.



David D. Winchell, P.L.S. 3209

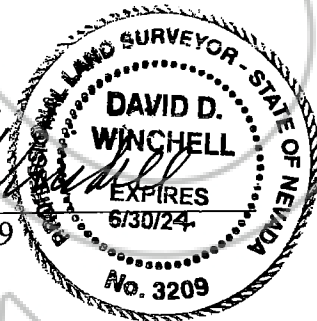

10/13/2022

Date

When Recorded Mail To:

✓ GEORGE M. KEELE, ESQ.
1692 County Road
Minden, Nevada 89423

AFFIDAVIT TERMINATING JOINT TENANCY

STATE OF NEVADA)
 : ss
COUNTY OF DOUGLAS)

We, VINCENT S. KEELE, GEORGE M. KEELE and JUDY S. KEELE, do hereby swear under penalty of perjury that the assertions of this Affidavit are true. We are over the age of 21 years and competent to be witnesses as to the matters hereinafter stated.

We are the persons named as VINCENT S. KEELE, GEORGE M. KEELE and JUDY S. KEELE, three of the four joint tenants on that certain deed recorded in the Office of the Recorder of Douglas County, State of Nevada, as File No. 223843, on April 13, 1990, wherein VINCENT S. KEELE, TEDDYANNA P. KEELE, GEORGE M. KEELE and JUDY S. KEELE were named as joint tenants with the right of survivorship as to an undivided fifty percent (50%) interest in all that real property situate in the Town of Minden, Douglas County, State of Nevada, described as follows:

See Exhibit "A" attached hereto and made a part hereof.

APN 25-461-23
(formerly a portion of Assessor's Parcel No.
25-461-20)

That TEDDYANNA P. KEELE is the decedent named in that Death Certificate, a certified copy of which is annexed hereto as Exhibit "B" and made a part hereof, as if set forth in full, verbatim.

We are the surviving joint tenants of said decedent TEDDYANNA P. KEELE who died on the 15th day of May, 1994.

VINCENT S. KEELE

GEORGE M. KEELE

JUDY S. KEELE

ACKNOWLEDGMENT

STATE OF NEVADA)
 :
COUNTY OF DOUGLAS) ss.

This instrument was acknowledged before me on the 6th day of January, 1995, by VINCENT S. KEELE, GEORGE M. KEELE and JUDY S. KEELE.

NOTARY PUBLIC

(My Commission expires: 10-29-97)

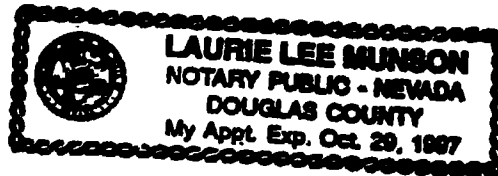
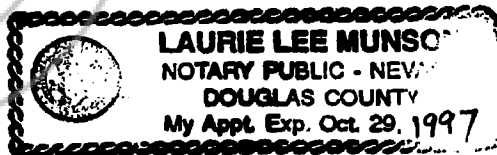

EXHIBIT "A"

PAGE 1 of 2

All that certain lot, piece, parcel or portion of land situate, lying and being within Section 30, Township 13 North, Range 20 East, M.D.B. & M., Douglas County, Nevada and more particularly described as follows:

A portion of Lot 3 of the Belarra Subdivision Unit No. 1 as shown on the final map filed for record in Book 277, page 1274 as document number 07213, Official Records of Douglas County, Nevada and also being a portion of Parcel 3-B of the Parcel Map for the 88 Center filed for record in Book 1085, page 3024 as document number 126041, Official Records of Douglas County, Nevada and more particularly described as follows:

Commencing at the southeast corner of Parcel 3-B as shown on the aforesaid Parcel Map, which point is the TRUE POINT OF BEGINNING; thence along the south line of said parcel
South 74°50'00" West a distance of 75.05 feet thence leaving said south line
North 15°10'00" West a distance of 44.50 feet; thence
North 74°50'00" East a distance of 22.00 feet; thence
North 15°10'00" West a distance of 17.00 feet; thence
North 33°43'20" West a distance of 59.56 feet; thence
North 26°04'18" West a distance of 42.82 feet to the north line of said Parcel 3-B; thence along said north line
North 74°50'00" East a distance of 101.38 feet to the northeast corner of said parcel; thence along the east line of said parcel
South 03°16'25" East a distance of 163.52 feet to the TRUE POINT OF BEGINNING and containing 11,678 square feet more or less which equals 0.268 acres.

Together with a private access easement over that portion of aforesaid Parcel 3-B described as follows:

Commencing at the northwest corner of Parcel 3-B as shown on the aforesaid Parcel Map, which point is the TRUE POINT OF BEGINNING; thence along the north line of said parcel
North 74°50'00" East a distance of 25.00 feet thence leaving said north line
South 15°10'00" West a distance of 115.51 feet; thence
North 74°50'00" East a distance of 50.05 feet to the west line of above described Parcel 3-B-2; thence along said line
South 15°10'00" East a distance of 25.00 feet; thence leaving

EXHIBIT "A"

Page 2 of 2

said line

South 74°50'00" West a distance of 75.05 feet to the west line of aforesaid Parcel 3-B; thence along said line North 15°10'00" West a distance of 140.51 feet to the TRUE POINT OF BEGINNING and containing 4,764 square feet more or less which equals 0.109 acres.

And reserving from the above described Parcel 3-B-2 a private access easement over the following described portion thereof:

Commencing at the northeast corner of said Parcel 3-B-2; thence along the east line of said parcel South 03°16'25" East a distance of 118.04 feet to the TRUE POINT OF BEGINNING; thence continuing along said east line South 03°16'25" East a distance of 25.55 feet; thence leaving said east line South 74°50'00" West a distance of 66.73 feet to the west line of said parcel; thence along said line North 15°10'00" West a distance of 25.00 feet; thence North 74°50'00" East a distance of 72.00 feet to the TRUE POINT OF BEGINNING and containing 1,734 square feet more or less which equals 0.040 acres.

Assessor's Parcel No. 25-461-23

STATE OF NEVADA

DEPARTMENT OF HUMAN RESOURCES DIVISION OF HEALTH VITAL STATISTICS

STATE OF NEVADA — DEPARTMENT OF HUMAN RESOURCES DIVISION OF HEALTH — SECTION OF VITAL STATISTICS CERTIFICATE OF DEATH

ROLL 81 IMAGE 960 LOCAL FILE NUMBER 1039 STATE FILE NUMBER 94 004917

TYPE OR PRINT IN PERMANENT BLACK INK

IF DEATH OCCURRED IN INSTITUTION SEE HANDBOOK REGARDING COMPLETION OF RESIDENCE ITEMS

PARENTS

DISPOSITION

CERTIFIER

CONDITIONS IF ANY WHICH GAVE RISE TO IMMEDIATE CAUSE STATING THE UNDERLYING CAUSE LAST

CAUSE OF DEATH

1. DECEASED—NAME First Middle Last Teddyanna Pease KEELE		2. DATE OF DEATH (Month, Day, Year) May 15, 1994		3. COUNTY OF DEATH Washoe	
1b. CITY, TOWN, OR LOCATION OF DEATH Incline Village		1c. HOSPITAL OR OTHER INSTITUTION—Name (If not either, give street and number) 914 Northwood Boulevard		1d. If Hosp. or Inst. indicate DOA, OP/Emar, Rm., Inpatient (Specify) 7	
1e. SEX Female		4. AGE—Last Birthday (Years) 72		5. DATE OF BIRTH (Mo., Day, Yr.) July 21, 1921	
6. RACE—(e.g., White, Black, American Indian, etc.) (Specify) White		7. Was Decedent of Hispanic Origin? Specify <input type="checkbox"/> yes <input checked="" type="checkbox"/> no Specify Mexican, Cuban, Puerto Rican, etc.		8. Decedent's Education, Specify highest grade completed. 17	
9. STATE OF BIRTH (If not U.S.A., name country) Montana		10. CITIZEN OF WHAT COUNTRY U.S.A.		11. MARRIED, NEVER MARRIED, WIDOWED, DIVORCED (Specify) Married	
12. SOCIAL SECURITY NUMBER 4873		13. USUAL OCCUPATION (Give Kind of Work Done During Most of Working Life, Even If Retired) High School Teacher		14. KIND OF BUSINESS OR INDUSTRY County School District	
15a. RESIDENCE—STATE Nevada		15b. COUNTY Washoe		15c. CITY, TOWN, OR LOCATION Sparks	
15d. STREET AND NUMBER 1848 F St.		15e. INSIDE CITY LIMITS (Specify Yes or No) Yes		16. FATHER—NAME First Middle Last Fred Pease	
16. MOTHER—MAIDEN NAME First Middle Last Avys Vice		17. INFORMANT—NAME (Type or Print) Vincent S. Keele		18. MAILING ADDRESS (Street or R.F.D. No., City or Town, State, Zip) 1848 F St., Sparks, Nevada 89431	
19a. BURIAL, CREMATION, REMOVAL, OTHER (Specify) Burial		19b. CEMETERY OR CREMATORY—NAME Mountain View Cemetery		19c. LOCATION City or Town State Reno, Nevada	
20a. FUNERAL DIRECTOR—SIGNATURE (Of Person Acting as Such)		20b. FUNERAL DIRECTOR LICENSE NUMBER 25		20c. NAME AND ADDRESS OF FACILITY Walton's Sparks Funeral Home 1745 Sullivan Lane, Sparks, Nevada 89431	
21a. To be Completed by CERTIFYING PHYSICIAN To the best of my knowledge, death occurred at the time, date and place and due to the cause(s) stated. (Signature and Title) DATE SIGNED (Mo., Day, Yr.) HOUR OF DEATH		22a. To be Completed by Coroner's Office On the basis of examination and/or investigation, in my opinion death occurred at the time, date and place and due to the cause(s) and manner stated. (Signature and Title) DATE SIGNED (Mo., Day, Yr.) HOUR OF DEATH		21b. NAME OF ATTENDING PHYSICIAN IF OTHER THAN CERTIFIER (Type or Print)	
21c. NAME AND ADDRESS OF CERTIFIER (PHYSICIAN, ATTENDING PHYSICIAN, MEDICAL EXAMINER, OR CORONER) (Type or Print) Vernon O. McCarty, Coroner, P.O. Box 11130, Reno, Nevada 89520		21d. LICENSE NUMBER WCC S. 35		22b. DATE SIGNED (Mo., Day, Yr.) May 18, 1994	
22c. PRONOUNCED DEAD (Mo., Day, Yr.) 1100 Found		22d. ON May 15, 1994		22e. AT 1100	
23a. REGISTRAR 24a. (Signature) Public Health Dep		23b. DATE RECEIVED BY REGISTRAR (Mo., Day, Yr.) May 18, 1994		23c. DEATH DUE TO COMMUNICABLE DISEASE 24c. YES <input type="checkbox"/> NO <input checked="" type="checkbox"/>	
25. IMMEDIATE CAUSE (ENTER ONLY ONE CAUSE PER LINE FOR (a), (b), AND (c).) PART I (a) Atherosclerotic coronary artery disease DUE TO, OR AS A CONSEQUENCE OF: (b) H.I.O. DUE TO, OR AS A CONSEQUENCE OF: (c) OTHER SIGNIFICANT CONDITIONS—Conditions contributing to death but not resulting in the underlying cause given in Part I.		Interval between onset and death: Interval between onset and death: Interval between onset and death:		26. AUTOPSY (Specify Yes or No) No	
26. ACC., SUICIDE, HOM., UNDET. OR PENDING INVEST. (Specify) 28a. DATE OF INJURY (Mo., Day, Yr.) 28b.		28c. HOUR OF INJURY M		28d. DESCRIBE HOW INJURY OCCURRED	
28e. INJURY AT WORK (Specify Yes or No)		28f. PLACE OF INJURY—At home, farm, street, factory, office building, etc. (Specify)		28g. LOCATION STREET OR R.F.D. No. CITY OR TOWN STATE	



This is to certify that the above is a true and correct copy of the certificate on file in this office.

Issued: **JAN 06 1995**

No. 064683
Lyonne Silva
Deputy Registrar



WARNING: IT IS ILLEGAL TO ALTER OR COPY THIS DOCUMENT.

BK0195PG0913 353918

I, Karen Ellison, certify that the foregoing instrument is a full, true and correct copy of the original on file in the office of the Recorder of Douglas County, Nevada. Per NRS 239B, the SSN shall be redacted, but in no way affects the legality of the document.

Witness my hand this 25th of October, 2022

By: Jodi O Stovall
Jodi Stovall - Deputy Recorder

REQUESTED BY
George Keels
IN OFFICIAL RECORDS OF
DOUGLAS CO., NEVADA

'95 JAN -6 P4:52

LINDA SLATER

COPY