

U.S.F.S.
RS 238109 (R2)
APN 1318-00-002-001

BASIS OF BEARINGS
N 89°44'26" W(R1)(M) 1321.80'(M)
N 89°44'25" W 1322.58'(R2)

SEE DETAIL "B"
(BELOW RIGHT)
330.59' (M)
330.57' (R6)
FOUND 3/4" IRON PIPE
W/PLUG, RLS 3519
C 1/4, S24
SHOWN PER (R2)

NEUSCHMID
DOC. NO. 2021-966286
RS 2021-961391 (R6)
APN 1318-24-302-003

KUOCH & CARRUTHERS
DOC. NO. 2022-980425
RS 818710 (R3)
APN 1318-24-302-002

VOORHIES
DOC. NO. 2022-983497
45,762 SQ. FT.
APN 1318-24-302-001

SCHILLING DEVELOPMENT LLC
DOC. NO. 2004-632571
RS 616034 (R5)
APN 1318-24-310-001

SEUFERT TRUST 2018
LOT 2, BLK. C (R7)
APN 1318-24-311-001

BASIS OF BEARING
THE MERIDIAN OF THIS SURVEY IS IDENTICAL WITH THAT GRANT, BARGAIN, SALE DEED RECORDED APRIL 8, 2022 AS DOCUMENT NUMBER 2022-983497 AND THAT RECORD OF SURVEY RECORDED FEBRUARY 21, 2013 AS DOCUMENT NUMBER 818710.

- LEGEND**
- FOUND MONUMENT AS NOTED
 - SET 3/4" IRON PIPE W/PLUG, PLS 21260
 - (C) CALCULATED
 - (M) MEASURED

TURNER & ASSOCIATES, INC.
LAND SURVEYING
(775) 588-5658
FAX (775) 588-9296
308 DORLA COURT, SUITE 203 - ROUND HILL, NEVADA 89448
P.O. BOX 5067 - STATELINE, NEVADA 89449
JN-22157

COUNTY RECORDER'S CERTIFICATE
FILED FOR RECORD THIS 15TH DAY OF *November*, 2022
AT 03 MINUTES PAST 11 O'CLOCK *A*.M., AS DOCUMENT
NUMBER *2022-991627*
RECORDED AT THE REQUEST OF GUY GIBNEY.
[Signature]
DOUGLAS COUNTY RECORDER

SCALE: 1"=20' SHEET 1 OF 1
RECORD OF SURVEY
FOR
GIBNEY & VOORHIES
POR. OF THE NE1/4 OF THE SW1/4 OF SECTION 24,
T.13N., R.18E., M.D.M.
DOUGLAS COUNTY, NEVADA
FILE NO. 22157.DWG NOVEMBER 2022

SURVEYOR'S CERTIFICATE

I, JEFFERY W. TURNER, A PROFESSIONAL LAND SURVEYOR LICENSED IN THE STATE OF NEVADA, CERTIFY THAT:
1. THIS IS A TRUE AND ACCURATE REPRESENTATION OF THE LANDS SURVEYED UNDER MY SUPERVISION AT THE INSTANCE OF GUY GIBNEY.
2. THE LANDS SURVEYED LIE WITHIN A PORTION OF SECTION 24, TOWNSHIP 13 NORTH, RANGE 18 EAST, M.D.M., AND THE SURVEY WAS COMPLETED ON SEPTEMBER 23, 2022.
3. THIS PLAT COMPLIES WITH THE APPLICABLE STATE STATUTES AND ANY LOCAL ORDINANCE AND IS NOT IN CONFLICT WITH THE PROVISIONS FOR N.R.S. 278.010 TO 278.630, INCLUSIVE.
4. THE MONUMENTS ARE OF THE CHARACTER SHOWN AND OCCUPY THE POSITIONS INDICATED.

[Signature]
JEFFERY W. TURNER DATE 10 NOV 22
P.L.S. #21260

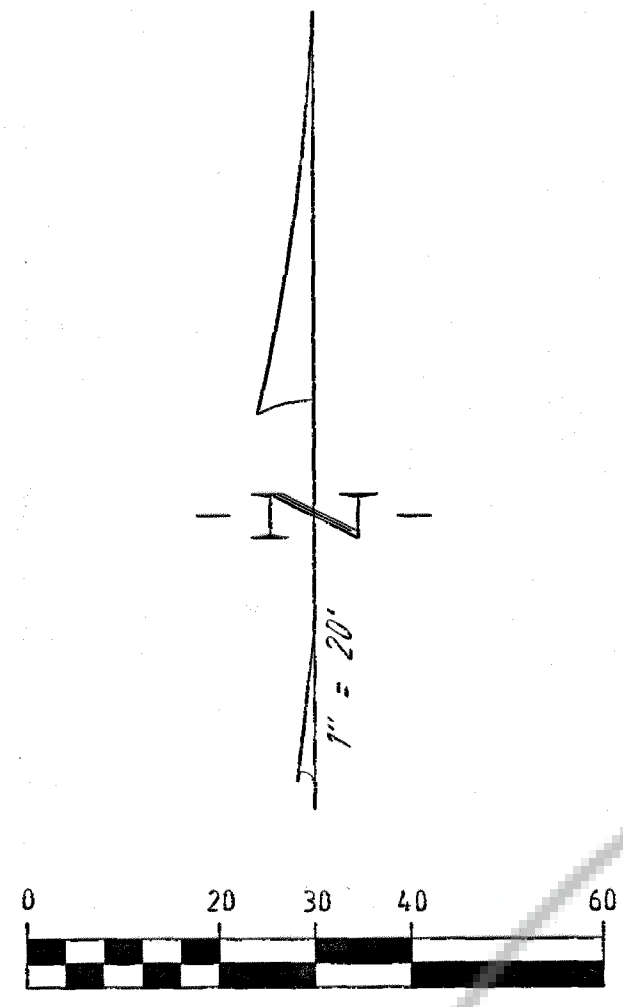
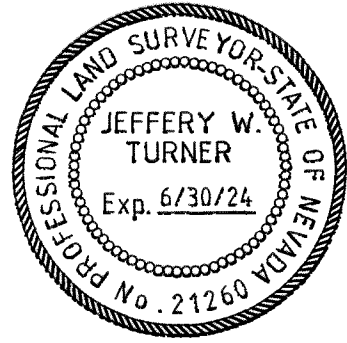

REFERENCES

- (R1) GRANT, BARGAIN, SALE DEED PER DOCUMENT NUMBER 2022-983497.
- (R2) RECORD OF SURVEY PER DOC. NO. 238109
- (R3) RECORD OF SURVEY PER DOC. NO. 818710
- (R4) RECORD OF SURVEY SUPPORTING A BOUNDARY LINE ADJUSTMENT FOR NELLO OLIVO PER DOC. NO. 508806
- (R5) RECORD OF SURVEY SUPPORTING A BOUNDARY LINE ADJUSTMENT FOR HERBERT E. SCHILLING II PER DOC. NO. 508806
- (R6) RECORD OF SURVEY PER DOC. NO. 2021-961391
- (R7) OFFICIAL PLAT KINGSBURY HIGHLANDS PER DOC. NO. 16916
- (R8) PLAT OF HANSON HEIGHTS ESTATES PER DOC. NO. 39361

NOTE

THIS MAP IS BEING FILED TO DELINEATE PROPERTY LINES AS DESCRIBED IN DEEDS RECORDED IN THE OFFICIAL RECORDS OF DOUGLAS COUNTY, NEVADA.