

VICINITY MAP
NO SCALE

LINE TABLE

LINE	BEARING	LENGTH
L1	N00°08'14"W	16.68'
L2	N37°44'14"W	21.22'

CURVE TABLE

CURVE	DELTA	RADIUS	LENGTH	CHORD BEARING	CHORD LENGTH
CI	37°36'00"	50.00'	32.81'	N18°56'14"W	32.23'

OWNER'S CERTIFICATE

WE, THE UNDERSIGNED OWNERS OF THE AFFECTED PARCELS AS SHOWN ON THIS MAP, DO HEREBY STATE THAT:

- 1) WE HAVE EXAMINED THIS PLAT AND APPROVE AND AUTHORIZE ITS RECORDING;
- 2) WE AGREE TO EXECUTE THE REQUIRED DOCUMENTS CREATING ANY EASEMENT WHICH IS SHOWN HEREON;
- 3) WE AGREE TO EXECUTE THE REQUIRED DOCUMENTS ABANDONING ANY EXISTING EASEMENT PURSUANT TO THE PROVISIONS OF NRS 278.010 TO 278.630 INCLUSIVE;
- 4) ALL PROPERTY TAXES ON THE LAND FOR THE FISCAL YEAR HAVE BEEN PAID;
- 5) ANY LENDER WITH AN IMPOUND ACCOUNT FOR THE PAYMENT OF TAXES HAS BEEN NOTIFIED OF THE ADJUSTMENT OF THE BOUNDARY LINE OR THE TRANSFER OF THE LAND.

BENTLY ENTERPRISES, LLC
 BY: *Jeffrey R. Jarboe*
 ITS: CHIEF FINANCIAL OFFICER

STATE OF NEVADA SS:
 COUNTY OF DOUGLAS

ON THIS 20th DAY OF October, IN THE YEAR 2022 BEFORE ME, A NOTARY PUBLIC, PERSONALLY APPEARED JEFFREY R. JARBOE, PERSONALLY KNOWN BY ME TO BE THE PERSON WHOSE NAME IS SUBSCRIBED TO THE ABOVE INSTRUMENT WHO ACKNOWLEDGED THAT HE EXECUTED THE SAME IN HIS AUTHORIZED CAPACITY AND THAT BY HIS SIGNATURES ON THE INSTRUMENT, THE PERSON, OR THE ENTITY ON BEHALF OF WHICH THE PERSON ACTED, EXECUTED THE INSTRUMENT.

WITNESS MY HAND AND OFFICIAL SEAL:
Julie Anne Keelen
 NOTARY'S SIGNATURE

JULIE ANNE KEELAN
 Notary Public - State of Nevada
 Appointment No. 22-5537-04
 My Appointment Expires 04/12/2026

COMMUNITY DEVELOPMENT DEPARTMENT CERTIFICATE

IT IS HEREBY CERTIFIED THAT THIS BOUNDARY LINE ADJUSTMENT WAS PRESENTED TO THE DOUGLAS COUNTY COMMUNITY DEVELOPMENT DEPARTMENT AND WAS DULY APPROVED.

Thomas A. Dallaire
 THOMAS A. DALLAIRE, P.E.
 COMMUNITY DEVELOPMENT DIRECTOR

DATE: 11.8.22

CLERK TREASURER'S CERTIFICATE

ALL PROPERTY TAXES FOR THE PARCELS SHOWN ON THIS MAP HAVE BEEN PAID IN FULL FOR THE FISCAL TAX YEAR. (A.P.N.'S 1320-27-001-004 & 1320-27-001-028)

APY Burgans
 APY BURGANS
 DOUGLAS COUNTY CLERK-TREASURER

DATE: 11-10-22

RECORDER'S CERTIFICATE

FILED FOR RECORD THIS 16th DAY OF November, 2022, AT 26 MINUTES PAST 11 O'CLOCK A.M., DOCUMENT NO. 2022-991656 RECORDED AT THE REQUEST OF R.O. ANDERSON ENGINEERING, INC.

Karen Ellison
 DOUGLAS COUNTY RECORDER
 KAREN ELLISON

SURVEYOR'S CERTIFICATE

I, ANDREW R. LINDSAY, A PROFESSIONAL LAND SURVEYOR LICENSED IN THE STATE OF NEVADA, CERTIFY THAT:

- 1) A FIELD SURVEY OF THE BOUNDARIES OF THE AFFECTED PARCELS HAS BEEN PERFORMED BY ME OR UNDER MY SUPERVISION AT THE INSTANCE OF BENTLY ENTERPRISES, LLC.
- 2) THIS PLAT IS A TRUE AND ACCURATE REPRESENTATION OF THE LANDS SURVEYED.
- 3) ALL CORNERS AND ANGLE POINTS OF THE ADJUSTED BOUNDARY LINE HAVE BEEN SET AND THE MONUMENTS ARE OF THE CHARACTER SHOWN AND OCCUPY THE POSITIONS INDICATED AND ARE OF SUFFICIENT NUMBER AND DURABILITY TO ENABLE THIS SURVEY TO BE RETRACED.
- 4) THE LANDS SURVEYED LIE WITHIN A PORTION OF SECTIONS 27, TOWNSHIP 13 NORTH, RANGE 20 EAST M.D.M., DOUGLAS COUNTY, NEVADA, AND THE SURVEY WAS COMPLETED ON AUGUST 5, 2022.
- 5) THIS PLAT IS NOT IN CONFLICT WITH THE PROVISIONS OF NRS 278.010 THROUGH NRS 278.630 INCLUSIVE AND COMPLIES WITH ALL APPLICABLE STATE STATUTES AND ANY LOCAL ORDINANCES.

Andrew R. Lindsay
 ANDREW R. LINDSAY, P.L.S. 18441

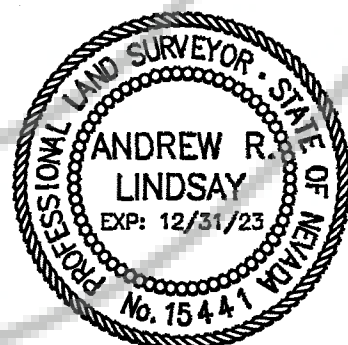

BASIS OF BEARING

S04°19'56"E IS IDENTICAL TO THE RECORD OF SURVEY FOR PARCEL 2, 'BLOCK A' FOR BENTLY ENTERPRISES, LLC FILED FOR RECORD APRIL 25, 2016 IN THE OFFICE OF RECORDER AS DOCUMENT NO. 879884.

LEGEND

- FOUND 5/8 REBAR WITH CAP, P.L.S. 18297
- ⊗ FOUND NAIL AND TAG, P.L.S. 18297
- FOUND 5/8 REBAR WITH CAP, P.L.S. 6497
- ⊙ FOUND 5/8 REBAR WITH CAP, P.L.S. 3204
- FOUND 5/8 REBAR WITH CAP, P.L.S. 3579
- △ SET 5/8" REBAR W/PLASTIC CAP, P.L.S. 15441
- FLOOD LINES PER DOUGLAS COUNTY GIS

NOTES

THIS MAP REFERENCES THE FINAL MAP NO. 1013 OF BENTLY SCIENCE PARK FILED FOR RECORD DECEMBER 12, 1996 IN THE OFFICE OF RECORDER AS DOCUMENT NO. 376672 AND THE RECORD OF SURVEY FOR PARCEL 2, 'BLOCK A' FOR BENTLY ENTERPRISES, LLC FILED FOR RECORD APRIL 25, 2016 IN THE OFFICE OF RECORDER AS DOCUMENT NO. 879884.

THESE PARCELS LIE WITHIN THE 'AE', 'X' AND UNSHADED 'X' FLOOD ZONE PER FEMA MAP PANEL 32005C0253H DATED JUNE 15, 2016.

THIS RECORD OF SURVEY IS TO SUPPORT THOSE CERTAIN DEEDS RECORDED IN THE OFFICIAL RECORDS OF DOUGLAS COUNTY, NEVADA AS DOCUMENT NO.(S)

2022-991654

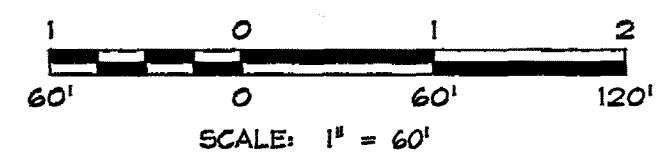

R/O Anderson
 www.roanderson.com

MINDEN
 1628 Esmeralda Ave
 P.O. Box 2529
 Minden, NV 89423
 P 775.782.7024
 F 775.782.7054

RENO
 9060 Double
 Plany, Unit 18
 Reno, NV 89501
 P 775.782.5252
 F 775.782.7054

RECORD OF SURVEY
 TO SUPPORT
 A BOUNDARY LINE ADJUSTMENT
 FOR
 BENTLY ENTERPRISES, LLC

LOCATED WITHIN A PORTION OF
 SECTION 27, T.13N., R.20E., M.D.M.
 DOUGLAS COUNTY, NEVADA

1640-0558LA