

PROJECT CONTROL (NAD 83 GROUND)

POINT	NORTHING	EASTING	DESCRIPTION
A	14716942.33	2285630.61	FOUND 2005 GLO BRASS CAP
B	14716858.21	2285647.89	FOUND 5/8" REBAR & CAP, PLS 1586
C	14717283.35	2285667.68	FOUND 1985 BLM BRASS CAP, 1/4 CORNER
D	14717117.12	2285670.74	FOUND 5/8" REBAR & CAP, PLS 6899
E	14716558.48	2287243.68	FOUND 5/8" REBAR & CAP, PLS 11172

BASIS OF BEARINGS

THE BASIS OF BEARINGS FOR THIS SURVEY IS BASED ON THE NEVADA STATE PLANE COORDINATE SYSTEM, WEST ZONE NAD 83(2011) EPOCH 2010.0000, SCALED TO GROUND AROUND 0.00N, 0.00E BY THE COMBINED SCALE FACTOR OF 1.00020000 AS MEASURED FROM THE DOUGLAS COUNTY CONTROL POINT NO.1 AS REFERENCED FROM THE GPS RECORD OF SURVEY FOR DOUGLAS COUNTY, FILED FOR RECORD AUGUST 4, 2022 AS DOCUMENT NO. 988160 IN THE OFFICE OF THE DOUGLAS COUNTY RECORDER.

SURVEYOR'S CERTIFICATE

I, TODD A. ENKE, A PROFESSIONAL LAND SURVEYOR, LICENSED IN THE STATE OF NEVADA, AS AN AGENT FOR RESOURCE CONCEPTS, INC, DO HEREBY CERTIFY THAT:

- THIS PLAT REPRESENTS THE RESULTS OF A SURVEY CONDUCTED UNDER MY DIRECT SUPERVISION AT THE INSTANCE OF CLEAR CREEK PLAZA, LLC.
- THE LANDS SURVEYED LYING WITHIN SECTION 6, T.14N., R.20E., M.D.M. DOUGLAS COUNTY NEVADA. THIS SURVEY WAS COMPLETED ON NOVEMBER 17, 2022.
- THIS PLAT COMPLIES WITH APPLICABLE STATUTES OF THIS STATE AND ANY LOCAL ORDINANCES IN EFFECT ON THE DATE THAT THE SURVEY WAS COMPLETED, AND THE SURVEY WAS CONDUCTED IN ACCORDANCE WITH CHAPTER 625 OF THE NEVADA ADMINISTRATIVE CODE.
- THE MONUMENTS DEPICTED ON THE PLAT ARE OF THE CHARACTER SHOWN, OCCUPY THE POSITIONS INDICATED AND ARE OF SUFFICIENT DURABILITY.

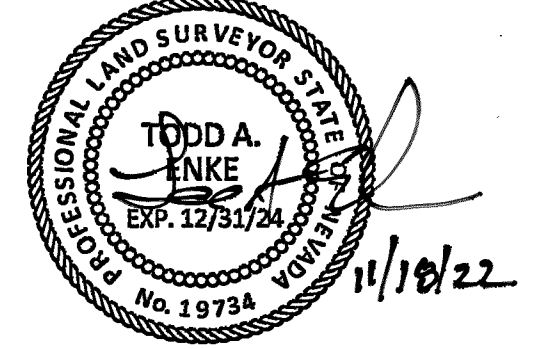

TODD A. ENKE, PLS 19734

COUNTY RECORDER'S CERTIFICATE

FILED THIS 18TH DAY OF November, 2022 AT 4:11 MINUTES PAST 3 O'CLOCK P.M., AS DOCUMENT NUMBER 2022-991762, RECORDED AT THE REQUEST OF BIDDLE TRUST.

[Signature]
DOUGLAS COUNTY RECORDER

NOTES

- TOTAL AREA SURVEYED IS 8.93 ACRES
- EASEMENTS MAY EXIST THAT ARE NOT SHOWN HEREON.

LINE TABLE

LINE	BEARING	DISTANCE	RECORD
L1	N00°59'50"E	170.04'	(1)(2)
L2	N00°15'54"E	170.04'	(1)(2)
	N00°59'50"E	8.33'	(4)
L3	S00°59'50"W	18.50'	(4)
	S00°15'54"W	18.50'	(1)(2)
L4	N89°00'10"W	80.00'	(4)
L5	N89°00'10"W	211.14'	(4)
	N89°00'10"W	211.00'	(4)
L6	N1°00'31"E	99.40'	(4)

CURVE TABLE

CURVE	RADIUS	DELTA ANGLE	ARC LENGTH	CHORD BEARING	CHORD DISTANCE	RECORD
C1	24.50'	90°00'00"	38.48'	S45°59'50"W	34.65'	(1)(2)(5)
C2	55.50'	90°00'00"	87.18'	N44°00'10"W	78.49'	(1)(2)(4)
C3	1.50'	90°00'00"	2.36'	S45°59'50"W	2.12'	(1)(2)(4)

LEGEND SYMBOLS

- FOUND BRASS CAP, BLM
- FOUND 5/8" REBAR & CAP, PLS 1586
- FOUND 5/8" REBAR & CAP, PLS 6899
- FOUND 5/8" REBAR & CAP, PLS 11172
- SET 5/8" REBAR & CAP OR NAIL & TAG, PLS 19734
- DIMENSION POINT, NOTHING FOUND OR SET
- FOUND 1985 GLO BRASS CAP 1/4 CORNER
- FOUND 1985 GLO BRASS CAP SECTION CORNER

LINES

- BOUNDARY LINE
- - - ADJACENT PROPERTY LINE
- - - EASEMENT LINE
- - - BOUNDARY TIE LINE
- - - RIGHT-OF-WAY LINE
- - - COUNTY LINE

REFERENCES

- GRANT, BARGAIN & SALE DEED, FILED FOR RECORD MAY 1, 2007 AS DOCUMENT NO. 700189 IN THE OFFICE OF THE DOUGLAS COUNTY RECORDER.
- RECORD OF SURVEY TO SUPPORT A BOUNDARY LINE ADJUSTMENT FOR EDGAR S. ROBERTS, FILED FOR RECORD FEBRUARY 9, 2001 AS DOCUMENT NO. 508502 IN THE OFFICE OF THE DOUGLAS COUNTY RECORDER.
- AMENDED RECORD OF SURVEY FOR DOUGLAS COUNTY #92, FILED FOR RECORD JULY 11, 2000 AS DOCUMENT NO. 485681 IN THE OFFICE OF THE DOUGLAS COUNTY RECORDER.
- PARCEL MAP LDA 07-062 FOR OUTLOT WALMART STORE #1648, FILED FOR RECORD OCTOBER 7, 2009 AS DOCUMENT NO. 781901 IN THE OFFICE OF THE DOUGLAS COUNTY RECORDER.
- RECORD OF SURVEY TO SUPPORT A BOUNDARY LINE ADJUSTMENT FOR EDGAR S. ROBERTS, FILED FOR RECORD SEPTEMBER 8, 2003 AS DOCUMENT NO. 589087 IN THE OFFICE OF THE DOUGLAS COUNTY RECORDER.
- PARCEL MAP FOR CLEAR CREEK ENTERPRISES, INC., FILED FOR RECORD DECEMBER 30, 1976 AS DOCUMENT NO. 86444 IN THE OFFICE OF THE DOUGLAS COUNTY RECORDER.
- PLAT OF THE UNITED STATES DEPARTMENT OF THE INTERIOR BUREAU OF LAND MANAGEMENT (BLM) DEPENDENT RESURVEY AND SUBDIVISION OF SECTIONS 6, 8, AND 7 OF TOWNSHIP 14 NORTH, RANGE 20 EAST, OF THE MOUNT DIABLO MERIDIAN, NEVADA DATED APRIL 29, 1966



Carson City
340 E. Minnesota St.
Carson City, NV 89703-4162
775-883-1600
Lake Tahoe
276 Kingsbury Grade, Ste. 209
Stateline, NV 89449
775-539-7500

RECORD OF SURVEY
FOR
CLEAR CREEK PLAZA, LLC
APN 1420-06-502-017
LOCATED WITHIN A PORTION OF SECTION 6,
TOWNSHIP 14 NORTH, RANGE 20 EAST, M.D.M.
MINDEN DOUGLAS COUNTY NEVADA