

APN: 1022-15-001-010

RECORDING REQUESTED BY:

William G. Field & Janet L. Field
1410 Albite Rd.
Wellington, NV 89444

AFTER RECORDATION, RETURN BY MAIL TO:

William G. Field & Janet L. Field, Trustees
1410 Albite Rd.
Wellington, NV 89444



KAREN ELLISON, RECORDER

E07

SPACE ABOVE THIS LINE FOR RECORDER'S USE

QUIT CLAIM DEED

THIS QUITCLAIM DEED, executed this 2nd day of December, 2022, by first party, Grantors, William G. Field and Janet L. Field, husband and wife as joint tenants, whose post office address is 1410 Albite Road, Wellington, NV 89444, to second party, Grantees, William G. Field and Janet L. Field, Trustees of The Field Family Trust, Dated December 2, 2022, whose post office address is 1410 Albite Road, Wellington, NV 89444.

WITNESSETH, that the said first party, for good consideration and for the sum of Ten Dollars (\$10.00) paid by the said second party, the receipt whereof is hereby acknowledged, does hereby remise, release and quitclaim unto the said second party forever, all the right, title, interest and claim which the said first party has in and to the following described parcel of land, and improvements and appurtenances thereto in the County of Douglas, State of Nevada to wit:

SEE EXHIBIT "A" ATTACHED HERETO AND MADE A PART HEREOF.

Subject to Restrictions, Conditions, Covenants, Rights, Rights of Way, and Easements now of record, if any. TOGETHER with all and singular the tenements, hereditaments and appurtenances now of record, if any.

IN WITNESS WHEREOF, the said first party has signed and sealed these presents the day and year first above written.

William G. Field

Janet L. Field

STATE OF NEVADA)
) ss.
COUNTY OF DOUGLAS)

This instrument was acknowledged before me on the 2 day of December, 2022 by William G. Field and Janet L. Field.

Notary Public

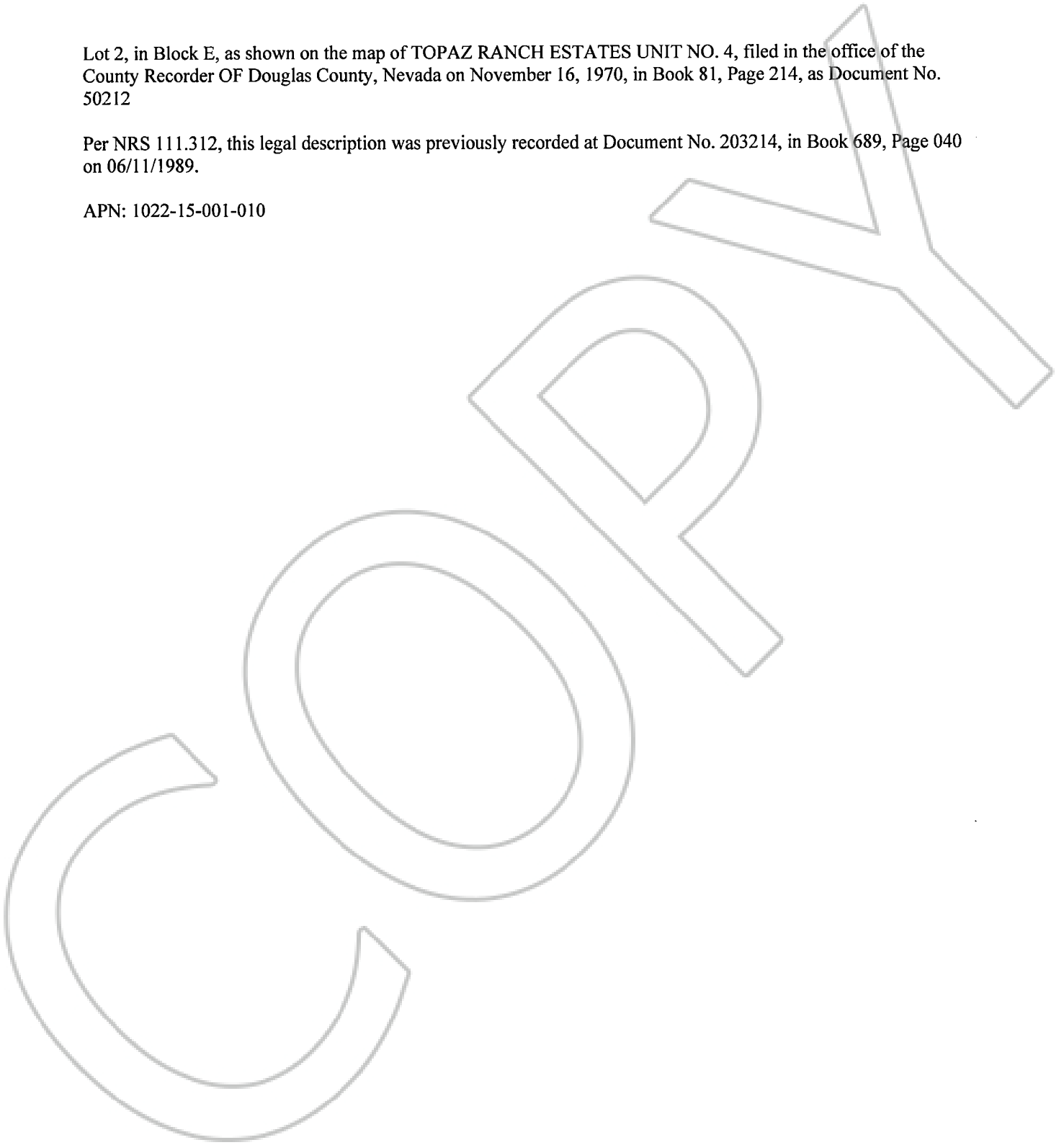

EXHIBIT "A"

Lot 2, in Block E, as shown on the map of TOPAZ RANCH ESTATES UNIT NO. 4, filed in the office of the County Recorder OF Douglas County, Nevada on November 16, 1970, in Book 81, Page 214, as Document No. 50212

Per NRS 111.312, this legal description was previously recorded at Document No. 203214, in Book 689, Page 040 on 06/11/1989.

APN: 1022-15-001-010



STATE OF NEVADA
DECLARATION OF VALUE

1. Assessor Parcel Number(s)
 a) 1022-15-001-010
 b) _____
 c) _____
 d) _____

2. Type of Property:
 a) Vacant Land b) Single Fam. Res.
 c) Condo/Twnhse d) 2-4 Plex
 e) Apt. Bldg f) Comm'l/Ind'l
 g) Agricultural h) Mobile Home
 i) Other _____

FOR RECORDERS OPTIONAL USE ONLY	
BOOK _____	PAGE _____
DATE OF RECORDING: _____	
NOTES: <u>By Trust OK</u>	

3. Total Value/Sales Price of Property: \$ _____
 Deed in Lieu of Foreclosure Only (value of property) (_____
 Transfer Tax Value: \$ _____
 Real Property Transfer Tax Due: \$ _____

4. If Exemption Claimed:
 a. Transfer Tax Exemption per NRS 375.090, Section # 7
 b. Explain Reason for Exemption: Transfer to Trust without consideration

5. Partial Interest: Percentage being transferred: _____ %

The undersigned declares and acknowledges, under penalty of perjury, pursuant to NRS 375.060 and NRS 375.110, that the information provided is correct to the best of their information and belief, and can be supported by documentation if called upon to substantiate the information provided herein. Furthermore, the parties agree that disallowance of any claimed exemption, or other determination of additional tax due, may result in a penalty of 10% of the tax due plus interest at 1% per month.

Pursuant to NRS 375.030, the Buyer and Seller shall be jointly and severally liable for any additional amount owed.

Signature William G. Field Capacity _____ Grantor

Signature Janet L. Field Capacity _____ Grantor

**SELLER (GRANTOR) INFORMATION
(REQUIRED)**

Print Name: William G. Field & Janet L. Field
 Address: 1410 Albite Rd.
 City: Wellington
 State: NV Zip: 89444

**BUYER (GRANTEE) INFORMATION
(REQUIRED)**

Print Name: William G. Field & Janet L. Field, Trustee
 Address: 1410 Albite Rd.
 City: Wellington
 State: NV Zip: 89444

COMPANY/PERSON REQUESTING RECORDING

(required if not the seller or buyer)

Print Name: _____ Escrow # _____
 Address: _____
 City: _____ State: _____ Zip: _____

(AS A PUBLIC RECORD THIS FORM MAY BE RECORDED/MICROFILMED)