



KAREN ELLISON, RECORDER

RECORDING REQUESTED BY:

John Langford  
2575 State Route 338  
Wellington, NV 89444



## CORNER RECORD SURVEYOR'S CERTIFICATE

I, John R. Langford, a Professional Land Surveyor registered in the State of Nevada, certify that:

1. This corner record represents the establishment or restoration of a corner or accessory to a corner conducted under my direct supervision.
2. The monument or accessories perpetuated lie within Section 29, T 13 N, R 20 E, MDM, County of Douglas, and the establishment or restoration was completed on November 4, 2022.
3. This Corner Record has been filed pursuant to NRS 329.140 or 329.150 and complies with the provisions of NAC 329.010 and any local ordinances in effect on the date that the establishment or restoration was completed.
4. The monument or witness monument and accessories found are of the character shown, occupy the positions indicated, and are of sufficient durability.

JOHN R LANGFORD  
PLS 4957

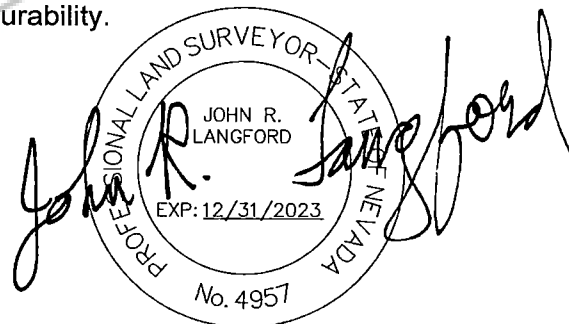

11/26/2022

## MONUMENTATION NOTES

The centerline monument in Lantana Drive originally set per FINAL MAP #1008-8 FOR WINDHAVEN UNIT NO. 8 was lost during reconstruction and resurfacing of Lantana Drive. The monument found prior to disturbance was a 1-1/2"Ø aluminum cap inscribed PLS 3209 on a 5/8"Ø rebar down 0.5' in an 8"Ø cast iron monument well. The position of the monument is shown on Sheet 3 of 4 hereon and was measured using GPS-RTK methods.

After completion of resurfacing the monument was replaced at the measured position with a 1-1/2"Ø aluminum cap inscribed PLS4957 on a 5/8"Øx24' long rebar and was set down 0.4' in a monument well in accordance with the detail on Sheet 4 of 4 hereon.

## RECORD REFERENCE

FINAL MAP #1008-8 FOR WINDHAVEN UNIT NO. 8, filed on September 11, 1997 as Document No. 421412.



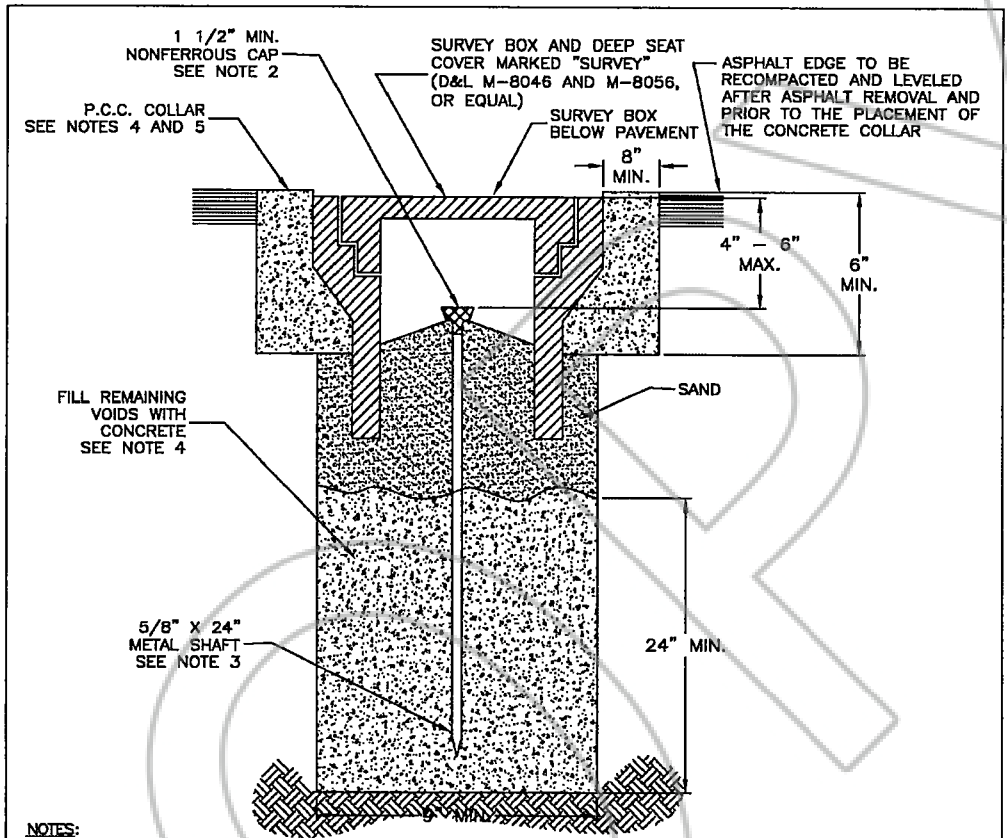

- NOTES:**
1. FERROUS METAL OVER MONUMENT FOR RECOVERY BY DIP NEEDLE OR MAGNETIC INSERT IN CAP.
  2. 1 1/2" MIN. NONFERROUS CAP WITH PROFESSIONAL LAND SURVEYOR NO. PERMANENTLY ATTACHED PRIOR TO PLACEMENT. PRE-PUNCHED CAPS SHALL NOT BE PERMITTED
  3. 5/8" METALLIC SHAFT (SMOOTH SHAFTS TO BE DEFORMED).
  4. FIBER-REINFORCED PORTLAND CEMENT CONCRETE (P.C.C.) SHALL HAVE THE FOLLOWING CHARACTERISTICS: 4000 PSI MIN. COMPRESSIVE STRENGTH AT 28 DAYS, MIN. 6 SACKS OF CEMENT PER CUBIC YARD WITH MAX. WATER-CEMENT RATIO OF 0.45, AIR ENTRAINMENT 6% ±1.5%, SLUMP AT 1 TO 4 INCHES. MIX DESIGN SHALL CONFORM TO THE REQUIREMENTS OF SECTION 337 OF STANDARD SPECIFICATIONS OF PUBLIC WORKS CONSTRUCTION (SSPWC). CEMENT SHALL BE TYPE II. ALL CEMENT CONCRETE SHALL HAVE A COARSE AGGREGATE GRADATION CONFORMING TO SIZE No. 67. POLYPROPYLENE OR CELLULOSE FIBERS SHALL BE ADDED TO THE P.C.C. AT 1.5 LBS. PER CUBIC YARD. ALL MATERIALS SHALL CONFORM TO SSPWC.
  5. P.C.C. COLLARS IN ALL ROADWAYS SHALL BE PROTECTED FROM TRAFFIC LOADS UNTIL MINIMUM 3000 PSI IS ATTAINED.

NO. REVISION DATE			STANDARD DETAIL FOR PUBLIC WORKS CONSTRUCTION	SECTION: DOUGLAS COUNTY
			<b>MONUMENTS</b>	DATE: JULY 2017
				DWG: A12