

DOUGLAS COUNTY, NV **2023-1000709**
RPTT:\$5850.00 Rec:\$40.00
\$5,890.00 Pgs=4 **09/22/2023 01:07 PM**
TICOR TITLE - GARDNERVILLE
SHAWNYNE GARREN, RECORDER

WHEN RECORDED MAIL TO:
PAL Enterprises LLC a Nevada series limited liability
company 1350 Buckeye Series
1560 Willow Creek Lane
Gardnerville NV 89410

MAIL TAX STATEMENTS TO:
Same as above

Escrow No. 2201529-RLT

The undersigned hereby affirms that this document
submitted for recording does not contain the social
security number of any person or persons.
(Pursuant to NRS 239b.030)

SIGNED IN COUNTERPART

APN No.: 1320-28-000-048
R.P.T.T. \$5,850.00

SPACE ABOVE FOR RECORDER'S USE ONLY

GRANT, BARGAIN, SALE DEED

THIS INDENTURE WITNESSETH: That Bently Family LLC a Nevada Limited Liability Company F/K/A
Bently Biofuels Company

FOR A VALUABLE CONSIDERATION, receipt of which is hereby acknowledged, do/does hereby Grant,
Bargain, Sell and Convey to PAL Enterprises LLC a Nevada series limited liability company 1350 Buckeye
Series

all that real property situated in the County of Douglas, State of Nevada, described as follows:
SEE EXHIBIT "A" ATTACHED HERETO AND BY REFERENCE MADE A PART HEREOF

Together with all and singular the tenements, hereditaments and appurtenances thereunto belonging or in
anywise appertaining.

Signature and notary acknowledgement on page two.

Bently Family LLC a Nevada Limited
Liability Company F/K/A Bently
Biofuels Company

Jeffrey Jarboe
CPB Holdings, LTD, Managing Member
Jeffrey Jarboe, CFO

Bently Family LLC a Nevada Limited
Liability Company F/K/A Bently Biofuels
Company

SIGNED IN COUNTERPART
CPB Holdings, LTD, Managing Member
Brady Frey, COO

STATE OF NEVADA ^{SWA} Arizona
COUNTY OF DOUGLAS ^{SWA}

} ss:

This instrument was acknowledged before me on September 21, 2023
by Jeffrey Jarboe and Brady Frey ^{SWA}

Stephen W. Jones
NOTARY PUBLIC
Stephen W. Jones

This Notary Acknowledgement is attached to that certain Grant, Bargain, Sale Deed under escrow
No. 02201529.

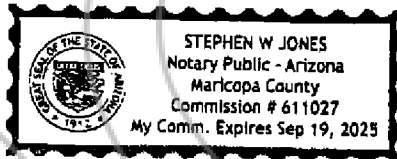

Bently Family LLC a Nevada Limited Liability Company F/K/A Bently Biofuels Company

SIGNED IN COUNTERPART

CPB Holdings, LTD, Managing Member
Jeffrey Jarboe, CFO

Bently Family LLC a Nevada Limited Liability Company F/K/A Bently Biofuels Company

CPB Holdings, LTD, Managing Member
Brady Frey, COO

STATE OF ~~NEVADA~~ ^{CH} California) ss:
COUNTY OF ~~DOUGLAS~~ ^{CH} Alameda

This instrument was acknowledged before me on, Sept 21, 2023
by Jeffrey Jarboe and Brady Frey

CH
C. Haines
NOTARY PUBLIC

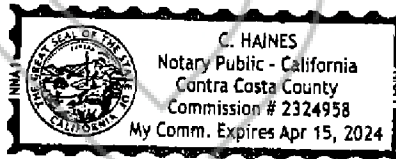

This Notary Acknowledgement is attached to that certain Grant, Bargain, Sale Deed under escrow No. 02201529.

Escrow No. 2201529-RLT

**EXHIBIT A
LEGAL DESCRIPTION**

All that certain real property situate in the County of Douglas, State of Nevada, described as follows:

Parcel 1 as shown on Parcel Map No. DP 23-0016, for BENTLY FAMILY, LLC, according to the map thereof, filed in the office of the County Recorder of Douglas County, State of Nevada, on September 19, 2023 as File No. 2023-1000583, Official Records.

APN: 1320-28-000-048

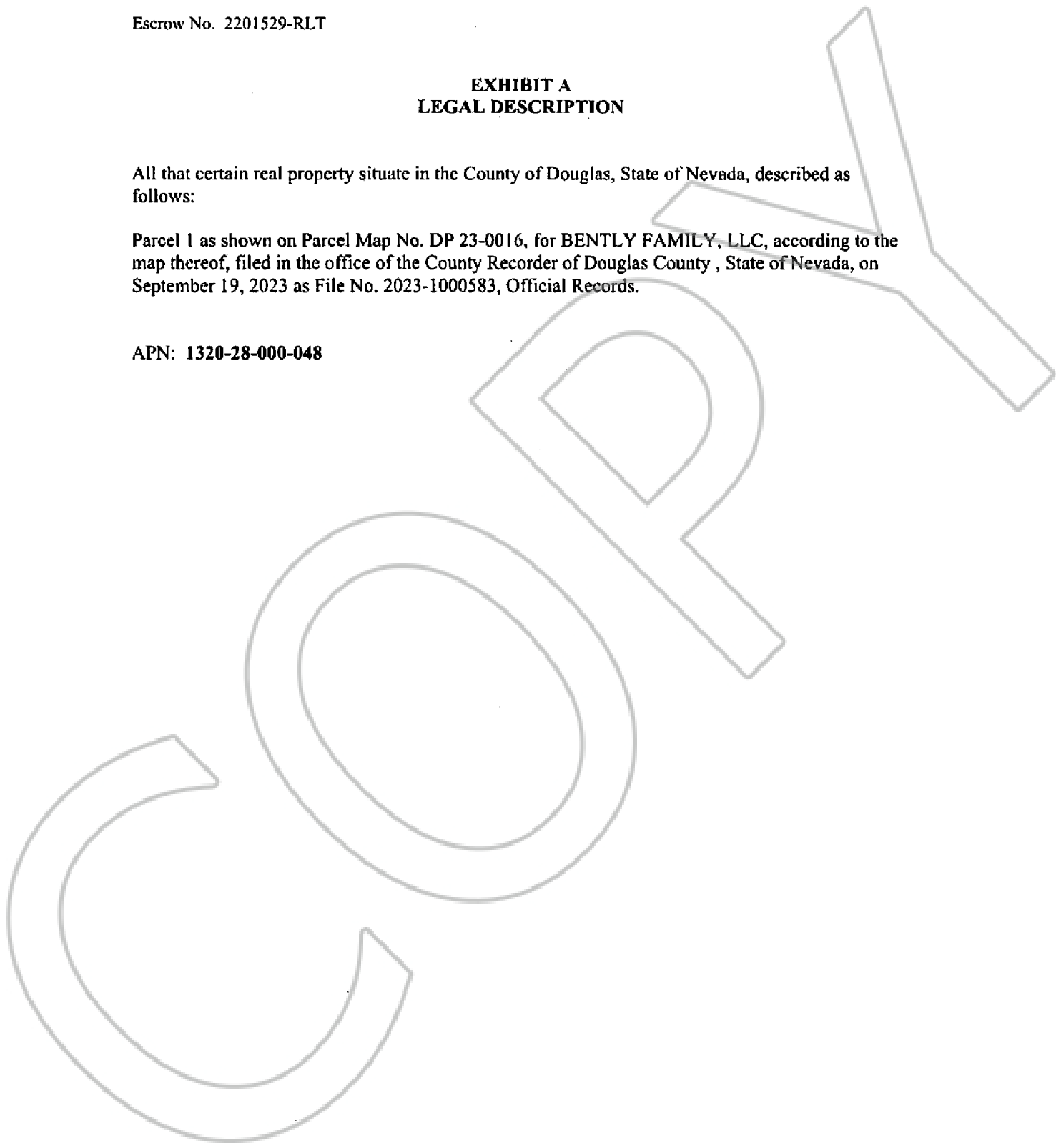

**STATE OF NEVADA
DECLARATION OF VALUE FORM**

1. Assessor Parcel Number(s)
 a. 1320-28-000-048
 b. _____
 c. _____
 d. _____

2. Type of Property:
 a. Vacant Land b. Single Fam. Res.
 c. Condo/Twnhse d. 2-4 Plex
 e. Apt. Bldg f. Comm'l/Ind'l
 g. Agricultural h. Mobile Home
 i. Other _____

FOR RECORDERS OPTIONAL USE ONLY	
Book _____	Page _____
Date of Recording: _____	
Notes: _____	

3. a. Total Value/Sales Price of Property: \$ 1,500,000.00
 b. Deed in Lieu of Foreclosure Only (value of property) \$ _____
 c. Transfer Tax Value \$ 1,500,000.00
 d. Real Property Transfer Tax Due: \$ 5,850.00

4. **If Exemption Claimed**
 a. Transfer Tax Exemption, per NRS 375.090, Section _____
 b. Explain Reason for Exemption: _____

5. Partial Interest: Percentage being transferred: 100%

The undersigned declares and acknowledges, under penalty of perjury, pursuant to NRS 375.060 and NRS 375.110, that the information provided is correct to the best of their information and belief, and can be supported by documentation if called upon to substantiate the information provided herein. Furthermore, the parties agree that disallowance of any claimed exemption, or other determination of additional tax due, may result in a penalty of 10% of the tax due plus interest at 1% per month. Pursuant to NRS 375.030, the Buyer and Seller shall be jointly and severally liable for any additional amount owed.

Signature [Signature] Capacity [Signature]
 Signature _____ Capacity _____

**SELLER (GRANTOR) INFORMATION
(REQUIRED)**

Print Name: Bently Family LLC a Nevada Limited Liability Company F/K/A Bently Biofuels Company
 Address: 1597 Esmeralda Avenue
 City: Minden
 State: NV Zip: 89423

**BUYER (GRANTEE) INFORMATION
(REQUIRED)**

Print Name: PAL Enterprises LLC a Nevada series limited liability company 1350 Buckeye Series
 Address: 1560 Willow Creek Lane
 City: Gardnerville
 State: NV Zip: 89410

COMPANY/PERSON REQUESTING RECORDING (Required if not Seller or Buyer)

Print Name: Ticor Title of Nevada, Inc. Escrow No.: 02201529-020-RLT
 Address: 1483 US Highway 395 N, Suite B
 City, State, Zip: Gardnerville, NV 89410

AS A PUBLIC RECORD THIS FORM MAY BE RECORDED/MICROFILMED