

APN: 1220-22-410-112
R.P.T.T.: \$0.00
Escrow No.: 23033243-ES
When Recorded Return To:
The Andrews Family Trust dated November
17, 2015
1475 Kathy Way
Gardnerville, NV 89460

Mail Tax Statements to:
The Andrews Family Trust dated November
17, 2015
1475 Kathy Way
Gardnerville, NV 89460

DOUGLAS COUNTY, NV
RPTT:\$0.00 Rec:\$40.00
\$40.00 Pgs=3
2023-994488
03/06/2023 12:09 PM
FIRST CENTENNIAL - RENO (MAIN OFFICE)
SHAWNYNE GARREN, RECORDER E07

SPACE ABOVE FOR RECORDER'S USE

GRANT, BARGAIN, SALE DEED

FOR VALUABLE CONSIDERATION, receipt of which is hereby acknowledged,

Larry Pat Andrews and Ana M. Andrews, husband and wife as joint tenants with right of survivorship

do(es) hereby Grant, Bargain, Sell and Convey to

Larry Pat Andrews and Ana M. Andrews, Trustees, or Successor Trustee(s) of The Andrews Family Trust dated November 17, 2015

all that real property situated in the Town of Gardnerville, County of Douglas, State of Nevada, described as follows:

SEE LEGAL DESCRIPTION ATTACHED HERETO AND MADE A PART HEREOF AS EXHIBIT "A"

Together with all and singular tenements, hereditaments and appurtenances thereunto belonging or in anywise appertaining.

Dated this 28 day of Feb, 2023.

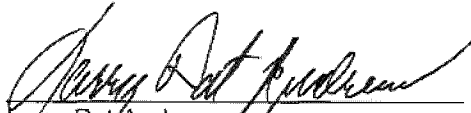
Larry Pat Andrews

Ana M. Andrews

STATE OF NEVADA

COUNTY OF CARSON City

This instrument was acknowledged before me on this 28 day of Feb, 2023, by Larry Pat Andrews and Ana M. Andrews.

Notary Public

 LIZ SVENNINGSEN
Notary Public - State of Nevada
Appointment Recorded in Carson City
No: 22-3325-03 - Expires June 4, 2026

EXHIBIT "A"

Lot 925, of Gardnerville Ranchos Subdivision, Phase 7, according to the map thereof, filed in the Office of the County Recorder of Douglas County, Nevada, recorded on March 27th, 1974, as Document No. 72456.

Assessors Parcel No.: 1220-22-410-112

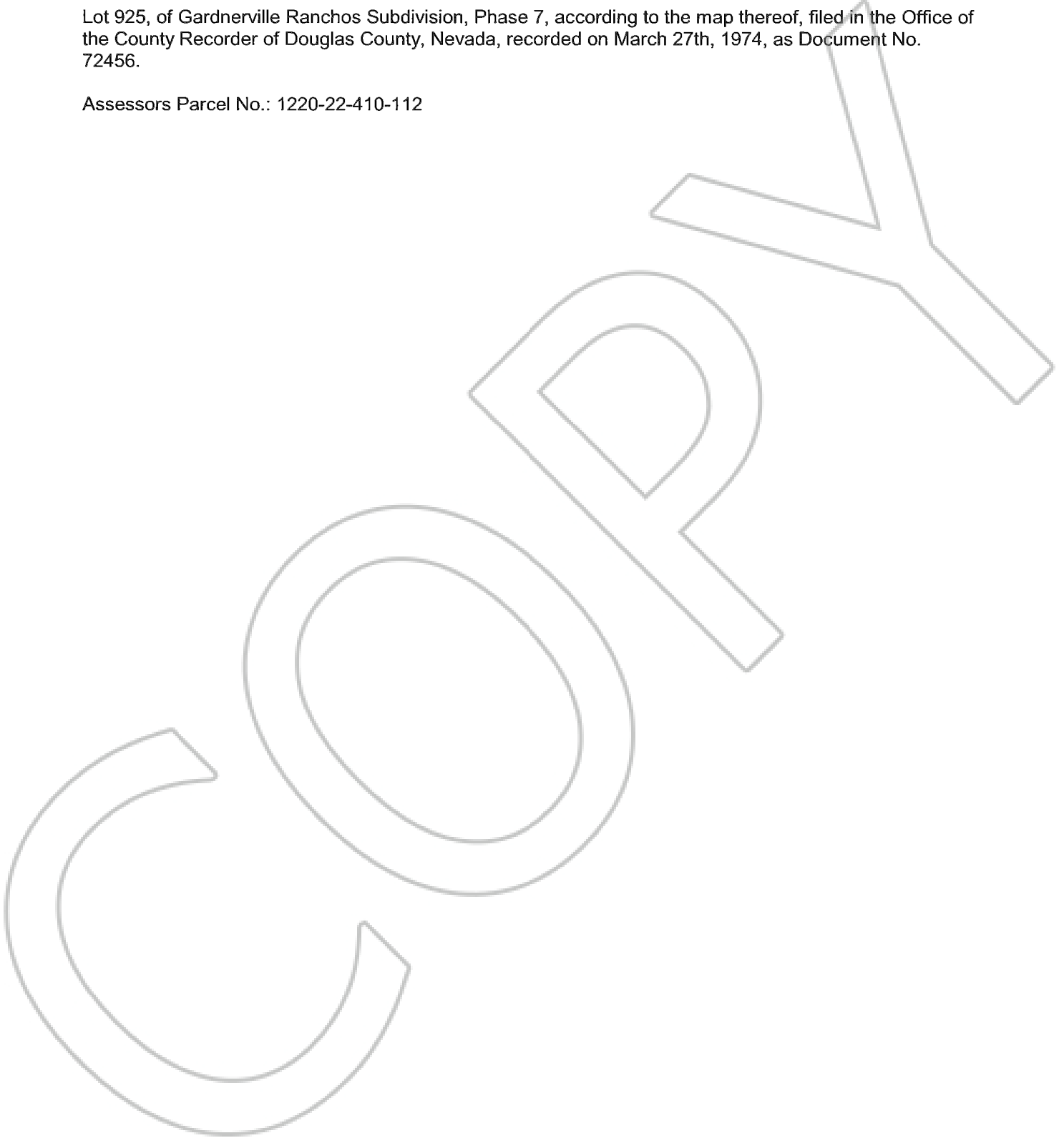

**STATE OF NEVADA
DECLARATION OF VALUE FORM**

1. Assessor Parcel Number(s)
 a) 1220-22-410-112
 b) _____
 c) _____
 d) _____

2. Type of Property:
 a) Vacant Land b) Sgl. Fam. Residence
 c) Condo/Twnhse d) 2-4 Plex
 e) Apt. Bldg. f) Comm'l/Ind'l
 g) Agricultural h) Mobile Home
 Other: _____

FOR RECORDER'S OPTIONAL USE ONLY	
Document/Instrument No.:	_____
Book _____	Page _____
Date of Recording:	_____
Notes:	<u>SG - Trust OK</u>

3. a. Total Value/Sale Price of Property: \$ _____
 b. Deed in Lieu of Foreclosure Only (value of property) \$ _____
 c. Transfer Tax Value: \$ _____
 d. Real Property Transfer Tax Due: \$0 _____

4. **IF EXEMPTION CLAIMED:**
 a. Transfer Tax Exemption, per NRS 375.090, Section: 7
 b. Explain Reason for Exemption: Transferring into Trust WITHOUT CONSIDERATION
 5. Partial Interest: Percentage Being Transferred: 100.00%

The undersigned declares and acknowledges, under penalty of perjury, pursuant to NRS 375.060 and NRS 375.110, that the information provided is correct to the best of their information and belief, and can be supported by documentation if called upon to substantiate the information provided herein. Furthermore, the parties agree the disallowance of any claimed exemption, or other determination of additional tax due, may result in a penalty of 10% of the tax due plus interest at 1% per month. **Pursuant to NRS 375.030, the Buyer and Seller shall be jointly and severally liable for any additional amount owed.**

Signature: [Signature] Capacity: ESROW ASST.
 Signature: _____ Capacity: _____

SELLER (GRANTOR) INFORMATION
(REQUIRED)

BUYER (GRANTEE) INFORMATION
(REQUIRED)

Print Name: Larry Pat Andrews and Ana M. Andrews, husband and wife as joint tenants with right of survivorship
 Address: 1475 Kathy Way
 City: Gardnerville
 State: NV Zip: 89460

Print Name: Larry Pat Andrews and Ana M. Andrews, Trustees, or Successor Trustee(s) of The Andrews Family Trust dated November 17, 2015
 Address: 1475 Kathy Way
 City: Gardnerville
 State: NV Zip: 89460

COMPANY/PERSON REQUESTING RECORDING (Required if not seller or buyer)

Print Name: First Centennial Title Company of Nevada Esc. #: 23033243-ES
 Address: 896 W Nye Ln, Ste 104
 City: Carson City State: NV Zip: 89703