



SHAWNYNE GARREN, RECORDER

After Recording Return To:
R.O. Anderson Engineering, Inc.
1603 Esmeralda Avenue
Minden, NV 89423

CERTIFICATE OF AMENDMENT

May 12, 2023

George Nicholas, PLS
Douglas County Surveyor
% DOWL
5510 Longley Lane
Reno, NV 89511

DOCUMENT:

Record of Survey
for Sheehan, Michael Guard
File No. 2023-993414
Recorded January 18, 2023
Official Records of Douglas County, Nevada

LOCATION:

Situate within a portion of Section 3, T.12N, R.19E.,
M.D.M. Douglas County, Nevada

Dear Mr. Nicholas,

In accordance with NRS 278.473, I am respectfully requesting that the following amendment and correction be noted on the above referenced plat:

- The A.P.N. on Sheet 1 of 1 within the parcel was incorrectly listed as "A.P.N. 1221-03-002-101" and should read: "A.P.N. 1219-03-002-101"

The amendment does not change or purport to change the physical location of any monument of the adjusted property line or boundary line.

Respectfully Submitted,

R.O. ANDERSON ENGINEERING, INC.

Andrew R. Lindsay
13 JUNE
2023

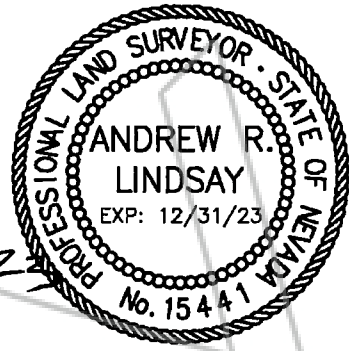

Andrew R. Lindsay, PLS
Nevada Professional Land Surveyor No. 15441

I hereby certify that I have examined the certificate of amendment and that the changes to the original document specified therein are provided for in applicable sections of NRS 278.010 to 278.630, inclusive, 625.340 to 625.380, inclusive, and local ordinances adopted pursuant thereto, and I am satisfied that this certificate of amendment so amends or corrects the document as to make it technically correct.

George Nicholas, PLS 30226
Douglas County Surveyor

