



SHAWNYNE GARREN, RECORDER

After Recording Return To:  
R.O. Anderson Engineering, Inc.  
1603 Esmeralda Avenue  
Minden, NV 89423

### CERTIFICATE OF AMENDMENT

May 12, 2023

George Nicholas, PLS  
Douglas County Surveyor  
c/o DOWL  
5510 Longley Lane  
Reno, NV 89511

**DOCUMENT:**

Record of Survey  
for Raymond A. Bertucci  
File No. 2023-993364  
Recorded January 24, 2023  
Official Records of Douglas County, Nevada

**LOCATION:**

Situate within a portion of Section 23, T.12N, R.19E.,  
M.D.M. Douglas County, Nevada

Dear Mr. Nicholas,

In accordance with NRS 278.473, I am respectfully requesting that the following amendment and correction be noted on the above referenced plat:

- The referenced document on Sheet 1 of 1 within the parcel was *incorrectly labeled as "Document No 1972-59965" and should read as follows: "PARCEL 4-A PER DOCUMENT NO. 146101"*

The amendment does not change or purport to change the physical location of any monument of the adjusted property line or boundary line.

Respectfully Submitted,

R.O. ANDERSON ENGINEERING, INC.

*Andrew R. Lindsay*  
13 June 2023

Andrew R. Lindsay, PLS  
Professional Land Surveyor No. 15441

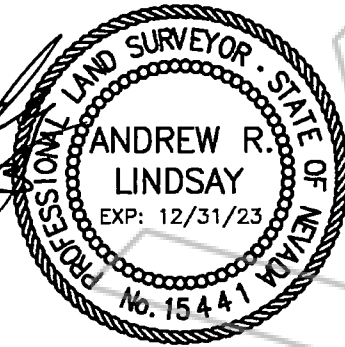

I hereby certify that I have examined the certificate of amendment and that the changes to the original document specified therein are provided for in applicable sections of NRS 278.010 to 278.630, inclusive, 625.340 to 625.380, inclusive, and local ordinances adopted pursuant thereto, and I am satisfied that this certificate of amendment so amends or corrects the document as to make it technically correct.

George Nicholas, PLS 30226  
Douglas County Surveyor

