

**APN: 1318-25-111-005**

**RECORDING REQUESTED BY:**

Kerry Smith & Rosemarie Smith, Trustees

**AFTER RECORDATION, RETURN BY MAIL TO:**

Kerry Smith & Rosemarie Smith, Trustees  
7026 Harvest Ln.  
Riverside, CA 92506

DOUGLAS COUNTY, NV **2024-1006313**

RPTT:\$185.25 Rec:\$40.00

Total:\$225.25

**04/03/2024 12:44 PM**

KERRY SMITH

Pgs=7



00179526202410063130070079

SHAWNYNE GARREN, RECORDER

SPACE ABOVE THIS LINE FOR RECORDER'S USE

**GRANT, BARGAIN, SALE DEED**

**THIS INDENTURE WITNESSETH:** On this 22 day of Feb., 2024, Grantors, Mary R. Anderson and Laurie J. Scalzo, Trustees of the Anderson Family Trust Agreement dated February 14, 2006, as to their undivided 10% interest, does hereby Grant, Bargain, Sell and Convey to Kerry Smith and Rosemarie Smith, Trustees of The Smith Family Trust dated March 2, 2019, and to the heirs and assigns of such Grantees forever, their interest in all that real property situated in the County of Douglas, State of Nevada, bounded and described as follows:

**SEE EXHIBIT "A" ATTACHED HERETO AND MADE A PART HEREOF.**

Subject to Restrictions, Conditions, Covenants, Rights, Rights of Way, and Easements now of record, if any. TOGETHER with all and singular the tenements, hereditaments and appurtenances now of record, if any.

IN WITNESS WHEREOF, the said first party has signed and sealed these presents the day and year first above written.

**See Notary Attachment**

Mary R. Anderson  
Mary R. Anderson, Trustee

**See Notary Attachment**

Laurie J. Scalzo  
Laurie J. Scalzo, Trustee

# ACKNOWLEDGMENT

A notary public or other officer completing this certificate verifies only the identity of the individual who signed the document to which this certificate is attached, and not the truthfulness, accuracy, or validity of that document.

State of California  
County of Los Angeles )

On 02/22/2024 before me, Ismael Gutierrez, Notary Public  
(insert name and title of the officer)

personally appeared Mary R. Anderson,  
who proved to me on the basis of satisfactory evidence to be the person(s) whose name(s) is/are subscribed to the within instrument and acknowledged to me that he/she/they executed the same in his/her/their authorized capacity(ies), and that by his/her/their signature(s) on the instrument the person(s), or the entity upon behalf of which the person(s) acted, executed the instrument.

I certify under PENALTY OF PERJURY under the laws of the State of California that the foregoing paragraph is true and correct.

WITNESS my hand and official seal.

Signature  (Seal)



## ACKNOWLEDGMENT

A notary public or other officer completing this certificate verifies only the identity of the individual who signed the document to which this certificate is attached, and not the truthfulness, accuracy, or validity of that document.

State of California  
County of Los Angeles )

On 02/22/2024 before me, Ismael Gutierrez, Notary Public  
(insert name and title of the officer)

personally appeared Laurie J. Scalzo,  
who proved to me on the basis of satisfactory evidence to be the person(s) whose name(s) is/are subscribed to the within instrument and acknowledged to me that he/she/they executed the same in his/her/their authorized capacity(ies), and that by his/her/their signature(s) on the instrument the person(s), or the entity upon behalf of which the person(s) acted, executed the instrument.

I certify under PENALTY OF PERJURY under the laws of the State of California that the foregoing paragraph is true and correct.

WITNESS my hand and official seal.

Signature  (Seal)

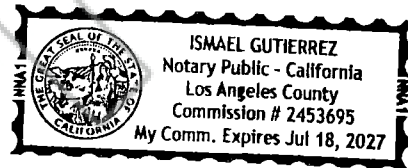

**EXHIBIT "A"**

All that certain lot, piece or parcel of land situate in the County of Douglas, State of Nevada, described as follows:

Lot 2, as shown on the map of KINGSBURY PALISADES, filed for record in the office of the County Recorder of Douglas County, State of Nevada on September 18, 1962, in Book 1 of Maps, as Document No. 20864.

Per NRS 111.312, this legal description was previously recorded at Document No.353543, in Book 1294, Page 4604, on 12/30/1994.

APN: 1318-25-111-005

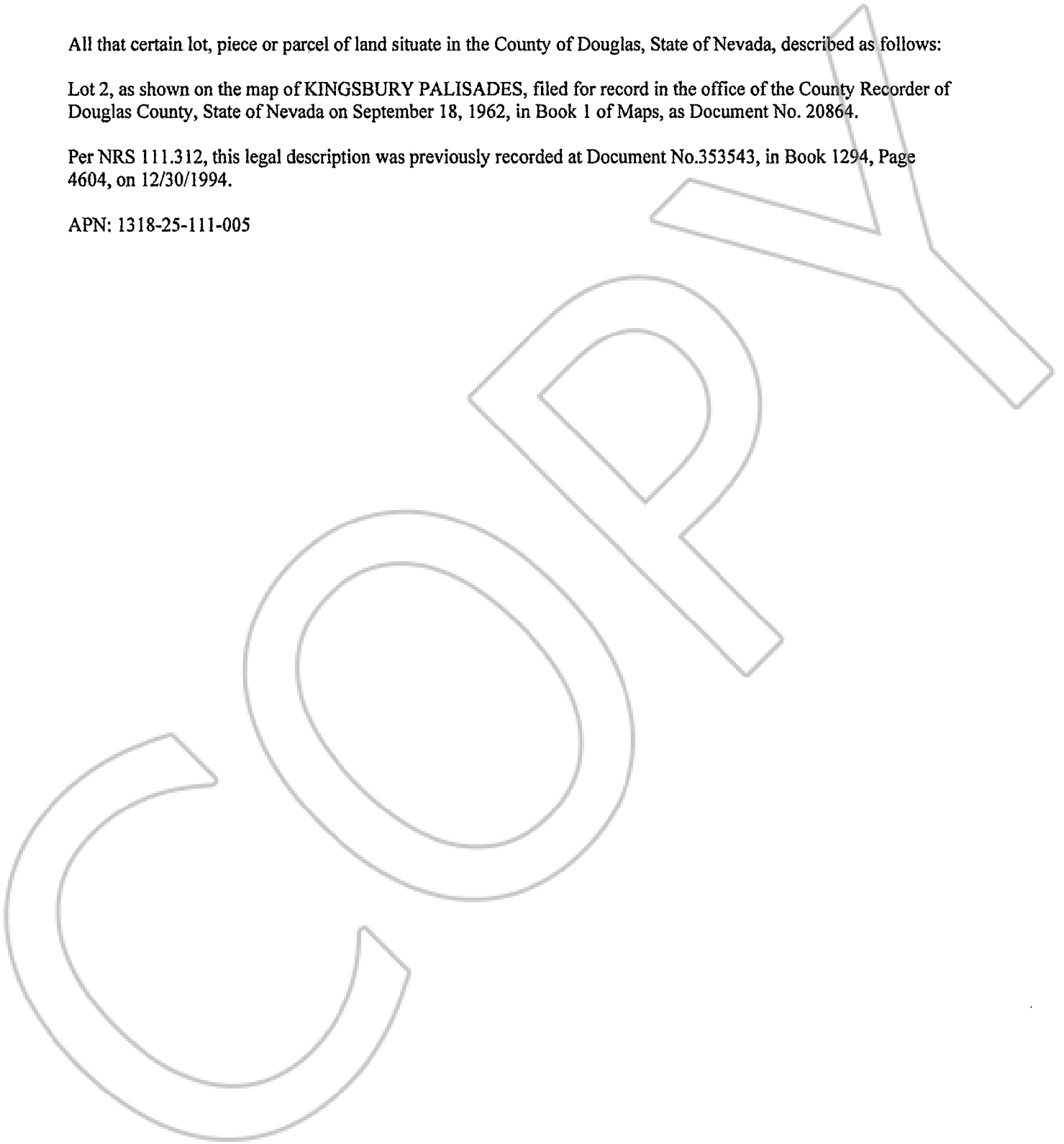

STATE OF NEVADA  
DECLARATION OF VALUE

1. Assessor Parcel Number(s)  
 a) 1318-25-111-005  
 b) \_\_\_\_\_  
 c) \_\_\_\_\_  
 d) \_\_\_\_\_

2. Type of Property:  
 a)  Vacant Land    b)  Single Fam. Res.  
 c)  Condo/Twnhse    d)  2-4 Plex  
 e)  Apt. Bldg    f)  Comm'l/Ind'l  
 g)  Agricultural    h)  Mobile Home  
 i)  Other \_\_\_\_\_

FOR RECORDERS OPTIONAL USE ONLY	
BOOK _____	PAGE _____
DATE OF RECORDING: _____	
NOTES: _____	

3. Total Value/Sales Price of Property: \$47,500.00  
 Deed in Lieu of Foreclosure Only (value of property) \_\_\_\_\_  
 Transfer Tax Value: \$ \_\_\_\_\_  
 Real Property Transfer Tax Due: \$185.25

4. If Exemption Claimed:  
 a. Transfer Tax Exemption per NRS 375.090, Section # \_\_\_\_\_  
 b. Explain Reason for Exemption: \_\_\_\_\_

5. Partial Interest: Percentage being transferred: 10.00 %

The undersigned declares and acknowledges, under penalty of perjury, pursuant to NRS 375.060 and NRS 375.110, that the information provided is correct to the best of their information and belief, and can be supported by documentation if called upon to substantiate the information provided herein. Furthermore, the parties agree that disallowance of any claimed exemption, or other determination of additional tax due, may result in a penalty of 10% of the tax due plus interest at 1% per month.

Pursuant to NRS 375.030, the Buyer and Seller shall be jointly and severally liable for any additional amount owed.

Signature Mary R. Anderson Capacity Grantor

Signature Laurie J. Scalzo Capacity Grantor

SELLER (GRANTOR) INFORMATION  
(REQUIRED)

BUYER (GRANTEE) INFORMATION  
(REQUIRED)

Print Name: Mary R. Anderson & Laurie J. Scalzo, TTEES  
 Address: 1752 Addison Rd.  
 City: Palos Verdes Estates  
 State: CA Zip: 90274

Print Name: Kerry Smith & Rosemarie Smith, TTEES  
 Address: 7026 Harvest Lane  
 City: Riverside  
 State: CA Zip: 92506

COMPANY/PERSON REQUESTING RECORDING  
(required if not the seller or buyer)

Print Name: \_\_\_\_\_ Escrow # \_\_\_\_\_  
 Address: \_\_\_\_\_  
 City: \_\_\_\_\_ State: \_\_\_\_\_ Zip: \_\_\_\_\_

(AS A PUBLIC RECORD THIS FORM MAY BE RECORDED/MICROFILMED)

See Notary Attachment

## ACKNOWLEDGMENT

A notary public or other officer completing this certificate verifies only the identity of the individual who signed the document to which this certificate is attached, and not the truthfulness, accuracy, or validity of that document.

State of California  
County of Los Angeles )

On 02/22/2024 before me, Ismael Gutierrez, Notary Public  
(insert name and title of the officer)

personally appeared Mary R. Anderson  
who proved to me on the basis of satisfactory evidence to be the person(s) whose name(s) is/are subscribed to the within instrument and acknowledged to me that he/she/they executed the same in his/her/their authorized capacity(ies), and that by his/her/their signature(s) on the instrument the person(s), or the entity upon behalf of which the person(s) acted, executed the instrument.

I certify under PENALTY OF PERJURY under the laws of the State of California that the foregoing paragraph is true and correct.

WITNESS my hand and official seal.

Signature  (Seal)

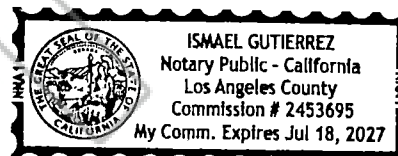

## ACKNOWLEDGMENT

A notary public or other officer completing this certificate verifies only the identity of the individual who signed the document to which this certificate is attached, and not the truthfulness, accuracy, or validity of that document.

State of California  
County of Los Angeles )

On 02/22/2024 before me, Ismael Gutierrez, Notary Public  
(insert name and title of the officer)

personally appeared Laurie J. Scalzo  
who proved to me on the basis of satisfactory evidence to be the person(s) whose name(s) is/are subscribed to the within instrument and acknowledged to me that he/she/they executed the same in his/her/their authorized capacity(ies), and that by his/her/their signature(s) on the instrument the person(s), or the entity upon behalf of which the person(s) acted, executed the instrument.

I certify under PENALTY OF PERJURY under the laws of the State of California that the foregoing paragraph is true and correct.

WITNESS my hand and official seal.

Signature  (Seal)

