

After Recording Return To:  
Turner & Associates, Inc.  
P.O. Box 5067  
Stateline, NV 89449



SHAWNYNE GARREN, RECORDER

**CERTIFICATE OF AMENDMENT**

April 5, 2024

Kaitlin Constantine, PLS  
Douglas County Surveyor  
c/o DOWL  
5510 Longley Lane  
Reno, NV 89511

**DOCUMENT:** Reversion to Acreage  
for Dancing Water Trust  
File No. 2023-1002201  
Recorded November 8, 2023  
Official Records of Douglas County, Nevada

**LOCATION:** Situate within a portion of Section 34, T.14N, R.18E.  
M.D.M Douglas County, Nevada

Dear Ms. Constantine,

In accordance with NRS 278.473, I am respectfully requesting that the following amendment and correction be noted on the above referenced plat:

- The A.P.N. on Sheet 1 of 1 associated with the REVERSION TO ACREAGE was incorrectly listed under the "Reversion Resultant Parcel" as "APN 1418-34-210-010" and should read: "APN 1418-34-210-012".

The amendment does not change or proprot to change the physical location of any survey monument, property line or boundary line.

Respectfully Submitted,

Turner & Associates, Inc.

Jeffery W. Turner, PLS  
Nevada Professional Land Surveyor No. 21260

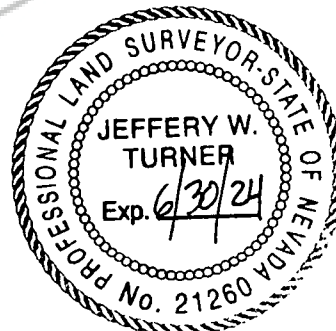

I hereby certify that I have examined the certificate of amendment and that the changes to the original document specified therein are provided for in applicable sections of NRS 278.010 to 278.630, inclusive, 625.340 to 625.380, inclusive, and local ordinances adopted pursuant thereto, and I am satisfied that this certificate of amendment so amends or corrects the document as to make it technically correct.

---

Kaitlin Constantine, PLS 30222  
Douglas County Surveyor

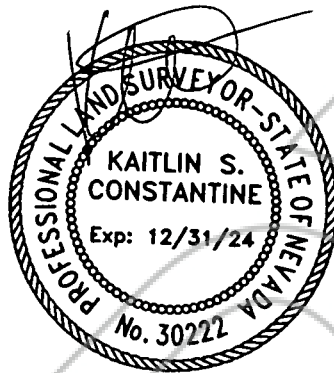

4/12/24

