

After Recording Return To:
Turner & Associates, Inc.
P.O. Box 5067
Stateline, NV 89449



SHAWNYNE GARREN, RECORDER

CERTIFICATE OF AMENDMENT

April 5, 2024

Kaitlin Constantine, PLS
Douglas County Surveyor
c/o DOWL
5510 Longley Lane
Reno, NV 89511

DOCUMENT: Record of Survey
for William A. Rogers
File No. 2023-1002259
Recorded November 13, 2023
Official Records of Douglas County, Nevada

LOCATION: Situate within a portion of Section 24, T.13N, R.18E.
M.D.M Douglas County, Nevada

Dear Ms. Constantine,

In accordance with NRS 278.473, I am respectfully requesting that the following amendment and correction be noted on the above referenced plat:

- The annotation of "LAUREL LN." is incorrect. The correct annotation should be: "LAUREL CIR."

The amendment does not change or proprot to change the physical location of any survey monument, property line or boundary line.

Respectfully Submitted,

Turner & Associates, Inc.

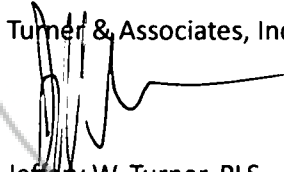

Jeffery W. Turner, PLS
Nevada Professional Land Surveyor No. 21260

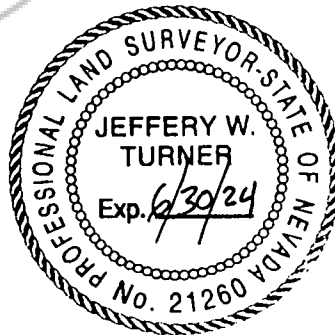

I hereby certify that I have examined the certificate of amendment and that the changes to the original document specified therein are provided for in applicable sections of NRS 278.010 to 278.630, inclusive, 625.340 to 625.380, inclusive, and local ordinances adopted pursuant thereto, and I am satisfied that this certificate of amendment so amends or corrects the document as to make it technically correct.

Kaitlin Constantine, PLS 30222
Douglas County Surveyor

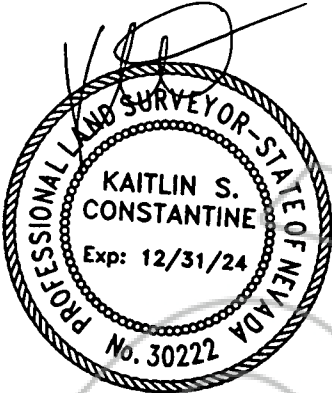

4/12/24

