

After Recording Return To:  
Turner & Associates, Inc.  
P.O. Box 5067  
Stateline, NV 89449



SHAWNYNE GARREN, RECORDER

### CERTIFICATE OF AMENDMENT

April 5, 2024

Kaitlin Constantine, PLS  
Douglas County Surveyor  
c/o DOWL  
5510 Longley Lane  
Reno, NV 89511

**DOCUMENT:** Record of Survey  
for Sea-N-Ski Trust 2020  
File No. 2024-1004314  
Recorded January 26, 2024  
Official Records of Douglas County, Nevada

**LOCATION:** Situate within a portion of Section 10, T.13N, R.18E.  
M.D.M Douglas County, Nevada

Dear Ms. Constantine,

In accordance with NRS 278.473, I am respectfully requesting that the following amendment and correction be noted on the above referenced plat:

- The text "POR. LOT 10, BLK. D" associated with the subject property surveyed should be "POR. LOT 12, BLK. D".

The amendment does not change or proprot to change the physical location of any survey monument, property line or boundary line.

Respectfully Submitted,

Turner & Associates, Inc.

Jeffery W. Turner, PLS  
Nevada Professional Land Surveyor No. 21260



I hereby certify that I have examined the certificate of amendment and that the changes to the original document specified therein are provided for in applicable sections of NRS 278.010 to 278.630, inclusive, 625.340 to 625.380, inclusive, and local ordinances adopted pursuant thereto, and I am satisfied that this certificate of amendment so amends or corrects the document as to make it technically correct.

\_\_\_\_\_  
Kaitlin Constantine, PLS 30222  
Douglas County Surveyor

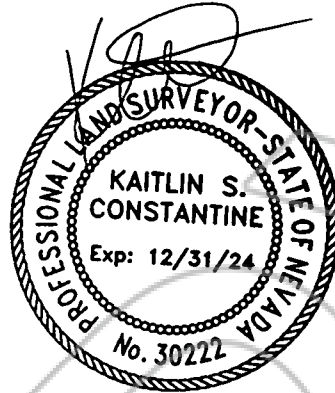

4/12/24

