



SHAWNYNE GARREN, RECORDER

APN# _____

Recording Requested by/Mail to:

Name: Jeremy Hutchings

Address: Community Development

City/State/Zip: _____

Mail Tax Statements to:

Name: _____

Address: _____

City/State/Zip: _____

Cert. of Amendment

Title of Document (required)

Please complete the Affirmation Statement below:

The undersigned hereby affirms that the document submitted for recording DOES contain personal information as required by law: (check applicable)

- Affidavit of Death – NRS 440.380 (1)(A) & NRS 40.525 (5)
- Military Discharge – NRS 419.020 (2)
- Other NRS _____ (state specific law)

-OR-

I the undersigned hereby affirm the attached document, including any exhibits, hereby submitted for recording does NOT contain the personal information of any person(s). (Per NRS 239B.030)

Signature

Jeremy J. Hutchings

Printed Name

This document is being (re-)recorded to correct document # _____, and is correcting

When Recorded Mail To:
DOWL
5510 Longley Lane,
Reno, NV 89511

April 16, 2024

Mr. Jeremy J. Hutchings, P.E.
Douglas County Engineer
1594 Esmeralda Avenue,
Minden, NV 89423

RECEIVED

APR 16 2024

DOUGLAS COUNTY

CERTIFICATE OF AMENDMENT

Document: Parcel Map LDA DP 18-0214 for “Mid Town Ventures, LLC”, Document No. 2019-931962, recorded on July 16, 2019, filed in the Official Records of Douglas County.

Legal Description: Situate within a portion of the Northeast One-Quarter (NE 1/4) of Section 33, Township 14 North, Range 20 East, M.D.M., Douglas County, State of Nevada.

Dear Mr. Hutchings,

Please be advised that in accordance with N.R.S. 278.473, I, Kaitlin S. Constantine, a Professional Land Surveyor, Nevada Certificate No. 30222, having been duly appointed by the Douglas County Engineer, Jeremy J. Hutchings, to prepare and record this Certificate of Amendment. I am notifying you of the following omission to be added on the above referenced plat:

1. The following note shall be added to Sheet 1:
“J. The private drainage easements as shown on Sheet 2 are for the benefit of Douglas County, but are to be maintained by the individual property owner.”

The correction of omission does not change or purport to change the physical location of any survey monument, property line, or boundary line.

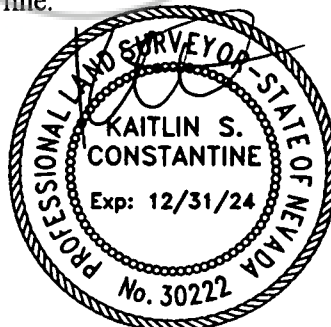

Kaitlin S. Constantine, P.L.S.
Nevada Certificate No. 30222

4/16/24

DOUGLAS COUNTY STATEMENT:

I have examined the Certificate of Amendment and the changes to the original document specified therein, and I am satisfied that this Certificate of Amendment so amends or corrects the original document.

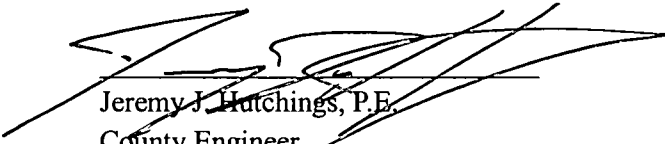
Jeremy J. Hutchings, P.E.
County Engineer

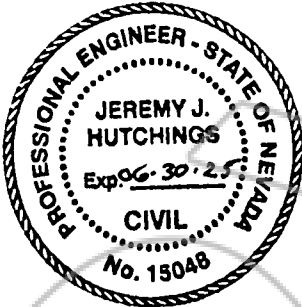

09.19.24

