

DOUGLAS COUNTY, NV  
RPTT:\$3591.90 Rec:\$40.00  
\$3,631.90 Pgs=24  
WILSON TITLE SERVICES  
SHAWNYNE GARREN, RECORDER

2024-1007755

05/14/2024 03:17 PM

APN#: 1319-30-643- See "Exhibit A-1"  
1319-30-721- See "Exhibit A-1"  
1319-30-722- See "Exhibit A-1"  
1319-30-723- See "Exhibit A-1"  
1319-30-724- See "Exhibit A-1"  
1319-30-644- See "Exhibit A-1"  
1319-30-645-003

**After Recording Send Tax Statements to:**

Holiday Inn Club Vacations Incorporated  
9271 S. John Young Pkwy.  
Orlando, FL 32819

**After Recording Return to:**

Wilson Title Services, LLC  
4045 S. Spencer Street, Suite A62  
Las Vegas, NV 89119

**GRANT, BARGAIN AND SALE DEED**  
*[Ridge Tahoe]*

***THIS DEED*** is made this 9<sup>th</sup> day of May, 2024, by and between **HOLIDAY INN CLUB VACATIONS INCORPORATED**, a Delaware corporation, whose mailing address is 9271 S. John Young Pkwy., Orlando, Florida 32819 ("Grantor"), and **CHICAGO TITLE TIMESHARE LAND TRUST, INC.**, a Florida corporation, solely as Trustee of Land Trust No. 2017-OL1 (a.k.a. Orange Lake Land Trust), whose mailing address is 2400 Maitland Center Parkway, Suite 110, Maitland, Florida 32751 ("Grantee") under that certain Trust Agreement for Orange Lake Land Trust (Trust No. 2017-OL1) dated December 15, 2017 as hereinafter described.

(Wherever used herein the terms "Grantor" and "Grantee" include all the parties to this instrument and the heirs, legal representatives and assigns of individuals, and the successors and assigns of corporations and limited liability companies.)

**WITNESSETH:**

***Grantor***, for and in consideration of Ten Dollars (\$10.00) and other good and valuable consideration to it paid by Grantee, the receipt and sufficiency of which is hereby acknowledged, by these presents does hereby grant, bargain, sell and convey unto Grantee, its successors and assigns, certain real property situate, lying and being in Douglas County, Nevada and being more particularly described in Exhibit "A" attached hereto and made a part hereof (the "Property").

***TOGETHER WITH*** all the improvements now or hereafter erected on the property, and all easements, rights, appurtenances, rents, royalties, mineral, oil and gas rights and profits, water rights and stock and all fixtures now or hereafter a part of the Property. All replacements and additions shall also be covered by this Deed. All of the foregoing together with all personal property associated therewith is part of the Property described above.

**SUBJECT TO:** (i) any and all rights, rights of way, reservations, restrictions, agreements, covenants, encumbrances, easements, mineral exceptions and reservations, and all conditions of record; (ii) the Fourth Amended and Restated Declaration of Time Share Covenants, Conditions, and Restrictions for The Ridge Tahoe recorded February 14, 1984, as Document No. 096758, as amended, and in the Declaration of Annexation of the Ridge Tahoe Phase Six, recorded December 18, 1990, as Document No. 241238, as amended by Amended Declaration of Annexation of The Ridge Tahoe Phase Six, recorded February 25, 1992, as Document No. 271727, as each may be amended, supplemented, and amended and restated from time to time; and (iii) Real Estate Taxes that are currently not due and payable but are a lien against the Property.

This conveyance is also made subject to the following:

1. All legal title and equitable title to the Property is being conveyed to Grantee, as trustee of that certain Orange Lake Land Trust created by that certain Trust Agreement for Orange Lake Land Trust (Trust No. 2017-OL1) executed by and among Grantor, Grantee, and Orange Lake Trust Owners' Association, Inc., a Florida not-for-profit corporation, as amended and supplemented from time to time ("Trust Agreement"), pursuant to which Grantor, as settlor, established the Orange Lake Land Trust in accordance with Section 689.071, *Florida Statutes* (the "Trust");
2. Grantee, as Trustee of the Trust, shall have the power and authority prescribed in Section 689.073(1), *Florida Statutes*;
3. Upon conveyance of the Property to Grantee by Grantor, all beneficial interests in the Trust resulting from the addition of the Property shall immediately and automatically vest in Grantor, as the sole initial beneficiary with respect to the Property, pursuant to the Trust Agreement, a memorandum of which is recorded as Instrument Number: 20180061276 in the Public Records of Orange County, Florida ("Memorandum of Trust"). Any deeds subsequently conveying beneficial interests in the Trust with respect to the Trust Plan Property or Interests (as such terms are defined in the Trust Agreement) shall be recorded solely in the Public Records of Orange County, Florida;
4. All Interests (as defined in the Trust Agreement) in the Trust are Florida real property interests;
5. The number of Points for Sale (as defined in the Trust Agreement) that Grantor may sell resulting from this conveyance and the submission of the Property to the Trust Plan shall be 48,979,750.
6. Grantor reserves for itself and its successors and assigns certain rights reserved to Grantor as more particularly set forth in that certain Fourth Amended and Restated Declaration of Time Share Covenants, Conditions, and Restrictions for The Ridge Tahoe recorded February 14, 1984, as Document No. 096758, as amended, and in the Declaration of Annexation of the Ridge Tahoe Phase Six, recorded December 18, 1990, as Document No. 241238, as amended by Amended Declaration of Annexation of The

Ridge Tahoe Phase Six, recorded February 25, 1992, as Document No. 271727, as each may be amended, supplemented, and amended and restated from time to time (collectively, the “**Declarations**”) and as described in the Recitation of Easements Affecting the Ridge Tahoe recorded February 24, 1992, as Document No. 271619. Such rights are not being conveyed pursuant to this Deed and may be exercised by Grantor without Grantee’s consent, approval, or knowledge. These rights, as more particularly described in the Declaration, and all of the relevant provisions of such Declaration with respect to these rights, are made a part of this Deed.

***TITLE TO THE PROPERTY*** is herein transferred with all tenements, hereditaments and appurtenances thereunto belonging or appertaining, and the reversion and reversions, remainder and remainders, rents, issues and profits thereof.

***TO HAVE AND TO HOLD***, the said Property unto the said Grantee, their heirs and successors and assigns forever in fee simple.

**IN WITNESS WHEREOF**, Grantor has executed this Grant, Bargain and Sale Deed on the date set forth above.

M. Vasquez  
Witness

Print name: Yuli Vanesa Cabala

Y. Hernandez  
Witness

Print name: Ydanda N. Hernandez

**"Grantor"**

**HOLIDAY INN CLUB VACATIONS  
INCORPORATED**, a Delaware  
corporation

By: [Signature]

Name: Michael Thompson

As its: Senior Vice President

(CORPORATE SEAL)

STATE OF FLORIDA     §  
                                  §  
COUNTY OF ORANGE   §

The foregoing instrument was acknowledged before me by means of  physical presence or  online notarization this 9<sup>th</sup> Jan day of May, 2024, by Michael Thompson, Senior Vice President of Holiday Inn Club Vacations Incorporated, a Delaware corporation, on behalf of the corporation.

Jennifer R. McGinnis  
Notary Public, State of Florida

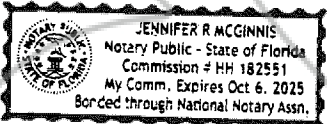

**Exhibit "A"**  
**Lot 28**  
**(Annual Interests)**

The timeshare estates set forth in Exhibit "A-1" attached hereto and incorporated herein by this reference, as said timeshare estate is defined in the Fourth Amended and Restated Declaration of Time Share Covenants, Conditions, and Restrictions for The Ridge Tahoe recorded February 14, 1984, as Document No. 096758, as amended, and in the Declaration of Annexation of the Ridge Tahoe Phase Six, recorded December 18, 1990, as Document No. 241238, as amended by Amended Declaration of Annexation of The Ridge Tahoe Phase Six, recorded February 25, 1992, as Document No. 271727, as each may be amended, supplemented, and amended and restated from time to time (collectively, the "Declarations") and as described in the Recitation of Easements Affecting the Ridge Tahoe recorded February 24, 1992, as Document No. 271619, which timeshare estate is comprised of:

An undivided 1/51<sup>st</sup> interest as tenants in common, with each interest having a 1/51<sup>st</sup> interest in and to that certain real property and improvements as follows:

(A) An undivided 1/50<sup>th</sup> interest in and to Lot 28 as shown on Tahoe Village Unit No. 3 – 13<sup>th</sup> Amended Map, recorded December 31, 1991, as Document No. 268097, re-recorded as Document No. 269053, Official Records of Douglas County, State of Nevada, excepting therefrom Units 1 through 50 (inclusive) as shown on said map; and

(B) A given single unit as set forth in <See Exhibit A-1> as shown and defined on said map; together with those easements appurtenant thereto and such easements described in the Fourth Amended and Restated Declaration of Time Share Covenants, Conditions and Restrictions for The Ridge Tahoe recorded February 14, 1984, as Document No. 096758, as amended, and in the Declaration of Annexation of The Ridge Tahoe Phase Six, recorded December 18, 1990, as Document No. 241238, as amended by Amended Declaration of Annexation of The Ridge Tahoe Phase Six, recorded February 25, 1992, as Document No. 271727, and as described in the Recitation of Easements Affecting the Ridge Tahoe recorded February 24, 1992, as Document No. 271619, and subject to said Declarations; with the exclusive right to use said interest, in Lot 28 only, for one week each year in accordance with said Declarations.

A Portion of APN: 1319-30-643-<See Exhibit A-1>

**Exhibit "A"**  
**Lot 28**  
**(Biennial Interests)**

The timeshare estates set forth in Exhibit "A-1" attached hereto and incorporated herein by this reference, as said timeshare estate is defined in the Fourth Amended and Restated Declaration of Time Share Covenants, Conditions, and Restrictions for The Ridge Tahoe recorded February 14, 1984, as Document No. 096758, as amended, and in the Declaration of Annexation of the Ridge Tahoe Phase Six, recorded December 18, 1990, as Document No. 241238, as amended by Amended Declaration of Annexation of The Ridge Tahoe Phase Six, recorded February 25, 1992, as Document No. 271727, as each may be amended, supplemented, and amended and restated from time to time (collectively, the "Declarations") and as described in the Recitation of Easements Affecting the Ridge Tahoe recorded February 24, 1992, as Document No. 271619, which timeshare estate is comprised of:

An undivided 1/102<sup>nd</sup> interest as tenants in common, with each interest having a 1/102<sup>nd</sup> interest in and to that certain real property and improvements as follows:

(A) An undivided 1/50<sup>th</sup> interest in and to Lot 28 as shown on Tahoe Village Unit No. 3 – 13<sup>th</sup> Amended Map, recorded December 31, 1991, as Document No. 268097, re-recorded as Document No. 269053, Official Records of Douglas County, State of Nevada, excepting therefrom Units 1 through 50 (inclusive) as shown on said map; and

(B) A given single unit as set forth in <See Exhibit A-1> as shown and defined on said map; together with those easements appurtenant thereto and such easements described in the Fourth Amended and Restated Declaration of Time Share Covenants, Conditions and Restrictions for The Ridge Tahoe recorded February 14, 1984, as Document No. 096758, as amended, and in the Declaration of Annexation of The Ridge Tahoe Phase Six, recorded December 18, 1990, as Document No. 241238, as amended by Amended Declaration of Annexation of The Ridge Tahoe Phase Six, recorded February 25, 1992, as Document No. 271727, and as described in the Recitation of Easements Affecting the Ridge Tahoe recorded February 24, 1992, as Document No. 271619, and subject to said Declarations; with the exclusive right to use said interest in the same unit type conveyed, in Lot 28 only, for one week every other year in <See Exhibit A-1>-numbered years in accordance with said Declarations.

A Portion of APN: 1319-30-643-<See Exhibit A-1>

**Exhibit "A"**  
**Lots 31, 32, and 33**  
**(Annual Interests)**

The timeshare estates set forth in Exhibit "A-1" attached hereto and incorporated herein by this reference, as said timeshare estate is defined in the Fourth Amended and Restated Declaration of Time Share Covenants, Conditions, and Restrictions for The Ridge Tahoe recorded February 14, 1984, as Document No. 096758, as amended, and in the Declaration of Annexation of the Ridge Tahoe Phase Six, recorded December 18, 1990, as Document No. 241238, as amended by Amended Declaration of Annexation of The Ridge Tahoe Phase Six, recorded February 25, 1992, as Document No. 271727, as each may be amended, supplemented, and amended and restated from time to time (collectively, the "Declarations") and as described in the Recitation of Easements Affecting the Ridge Tahoe recorded February 24, 1992, as Document No. 271619, which timeshare estate is comprised of:

An undivided 1/51<sup>st</sup> interest as tenants in common, with each interest having a 1/51<sup>st</sup> interest in and to that certain real property and improvements as follows:

(A) An undivided 1/20<sup>th</sup> interest in and to <See Exhibit A-1> as shown on Tahoe Village Unit No. 3 - 13<sup>th</sup> Amended Map, recorded December 31, 1991, as Document No. 268097, re-recorded as Document No. 269053, Official Records of Douglas County, State of Nevada, excepting therefrom Units 081 through 100 (inclusive) as shown on Tahoe Village Unit No. 3, Fifth Amended Map, recorded October 29, 1981, as Document No. 61612, as corrected by Certificate of Amendment recorded November 23, 1981, as Document No. 62661; and

(B) A given single unit as set forth in <See Exhibit A-1> as shown and defined on said last mentioned map as corrected by said Certificate of Amendment; together with those easements appurtenant thereto and such easements described in the Fourth Amended and Restated Declaration of Time Share Covenants, Conditions and Restrictions for The Ridge Tahoe recorded February 14, 1984, as Document No. 096758, as amended, and in the Declaration of Annexation of The Ridge Tahoe Phase II recorded February 14, 1984, as Document No. 096759, as amended by document recorded October 15, 1990, as Document No. 236690, and as described in the Recitation of Easements Affecting the Ridge Tahoe recorded February 24, 1992, as Document No. 271619, and subject to said Declarations; with the exclusive right to use said interest in Lots 31, 32, or 33 only, for one week each year in the <See Exhibit A-1> "Season" as defined in and in accordance with said Declarations.

A Portion of APN: 1319-30-<See Exhibit A-1>

**Exhibit "A"**  
**Lots 31, 32, and 33**  
**(Biennial Interests)**

The timeshare estates set forth in Exhibit "A-1" attached hereto and incorporated herein by this reference, as said timeshare estate is defined in the Fourth Amended and Restated Declaration of Time Share Covenants, Conditions, and Restrictions for The Ridge Tahoe recorded February 14, 1984, as Document No. 096758, as amended, and in the Declaration of Annexation of the Ridge Tahoe Phase Six, recorded December 18, 1990, as Document No. 241238, as amended by Amended Declaration of Annexation of The Ridge Tahoe Phase Six, recorded February 25, 1992, as Document No. 271727, as each may be amended, supplemented, and amended and restated from time to time (collectively, the "Declarations") and as described in the Recitation of Easements Affecting the Ridge Tahoe recorded February 24, 1992, as Document No. 271619, which timeshare estate is comprised of:

An undivided 1/102<sup>nd</sup> interest as tenants in common, with each interest having a 1/102<sup>nd</sup> interest in and to that certain real property and improvements as follows:

(A) An undivided 1/20<sup>th</sup> interest in and to <See Exhibit A-1> as shown on Tahoe Village Unit No. 3 - 13<sup>th</sup> Amended Map, recorded December 31, 1991, as Document No. 268097, re-recorded as Document No. 269053, Official Records of Douglas County, State of Nevada, excepting therefrom Units 081 through 100 (inclusive) as shown on Tahoe Village Unit No. 3, Fifth Amended Map, recorded October 29, 1981, as Document No. 61612, as corrected by Certificate of Amendment recorded November 23, 1981, as Document No. 62661; and

(B) A given single unit as set forth in <See Exhibit A-1> as shown and defined on said last mentioned map as corrected by said Certificate of Amendment; together with those easements appurtenant thereto and such easements described in the Fourth Amended and Restated Declaration of Time Share Covenants, Conditions and Restrictions for The Ridge Tahoe recorded February 14, 1984, as Document No. 096758, as amended, and in the Declaration of Annexation of The Ridge Tahoe Phase II recorded February 14, 1984, as Document No. 096759, as amended by document recorded October 15, 1990, as Document No. 236690, and as described in the Recitation of Easements Affecting the Ridge Tahoe recorded February 24, 1992, as Document No. 271619, and subject to said Declarations; with the exclusive right to use said interest in Lots 31, 32, or 33 only, for one week every other year in <See Exhibit A-1>-numbered years in the <See Exhibit A-1> "Season" as defined in and in accordance with said Declarations.

A Portion of APN: 1319-30-<See Exhibit A-1>



**Exhibit "A"**  
**Lot 34**  
**(Annual Interests)**

The timeshare estates set forth in Exhibit "A-1" attached hereto and incorporated herein by this reference, as said timeshare estate is defined in the Fourth Amended and Restated Declaration of Time Share Covenants, Conditions, and Restrictions for The Ridge Tahoe recorded February 14, 1984, as Document No. 096758, as amended, and in the Declaration of Annexation of the Ridge Tahoe Phase Six, recorded December 18, 1990, as Document No. 241238, as amended by Amended Declaration of Annexation of The Ridge Tahoe Phase Six, recorded February 25, 1992, as Document No. 271727, as each may be amended, supplemented, and amended and restated from time to time (collectively, the "Declarations") and as described in the Recitation of Easements Affecting the Ridge Tahoe recorded February 24, 1992, as Document No. 271619, which timeshare estate is comprised of:

An undivided 1/51<sup>st</sup> interest as tenants in common in and to that certain real property and improvements as follows:

(A) An undivided 1/38<sup>th</sup> interest in and to Lot 34 as shown on Tahoe Village Unit No. 3 - 13<sup>th</sup> Amended Map, recorded December 31, 1991, as Document No. 268097, re-recorded as Document No. 269053, Official Records of Douglas County, State of Nevada, excepting therefrom Units 001 through 038 (inclusive) as shown on that certain Condominium Plan recorded June 22, 1987, as Document No. 156903; and

(B) A given single unit as set forth in <See Exhibit A-1> as shown and defined on said Condominium Plan; together with those easements appurtenant thereto and such easements described in the Fourth Amended and Restated Declaration of Time Share Covenants, Conditions and Restrictions for The Ridge Tahoe recorded February 14, 1984, as Document No. 096758, as amended, and in the Declaration of Annexation of The Ridge Tahoe recorded August 21, 1984, as Document No. 097150, as amended, by Documents recorded October 15, 1990, June 22, 1987 and November 10, 1987 as Document Nos. 236691, 156904 and 166130, and as described in the Recitation of Easements Affecting the Ridge Tahoe recorded February 24, 1992, as Document No. 271619, and subject to said Declarations; with the exclusive right to use said interest in the same unit type conveyed, in Lot 34 only, for one week each year in the <See Exhibit A-1> "Season" as defined in and in accordance with said Declarations.

A Portion of APN: 1319-30-724-<See Exhibit A-1>

**Exhibit "A"**  
**Lot 34**  
**(Biennial Interests)**

The timeshare estates set forth in Exhibit "A-1" attached hereto and incorporated herein by this reference, as said timeshare estate is defined in the Fourth Amended and Restated Declaration of Time Share Covenants, Conditions, and Restrictions for The Ridge Tahoe recorded February 14, 1984, as Document No. 096758, as amended, and in the Declaration of Annexation of the Ridge Tahoe Phase Six, recorded December 18, 1990, as Document No. 241238, as amended by Amended Declaration of Annexation of The Ridge Tahoe Phase Six, recorded February 25, 1992, as Document No. 271727, as each may be amended, supplemented, and amended and restated from time to time (collectively, the "Declarations") and as described in the Recitation of Easements Affecting the Ridge Tahoe recorded February 24, 1992, as Document No. 271619, which timeshare estate is comprised of:

An undivided 1/102<sup>nd</sup> interest as tenants in common in and to that certain real property and improvements as follows:

(A) An undivided 1/38<sup>th</sup> interest in and to Lot 34 as shown on Tahoe Village Unit No. 3 - 13<sup>th</sup> Amended Map, recorded December 31, 1991, as Document No. 268097, re-recorded as Document No. 269053, Official Records of Douglas County, State of Nevada, excepting therefrom Units 001 through 038 (inclusive) as shown on that certain Condominium Plan recorded June 22, 1987, as Document No. 156903; and

(B) A given single unit as set forth in <See Exhibit A-1> as shown and defined on said Condominium Plan; together with those easements appurtenant thereto and such easements described in the Fourth Amended and Restated Declaration of Time Share Covenants, Conditions and Restrictions for The Ridge Tahoe recorded February 14, 1984, as Document No. 096758, as amended, and in the Declaration of Annexation of The Ridge Tahoe recorded August 21, 1984, as Document No. 097150, as amended, by Documents recorded October 15, 1990, June 22, 1987 and November 10, 1987 as Document Nos. 236691, 156904 and 166130, and as described in the Recitation of Easements Affecting the Ridge Tahoe recorded February 24, 1992, as Document No. 271619, and subject to said Declarations; with the exclusive right to use said interest in the same unit type, in Lot 34 only, for one week every other year in <See Exhibit A-1>-numbered years in the <See Exhibit A-1> "Season" as defined in and in accordance with said Declarations.

A Portion of APN: 1319-30-724-<See Exhibit A-1>

**Exhibit "A"**  
**Lot 37**  
**(Annual Interests)**

The timeshare estates set forth in Exhibit "A-1" attached hereto and incorporated herein by this reference, as said timeshare estate is defined in the Fourth Amended and Restated Declaration of Time Share Covenants, Conditions, and Restrictions for The Ridge Tahoe recorded February 14, 1984, as Document No. 096758, as amended, and in the Declaration of Annexation of the Ridge Tahoe Phase Six, recorded December 18, 1990, as Document No. 241238, as amended by Amended Declaration of Annexation of The Ridge Tahoe Phase Six, recorded February 25, 1992, as Document No. 271727, as each may be amended, supplemented, and amended and restated from time to time (collectively, the "Declarations") and as described in the Recitation of Easements Affecting the Ridge Tahoe recorded February 24, 1992, as Document No. 271619, which timeshare estate is comprised of:

An undivided 1/51<sup>st</sup> interest as tenants in common in and to that certain real property and improvements as follows:

(A) An undivided 1/106<sup>th</sup> interest in and to Lot 37 as shown on Tahoe Village Unit No. 3 - 13<sup>th</sup> Amended Map, recorded December 31, 1991, as Document No. 268097, re-recorded as Document No. 269053, Official Records of Douglas County, State of Nevada, excepting therefrom Units 039 through 080 (inclusive) and Units 141 through 204 (inclusive) as shown on that certain Condominium Plan recorded July 14, 1988, as Document No. 182057; and

(B) A given single unit as set forth in <See Exhibit A-1> as shown and defined on said Condominium Plan; together with those easements appurtenant thereto and such easements described in the Fourth Amended and Restated Declaration of Time Share Covenants, Conditions and Restrictions for The Ridge Tahoe recorded February 14, 1984, as Document No. 096758, as amended, and in the Declaration of Annexation of The Ridge Tahoe Phase Five recorded August 18, 1988, as Document No. 184461, as amended, and as described in the Recitation of Easements Affecting the Ridge Tahoe recorded February 24, 1992, as Document No. 271619, and subject to said Declarations; with the exclusive right to use said interest in Lot 37 only, for one week each year in the <See Exhibit A-1> "Season" as defined in and in accordance with said Declarations.

A Portion of APN: 1319-30-644-<See Exhibit A-1>

**Exhibit "A"**  
**Lot 37**  
**(Biennial Interests)**

The timeshare estates set forth in Exhibit "A-1" attached hereto and incorporated herein by this reference, as said timeshare estate is defined in the Fourth Amended and Restated Declaration of Time Share Covenants, Conditions, and Restrictions for The Ridge Tahoe recorded February 14, 1984, as Document No. 096758, as amended, and in the Declaration of Annexation of the Ridge Tahoe Phase Six, recorded December 18, 1990, as Document No. 241238, as amended by Amended Declaration of Annexation of The Ridge Tahoe Phase Six, recorded February 25, 1992, as Document No. 271727, as each may be amended, supplemented, and amended and restated from time to time (collectively, the "Declarations") and as described in the Recitation of Easements Affecting the Ridge Tahoe recorded February 24, 1992, as Document No. 271619, which timeshare estate is comprised of:

An undivided 1/102<sup>nd</sup> interest as tenants in common in and to that certain real property and improvements as follows:

(A) An undivided 1/106<sup>th</sup> interest in and to Lot 37 as shown on Tahoe Village Unit No. 3 - 13<sup>th</sup> Amended Map, recorded December 31, 1991, as Document No. 268097, re-recorded as Document No. 269053, Official Records of Douglas County, State of Nevada, excepting therefrom Units 039 through 080 (inclusive) and Units 141 through 204 (inclusive) as shown on that certain Condominium Plan recorded July 14, 1988, as Document No. 182057; and

(B) A given single unit as set forth in <See Exhibit A-1> as shown and defined on said Condominium Plan; together with those easements appurtenant thereto and such easements described in the Fourth Amended and Restated Declaration of Time Share Covenants, Conditions and Restrictions for The Ridge Tahoe recorded February 14, 1984, as Document No. 096758, as amended, and in the Declaration of Annexation of The Ridge Tahoe Phase Five recorded August 18, 1988, as Document No. 184461, as amended, and as described in the Recitation of Easements Affecting the Ridge Tahoe recorded February 24, 1992, as Document No. 271619, and subject to said Declarations; with the exclusive right to use said interest in Lot 37 only, for one week every other year in the <See Exhibit A-1>-numbered years in the <See Exhibit A-1> "Season" as defined in and in accordance with said Declarations.

A Portion of APN: 1319-30-644-<See Exhibit A-1>

**Exhibit "A"**  
**Lot 42**  
**(Annual Interests)**

The timeshare estates set forth in Exhibit "A-1" attached hereto and incorporated herein by this reference, as said timeshare estate is defined in the Fourth Amended and Restated Declaration of Time Share Covenants, Conditions, and Restrictions for The Ridge Tahoe recorded February 14, 1984, as Document No. 096758, as amended, and in the Declaration of Annexation of the Ridge Tahoe Phase Six, recorded December 18, 1990, as Document No. 241238, as amended by Amended Declaration of Annexation of The Ridge Tahoe Phase Six, recorded February 25, 1992, as Document No. 271727, as each may be amended, supplemented, and amended and restated from time to time (collectively, the "Declarations") and as described in the Recitation of Easements Affecting the Ridge Tahoe recorded February 24, 1992, as Document No. 271619, which timeshare estate is comprised of:

An undivided 1/51<sup>st</sup> interest as tenants in common, with each interest having a 1/51<sup>st</sup> interest in and to that certain real property and improvements as follows:

(A) An undivided 1/48<sup>th</sup> interest in and to Lot 42 as shown on Tahoe Village Unit No. 3 - 14<sup>th</sup> Amended Map, recorded April 1, 1994, as Document No. 333985, Official Records of Douglas County, State of Nevada, excepting therefrom Units 255 through 302 (inclusive) as shown on said map; and

(B) A given single unit as set forth in <See Exhibit A-1> as shown and defined on said map; together with those easements appurtenant thereto and such easements described in the Fourth Amended and Restated Declaration of Time Share Covenants, Conditions and Restrictions for The Ridge Tahoe recorded February 14, 1984, as Document No. 096758, as amended, and in the Declaration of Annexation of The Ridge Tahoe Phase Seven recorded April 26, 1995, as Document No. 360927, as amended by Amended and Restated Declaration of Annexation of The Ridge Tahoe Phase Seven, recorded May 4, 1995, as Document No. 361461, and as further amended by the Second Amendment to Declaration of Annexation of The Ridge Tahoe Phase Seven recorded on October 17, 1995 as Document No. 372905, and as described in the First Amended Recitation of Easements Affecting the Ridge Tahoe recorded June 9, 1995, as Document No. 363815, and subject to said Declarations; with the exclusive right to use said interest, in Lot 42 only, for one week each year in accordance with said Declarations.

Together with a 13-foot wide easement located within a portion of Section 30, Township 13 North, Range 19 East, MDB&M, Douglas County, Nevada, being more particularly described as follows:

BEGINNING at the Northwest corner of this easement said point bears S. 43°19'06" E., 472.67 feet from Control Point "C" as shown on the Tahoe Village Unit No. 3 - 13<sup>th</sup> Amended Map, Document No. 269053 of the Douglas County Recorder's Office; thence S. 52°20'29" E., 24.92 feet to a point on the Northerly line of Lot 36 as shown on said 13<sup>th</sup> Amended Map; thence S.

14°00'00" W. along said Northerly line, 14.19 feet; thence N. 52°20'29" W., 30.59 feet; thence N. 37°33'12" E., 13.00 feet to the POINT OF BEGINNING.

A Portion of APN: 1319-30-645-003

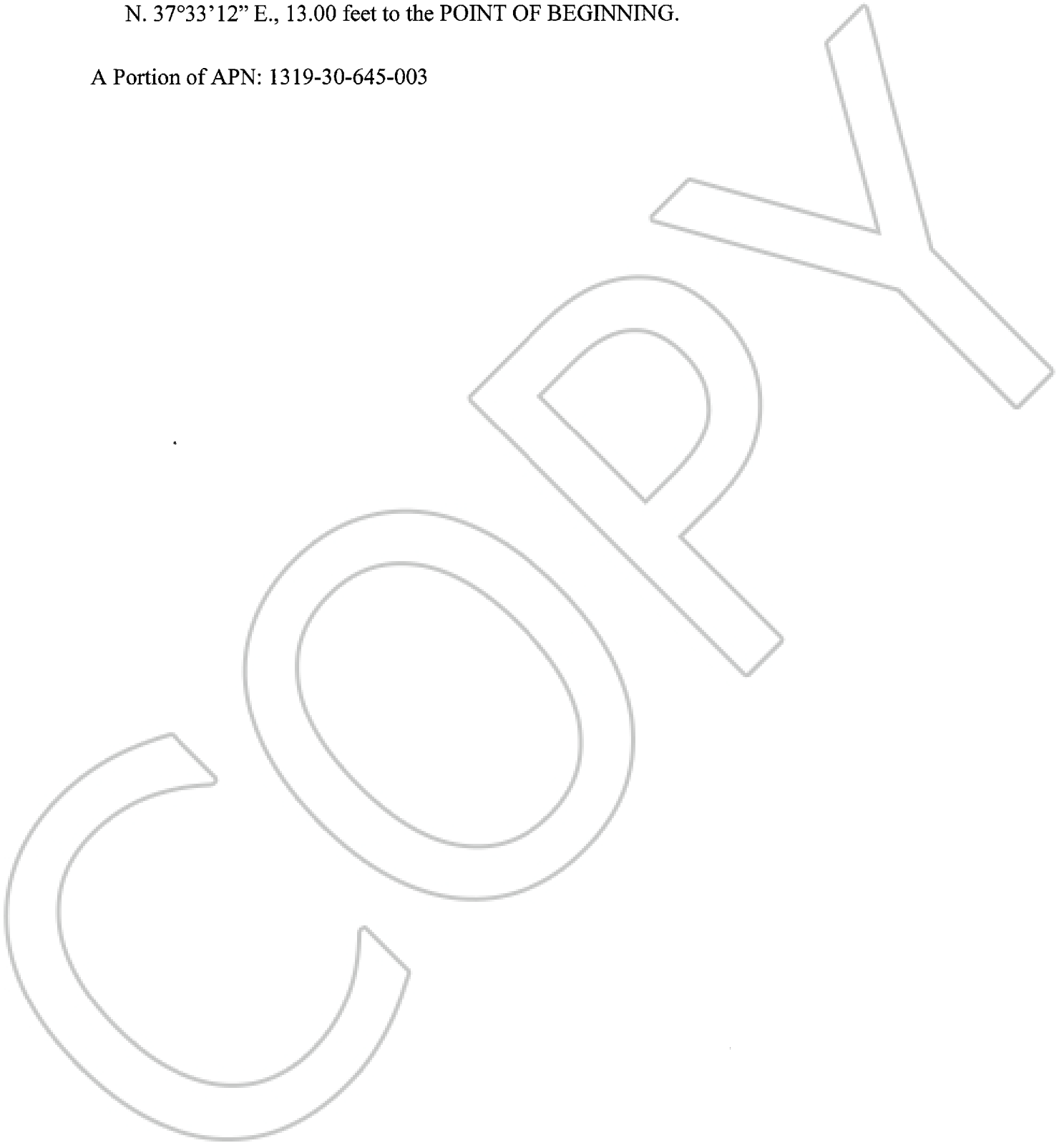

**Exhibit "A"**  
**Lot 42**  
**(Biennial Interests)**

The timeshare estates set forth in Exhibit "A-1" attached hereto and incorporated herein by this reference, as said timeshare estate is defined in the Fourth Amended and Restated Declaration of Time Share Covenants, Conditions, and Restrictions for The Ridge Tahoe recorded February 14, 1984, as Document No. 096758, as amended, and in the Declaration of Annexation of the Ridge Tahoe Phase Six, recorded December 18, 1990, as Document No. 241238, as amended by Amended Declaration of Annexation of The Ridge Tahoe Phase Six, recorded February 25, 1992, as Document No. 271727, as each may be amended, supplemented, and amended and restated from time to time (collectively, the "Declarations") and as described in the Recitation of Easements Affecting the Ridge Tahoe recorded February 24, 1992, as Document No. 271619, which timeshare estate is comprised of:

An undivided 1/102<sup>nd</sup> interest as tenants in common, with each interest having a 1/102<sup>nd</sup> interest in and to that certain real property and improvements as follows:

(A) An undivided 1/48<sup>th</sup> interest in and to Lot 42 as shown on Tahoe Village Unit No. 3 - 14<sup>th</sup> Amended Map, recorded April 1, 1994, as Document No. 333985, Official Records of Douglas County, State of Nevada, excepting therefrom Units 255 through 302 (inclusive) as shown on said map; and

(B) A given single unit as set forth in <See Exhibit A-1> as shown and defined on said map; together with those easements appurtenant thereto and such easements described in the Fourth Amended and Restated Declaration of Time Share Covenants, Conditions and Restrictions for The Ridge Tahoe recorded February 14, 1984, as Document No. 096758, as amended, and in the Declaration of Annexation of The Ridge Tahoe Phase Seven recorded April 26, 1995, as Document No. 360927, as amended by Amended and Restated Declaration of Annexation of The Ridge Tahoe Phase Seven, recorded May 4, 1995, as Document No. 361461, and as further amended by the Second Amendment to Declaration of Annexation of The Ridge Tahoe Phase Seven recorded on October 17, 1995 as Document No. 372905, and as described in the First Amended Recitation of Easements Affecting the Ridge Tahoe recorded June 9, 1995, as Document No. 363815, and subject to said Declarations; with the exclusive right to use said interest, in Lot 42 only, for one week every other year in <See Exhibit A-1>-numbered years in accordance with said Declarations.

Together with a 13-foot wide easement located within a portion of Section 30, Township 13 North, Range 19 East, MDB&M, Douglas County, Nevada, being more particularly described as follows:

BEGINNING at the Northwest corner of this easement said point bears S. 43°19'06" E, 472.67 feet from Control Point "C" as shown on the Tahoe Village Unit No. 3 - 13th Amended Map, Document No. 269053 of the Douglas County Recorder's Office; thence S. 52°20'29" E., 24.92 feet to a point on the Northerly line of Lot 36 as shown on said 13th Amended Map; thence S.

14°00'00" W. along said Northerly line, 14.19 feet; thence N. 52°20'29" W., 30.59 feet; thence N. 37°33'12" E., 13.00 feet to the POINT OF BEGINNING.

A Portion of APN: 1319-30-645-003

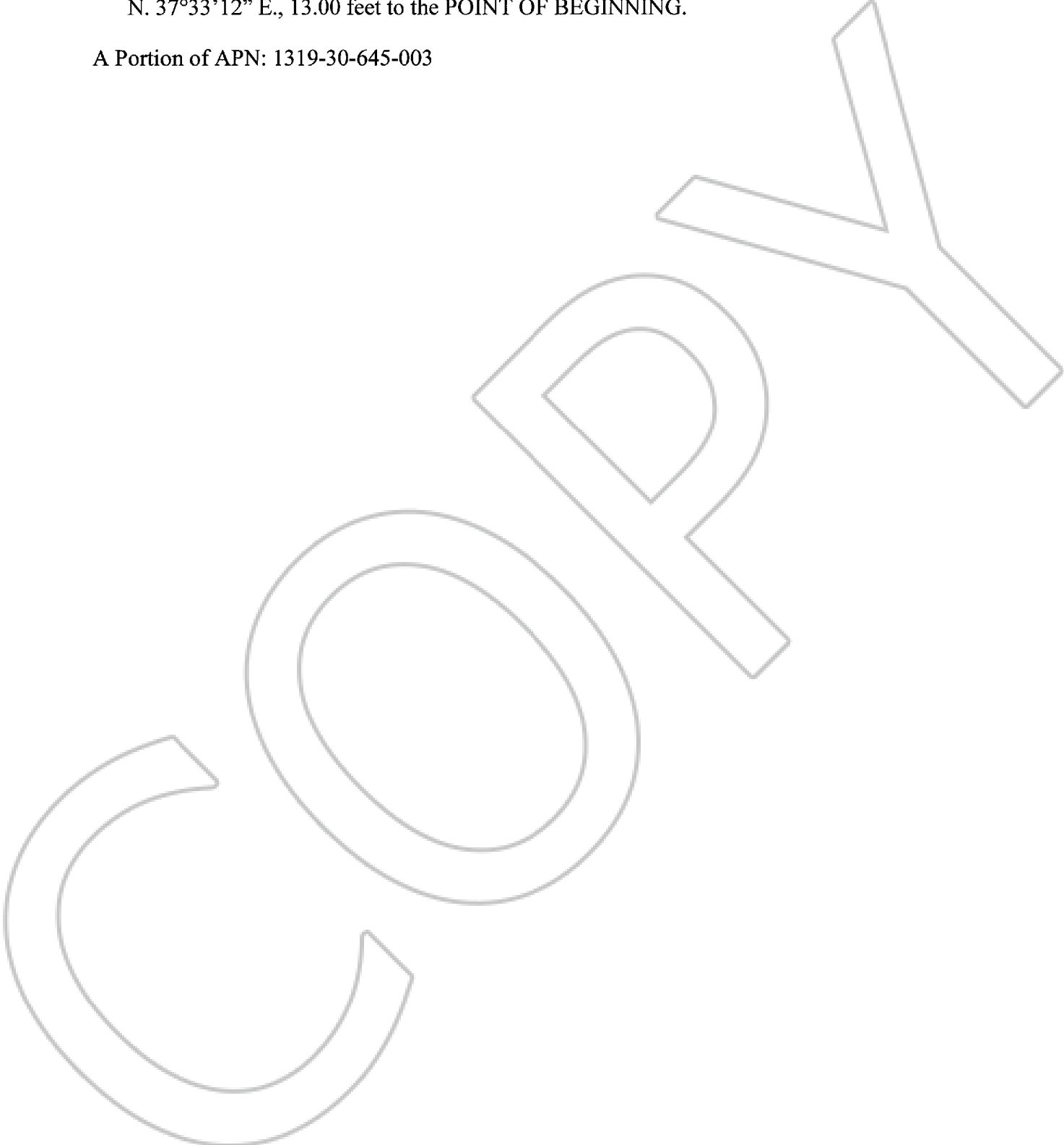



Exhibit A-1  
[Ridge Tahoe]

Count	Inventory	Frequency	Lot	Season2	APN
1	2800451A	Annual	28	All	1319-30-643-004
2	2800503A	Annual	28	All	1319-30-643-005
3	2800541B	Odd	28	All	1319-30-643-005
4	2800541C	Even	28	All	1319-30-643-005
5	2800548A	Annual	28	All	1319-30-643-005
6	2800601A	Annual	28	All	1319-30-643-006
7	2800603A	Annual	28	All	1319-30-643-006
8	2800615A	Annual	28	All	1319-30-643-006
9	2800637B	Odd	28	All	1319-30-643-006
10	2800637C	Even	28	All	1319-30-643-006
11	2800704A	Annual	28	All	1319-30-643-008
12	2800706A	Annual	28	All	1319-30-643-008
13	2800727A	Annual	28	All	1319-30-643-008
14	2800730A	Annual	28	All	1319-30-643-008
15	2800733A	Annual	28	All	1319-30-643-008
16	2800734A	Annual	28	All	1319-30-643-008
17	2800746A	Annual	28	All	1319-30-643-008
18	2800814A	Annual	28	All	1319-30-643-009
19	2800818A	Annual	28	All	1319-30-643-009
20	2800826A	Annual	28	All	1319-30-643-009
21	2800839A	Annual	28	All	1319-30-643-009
22	2800851A	Annual	28	All	1319-30-643-009
23	2800901A	Annual	28	All	1319-30-643-010
24	2800910A	Annual	28	All	1319-30-643-010
25	2800912A	Annual	28	All	1319-30-643-010
26	2800915A	Annual	28	All	1319-30-643-010
27	2801046A	Annual	28	All	1319-30-643-011
28	2801118A	Annual	28	All	1319-30-643-012
29	2801139A	Annual	28	All	1319-30-643-012
30	2801234A	Annual	28	All	1319-30-643-013
31	2801246A	Annual	28	All	1319-30-643-013
32	2801712A	Annual	28	All	1319-30-643-020
33	2801727A	Annual	28	All	1319-30-643-020
34	2803623A	Annual	28	All	1319-30-643-043
35	2804426A	Annual	28	All	1319-30-643-052
36	3108147A	Annual	31	Winter	1319-30-721-001
37	3108424A	Annual	31	Swing	1319-30-721-004
38	3108520B	Odd	31	Swing	1319-30-721-005
39	3108520C	Even	31	Swing	1319-30-721-005
40	3108614A	Annual	31	Summer	1319-30-721-006
41	3108615A	Annual	31	Summer	1319-30-721-006
42	3108704A	Annual	31	Summer	1319-30-721-007

Exhibit A-1  
[Ridge Tahoe]

Count	Inventory	Frequency	Lot	Season2	APN
43	3108714A	Annual	31	Summer	1319-30-721-007
44	3108715A	Annual	31	Summer	1319-30-721-007
45	3108742A	Annual	31	Winter	1319-30-721-007
46	3108810A	Annual	31	Summer	1319-30-721-008
47	3108822A	Annual	31	Swing	1319-30-721-008
48	3108829A	Annual	31	Swing	1319-30-721-008
49	3108851A	Annual	31	Winter	1319-30-721-008
50	3108901A	Annual	31	Summer	1319-30-721-009
51	3108905A	Annual	31	Summer	1319-30-721-009
52	3108915A	Annual	31	Summer	1319-30-721-009
53	3108919A	Annual	31	Swing	1319-30-721-009
54	3108948A	Annual	31	Winter	1319-30-721-009
55	3109006A	Annual	31	Summer	1319-30-721-010
56	3109048A	Annual	31	Winter	1319-30-721-010
57	3109115A	Annual	31	Summer	1319-30-721-012
58	3109145A	Annual	31	Winter	1319-30-721-012
59	3109149A	Annual	31	Winter	1319-30-721-012
60	3109249A	Annual	31	Winter	1319-30-721-013
61	3109439A	Annual	31	Winter	1319-30-721-015
62	3210242A	Annual	32	Winter	1319-30-722-002
63	3210802A	Annual	32	Summer	1319-30-722-008
64	3211012A	Annual	32	Summer	1319-30-722-010
65	3211116A	Annual	32	Summer	1319-30-722-012
66	3211322A	Annual	32	Swing	1319-30-722-014
67	3211351A	Annual	32	Winter	1319-30-722-014
68	3313619B	Odd	33	Swing	1319-30-723-016
69	3313619C	Even	33	Swing	1319-30-723-016
70	3400140B	Odd	34	Swing	1319-30-643-001
71	3400140C	Even	34	Swing	1319-30-643-001
72	3400230A	Annual	34	Prime	1319-30-724-002
73	3400316A	Annual	34	Prime	1319-30-724-003
74	3400322B	Odd	34	Prime	1319-30-724-003
75	3400322C	Even	34	Prime	1319-30-724-003
76	3400407B	Odd	34	Prime	1319-30-724-004
77	3400407C	Even	34	Prime	1319-30-724-004
78	3400442B	Odd	34	Swing	1319-30-724-004
79	3400442C	Even	34	Swing	1319-30-724-004
80	3400512A	Annual	34	Prime	1319-30-724-005
81	3400519A	Annual	34	Prime	1319-30-724-005
82	3400534A	Annual	34	Prime	1319-30-724-005
83	3400546A	Annual	34	Swing	1319-30-724-005
84	3400550A	Annual	34	Swing	1319-30-724-005

Exhibit A-1  
[Ridge Tahoe]

Count	Inventory	Frequency	Lot	Season2	APN
85	3400602A	Annual	34	Prime	1319-30-724-006
86	3400611A	Annual	34	Prime	1319-30-724-006
87	3400615A	Annual	34	Prime	1319-30-724-006
88	3400628A	Annual	34	Prime	1319-30-724-006
89	3400640A	Annual	34	Swing	1319-30-724-006
90	3400649A	Annual	34	Swing	1319-30-724-006
91	3400650A	Annual	34	Swing	1319-30-724-006
92	3400709A	Annual	34	Prime	1319-30-724-008
93	3400720A	Annual	34	Prime	1319-30-724-008
94	3400724A	Annual	34	Prime	1319-30-724-008
95	3400728A	Annual	34	Prime	1319-30-724-008
96	3400736A	Annual	34	Prime	1319-30-724-008
97	3400748A	Annual	34	Swing	1319-30-724-008
98	3400751A	Annual	34	Swing	1319-30-724-008
99	3400802A	Annual	34	Prime	1319-30-724-009
100	3400803A	Annual	34	Prime	1319-30-724-009
101	3400806A	Annual	34	Prime	1319-30-724-009
102	3401140B	Odd	34	Swing	1319-30-724-012
103	3401140C	Even	34	Swing	1319-30-724-012
104	3401340A	Annual	34	Swing	1319-30-724-014
105	3401829B	Odd	34	Prime	1319-30-724-019
106	3401829C	Even	34	Prime	1319-30-724-019
107	3401925A	Annual	34	Prime	1319-30-724-020
108	3402214A	Annual	34	Prime	1319-30-724-023
109	3403403A	Annual	34	Prime	1319-30-724-035
110	3403508A	Annual	34	Prime	1319-30-724-036
111	3403514A	Annual	34	Prime	1319-30-724-036
112	3403520A	Annual	34	Prime	1319-30-724-036
113	3403613A	Annual	34	Prime	1319-30-724-037
114	3403615A	Annual	34	Prime	1319-30-724-037
115	3403711A	Annual	34	Prime	1319-30-724-038
116	3704035A	Annual	37	Prime	1319-30-644-002
117	3704242A	Annual	37	Swing	1319-30-644-004
118	3704301A	Annual	37	Prime	1319-30-644-005
119	3704407A	Annual	37	Prime	1319-30-644-006
120	3704412A	Annual	37	Prime	1319-30-644-006
121	3704429B	Odd	37	Prime	1319-30-644-006
122	3704429C	Even	37	Prime	1319-30-644-006
123	3704439A	Annual	37	Swing	1319-30-644-006
124	3704442B	Odd	37	Swing	1319-30-644-006
125	3704442C	Even	37	Swing	1319-30-644-006
126	3704502A	Annual	37	Prime	1319-30-644-007

Exhibit A-1  
[Ridge Tahoe]

Count	Inventory	Frequency	Lot	Season2	APN
127	3704508A	Annual	37	Prime	1319-30-644-007
128	3704511A	Annual	37	Prime	1319-30-644-007
129	3704512A	Annual	37	Prime	1319-30-644-007
130	3704515A	Annual	37	Prime	1319-30-644-007
131	3704519B	Odd	37	Prime	1319-30-644-007
132	3704519C	Even	37	Prime	1319-30-644-007
133	3704529A	Annual	37	Prime	1319-30-644-007
134	3704602A	Annual	37	Prime	1319-30-644-008
135	3704611A	Annual	37	Prime	1319-30-644-008
136	3704651A	Annual	37	Swing	1319-30-644-008
137	3704702A	Annual	37	Prime	1319-30-644-010
138	3704705A	Annual	37	Prime	1319-30-644-010
139	3704706A	Annual	37	Prime	1319-30-644-010
140	3704710A	Annual	37	Prime	1319-30-644-010
141	3704711A	Annual	37	Prime	1319-30-644-010
142	3704716A	Annual	37	Prime	1319-30-644-010
143	3704719A	Annual	37	Prime	1319-30-644-010
144	3704723A	Annual	37	Prime	1319-30-644-010
145	3704727A	Annual	37	Prime	1319-30-644-010
146	3704733A	Annual	37	Prime	1319-30-644-010
147	3704739A	Annual	37	Swing	1319-30-644-010
148	3704805A	Annual	37	Prime	1319-30-644-011
149	3704807A	Annual	37	Prime	1319-30-644-011
150	3704811A	Annual	37	Prime	1319-30-644-011
151	3704812A	Annual	37	Prime	1319-30-644-011
152	3704826A	Annual	37	Prime	1319-30-644-011
153	3704845A	Annual	37	Swing	1319-30-644-011
154	3704848A	Annual	37	Swing	1319-30-644-011
155	3704908A	Annual	37	Prime	1319-30-644-012
156	3704909A	Annual	37	Prime	1319-30-644-012
157	3704914A	Annual	37	Prime	1319-30-644-012
158	3704941A	Annual	37	Swing	1319-30-644-012
159	3705001A	Annual	37	Prime	1319-30-644-013
160	3705008A	Annual	37	Prime	1319-30-644-013
161	3705010A	Annual	37	Prime	1319-30-644-013
162	3705011A	Annual	37	Prime	1319-30-644-013
163	3705020A	Annual	37	Prime	1319-30-644-013
164	3705024A	Annual	37	Prime	1319-30-644-013
165	3705030A	Annual	37	Prime	1319-30-644-013
166	3705040A	Annual	37	Swing	1319-30-644-013
167	3705042A	Annual	37	Swing	1319-30-644-013
168	3705043A	Annual	37	Swing	1319-30-644-013

Exhibit A-1  
[Ridge Tahoe]

Count	Inventory	Frequency	Lot	Season2	APN
169	3705102A	Annual	37	Prime	1319-30-644-014
170	3705103A	Annual	37	Prime	1319-30-644-014
171	3705106A	Annual	37	Prime	1319-30-644-014
172	3705108A	Annual	37	Prime	1319-30-644-014
173	3705118A	Annual	37	Prime	1319-30-644-014
174	3705139A	Annual	37	Swing	1319-30-644-014
175	3705142B	Odd	37	Swing	1319-30-644-014
176	3705142C	Even	37	Swing	1319-30-644-014
177	3705147A	Annual	37	Swing	1319-30-644-014
178	3705202A	Annual	37	Prime	1319-30-644-015
179	3705204A	Annual	37	Prime	1319-30-644-015
180	3705213A	Annual	37	Prime	1319-30-644-015
181	3705215A	Annual	37	Prime	1319-30-644-015
182	3705219B	Odd	37	Prime	1319-30-644-015
183	3705219C	Even	37	Prime	1319-30-644-015
184	3705239A	Annual	37	Swing	1319-30-644-015
185	3705250A	Annual	37	Swing	1319-30-644-015
186	3705303A	Annual	37	Prime	1319-30-644-016
187	3705306A	Annual	37	Prime	1319-30-644-016
188	3705307A	Annual	37	Prime	1319-30-644-016
189	3705312A	Annual	37	Prime	1319-30-644-016
190	3705314A	Annual	37	Prime	1319-30-644-016
191	3705319C	Even	37	Prime	1319-30-644-016
192	3705320A	Annual	37	Prime	1319-30-644-016
193	3705324A	Annual	37	Prime	1319-30-644-016
194	3705326A	Annual	37	Prime	1319-30-644-016
195	3705340B	Odd	37	Swing	1319-30-644-016
196	3705340C	Even	37	Swing	1319-30-644-016
197	3705341A	Annual	37	Swing	1319-30-644-016
198	3705344B	Odd	37	Swing	1319-30-644-016
199	3705344C	Even	37	Swing	1319-30-644-016
200	3705345A	Annual	37	Swing	1319-30-644-016
201	3705348B	Odd	37	Swing	1319-30-644-016
202	3705348C	Even	37	Swing	1319-30-644-016
203	3705401A	Annual	37	Prime	1319-30-644-017
204	3705408A	Annual	37	Prime	1319-30-644-017
205	3705409A	Annual	37	Prime	1319-30-644-017
206	3705413A	Annual	37	Prime	1319-30-644-017
207	3705415A	Annual	37	Prime	1319-30-644-017
208	3705417A	Annual	37	Prime	1319-30-644-017
209	3705427A	Annual	37	Prime	1319-30-644-017
210	3705430A	Annual	37	Prime	1319-30-644-017

Exhibit A-1  
[Ridge Tahoe]

Count	Inventory	Frequency	Lot	Season2	APN
211	3705431A	Annual	37	Prime	1319-30-644-017
212	3705435A	Annual	37	Prime	1319-30-644-017
213	3705437A	Annual	37	Prime	1319-30-644-017
214	3705506A	Annual	37	Prime	1319-30-644-020
215	3705514A	Annual	37	Prime	1319-30-644-020
216	3705518B	Odd	37	Prime	1319-30-644-020
217	3705518C	Even	37	Prime	1319-30-644-020
218	3705941B	Odd	37	Swing	1319-30-644-024
219	3705941C	Even	37	Swing	1319-30-644-024
220	3706307A	Annual	37	Prime	1319-30-644-028
221	3706635A	Annual	37	Prime	1319-30-644-031
222	3706648B	Odd	37	Swing	1319-30-644-031
223	3706648C	Even	37	Swing	1319-30-644-031
224	3706749A	Annual	37	Swing	1319-30-644-034
225	3706939B	Odd	37	Swing	1319-30-644-036
226	3706939C	Even	37	Swing	1319-30-644-036
227	3707046A	Annual	37	Swing	1319-30-644-037
228	3707531B	Odd	37	Prime	1319-30-644-042
229	3707819A	Annual	37	Prime	1319-30-644-045
230	3707848A	Annual	37	Swing	1319-30-644-045
231	3708018A	Annual	37	Prime	1319-30-644-047
232	3714507A	Annual	37	Prime	1319-30-644-053
233	3714742C	Even	37	Swing	1319-30-644-055
234	3714806A	Annual	37	Prime	1319-30-644-056
235	3715245A	Annual	37	Swing	1319-30-644-060
236	3715539B	Odd	37	Swing	1319-30-644-063
237	3715539C	Even	37	Swing	1319-30-644-063
238	3715641B	Odd	37	Swing	1319-30-644-064
239	3715641C	Even	37	Swing	1319-30-644-064
240	3715838A	Annual	37	Swing	1319-30-644-066
241	3717547B	Odd	37	Swing	1319-30-644-085
242	3717547C	Even	37	Swing	1319-30-644-085
243	3718344B	Odd	37	Swing	1319-30-644-093
244	3718344C	Even	37	Swing	1319-30-644-093
245	3718802A	Annual	37	Prime	1319-30-644-098
246	3718902A	Annual	37	Prime	1319-30-644-099
247	3719109A	Annual	37	Prime	1319-30-644-102
248	3719420A	Annual	37	Prime	1319-30-644-105
249	3719520	Even	37	Prime	1319-30-644-106
250	3719520B	Odd	37	Prime	1319-30-644-106
251	3719545B	Odd	37	Swing	1319-30-644-106
252	4225711A	Annual	42	All	1319-30-645-003

Exhibit A-1  
[Ridge Tahoe]

Count	Inventory	Frequency	Lot	Season2	APN
253	4225713A	Annual	42	All	1319-30-645-003
254	4225723A	Annual	42	All	1319-30-645-003
255	4225725A	Annual	42	All	1319-30-645-003
256	4225727A	Annual	42	All	1319-30-645-003
257	4225729A	Annual	42	All	1319-30-645-003
258	4225732A	Annual	42	All	1319-30-645-003
259	4225733A	Annual	42	All	1319-30-645-003
260	4225737A	Annual	42	All	1319-30-645-003
261	4225741A	Annual	42	All	1319-30-645-003
262	4225743A	Annual	42	All	1319-30-645-003
263	4225746A	Annual	42	All	1319-30-645-003
264	4225804A	Annual	42	All	1319-30-645-003
265	4225806A	Annual	42	All	1319-30-645-003
266	4225807A	Annual	42	All	1319-30-645-003
267	4225810A	Annual	42	All	1319-30-645-003
268	4225811A	Annual	42	All	1319-30-645-003
269	4225822A	Annual	42	All	1319-30-645-003
270	4225823A	Annual	42	All	1319-30-645-003
271	4225831A	Annual	42	All	1319-30-645-003
272	4225837A	Annual	42	All	1319-30-645-003
273	4225838A	Annual	42	All	1319-30-645-003
274	4225910A	Annual	42	All	1319-30-645-003
275	4225925A	Annual	42	All	1319-30-645-003
276	4225929A	Annual	42	All	1319-30-645-003
277	4225937A	Annual	42	All	1319-30-645-003
278	4225950A	Annual	42	All	1319-30-645-003
279	4226002A	Annual	42	All	1319-30-645-003
280	4226004A	Annual	42	All	1319-30-645-003
281	4226012A	Annual	42	All	1319-30-645-003
282	4226013A	Annual	42	All	1319-30-645-003
283	4226015A	Annual	42	All	1319-30-645-003
284	4226018A	Annual	42	All	1319-30-645-003
285	4226019A	Annual	42	All	1319-30-645-003
286	4226024A	Annual	42	All	1319-30-645-003
287	4226025A	Annual	42	All	1319-30-645-003
288	4226029A	Annual	42	All	1319-30-645-003
289	4226036A	Annual	42	All	1319-30-645-003
290	4226039A	Annual	42	All	1319-30-645-003
291	4226042A	Annual	42	All	1319-30-645-003
292	4226046A	Annual	42	All	1319-30-645-003
293	4226051A	Annual	42	All	1319-30-645-003
294	4226106A	Annual	42	All	1319-30-645-003

Exhibit A-1  
[Ridge Tahoe]

Count	Inventory	Frequency	Lot	Season2	APN
295	4226109A	Annual	42	All	1319-30-645-003
296	4226112A	Annual	42	All	1319-30-645-003
297	4226114A	Annual	42	All	1319-30-645-003
298	4226115A	Annual	42	All	1319-30-645-003
299	4226117A	Annual	42	All	1319-30-645-003
300	4226118A	Annual	42	All	1319-30-645-003
301	4226128A	Annual	42	All	1319-30-645-003
302	4226133A	Annual	42	All	1319-30-645-003
303	4226134A	Annual	42	All	1319-30-645-003
304	4226144B	Odd	42	All	1319-30-645-003
305	4226144C	Even	42	All	1319-30-645-003
306	4226149A	Annual	42	All	1319-30-645-003
307	4226151A	Annual	42	All	1319-30-645-003
308	4226202A	Annual	42	All	1319-30-645-003
309	4226203A	Annual	42	All	1319-30-645-003
310	4226209A	Annual	42	All	1319-30-645-003
311	4226216A	Annual	42	All	1319-30-645-003
312	4226801A	Annual	42	All	1319-30-645-003
313	4226804A	Annual	42	All	1319-30-645-003
314	4226808A	Annual	42	All	1319-30-645-003
315	4226816A	Annual	42	All	1319-30-645-003
316	4226819A	Annual	42	All	1319-30-645-003
317	4227007A	Annual	42	All	1319-30-645-003
318	4227530A	Annual	42	All	1319-30-645-003
319	4228006A	Annual	42	All	1319-30-645-003
320	4228126A	Annual	42	All	1319-30-645-003
321	4228334A	Annual	42	All	1319-30-645-003
322	4228449A	Annual	42	All	1319-30-645-003
323	4228648A	Annual	42	All	1319-30-645-003
324	4228945A	Annual	42	All	1319-30-645-003
325	4229104A	Annual	42	All	1319-30-645-003
326	4229422A	Annual	42	All	1319-30-645-003
327	4229603A	Annual	42	All	1319-30-645-003
328	4229614A	Annual	42	All	1319-30-645-003
329	4229620A	Annual	42	All	1319-30-645-003
330	4229621A	Annual	42	All	1319-30-645-003
331	4229923A	Annual	42	All	1319-30-645-003
332	4229937A	Annual	42	All	1319-30-645-003
333	4230040A	Annual	42	All	1319-30-645-003
334	4230148A	Annual	42	All	1319-30-645-003



**STATE OF NEVADA  
DECLARATION OF VALUE**

1. Assessor Parcel Number(s)

- a) 1319-30-643-001 thru-050 ; 1319-30-644-001 thru 115
- b) 1319-30-721-001 thru 021 ; 1319-30-722-001 thru 021
- c) 1319-30-723-001 thru 021 ; 1319-30-724-001 thru 039
- d) 1319030-645-003

2. Type of Property

- a)  Vacant Land      b)  Single Fam. Res.
- c)  Condo/Twnhs      d)  2-4 Plex
- e)  Apt. Bldg.      f)  Comm'l/Ind'l
- g)  Agricultural      h)  Mobile Home
- i)  Other Timeshare

FOR RECORDERS OPTIONAL USE	
Book _____	Page: _____
Date of Recording: _____	
Notes: _____	

- 3. Total Value/Sales Price of Property: \$ 920,819.30
- Deed in Lieu of Foreclosure Only (value of property) ( \$ \_\_\_\_\_ )
- Transfer Tax Value: \$ 920,819.30
- Real Property Transfer Tax Due \$ 3,591.90

4. **If Exemption Claimed:**

- a. Transfer Tax Exemption, per 375.090, Section: \_\_\_\_\_
- b. Explain reason for exemption:  
\_\_\_\_\_

5. Partial Interest: Percentage being transferred: 100 %

The undersigned declares and acknowledges, under penalty of perjury, pursuant to NRS 375.060 and NRS 375.110, that the information provided is correct to the best of their information and belief, and can be supported by documentation if called upon to substantiate the information provided herein. Furthermore, the parties agree that disallowance of any claimed exemption, or other determination of additional tax due, may result in a penalty of 10% of the tax due plus interest at 1% per month. Pursuant to NRS 375.030, the Buyer and Seller shall be jointly and severally liable for any additional amount owed.

Signature: *[Signature]* Capacity: Agent  
 Signature: \_\_\_\_\_ Capacity: \_\_\_\_\_

**SELLER (GRANTOR) INFORMATION**

**(REQUIRED)**

Print Name: Holiday Inn Club Vacations Incorporated  
 Address: 9271 S John Young Pkwy  
 City: Orlando  
 State: Florida Zip: 32819

**BUYER (GRANTEE) INFORMATION**

**(REQUIRED)**

Print Name: Chicago Title Timeshare Land Trust Inc, Trustee  
 Address: 2400 Maitland Center Pkwy 110  
 City: Maitland  
 State: Florida Zip: 32751

**COMPANY/PERSON REQUESTING RECORDING (required if not seller or buyer)**

Print Name: Wilson Title Services File Number: \_\_\_\_\_  
 Address 4045 S Spencer St, A62  
 City: Las Vegas State: NV Zip: 89119

(AS A PUBLIC RECORD THIS FORM MAY BE RECORDED/MICROFILMED)