



00181767202410083120030036

SHAWNYNE GARREN, RECORDER

E07

RECORDING REQUESTED BY
AND WHEN RECORDED MAIL TO:

Christeen M. Reeg, Trustee
3217 Cessna Drive
Cameron Park, CA 95682

A.P.N. 1420-08-414-008

The undersigned hereby declare that:

1. Documentary Transfer Tax Due: NONE Grantee is a Trust for the benefit of the Grantors NRS 375.090

TRUST TRANSFER DEED (QUITCLAIM)

FOR NO CONSIDERATION,

CHRISTEEN M. REEG, Trustee of the MICHAEL S. COLLOM AND CHRISTEEN M. REEG TRUST, dated March 25, 2011

hereby QUITCLAIMS to

CHRISTEEN M. REEG, Trustee of the CHRISTEEN M. REEG SEPARATE PROPERTY TRUST, dated March 25, 2011

all of the Trust's right, title, and interest in the real property in the County of Douglas, State of Nevada, described in Exhibit A attached hereto.

Dated: April 30, 2024

CHRISTEEN M. REEG

A notary public or other officer completing this certificate verifies only the identity of the individual who signed the document to which this certificate is attached, and not the truthfulness, accuracy, or validity of that document.

STATE OF CALIFORNIA)
 :SS
COUNTY OF EL DORADO)

On April 30, 2024, before me, JANA S. ELLERMAN, Notary Public, personally appeared CHRISTEEN M. REEG, who proved to me on the basis of satisfactory evidence to be the person(s) whose name(s) is/are subscribed to the within instrument and acknowledged to me that he/she/they executed the same in his/her/their authorized capacity(ies), and that by his/her/their signature(s) on the instrument the person(s), or the entity upon behalf of which the person(s) acted, executed the instrument.

I certify under PENALTY OF PERJURY under the laws of the State of California that the foregoing paragraph is true and correct.

WITNESS my hand and official seal.

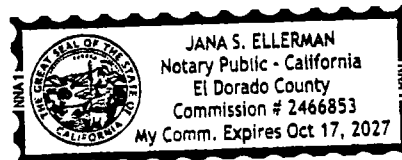
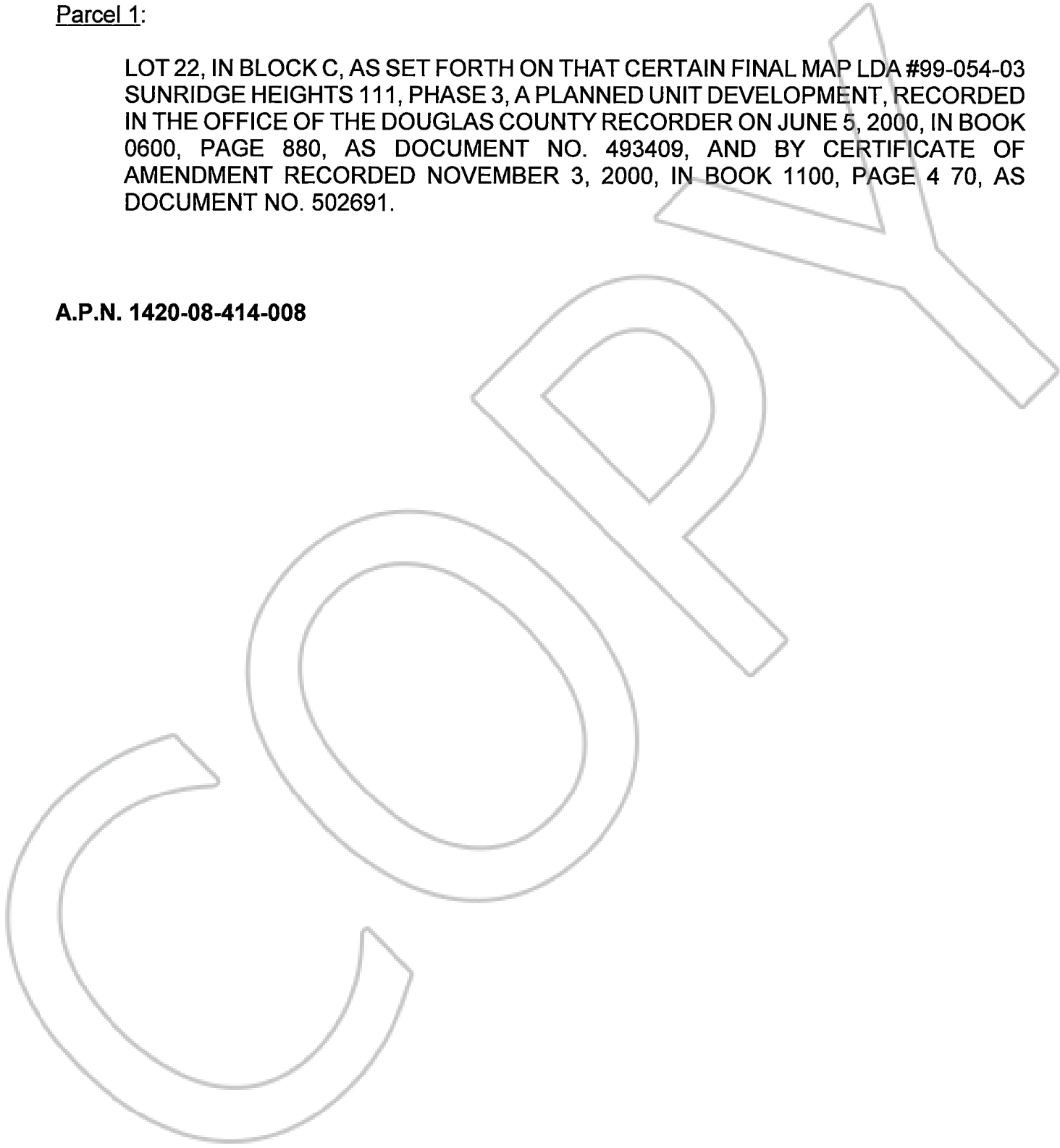

EXHIBIT A

Parcel 1:

LOT 22, IN BLOCK C, AS SET FORTH ON THAT CERTAIN FINAL MAP LDA #99-054-03 SUNRIDGE HEIGHTS 111, PHASE 3, A PLANNED UNIT DEVELOPMENT, RECORDED IN THE OFFICE OF THE DOUGLAS COUNTY RECORDER ON JUNE 5, 2000, IN BOOK 0600, PAGE 880, AS DOCUMENT NO. 493409, AND BY CERTIFICATE OF AMENDMENT RECORDED NOVEMBER 3, 2000, IN BOOK 1100, PAGE 4 70, AS DOCUMENT NO. 502691.

A.P.N. 1420-08-414-008



**STATE OF NEVADA
DECLARATION OF VALUE FORM**

1. Assessor Parcel Number(s)

- a) 1420-08-414-008
- b) _____
- c) _____
- d) _____

2. Type of Property:

- a) Vacant Land
- b) Single Fam. Res.
- c) Condo/Twnhse
- d) 2-4 Plex
- e) Apt. Bldg
- f) Comm'l/Ind'l
- g) Agricultural
- h) Mobile Home
- Other _____

FOR RECORDER'S OPTIONAL USE ONLY	
Book: _____	Page: _____
Date of Recording: <u>8/20/24</u>	
Notes: <u>Grant or 48</u>	

- 3. Total Value/Sales Price of Property \$ 0.00
- Deed in Lieu of Foreclosure Only (value of property) (_____)
- Transfer Tax Value: \$ _____
- Real Property Transfer Tax Due \$ 0.00

4. If Exemption Claimed:

- a. Transfer Tax Exemption per NRS 375.090, Section 7
- b. Explain Reason for Exemption: Transfer to revocable trust without consideration

5. Partial Interest: Percentage being transferred: _____ %

The undersigned declares and acknowledges, under penalty of perjury, pursuant to NRS 375.060 and NRS 375.110, that the information provided is correct to the best of their information and belief, and can be supported by documentation if called upon to substantiate the information provided herein. Furthermore, the parties agree that disallowance of any claimed exemption, or other determination of additional tax due, may result in a penalty of 10% of the tax due plus interest at 1% per month. Pursuant to NRS 375.030, the Buyer and Seller shall be jointly and severally liable for any additional amount owed.

Signature Christeen M. Reeg Capacity Trustee

Signature Christeen M. Reeg Capacity _____

SELLER (GRANTOR) INFORMATION
(REQUIRED)
Print Name: Christeen M. Reeg, Ttee
Address: 3217 Cessna Drive
City: Cameron Park
State: CA Zip: 95682

BUYER (GRANTEE) INFORMATION
(REQUIRED)
Print Name: Christeen M. Reeg, Ttee
Address: 3217 Cessna Drive
City: Cameron Park
State: CA Zip: 95682

COMPANY/PERSON REQUESTING RECORDING (required if not seller or buyer)
Print Name: Ellerman Strand Escrow #: n/a
Address: 3108 Ponte Morino Drive, Suite 240
City: Cameron Park State: CA Zip: 95682