

SURVEYOR'S CERTIFICATE

I, JEFFERY W. TURNER, A PROFESSIONAL LAND SURVEYOR LICENSED IN THE STATE OF NEVADA, CERTIFY THAT:
 1. THIS IS A TRUE AND ACCURATE REPRESENTATION OF THE LANDS SURVEYED UNDER MY SUPERVISION AT THE INSTANCE OF WILLIAM REGAN.
 2. THE LANDS SURVEYED LIE WITHIN A PORTION OF SECTION 9, TOWNSHIP 13 NORTH, RANGE 18 EAST, M.D.M., AND THE SURVEY WAS COMPLETED ON MAY 8, 2024.
 3. THIS PLAT COMPLIES WITH THE APPLICABLE STATE STATUTES AND ANY LOCAL ORDINANCE AND IS NOT IN CONFLICT WITH THE PROVISIONS FOR N.R.S. 278.010 TO 278.630, INCLUSIVE.
 4. THE MONUMENTS ARE OF THE CHARACTER SHOWN AND OCCUPY THE POSITIONS INDICATED.

Jeffery W. Turner
 JEFFERY W. TURNER
 P.L.S. 21260
 16 AUG 24
 DATE

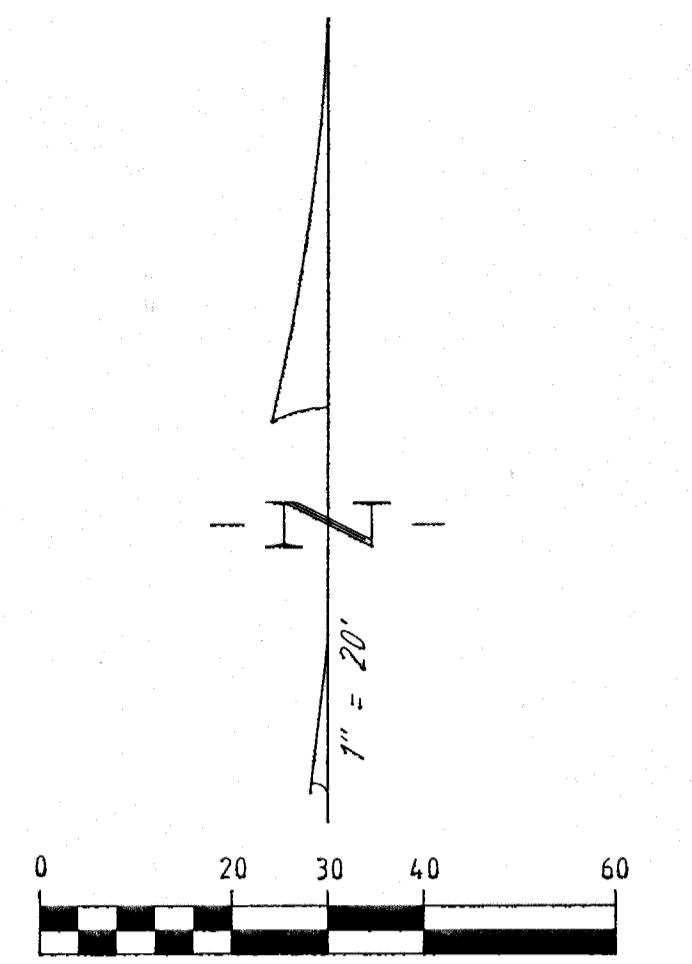
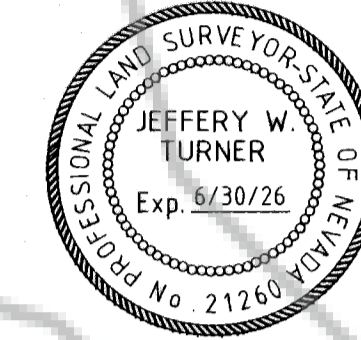

BASIS OF BEARINGS

THE MERIDIAN OF THIS SURVEY IS IDENTICAL WITH THAT OF THE AMENDED MAP OF SUBDIVISION NO. 2 OF ZEPHYR COVE PROPERTIES INC, FILED FOR RECORD ON AUGUST 5, 1929 AS DOCUMENT 267. BEING THE BEARING N 36°30' W AS MEASURED BETWEEN FOUND MONUMENTS AS SHOWN HEREON.

LEGEND

- FOUND MONUMENT AS NOTED
- SET 3/4" IRON PIPE W/PLASTIC PLUG, STAMPED "PLS 21260, OR SET AS NOTED
- (C) CALCULATED
- (M) MEASURED

COUNTY RECORDER'S CERTIFICATE

FILED FOR RECORD THIS 16th DAY OF August, 2024,
 AT 57 MINUTES PAST 12 O'CLOCK P.M., AS DOCUMENT
 NUMBER 2024-1011058
 RECORDED AT THE REQUEST OF WILLIAM REGAN.

Shawnyne Crahan, Deputy
 DOUGLAS COUNTY RECORDER

SCALE: 1"=20' SHEET 1 OF 1

RECORD OF SURVEY
 FOR
REGAN PROPERTIES, L.P.
 PORTION OF SECTION 9, T.13N., R.18E., M.D.M.
 BEING LOT 8 AND A PORTION OF LOT 9, BLK. A,
 AMENDED MAP OF SUBDIVISION NO. 2 OF ZEPHYR COVE
 PROPERTIES INC
 DOUGLAS COUNTY, NEVADA
 FILE NO. 24055 ROS.DWG AUG. 2024

REFERENCES

- (R1) AMENDED MAP OF SUBDIVISION NO. 2 OF ZEPHYR COVE PROPERTIES INC, DOCUMENT NUMBER 267.
- (R2) GRANT DEED, DOCUMENT NUMBER 353477

TURNER & ASSOCIATES, INC.
 LAND SURVEYING
 (775) 588-5658
 ADMIN@TURNERSURVEYING.NET
 308 DORLA COURT, SUITE 203 - ROUND HILL, NEVADA 89448
 P.O. BOX 5067 - STATELINE, NEVADA 89449
 JN 24055

NOTE

THIS MAP IS BEING FILED TO DELINEATE PROPERTY LINES AS DESCRIBED IN DEEDS RECORDED IN THE OFFICIAL RECORDS OF DOUGLAS COUNTY, NEVADA.